

DATE	
BY	
SURVEYED	
PLOTTED	
TEMPLATE	
NOTE BOOK	
AREAS CHECKED	
NO.	

DATE	
BY	
SURVEYED	
PLOTTED	
TEMPLATE	
NOTE BOOK	
AREAS CHECKED	
NO.	

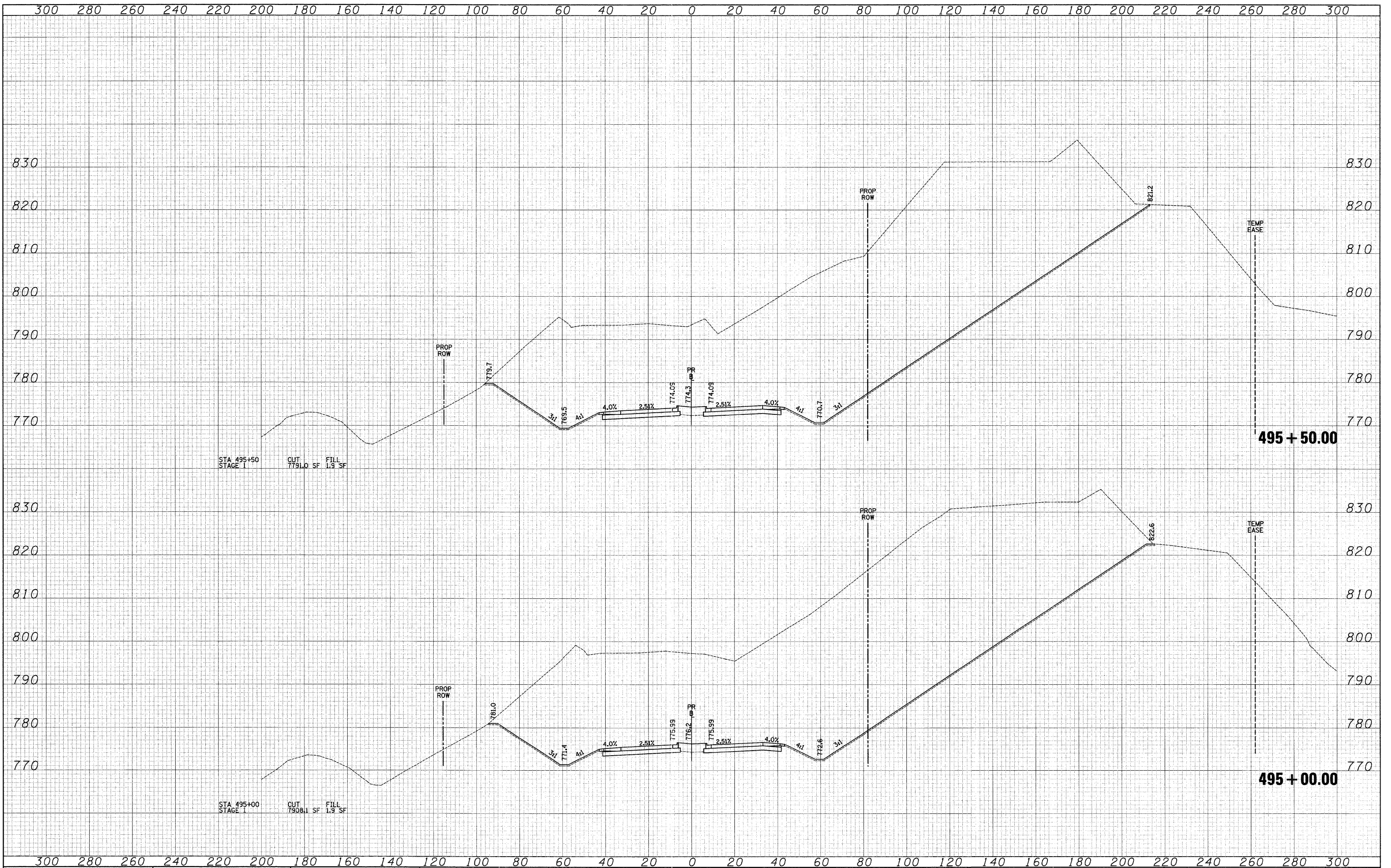

FILE NAME =

USER NAME = ead
 DESIGNED - JSM
 DRAWN - JSM
 CHECKED - DNM
 DATE - 3/30/09

REVISED -
 REVISED -
 REVISED -
 REVISED -

**KANE COUNTY
 DEPARTMENT OF TRANSPORTATION**

CROSS SECTIONS - STEARNS ROAD
 SCALE: 1"=10'V/20'H SHEET NO. 51 OF 63 SHEETS STA. 495+00.00 TO STA. 495+50.00

F.A. RTE. 361	SECTION 06-00214-25-BR	COUNTY KANE	TOTAL SHEETS 220	SHEET NO. 196
CONTRACT NO. 63076				
FED. ROAD DIST. NO. 1 ILLINOIS FED. AID PROJECT				