

DATE	
BY	
FINAL SURVEY	
SURVEYED	
PLOTTED	
NOTE BOOK	
AREAS CHECKED	
NO.	

DATE	
BY	
ORIGINAL SURVEY	
SURVEYED	
PLOTTED	
NOTE BOOK	
AREAS CHECKED	
NO.	

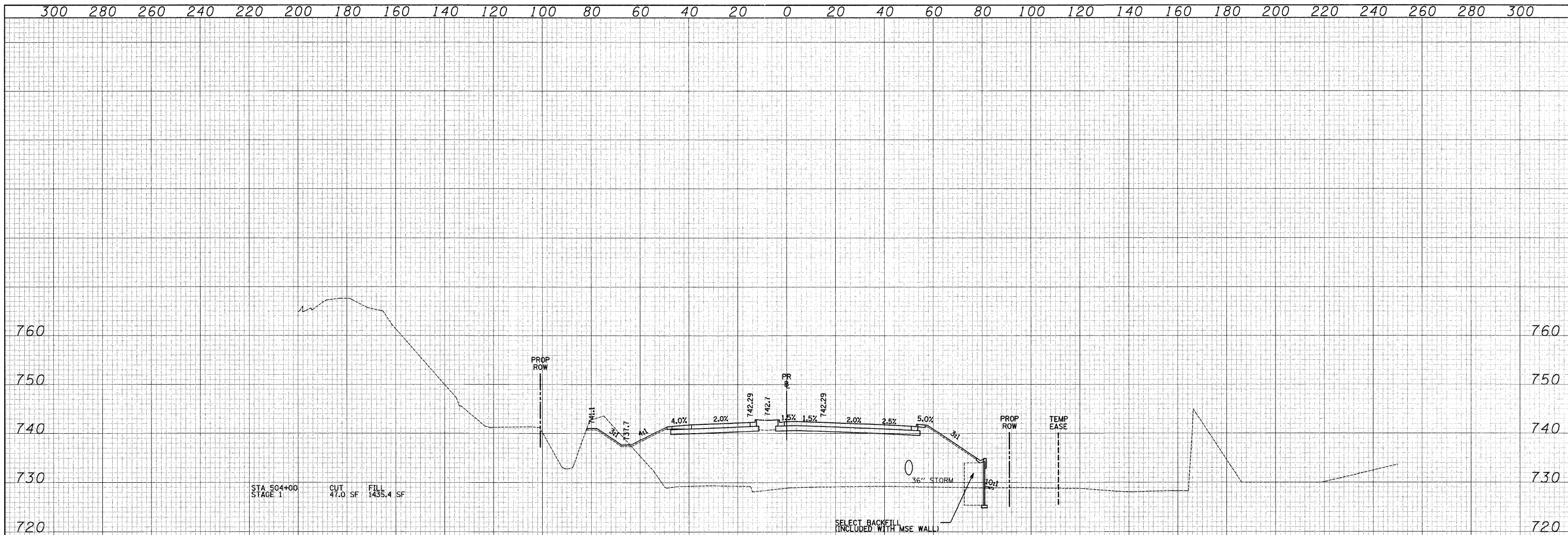

504 + 00.00

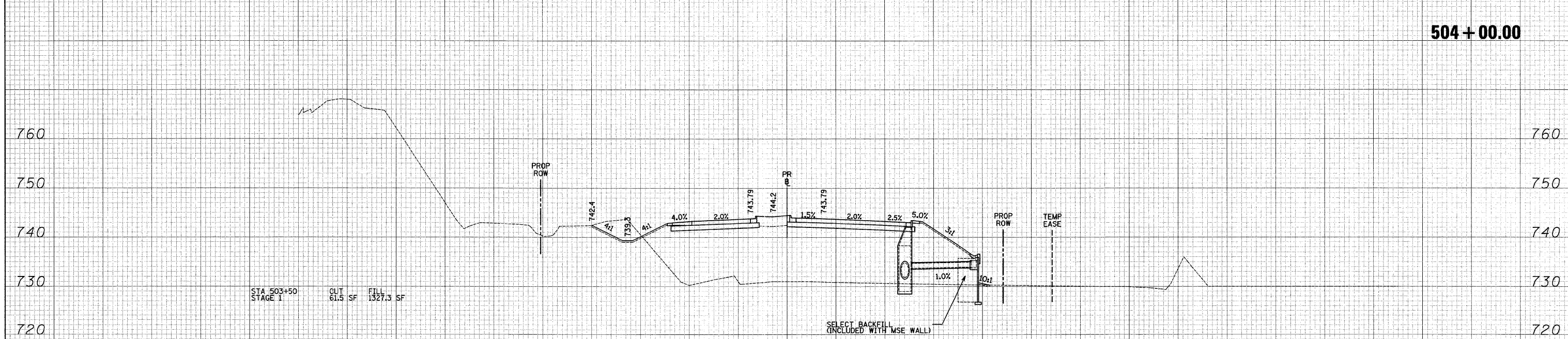

503 + 50.00

FILE NAME =	USER NAME = eed	DESIGNED - JSM	REVISED -	KANE COUNTY DEPARTMENT OF TRANSPORTATION	CROSS SECTIONS - STEARNS ROAD	F.A. RTE. 361	SECTION 06-00214-25-BR	COUNTY KANE	TOTAL SHEETS 220	SHEET NO. 203		
	PLOT SCALE = 20.0000' / IN.	DRAWN - JSM	REVISED -			SCALE: 1"=10'V/20'H SHEET NO. 58 OF 63 SHEETS	STA. 503+50.00 TO STA. 504+00.00	CONTRACT NO. 63076				
	PLOT DATE = 3/27/2009	CHECKED - DNM	REVISED -			FED. ROAD DIST. NO. 1 ILLINOIS FED. AID PROJECT						
		DATE - 3/30/09	REVISED -									