

PLAN	DATE
NO.	
BY	
DATE	
SURVEYED	
ALIGNMENT CHECKED	
NOTE BOOK	
NO.	
BY	
DATE	
SURVEYED	
GRADES CHECKED	
NOTE BOOK	
NO.	
BY	
DATE	
SURVEYED	
GRADES CHECKED	
NOTE BOOK	
NO.	
BY	
DATE	

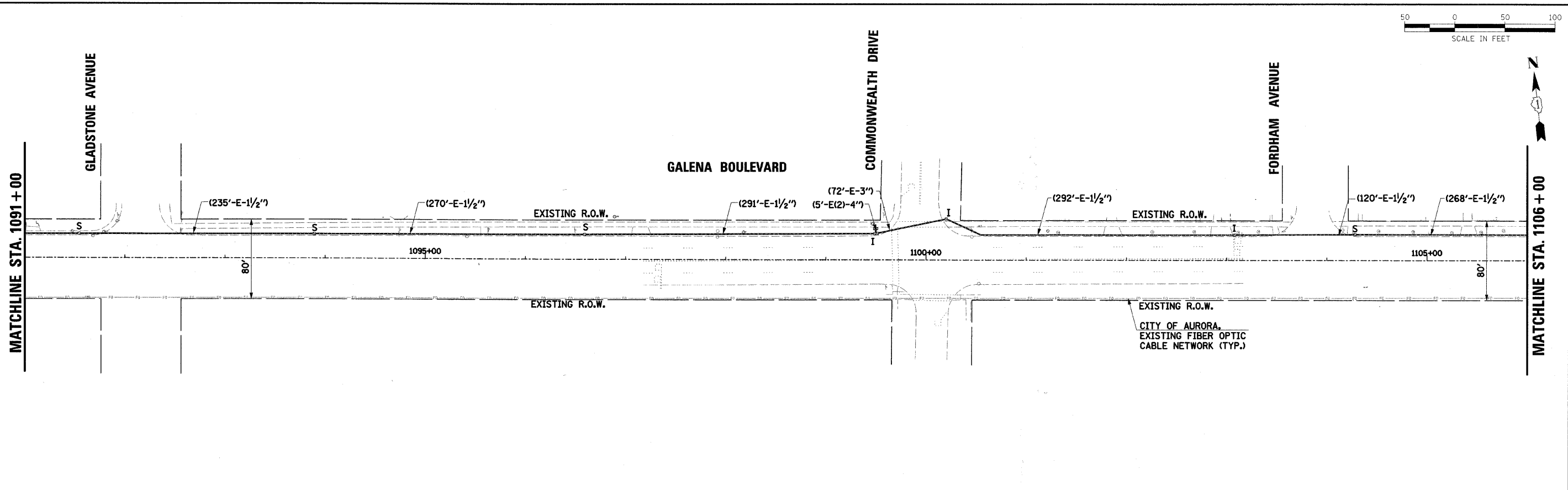

PROFILE	DATE
NO.	
BY	
DATE	
SURVEYED	
GRADES CHECKED	
NOTE BOOK	
NO.	
BY	
DATE	
SURVEYED	
GRADES CHECKED	
NOTE BOOK	
NO.	
BY	
DATE	

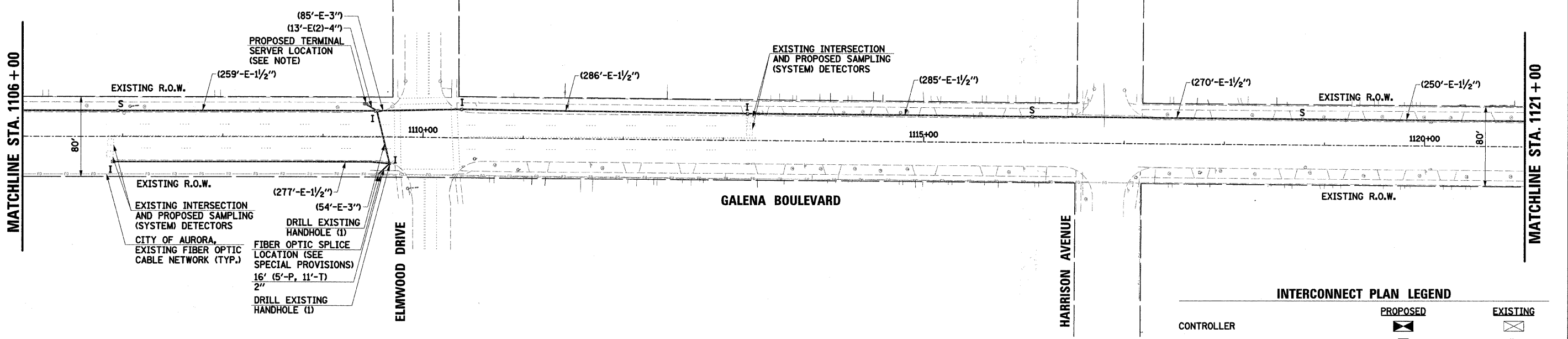

NOTE:
THE PROPOSED TERMINAL SERVER AND ETHERNET SWITCH SHALL BE INSTALLED WITHIN THE EXISTING TRAFFIC SIGNAL CONTROLLER CABINET AT ELMWOOD DRIVE (SEE SPECIAL PROVISIONS).

MODIFY EXISTING CONTROLLER (SPECIAL):
ALL TRAFFIC SIGNAL CONTROLLERS MUST BE FULLY OPERATIONAL AND NTCIP COMPATIBLE PRIOR TO INSTALLATION OF THE CENTRALIZED TRANSPORTATION MANAGEMENT SYSTEM (SEE SPECIAL PROVISIONS).

RESTORATION OF WORK AREA:
RESTORATION OF THE TRAFFIC SIGNAL WORK AREA SHALL BE INCIDENTAL TO THE RELATED PAY ITEM SUCH AS FOUNDATION, CONDUIT, HANDHOLE, TRENCH AND BACKFILL, ETC., AND NO EXTRA COMPENSATION SHALL BE ALLOWED. ALL ROADWAY SURFACES SUCH AS SHOULDERS, MEDIANS, SIDEWALKS, PAVEMENT, ETC. SHALL BE REPLACED IN KIND. ALL DAMAGE TO MOWED LAWNS SHALL BE REPLACED WITH AN APPROVED SOD, AND ALL DAMAGE TO UNMOWED FIELDS SHALL BE SEED IN ACCORDANCE WITH STANDARD SPECIFICATIONS 252 AND 250 RESPECTIVELY.

INTERCONNECT PLAN LEGEND		
	PROPOSED	EXISTING
CONTROLLER		
HANDHOLE		
DOUBLE HANDHOLE		
HEAVY-DUTY HANDHOLE		
G.S. CONDUIT IN TRENCH (T) OR PUSHED (P)		
DETECTOR LOOP		
UNIT DUCT	UD	
SYSTEM	S	
INTERSECTION	IP	I
MAST ARM ASSEMBLY AND POLE, STEEL		

FILE NAME =	USER NAME = .USER	DESIGNED -	REVISED -	STATE OF ILLINOIS DEPARTMENT OF TRANSPORTATION	INTERCONNECT PLAN (SHEET 4 OF 6)	F.A. RTE.	SECTION	COUNTY	TOTAL SHEETS	SHEET NO.
g:\jobs\smith\2007\070690 AURO - Traffic	Signals\070690.01 AURO Galena Blvd Traffic S	DRAWN: d\Tr\B\A\H\l.dwg\690.1.sigint04.dg	REVISED -			05-00257-00-TL	KANE	39	35	
	PLOT SCALE = #SCALE#	CHECKED APS	REVISED -			CONTRACT NO. 63105				
	PLOT DATE = 4/15/2009	DATE -	REVISED -			SCALE:	SHEET NO.	OF SHEETS	STA. TO STA.	FED. ROAD DIST. NO.