

DATE	BY	DATE	BY
DATE	BY	DATE	BY

DATE	BY

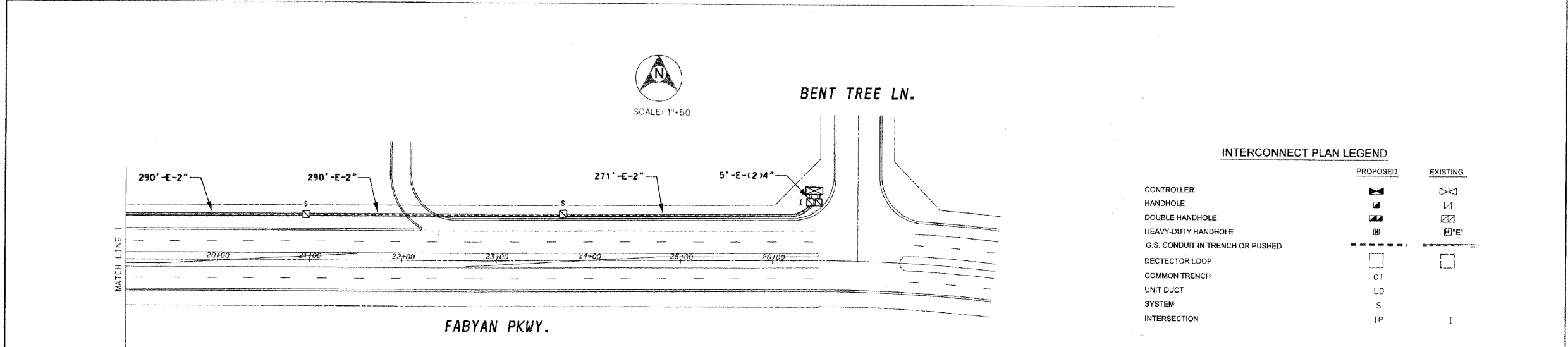
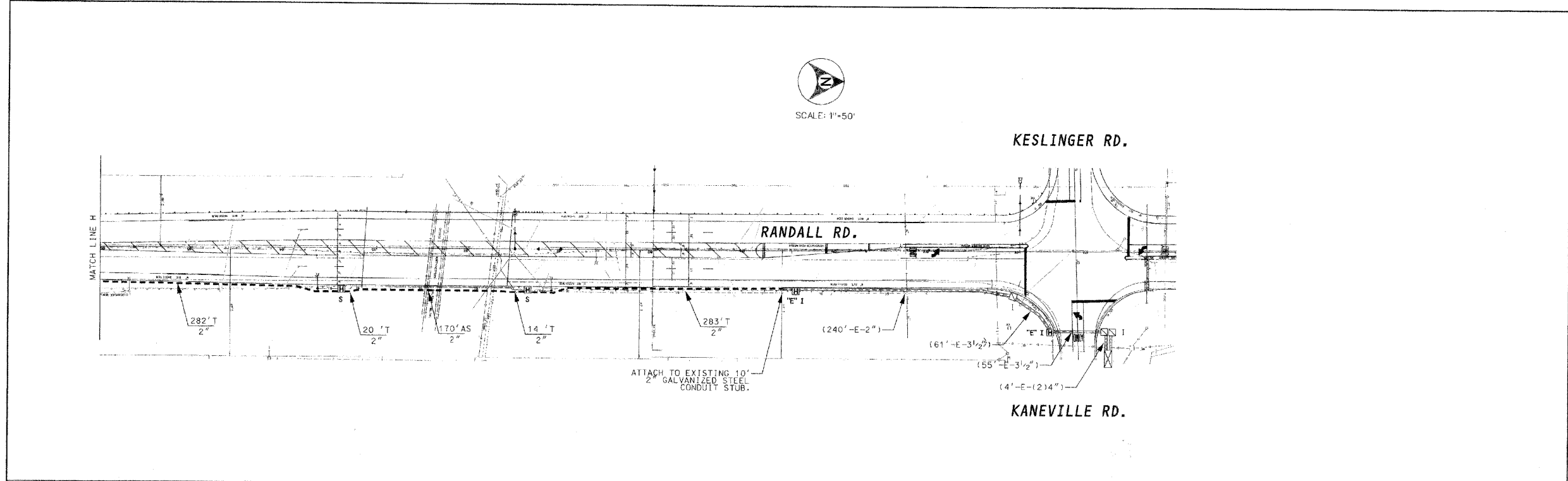

INTERCONNECT PLAN LEGEND

	PROPOSED	EXISTING
CONTROLLER		
HANDHOLE		
DOUBLE HANDHOLE		
HEAVY-DUTY HANDHOLE		
G.S. CONDUIT IN TRENCH OR PUSHED		
DETECTOR LOOP		
COMMON TRENCH	CT	
UNIT DUCT	UD	
SYSTEM	S	
INTERSECTION	IP	I

FOR INFORMATION ONLY

COUNTY SECTION 99-00237-00-TL



METRO TRANSPORTATION GROUP, INC.
 TRANSPORTATION PLANNING, ENGINEERING AND DESIGN
 1300 GREENBROOK, HANOVER PARK, IL 60103 PH# 630 213-1000

REVISIONS	
NO.	DESCRIPTION

INTERCONNECT PLAN
 RANDALL RD. (MAIN ST. TO KESLINGER RD.)
 GENEVA / BATAVIA, ILLINOIS

FILE NAME: 1a-5.dgn	SHEET NO.: 19
DATE: Apr 11 15, 1999	OF 24
PROJECT NO.: 3857-00	

NOTE: RANDALL ROAD INTERCONNECT PLAN FROM MAIN STREET TO KESLINGER ROAD PROVIDED TO SHOW EXISTING CONDUIT ROUTING. PROPOSED WORK INCLUDES FIBER OPTIC CABLE INSTALLATION PER INTERCONNECT SCHEMATIC SHOWN ON SHEET NO. 18.

FILE NAME = **DGN SPEC**	USER NAME = jzvolanek	DESIGNED JOSH ZVOLANEK	REVISIONS -	STATE OF ILLINOIS DEPARTMENT OF TRANSPORTATION	INTERCONNECT PLAN RANDALL ROAD ORCHARD ROAD TO FABYAN PARKWAY	F.A. RTE. 336	SECTION 07-00366-00-TL	COUNTY KANE	TOTAL SHEETS 43	SHEET NO. 17	
	PLOT SCALE =	CHECKED YOUNGJAE JU	REVISIONS -			SCALE:	FED. ROAD DIST. NO.	ILLINOIS	FED. AID PROJECT	CONTRACT NO. 63128	
	PLOT DATE = 11-FEB-2009	DRAWN JOSH ZVOLANEK	REVISIONS -								