

LEGEND:

- PAVEMENT REMOVAL
- DRIVEWAY PAVEMENT REMOVAL
- HMA PATH REMOVAL
- CULVERT/STORM SEWER REMOVAL
- 2" HMA SURFACE REMOVAL
- SIDEWALK REMOVAL
- MAILBOX TO BE RELOCATED
- SIGN TO BE RELOCATED (INC.)
- MANHOLES TO BE ADJUSTED WITH NEW FRAME, LID, & CHIMNEY SEAL

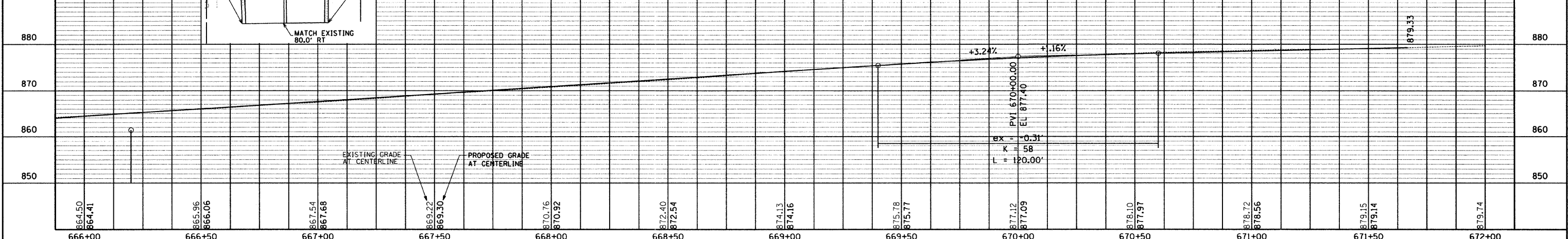
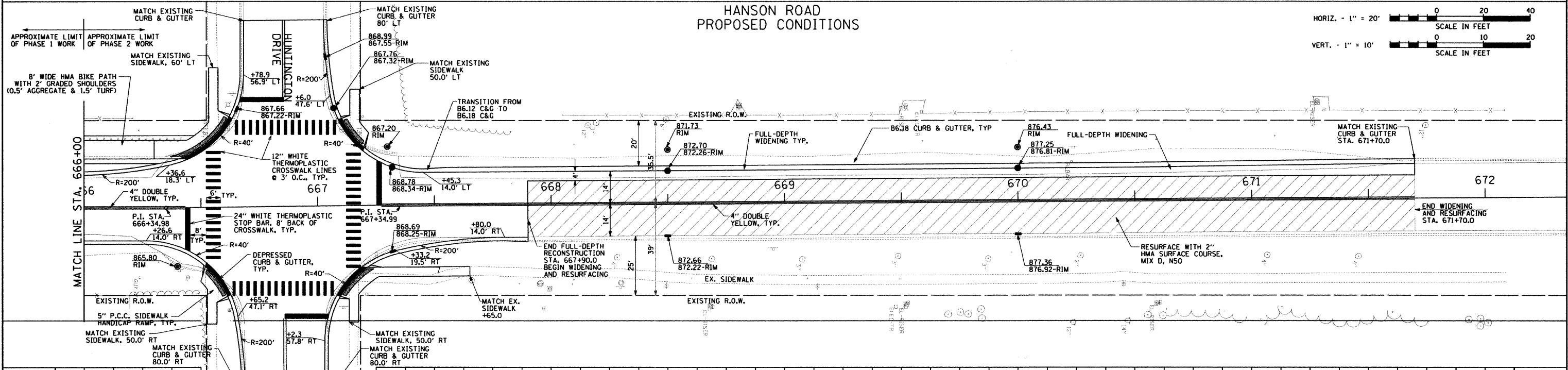
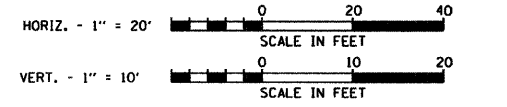

PLAN AND PROFILE HANSON ROAD STA. 666+00 TO STA. 672+00