

| F.A.U. ROUTE             | SECTION        | COUNTY | TOTAL SHEETS | SHEET NO. |
|--------------------------|----------------|--------|--------------|-----------|
| 1441                     | 09-00071-00-RS | KANE   | 20           | 8         |
| STA. 54+00 TO STA. 72+00 |                |        |              |           |
| ROADWAY PLANS            |                |        |              |           |

CONTRACT NO. 63151

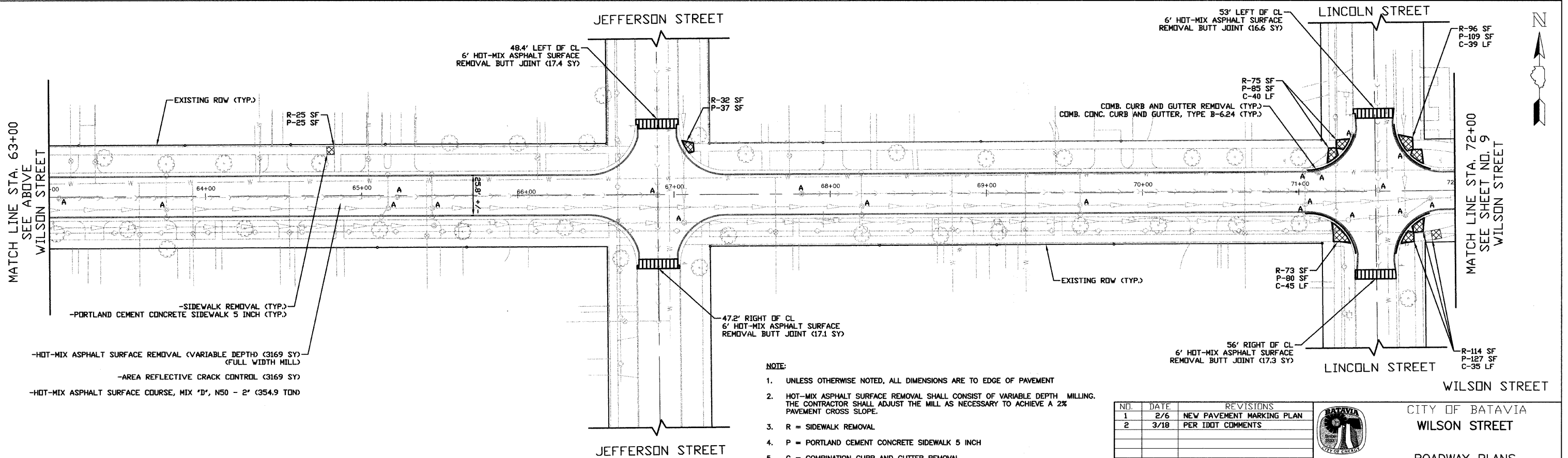
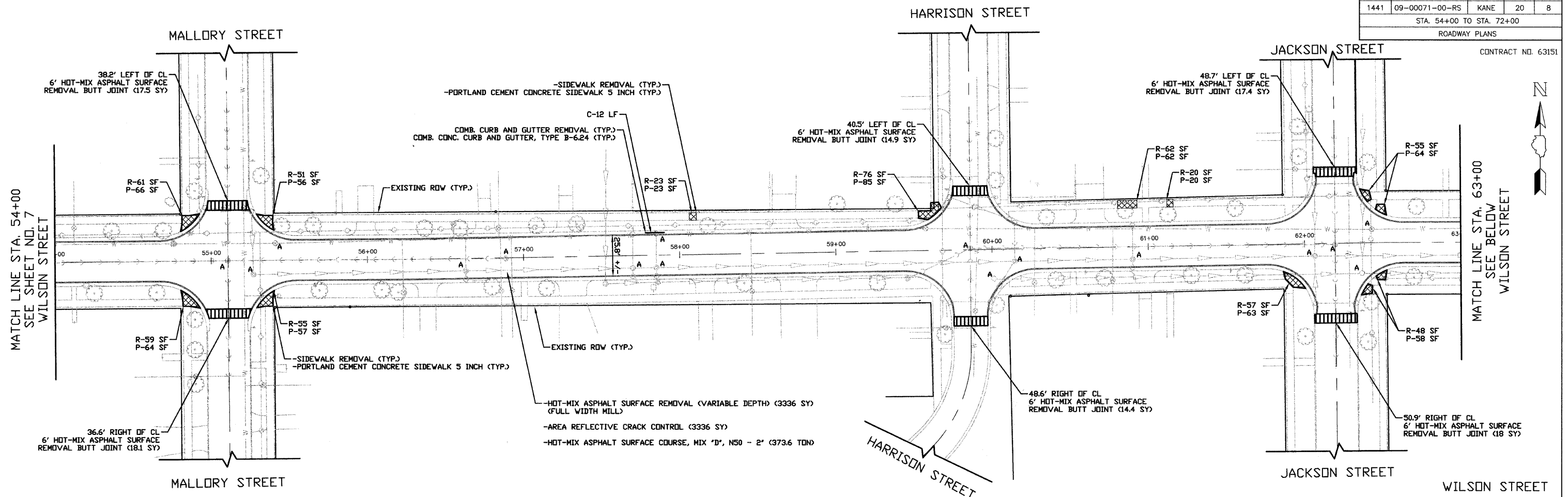

- NOTE:**
- UNLESS OTHERWISE NOTED, ALL DIMENSIONS ARE TO EDGE OF PAVEMENT
  - HOT-MIX ASPHALT SURFACE REMOVAL SHALL CONSIST OF VARIABLE DEPTH MILLING. THE CONTRACTOR SHALL ADJUST THE MILL AS NECESSARY TO ACHIEVE A 2% PAVEMENT CROSS SLOPE.
  - R = SIDEWALK REMOVAL
  - P = PORTLAND CEMENT CONCRETE SIDEWALK 5 INCH
  - C = COMBINATION CURB AND GUTTER REMOVAL  
COMBINATION CONCRETE CURB AND GUTTER, BYPE B-6.12
  - ALL LANDSCAPING RESTORATION IS INCIDENTAL TO THE ITEM BEING REMOVED OR REPLACED.

| NO. | DATE | REVISIONS                 |
|-----|------|---------------------------|
| 1   | 2/6  | NEW PAVEMENT MARKING PLAN |
| 2   | 3/18 | PER IDOT COMMENTS         |
|     |      |                           |
|     |      |                           |
|     |      |                           |



CITY OF BATAVIA  
WILSON STREET

ROADWAY PLANS  
STA. 54+00 TO STA. 72+00

DATE: 4/6/09  
DESIGNED BY: K.R.Y.  
CHECKED BY: N.A.B.

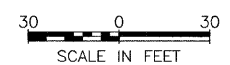

**I.D.O.T. FINAL SUBMITTAL**

.\Streets\STR\_09\_001\_Wilson\_LAPP\cadd\sheet\06\_P\_Wilson.dwg (Layout)  
 PLOTTED: Thursday, 08 Apr 2009 - 5:53pm  
 SAVED: Monday, 06 Apr 2009 - 11:58am