

F.A.P. R.T.E.	SECTION	COUNTY	TOTAL SHEETS	SHEET NO.
2765	08-00088-00-RS	COOK	17	1
FED. ROAD DIST. NO. 1		ILLINOIS		

CONTRACT NO. 63179

STATE OF ILLINOIS DEPARTMENT OF TRANSPORTATION DIVISION OF HIGHWAYS PLANS FOR PROPOSED FEDERAL AID HIGHWAY

LATHROP AVENUE FROM LAKE AVENUE TO NORTH AVENUE

SECTION NO. 08-00088-00-RS PROJECT NO. M-9003 (166) JOB NO. C-91-200-09 VILLAGE OF RIVER FOREST, COOK COUNTY

INDEX OF SHEETS

- 1 COVER SHEET
- 2 LEGEND, SUMMARY OF QUANTITIES AND GENERAL NOTES
- 3 TYPICAL SECTIONS
- 4-11 PLAN SHEETS
- 12-13 PAVEMENT MARKING PLAN
- 14 DETECTOR LOOP LOCATION PLAN
- 15-16 STANDARDS AND DETAILS
- 17 PAVEMENT PATCHING FOR HMA SURFACED PAVEMENT

HIGHWAY STANDARDS

- 000001-05 STANDARD SYMBOLS ABBREVIATIONS AND PATTERNS
- 424001-05 CURB RAMPS FOR SIDEWALKS
- 442201-03 CLASS C AND D PATCHES
- 602001-01 CATCH BASIN - TYPE A
- 602301-02 INLET TYPE A
- 602401-02 MANHOLE - TYPE A
- 604001-03 FRAME AND LIDS TYPE 1
- 606001-04 CONCRETE CURB TYPE B AND COMBINATION CONCRETE CURB AND GUTTER
- 701501-05 URBAN LANE CLOSURE 2L, 2W UNDIVIDED
- 701701-06 URBAN LANE CLOSURE MULTILANE INTERSECTION
- 701801-04 LANE CLOSURE MULTILANE 1W OR 2W CROSSWALK OR SIDEWALK CLOSURE
- 701901-01 TRAFFIC CONTROL DEVICES
- 780001-02 TYPICAL PAVEMENT MARKINGS
- B.L.R. 17-4 TRAFFIC CONTROL DEVICES DAY LABOR CONSTRUCTION
- B.L.R. 22-6 TRAFFIC CONTROL DEVICES CONSTRUCTION ON RURAL OR LOCAL HIGHWAYS

TRAFFIC DATA

LATHROP AVENUE (BEETWEEN LAKE AND DIVISION)
ADT = 8916
YEAR TAKEN = FALL OF 2008
DESIGN DESIGNATION: COLLECTOR STREET

LATHROP AVENUE (BEETWEEN DIVISION AND NORTH)
ADT = 8246
YEAR TAKEN = FALL OF 2008
DESIGN DESIGNATION: COLLECTOR STREET

POSTED SPEED
25 M.P.H.

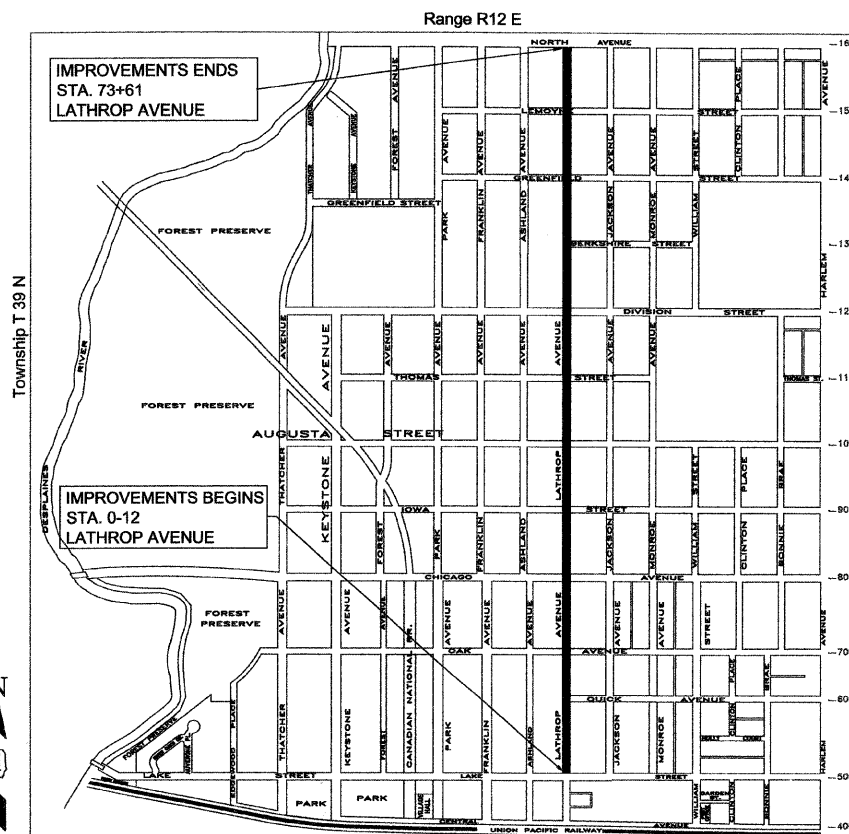
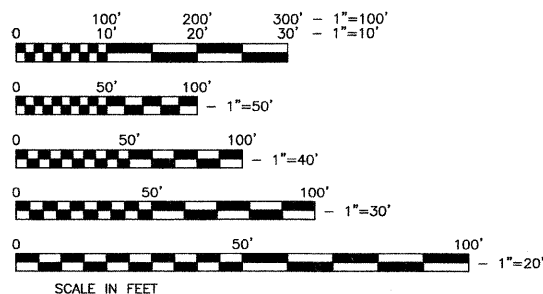

LOCATION MAP
N.T.S.

LENGTH OF IMPROVEMENTS
GROSS PROJECT LENGTH = 7373 FEET = 1.4 MILES
NET PROJECT LENGTH = 7209 FEET

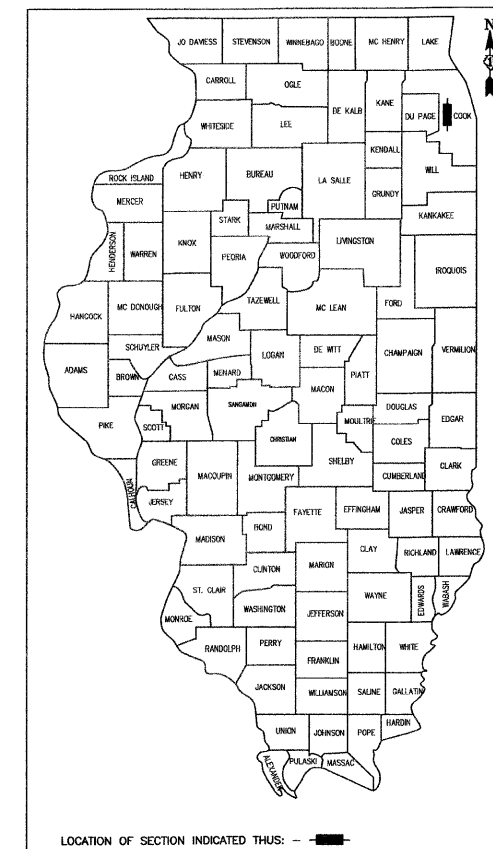

FIELD ENGINEER: MARLIN SOLOMON (847) 705-4407

Gregory W. Kramer
GREGORY W. KRAMER
ILLINOIS REGISTERED PROFESSIONAL ENGINEER
NO. 062-040597 EXPIRATION DATE: 11/30/09

STATE OF ILLINOIS
DEPARTMENT OF TRANSPORTATION
DIVISION OF HIGHWAYS

APPROVED APRIL 16 2009
Gregory W. Kramer GREGORY W. KRAMER
DIRECTOR OF PUBLIC WORKS, VILLAGE OF RIVER FOREST

PASSED APRIL 16 2009
C. Heit CHRISTOPHER HEIT
REGION ONE ENGINEER OF LOCALS ROADS & STREETS

RELEASING FOR
BID BASED ON
LIMITED REVIEW APRIL 16 2009
Diane M. O'Keefe DIANE M. O'KEEFE
DEPUTY DIRECTOR OF HIGHWAYS, REGION ONE ENGINEER

PRINTED BY AUTHORITY OF THE STATE OF ILLINOIS

VILLAGE OF RIVER FOREST
ENGINEERING DEPARTMENT
400 PARK AVE.
RIVER FOREST, IL 60305
(830) 366-8500 FAX (830) 366-3702

SUMMARY OF QUANTITIES - CONSTRUCTION TYPE CODE 1000-2A,
80% FEDERAL, 20% VILLAGE

CODE NO.	ITEM	UNIT	QUANTITY
20800150	TRENCH BACKFILL	CU YD	10.4
21101610	TOPSOIL FURNISH AND PLACE 3"	SQ YD	396.6
25200110	SODDING, SALT TOLERANT	SQ YD	396.6
25200200	SUPPLEMENTAL WATERING	UNIT	30.3
31101000	SUB-BASE GRANULAR MATERIAL, TYPE B	TON	96.2
35300300	PORTLAND CEMENT BASE COURSE 8"	SQ YD	73.6
40600100	BITUMINOUS MATERIALS (PRIME COAT)	GAL	3,679.5
40600300	AGGREGATE (PRIME COAT)	TON	67.0
40600895	CONSTRUCTING TEST STRIP	EACH	2
40600982	HOT-MIX ASPHALT SURFACE REMOVAL - BUTT JOINT	SQ YD	1,529
40603335	HOT-MIX ASPHALT SURFACE COURSE, MIX D, N50	TON	2,923.2
42400200	PORTLAND CEMENT CONCRETE SIDEWALK 5 INCH	SQ FT	918.9
42400800	DETECTABLE WARNINGS	SQ FT	709
44000161	HOT-MIX ASPHALT SURFACE REMOVAL, 3"	SQ YD	24,340.0
44000600	SIDEWALK REMOVAL	SQ FT	1,627.8
44001700	COMBINATION CONCRETE CURB AND GUTTER REMOVAL & REPLACEMENT	FOOT	1,356
550B0030	STORM SEWERS, CLASS B, TYPE 1 8"	FOOT	48
60200105	CATCH BASIN, TYPE A, 4'-DIAMETER, TYPE 1 FRAME, OPEN LID	EACH	5
60220220	MANHOLES, TYPE A, 4'-DIAMETER, WITH SALVAGED FRAME AND LID	EACH	1
60234500	INLETS, TYPE A, TYPE 1 FRAME, OPEN LID (24" DEPTH)	EACH	4
60258200	MANHOLES TO BE RECONSTRUCTED WITH NEW TYPE 1 FRAME, CLOSED LID	EACH	2
60300105	FRAMES AND GRATES TO BE ADJUSTED	EACH	17
60300310	FRAMES AND LIDS TO BE ADJUSTED (SPECIAL)	EACH	59
60406000	FRAMES AND LIDS, TYPE 1, OPEN LID	EACH	4
60406100	FRAMES AND LIDS, TYPE 1, CLOSED LID	EACH	4
67100100	MOBILIZATION	L SUM	1
70102620	TRAFFIC CONTROL AND PROTECTION, STANDARD 701501	L Sum	1
70102635	TRAFFIC CONTROL AND PROTECTION, STANDARD 701701	L Sum	1
70102640	TRAFFIC CONTROL AND PROTECTION, STANDARD 701801	L Sum	1
70300220	TEMPORARY PAVEMENT MARKING - LINE 4"	FOOT	5,448
*78000100	THERMOPLASTIC PAVEMENT MARKING - LETTERS AND SYMBOLS	SQ FT	294
*78000200	THERMOPLASTIC PAVEMENT MARKING - LINE 4"	FOOT	4,393
*78000400	THERMOPLASTIC PAVEMENT MARKING - LINE 6"	FOOT	1,055
*78000600	THERMOPLASTIC PAVEMENT MARKING - LINE 12"	FOOT	552
*78000650	THERMOPLASTIC PAVEMENT MARKING - LINE 24"	FOOT	247
*88600600	DETECTOR LOOP REPLACEMENT	FOOT	546
X4067107	POLYMERIZED LEVELING BINDER (MACHINE METHOD), IL-4.75, N50	TON	1,461.6
XX006392	CLASS D PATCHES, 6" (SPECIAL)	SQ YD	1,226.5
Z0019600	DUST CONTROL WATERING	UNIT	81
Z0062000	SAW CUTTING	FOOT	1,356
▲ Z0076600	TRAINEES	HOUR	500

* INDICATES SPECIALITY ITEMS

▲ Y080

<p>EXISTING</p>	<p>LEGEND</p>	<p>PROPOSED</p>
------------------------	----------------------	------------------------

Plan Notes

- Pipe Connection to Manholes** - A structural grade concrete or grout with minimum 28 day compressive strength of 3,000 psi shall be used. Existing reinforcement shall be bent into new concrete. The surface of the exposed concrete shall be sound, free from loose debris, brushed and coated with suitable bonding compound.
- Top of Curb Elevations** - Before setting the top of curb elevations, the engineer shall check the existing elevations at the adjacent property line, and if necessary, the Contractor is required to vary the curb exposure and/or gutter elevations in order to more closely follow the proper line grades. The proposed curb exposure shall vary in height from 6 inches (MAX.) to 4 inches (MIN.)
- Earth Excavations** - Except as noted in the special provisions, earth excavation which is necessary for the construction of proposed combination concrete curb and gutter, driveway pavement, sidewalk, street return radius and alley return adjustments shall be considered incidental to their respective pay items of removal and no additional compensation will be paid.
- Street Returns** - A 20 feet radius shall be used on all intersecting street returns unless indicated otherwise.
- Existing Utilities** - Contractor must notify companies for locations prior to commencement of work. Existing utilities shall be maintained in service at all times. Utilities and obstructions shown on the plans were derived from the best possible information through contacts made with various utilities and agencies known to have structures in the area. The location, material and dimensions of existing obstructions are based upon available records, and are shown on the plans and profile strictly as an aid to the Contractor, but must not be construed as being accurate, correct or complete. All structures above and below ground that are encountered during construction shall be properly supported and maintained. The Contractor shall make all arrangements with the Owner of such structures for shifting, support, temporary relocation and for protection where necessary. If damaged during construction, the Contractor shall make or pay to have made all repairs to the structure to the satisfaction of the Owner of the structure. No extra payment shall be made for such interferences or obstructions.
- Utility locations:** The Contractor shall contact Julie (800) 892-0123, and the Village of River Forest Department of Public Works (708) 366-8500 for utility locations prior to commencing construction. A joint July locate meeting is required. The Contractor shall notify all utility companies prior to construction to verify in the field all existing utilities and shall be responsible for protection of same. Contractor must exercise caution while working around existing utilities and existing trees in the area.
- Access/Resident Control:** The Contractor shall not close any street or private driveway without consent of the Engineer, and the proper notification of the affected resident(s) in the event the Engineer deems it necessary to close any driveways or streets, the Engineer shall made the necessary arrangements with the property owners, Police Department (708) 366-7125, and Fire Department (708) 366-7629.
- Use of fire hydrant:** No fire hydrant shall be used to obtain water unless a hydrant use permit is obtained. Permit application can be obtained at the Village of River Forest, Department of Public Works, 400 Park Avenue, River Forest, Illinois 60305 (708-366-8500).
- Notification of Work:** The Contractor shall notify the Village of River Forest at least 48 hours prior to initial start of operations, and also prior to any temporary cessation and resumption of operations, and 24 hours prior to each inspection at (708-366-8500).
- Service connections for existing utilities** (gas, water and sanitary sewer) are not shown on the drawings. Contractor shall assume service connections cross street opposite from utility location indicated on drawings and shall take care not to disturb them.
- Utility service** (i.e., combined sewer, storm sewer, water main, gas, telephone, electric cable TV) are generally shown on the drawings but may not be complete. Contractor shall maintain all utility services and repair any damage resulting from construction operations.

REVISIONS					
DATE	BY	DESCRIPTION	DATE	BY	DESCRIPTION

DESIGNED: GC
 DRAFTED: GC
 CHECKED: GWK
 APPROVED: GWK DATE: 11/17/08



TITLE:
 LATHROP AVENUE
 RESURFACING IMPROVEMENTS
 LEGEND, SUMMARY OF QUANTITIES AND GENERAL NOTES
 SECTION NO: 08-00088-00-RS



SCALE:	NONE
DATE:	11/17/2008
PROJ. NO.:	4065
SHEET:	2 OF 17

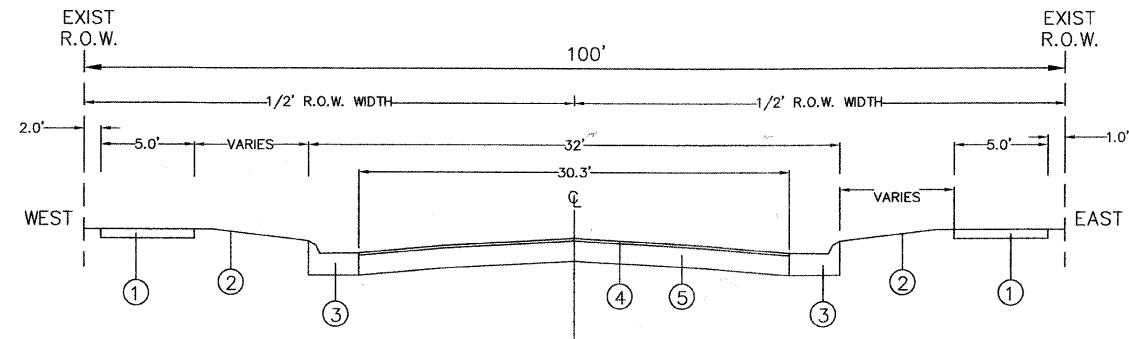

**LATHROP AVENUE
EXISTING TYPICAL SECTION**
NOT TO SCALE

LEGEND

1. EXISTING P.C.C. SIDEWALK
2. EXISTING PARKWAY
3. EXISTING COMBINATION CONCRETE CURB AND GUTTER B-6.12
4. EXISTING HOT MIX ASPHALT SURFACE COURSE VARIABLE THICKNESS. REMOVE EXISTING HOT-MIX ASPHALT SURFACE 3.0 INCHES
5. EXISTING PCC BASE COURSE.
6. PROPOSED TOPSOIL PLACEMENT AND SODDING AT LOCATIONS C&G REPLACEMENT
7. PROPOSED SUB-BASE GRANULAR MATERIAL TYPE B
8. PROPOSED COMBINATION CONCRETE CURB AND GUTTER, TYPE B-6.12 (MODIFIED) AT DESIGNATED LOCATION BY ENGINEER
9. PROPOSED POLYMERIZED LEVELING BINDER (mm) IL-4.75, N50, 1". (SEE ENLARGED DETAIL 1)
10. PROPOSED HOT-MIX ASPHALT SURFACE COURSE, MIX "D", N50, 2". (SEE ENLARGED DETAIL 1)
11. PROPOSED PCC BASE COURSE 8", WIDTH AS REQUIRED (INCIDENTAL TO COMB. CURB AND GUTTER)
12. PROPOSED BITUMINOUS MATERIALS (PRIME COAT)
13. PROPOSED CLASS D PATCHES, 6 INCHES (SPECIAL)

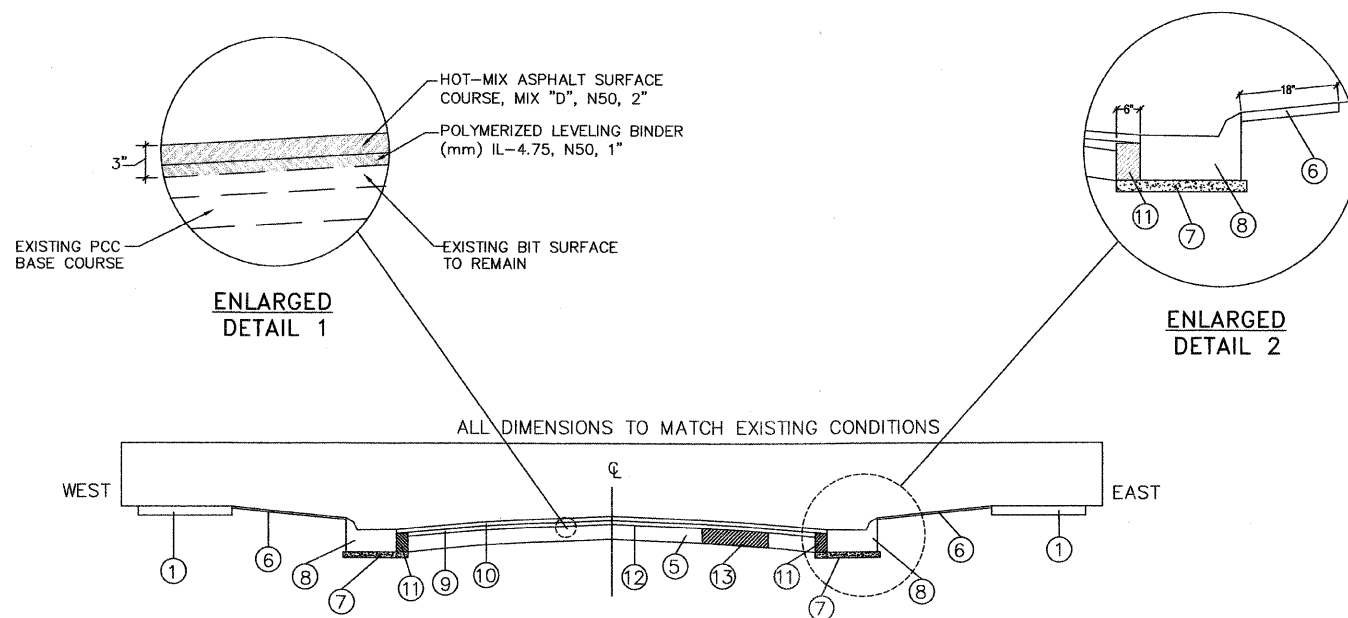

**LATHROP AVENUE
PROPOSED TYPICAL SECTION**
NOT TO SCALE

HOT MIX ASPHALT MIXTURE REQUIREMENTS		
ITEM	AC TYPE	VOIDS
HOT MIX ASPHALT SURFACE COURSE, MIX D, N50, IL-9.5 MM	PG 64-22	4% @ 50 GYR
POLYMERIZED LEVELING BINDER (MACHINE METHOD), IL-4.75, N50	SBS/SBR PG 76-28/22	4% @ 50 GYR
CLASS D PATCHES, 6 INCHES (SPECIAL) BINDER IL-19 MM	PG 64-22 *	4% @ 70 GYR

NOTES:
 THE UNIT WEIGHT USED TO CALCULATE ALL HOT-MIX ASPHALT (HMA) SURFACE MIXTURE QUANTITIES IS 112 LBS/SQYD/IN.
 * WHEN RAP EXCEEDS 20%, THE NEW ASPHALT BINDER IN THE MIX SHALL BE PG 58-22.

REVISIONS							
DATE	BY	DESCRIPTION	DATE	BY	DESCRIPTION	DATE	BY

DESIGNED: GC
DRAFTED: GC
CHECKED: GWK
APPROVED: GWK DATE: 11/17/08

**VILLAGE OF RIVER FOREST
ENGINEERING DEPARTMENT
400 PARK AVE.
RIVER FOREST, IL 60305
(708) 366-8500**

TITLE:
LATHROP AVENUE
RESURFACING IMPROVEMENTS
TYPICAL SECTIONS
SECTION NO: 08-00088-00-RS



SCALE: NONE
DATE: 11/17/2008
PROJ. NO: 4065
SHEET: 3 OF 17

F.A.P. RTE.	SECTION	COUNTY	TOTAL SHEETS	SHEET NO.
2765	08-00088-00-RS	COOK	17	4
FED. ROAD DIST. NO. 1		ILLINOIS		

CONTRACT NO. 63179

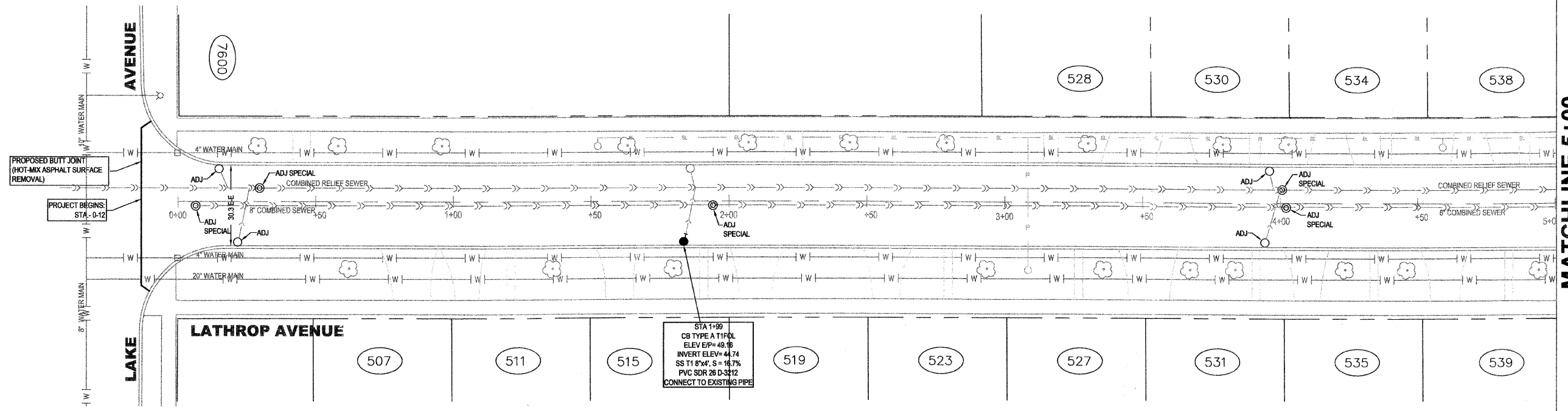
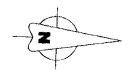

MATCHLINE 5+00

MATCHLINE 5+00

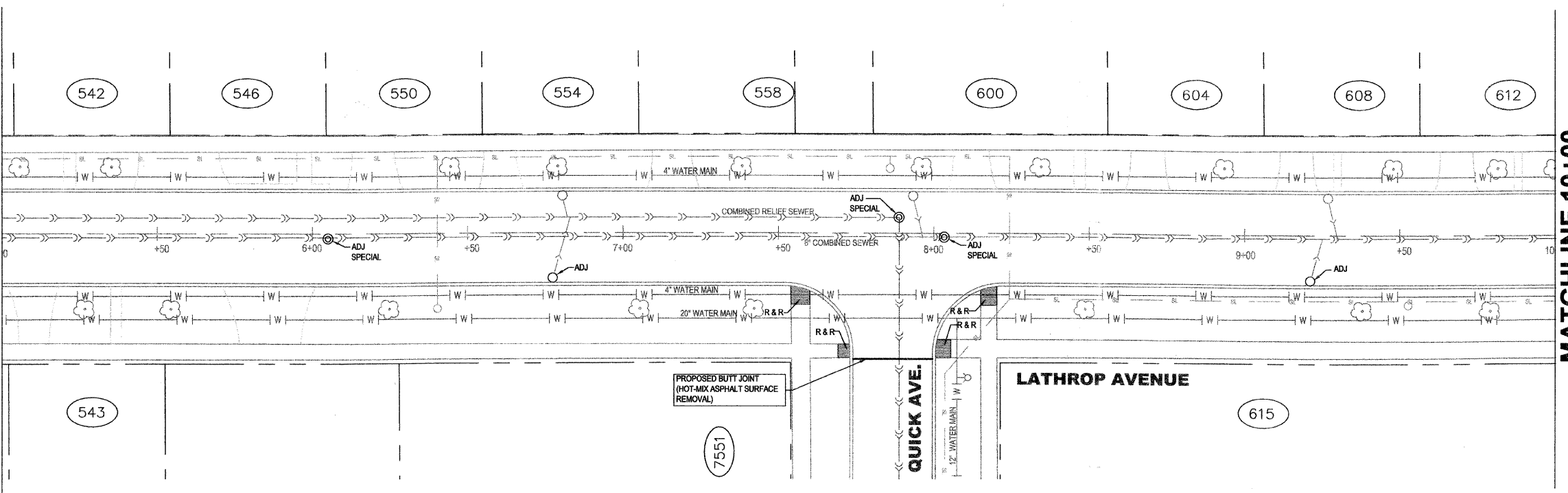

MATCHLINE 10+00

REVISIONS					
DATE	BY	DESCRIPTION	DATE	BY	DESCRIPTION

DESIGNED:	GC
DRAFTED:	GC
CHECKED:	GWK
APPROVED:	GWK DATE: 11/17/08

VILLAGE OF RIVER FOREST
ENGINEERING DEPARTMENT
400 PARK AVE.
RIVER FOREST, IL 60305
(708) 366-8500

TITLE:
 LATHROP AVENUE
 RESURFACING IMPROVEMENTS
 PLANS
 SECTION NO: 08-00088-00-RS



SCALE:	1" = 20'
DATE:	11/17/2008
PROJ. NO.:	4065
SHEET:	4 of 17

F.A.P. RTE.	SECTION	COUNTY	TOTAL SHEETS	SHEET NO.
2765	08-00088-00-RS	COOK	17	5
FED. ROAD DIST. NO. 1		ILLINOIS		

CONTRACT NO. 63179

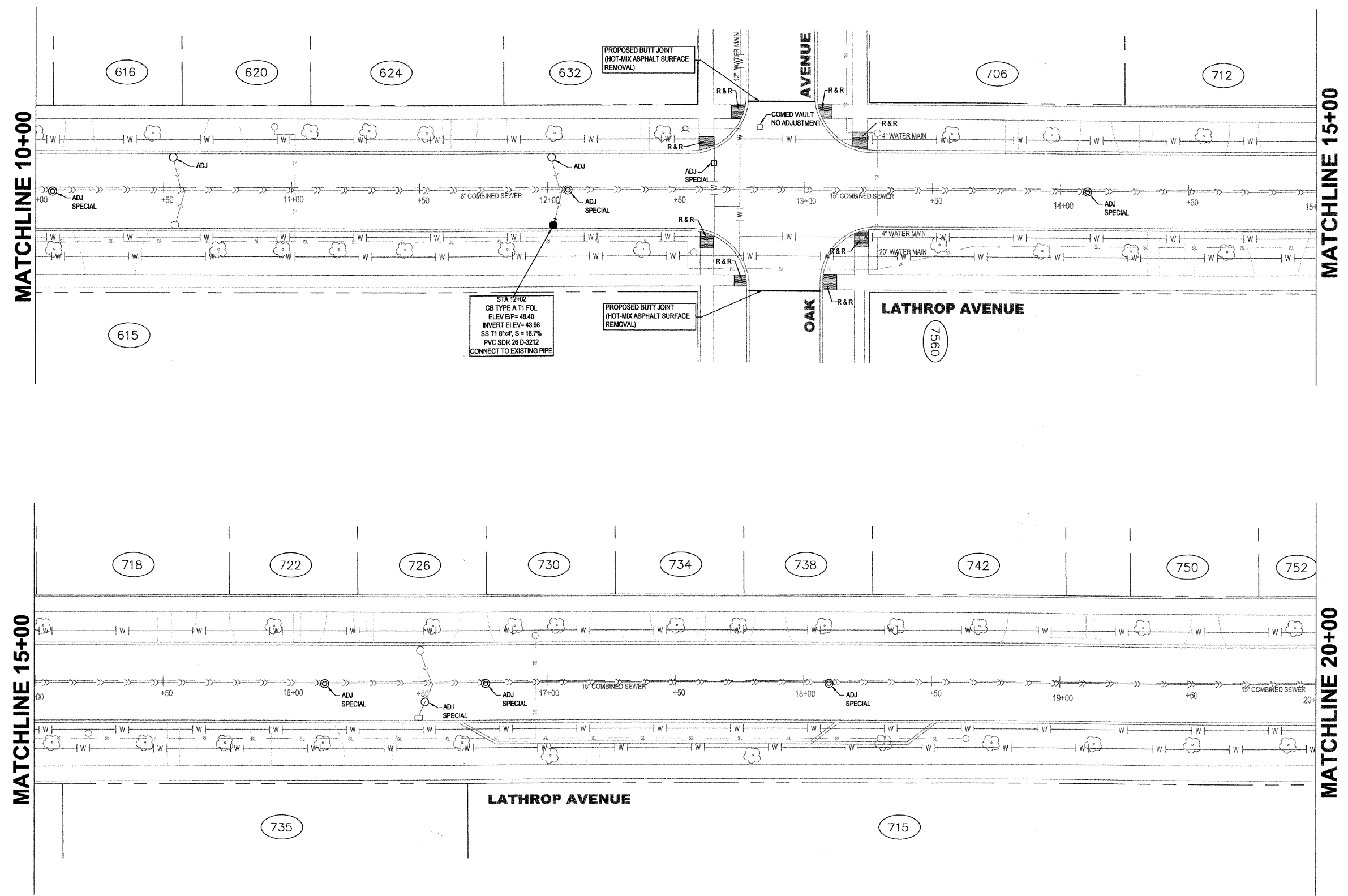

STA 12+02
 CB TYPE A T1 FOL
 ELEV E/P= 48.40
 INVERT ELEV= 43.98
 SS T1 8\"/>

PROPOSED BUTT JOINT
 (HOT-MIX ASPHALT SURFACE
 REMOVAL)

REVISIONS					
DATE	BY	DESCRIPTION	DATE	BY	DESCRIPTION

DESIGNED: GC
DRAWN: GC
CHECKED: GWK
APPROVED: GWK DATE: 11/17/08

VILLAGE OF RIVER FOREST
 ENGINEERING DEPARTMENT
 400 PARK AVE.
 RIVER FOREST, IL 60305
 (708) 366-8500

TITLE:
 LATHROP AVENUE
 RESURFACING IMPROVEMENTS
 PLANS
 SECTION NO: 08-00088-00-RS

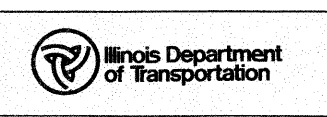

SCALE: 1" = 20'
DATE: 11/17/2008
PROJ. NO: 4065
SHEET: 5 OF 17

F.A.P. RTE.	SECTION	COUNTY	TOTAL SHEETS	SHEET NO.
2765	08-00088-00-RS	COOK	17	6
FED. ROAD DIST. NO. 1		ILLINOIS		

CONTRACT NO. 63179

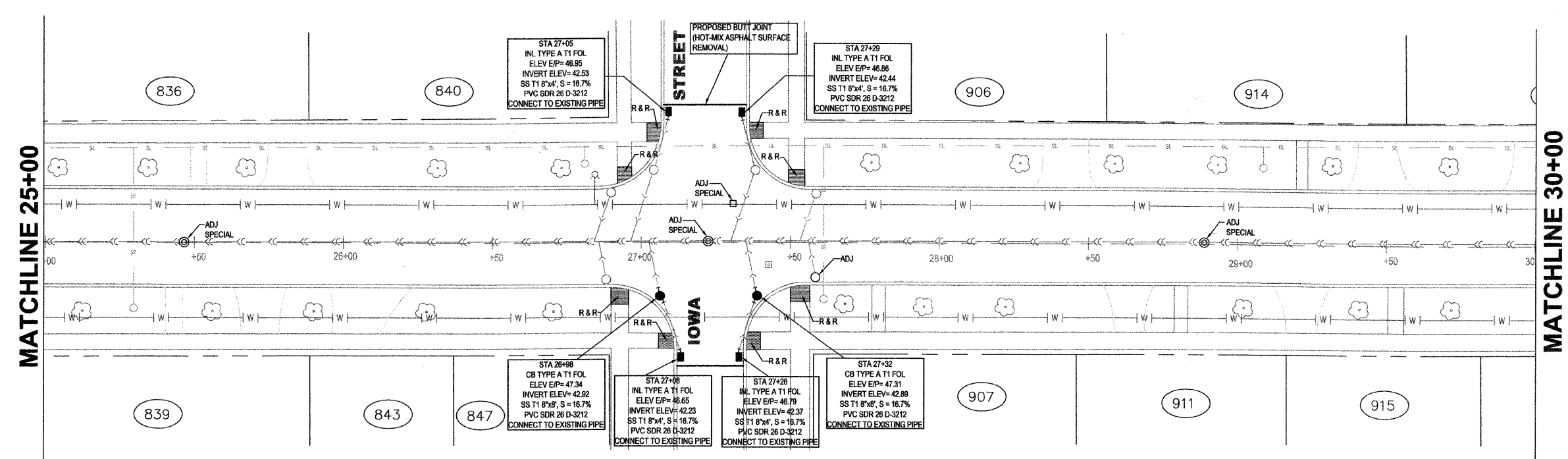
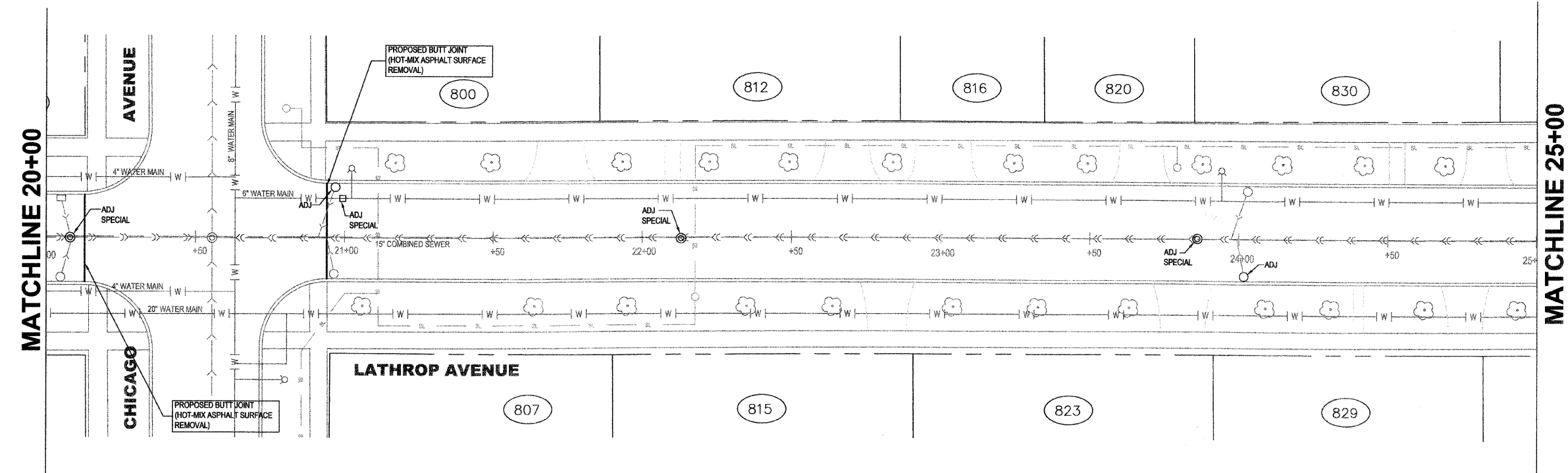

REVISIONS					
DATE	BY	DESCRIPTION	DATE	BY	DESCRIPTION

DESIGNED: GC
DRAFTED: GC
CHECKED: GWK
APPROVED: GWK DATE: 11/17/08



TITLE:
LATHROP AVENUE
RESURFACING IMPROVEMENTS
PLANS
SECTION NO: 08-00088-00-RS



SCALE: 1" = 20'
DATE: 11/17/2008
PROJ. NO: 4065
SHEET: 6 OF 17



F.A.P. RTE.	SECTION	COUNTY	TOTAL SHEETS	SHEET NO.
2765	08-00088-00-RS	COOK	17	7
FED. ROAD DIST. NO. 1		ILLINOIS		

CONTRACT NO. 63179

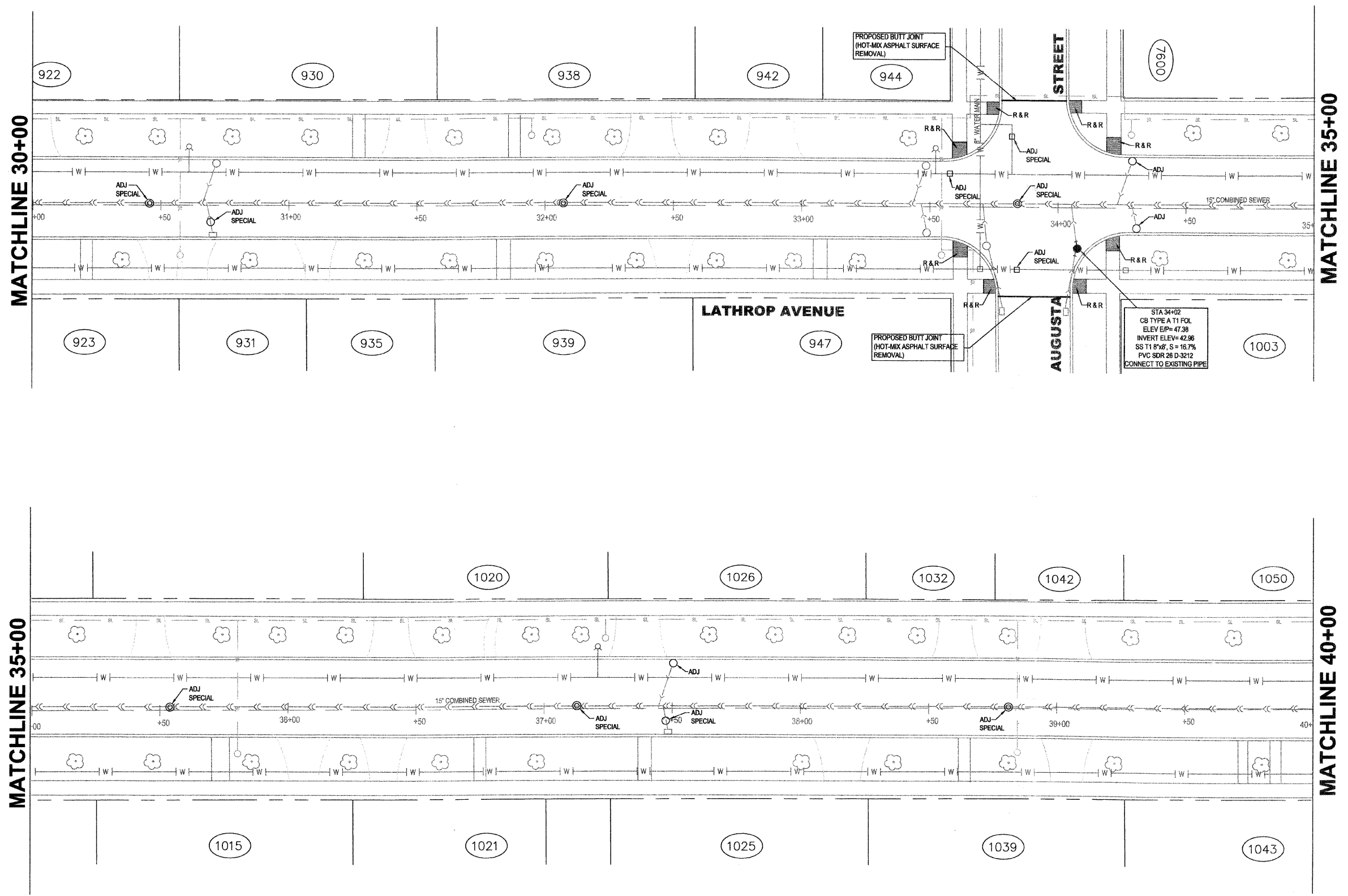

REVISIONS					
DATE	BY	DESCRIPTION	DATE	BY	DESCRIPTION

DESIGNED: GC
DRAFTED: GC
CHECKED: GWK
APPROVED: GWK DATE: 11/17/08



**VILLAGE OF RIVER FOREST
ENGINEERING DEPARTMENT**
400 PARK AVE.
RIVER FOREST, IL 60305
(708) 366-8500

TITLE:
LATHROP AVENUE
RESURFACING IMPROVEMENTS
PLANS
SECTION NO: 08-00088-00-RS



SCALE: 1"=20'
DATE: 11/17/2008
PROJ. NO: 4065
SHEET: 7 of 17

F.A.P. RTE.	SECTION	COUNTY	TOTAL SHEETS	SHEET NO.
2765	08-00088-00-RS	COOK	17	8
FED. ROAD DIST. NO. 1		ILLINOIS		

CONTRACT NO. 63179

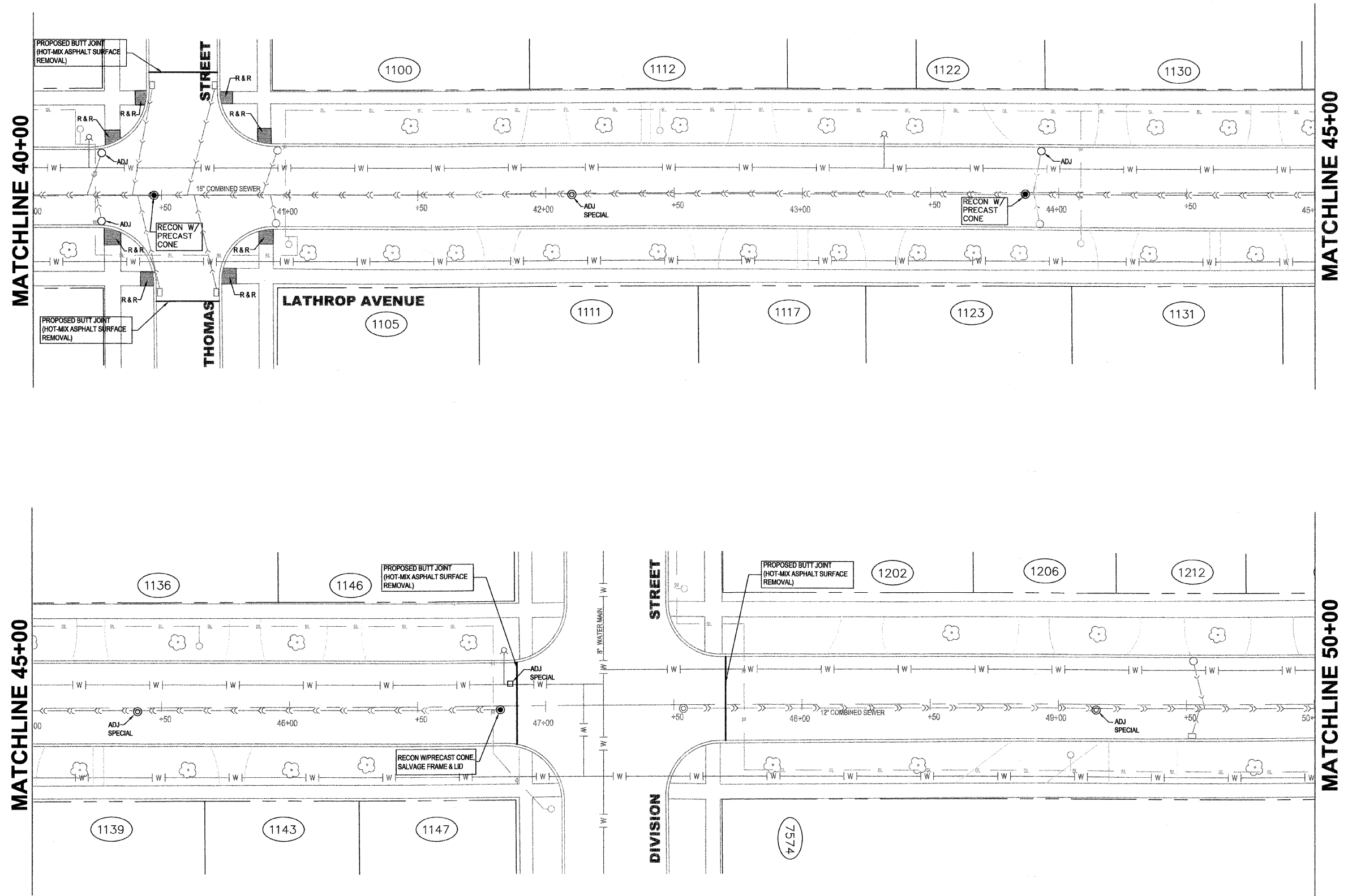
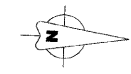

REVISIONS					
DATE	BY	DESCRIPTION	DATE	BY	DESCRIPTION

DESIGNED: GC
DRAFTED: GC
CHECKED: GWK
APPROVED: GWK DATE: 11/7/08



VILLAGE OF RIVER FOREST
ENGINEERING DEPARTMENT
 400 PARK AVE.
 RIVER FOREST, IL 60305
 (708) 366-8500

TITLE:
 LATHROP AVENUE
 RESURFACING IMPROVEMENTS
 PLANS
 SECTION NO: 08-00088-00-RS



SCALE: 1"=20'
DATE: 11/17/2008
PROJ. NO: 4065
SHEET: 8 of 17



F.A.P. RTE.	SECTION	COUNTY	TOTAL SHEETS	SHEET NO.
2765	08-00088-00-RS	COOK	17	9
FED. ROAD DIST. NO. 1		ILLINOIS		

CONTRACT NO. 63179

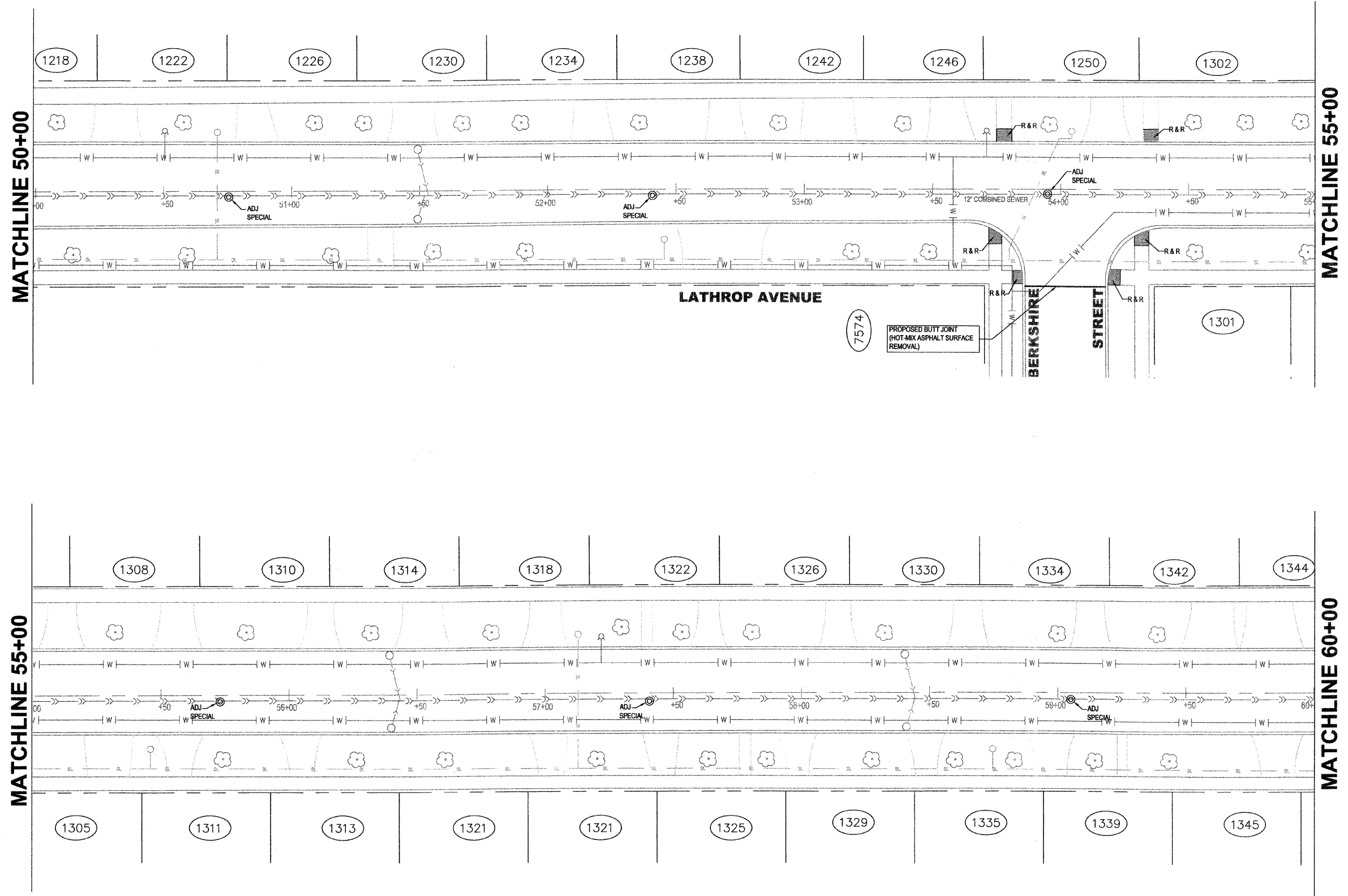

REVISIONS					
DATE	BY	DESCRIPTION	DATE	BY	DESCRIPTION

DESIGNED:	GC
DRAFTED:	GC
CHECKED:	GWK
APPROVED:	GWK DATE: 11/17/08



VILLAGE OF RIVER FOREST
ENGINEERING DEPARTMENT
 400 PARK AVE.
 RIVER FOREST, IL 60305
 (708) 366-8500

TITLE:
 LATHROP AVENUE
 RESURFACING IMPROVEMENTS
 PLANS
 SECTION NO: 08-00088-00-RS



SCALE:	1" = 20'
DATE:	11/17/2008
PROJ. NO:	4065
SHEET:	9 of 17

F.A.P. RTE.	SECTION	COUNTY	TOTAL SHEETS	SHEET NO.
2765	08-00088-00-RS	COOK	17	10
FED. ROAD DIST. NO. 1		ILLINOIS		

CONTRACT NO. 63179

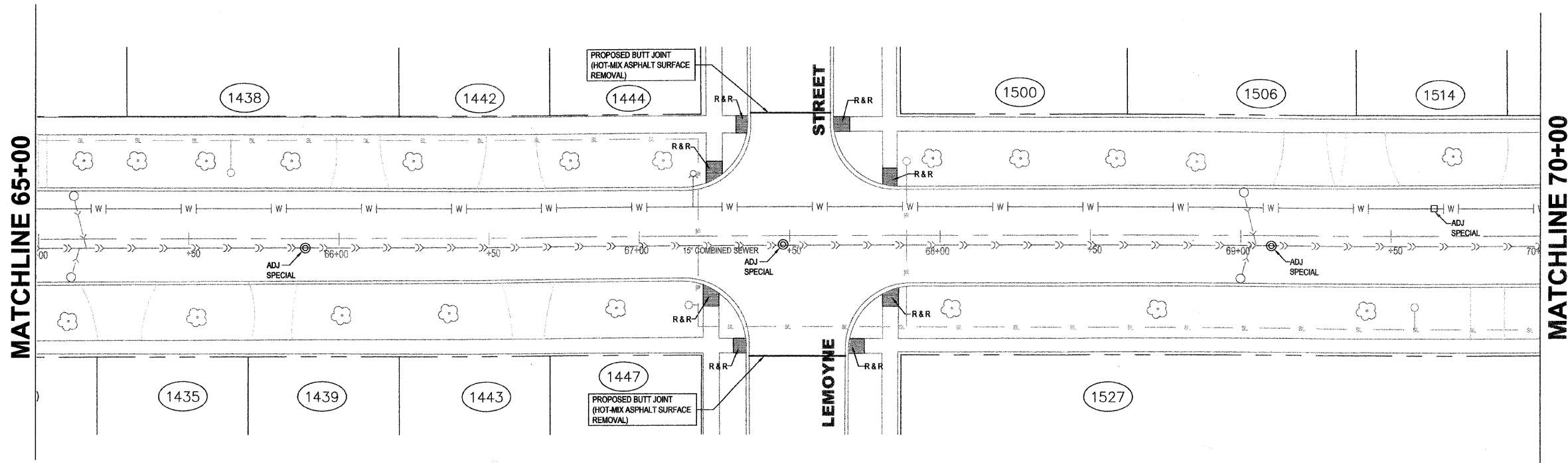
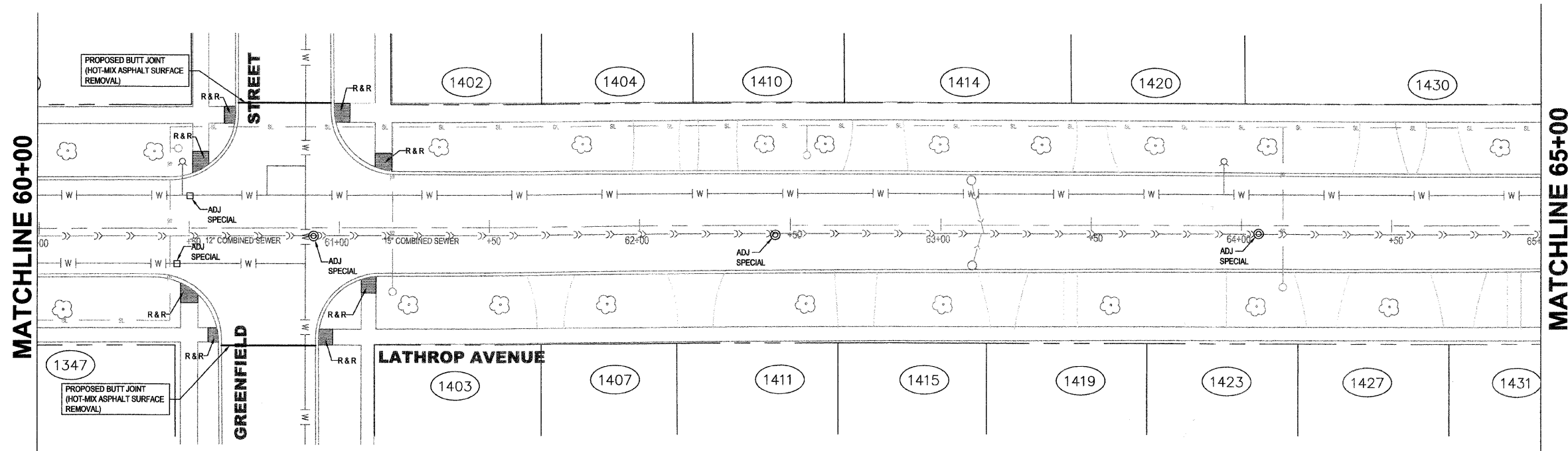

REVISIONS					
DATE	BY	DESCRIPTION	DATE	BY	DESCRIPTION

DESIGNED: GC
DRAFTED: GC
CHECKED: GWK
APPROVED: GWK DATE: 11/17/08



VILLAGE OF RIVER FOREST
ENGINEERING DEPARTMENT
400 PARK AVE.
RIVER FOREST, IL 60305
(708) 366-8500

TITLE:
LATHROP AVENUE
RESURFACING IMPROVEMENTS
PLANS
 SECTION NO: 08-00088-00-RS



Illinois Department
of Transportation

SCALE: 1"=20'
DATE: 11/17/2008
PROJ. NO: 4065
SHEET: 10 of 17

F.A.P. RTE.	SECTION	COUNTY	TOTAL SHEETS	SHEET NO.
2765	08-00088-00-RS	COOK	17	11
FED. ROAD DIST. NO. 1		ILLINOIS		

CONTRACT NO. 63179

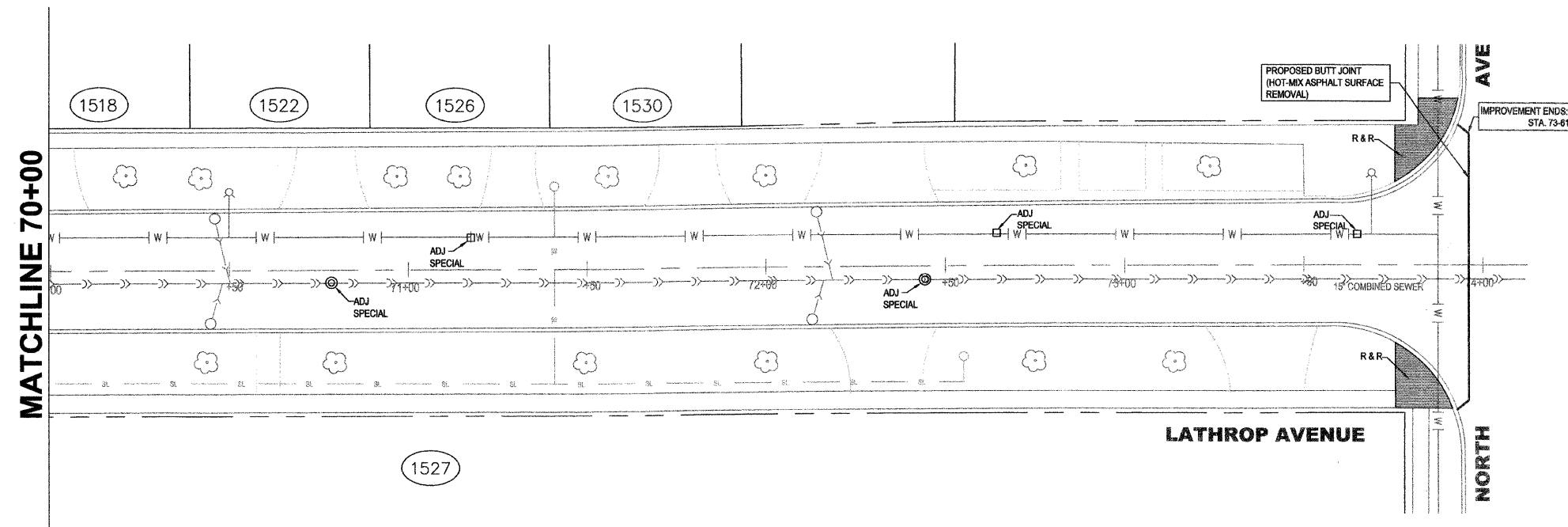

REVISIONS								
DATE	BY	DESCRIPTION	DATE	BY	DESCRIPTION	DATE	BY	DESCRIPTION

DESIGNED:	GC
DRAFTED:	GC
CHECKED:	GWK
APPROVED:	GWK
DATE:	11/17/08



**VILLAGE OF RIVER FOREST
ENGINEERING DEPARTMENT
400 PARK AVE.
RIVER FOREST, IL 60305
(708) 366-8500**

TITLE:
LATHROP AVENUE
RESURFACING IMPROVEMENTS
PLANS
SECTION NO: 08-00088-00-RS



SCALE:	1" = 20'
DATE:	11/17/2008
PROJ. NO.:	4065
SHEET:	11 of 17

F.A.P. RTE.	SECTION	COUNTY	TOTAL SHEETS	SHEET NO.
2765	08-00088-00-RS	COOK	17	12
FED. ROAD DIST. NO. 1		ILLINOIS		

CONTRACT NO. 63179

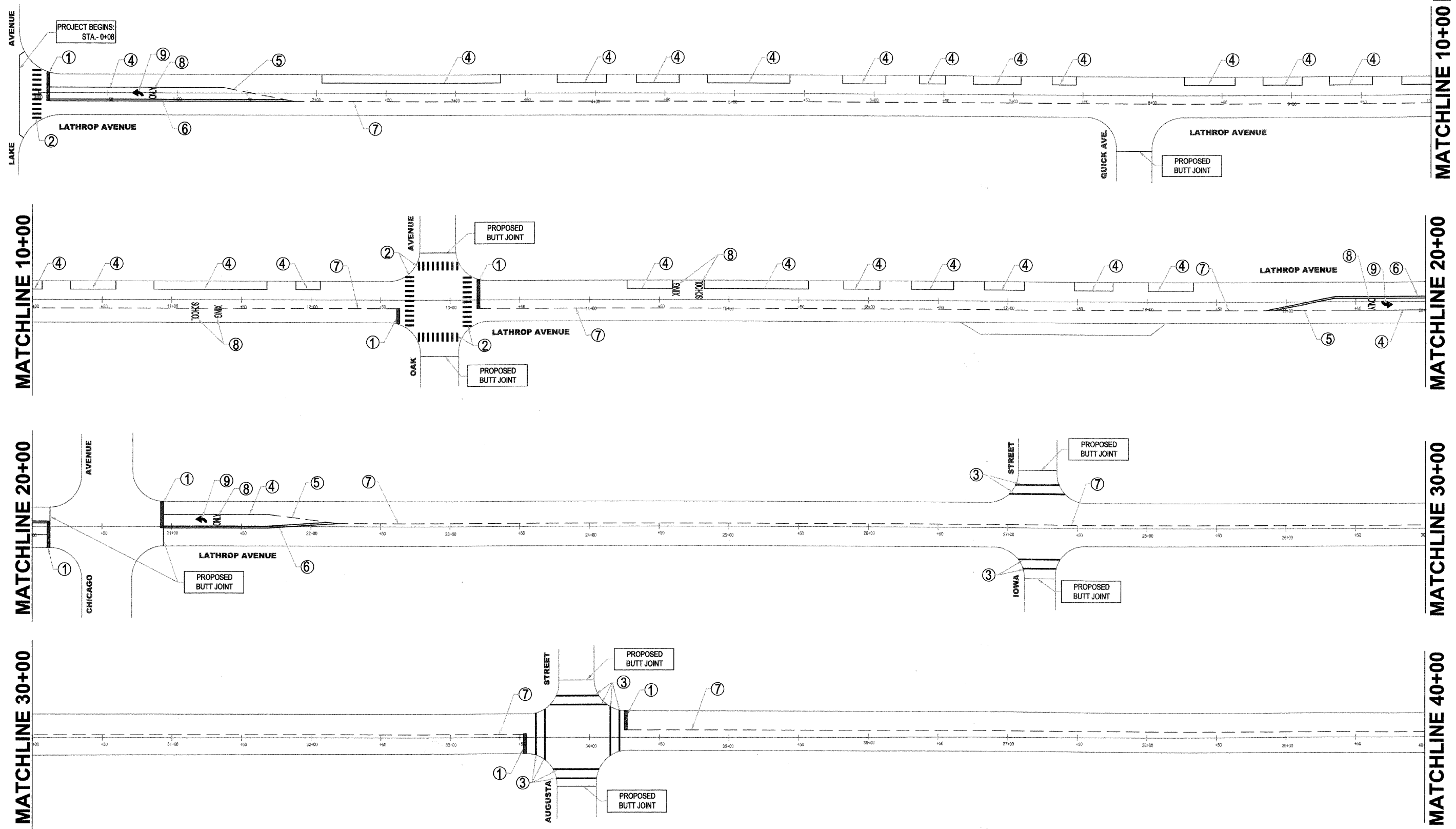

REVISIONS					
DATE	BY	DESCRIPTION	DATE	BY	DESCRIPTION

DESIGNED: GC
DRAWN: GC
CHECKED: GWK
APPROVED: GWK DATE: 11/17/08



TITLE:
LATHROP AVENUE
RESURFACING IMPROVEMENTS
PAVEMENT MARKING PLAN
SECTION NO: 08-00088-00-RS



SCALE: 1" = 50'
DATE: 11/17/2008
PROJ. NO: 4065
SHEET: 12 of 17

F.A.P. RTE.	SECTION	COUNTY	TOTAL SHEETS	SHEET NO.
2765	08-00088-00-RS	COOK	17	13
FED. ROAD DIST. NO. 1		ILLINOIS		

CONTRACT NO. 63179

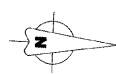

MATCHLINE 40+00

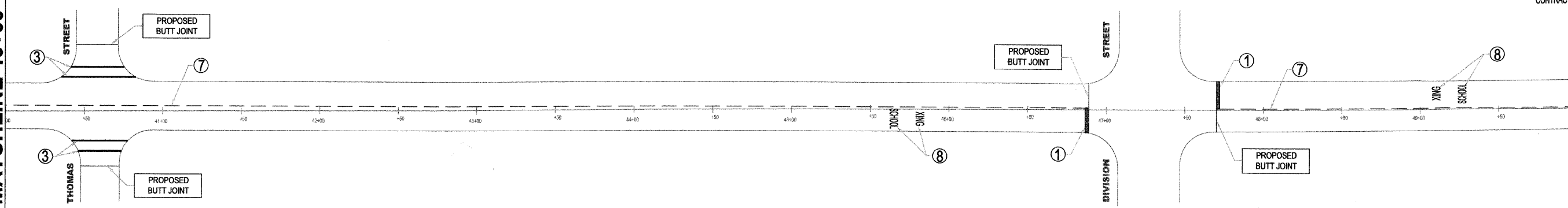

MATCHLINE 50+00

MATCHLINE 50+00

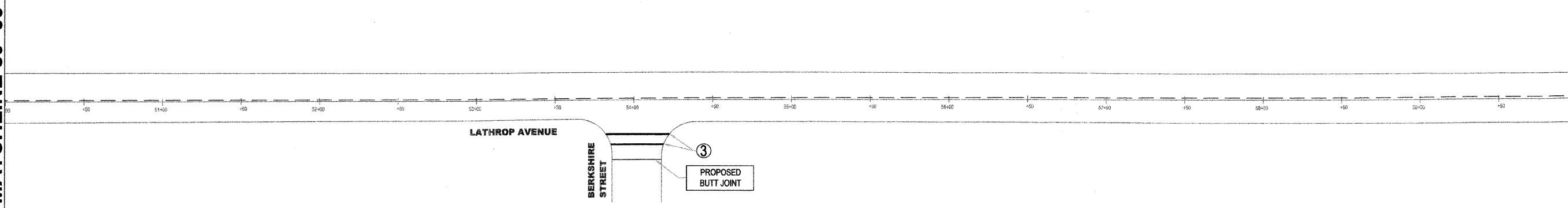

MATCHLINE 60+00

MATCHLINE 60+00

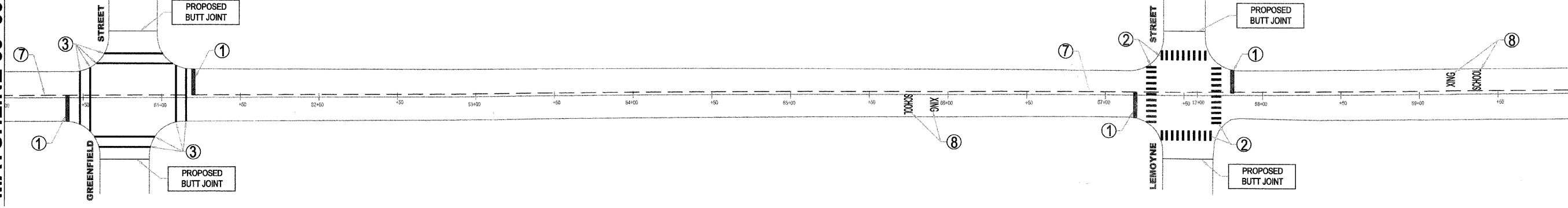

MATCHLINE 70+00

MATCHLINE 70+00

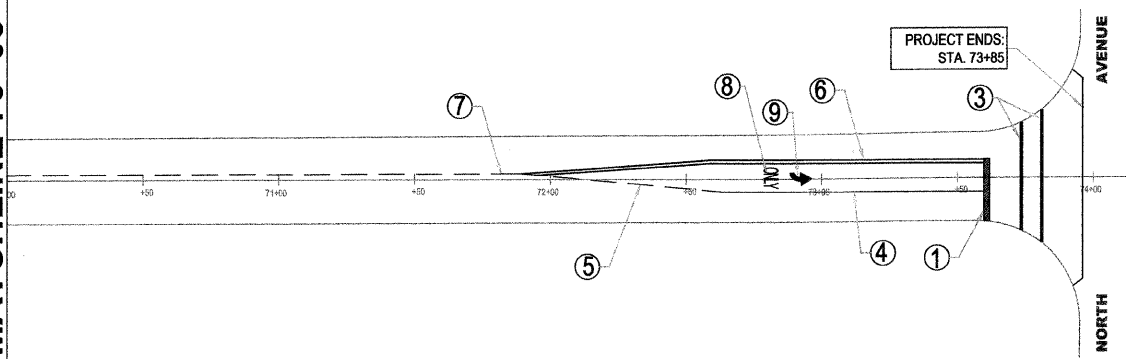

LEGEND:

- ① THERMOPLASTIC PAVEMENT MARKING, 24" SOLID WHITE LINE, STOP BAR (TYP)
- ② THERMOPLASTIC PAVEMENT MARKING, 12" SOLID WHITE LINE, PEDESTRIAN CROSSING BAR (TYP)
- ③ THERMOPLASTIC PAVEMENT MARKING, 6" SOLID WHITE, PEDESTRIAN CROSSING LINE
- ④ THERMOPLASTIC PAVEMENT MARKING, 4" SOLID WHITE LANE LINE, (TYP)
- ⑤ THERMOPLASTIC PAVEMENT MARKING, 4" SKIP WHITE LANE LINE, (10'DASH, 30'SKIP) (TYP)
- ⑥ THERMOPLASTIC PAVEMENT MARKING, 4" SOLID YELLOW LANE LINE, (TYP)
- ⑦ THERMOPLASTIC PAVEMENT MARKING, 4" SKIP YELLOW DASH LANE LINE, (10' DASH, 30' SKIP) (TYP)
- ⑧ THERMOPLASTIC LETTERS, WHITE "SCHOOL XING" OR "ONLY"
- ⑨ THERMOPLASTIC SYMBOL, WHITE ONLY ARROW

REVISIONS					
DATE	BY	DESCRIPTION	DATE	BY	DESCRIPTION

DESIGNED: GC
DRAFTED: GC
CHECKED: GWK
APPROVED: GWK DATE: 11/17/08

**VILLAGE OF RIVER FOREST
ENGINEERING DEPARTMENT
400 PARK AVE.
RIVER FOREST, IL 60305
(708) 366-8500**

TITLE:
LATHROP AVENUE
RESURFACING IMPROVEMENTS
PAVEMENT MARKING PLAN
SECTION NO: 08-00088-00-RS

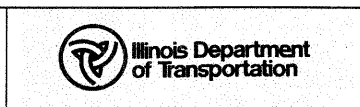

SCALE: 1" = 50'
DATE: 11/17/2008
PROJ. NO: 4065
SHEET: 13 of 17

F.A.P. RTE.	SECTION	COUNTY	TOTAL SHEETS	SHEET NO.
2765	08-00088-00-RS	COOK	17	14
FED. ROAD DIST. NO. 1		ILLINOIS		

CONTRACT NO. 63179

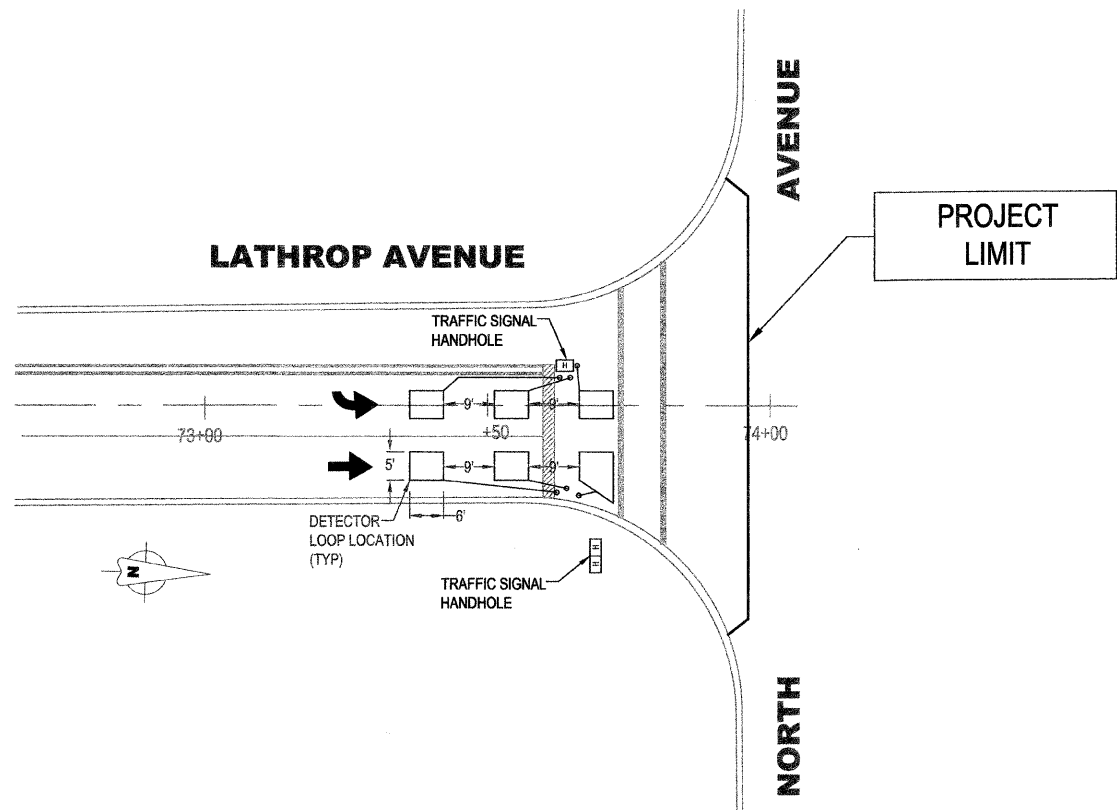

LATHROP AND NORTH INTERSECTION
TRAFFIC SIGNAL DETECTOR LOOP LOCATIONS

NOT TO SCALE

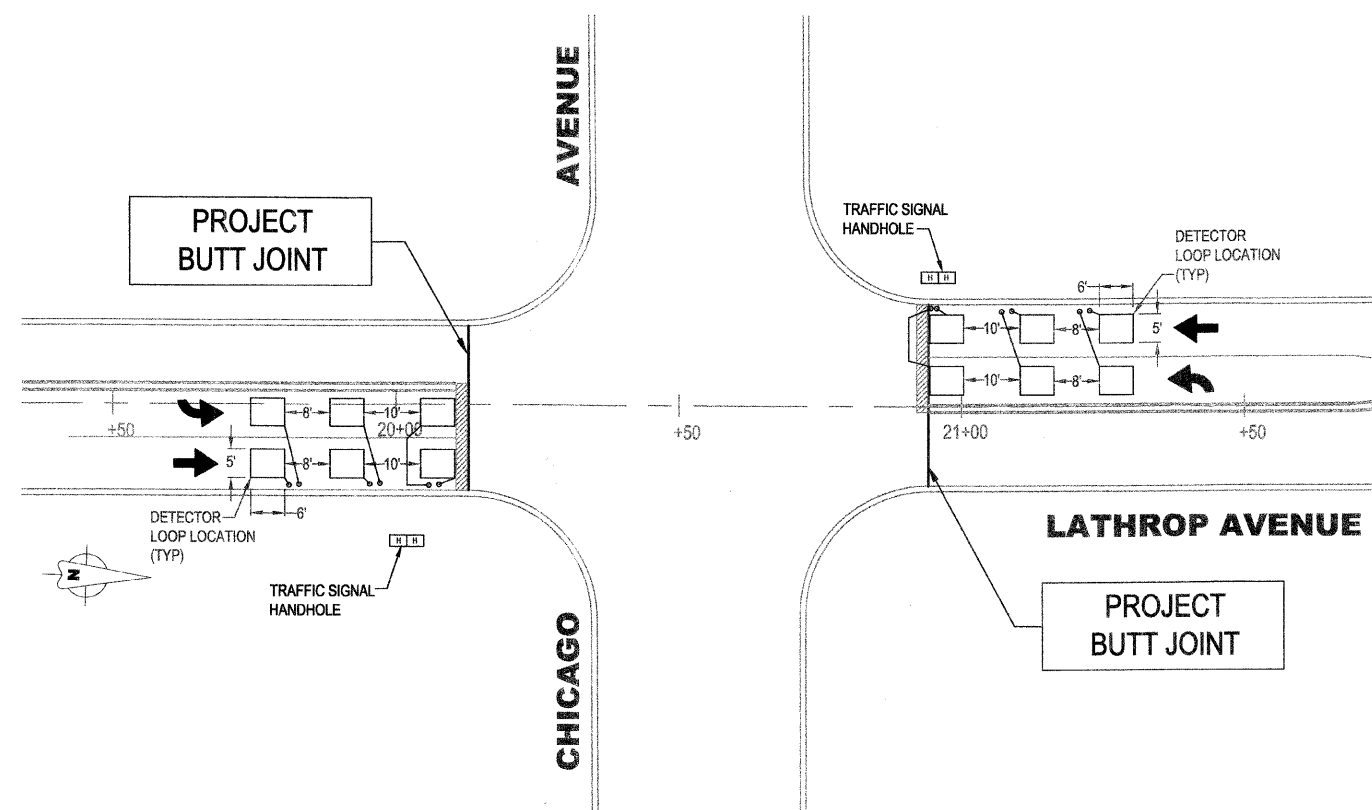

LATHROP AND CHICAGO INTERSECTION
TRAFFIC SIGNAL DETECTOR LOOP LOCATIONS

NOT TO SCALE

REVISIONS							
DATE	BY	DESCRIPTION	DATE	BY	DESCRIPTION	DATE	BY

DESIGNED:	GC
DRAFTED:	GC
CHECKED:	GWK
APPROVED:	GWK DATE: 11/17/08



**VILLAGE OF RIVER FOREST
ENGINEERING DEPARTMENT**
400 PARK AVE.
RIVER FOREST, IL 60305
(708) 366-8500

TITLE:
LATHROP AVENUE
RESURFACING IMPROVEMENTS
DETECTOR LOOP LOCATION PLAN
SECTION NO: 08-00088-00-RS



Illinois Department
of Transportation

SCALE:	1" = 50'
DATE:	11/17/2008
PROJ. NO.:	4065
SHEET:	14 OF 17

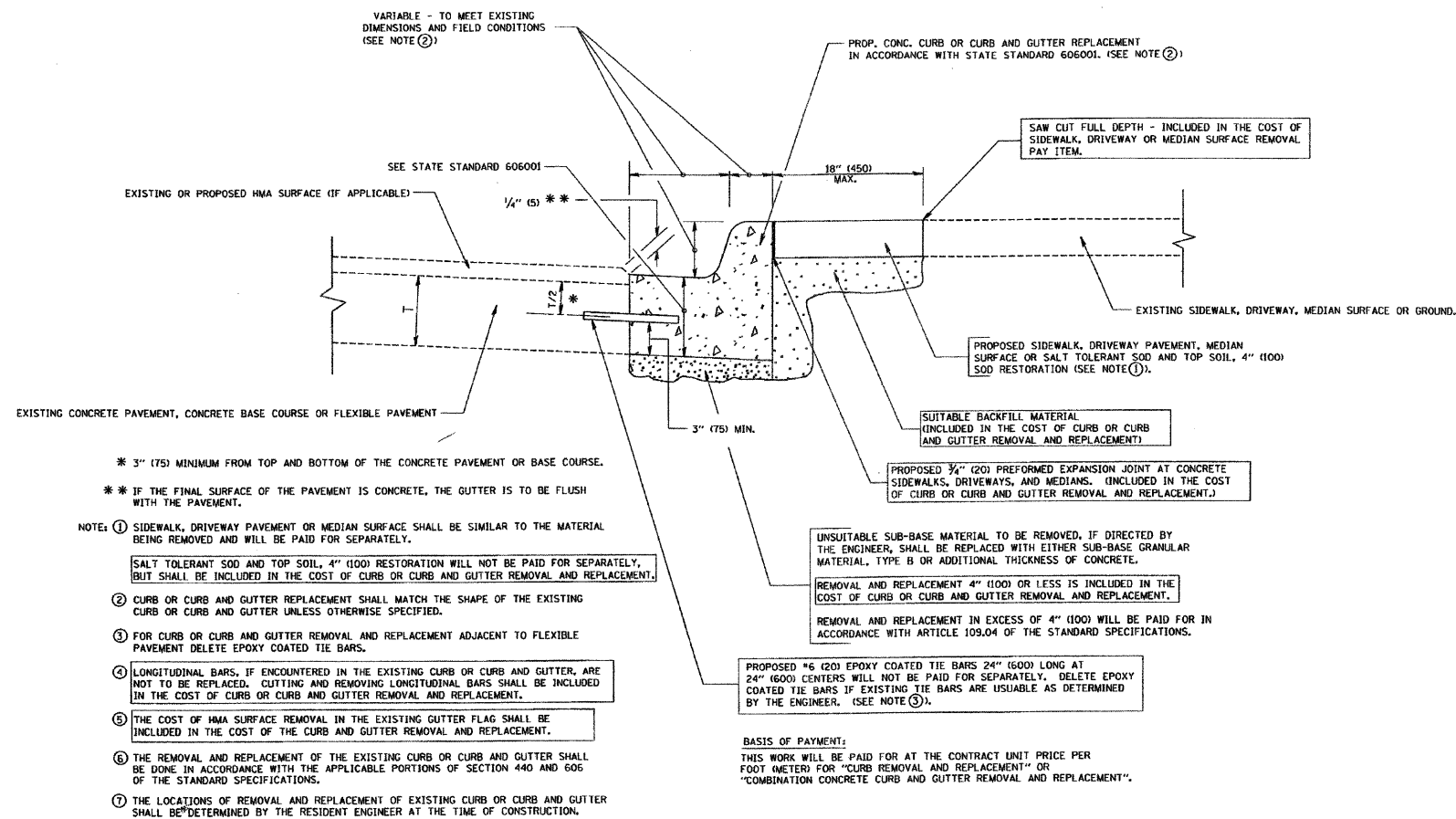

* 3" (75) MINIMUM FROM TOP AND BOTTOM OF THE CONCRETE PAVEMENT OR BASE COURSE.
 ** IF THE FINAL SURFACE OF THE PAVEMENT IS CONCRETE, THE GUTTER IS TO BE FLUSH WITH THE PAVEMENT.

- NOTE: ① SIDEWALK, DRIVEWAY PAVEMENT OR MEDIAN SURFACE SHALL BE SIMILAR TO THE MATERIAL BEING REMOVED AND WILL BE PAID FOR SEPARATELY.
 ② CURB OR CURB AND GUTTER REPLACEMENT SHALL MATCH THE SHAPE OF THE EXISTING CURB OR CURB AND GUTTER UNLESS OTHERWISE SPECIFIED.
 ③ FOR CURB OR CURB AND GUTTER REMOVAL AND REPLACEMENT ADJACENT TO FLEXIBLE PAVEMENT DELETE EPOXY COATED TIE BARS.
 ④ LONGITUDINAL BARS, IF ENCOUNTERED IN THE EXISTING CURB OR CURB AND GUTTER, ARE NOT TO BE REPLACED. CUTTING AND REMOVING LONGITUDINAL BARS SHALL BE INCLUDED IN THE COST OF CURB OR CURB AND GUTTER REMOVAL AND REPLACEMENT.
 ⑤ THE COST OF HMA SURFACE REMOVAL IN THE EXISTING GUTTER FLAG SHALL BE INCLUDED IN THE COST OF THE CURB AND GUTTER REMOVAL AND REPLACEMENT.
 ⑥ THE REMOVAL AND REPLACEMENT OF THE EXISTING CURB OR CURB AND GUTTER SHALL BE DONE IN ACCORDANCE WITH THE APPLICABLE PORTIONS OF SECTION 440 AND 606 OF THE STANDARD SPECIFICATIONS.
 ⑦ THE LOCATIONS OF REMOVAL AND REPLACEMENT OF EXISTING CURB OR CURB AND GUTTER SHALL BE DETERMINED BY THE RESIDENT ENGINEER AT THE TIME OF CONSTRUCTION.

SALT TOLERANT SOD AND TOP SOIL, 4" (100) RESTORATION WILL NOT BE PAID FOR SEPARATELY, BUT SHALL BE INCLUDED IN THE COST OF CURB OR CURB AND GUTTER REMOVAL AND REPLACEMENT.

UNUSABLE SUB-BASE MATERIAL TO BE REMOVED, IF DIRECTED BY THE ENGINEER, SHALL BE REPLACED WITH EITHER SUB-BASE GRANULAR MATERIAL, TYPE B OR ADDITIONAL THICKNESS OF CONCRETE.

REMOVAL AND REPLACEMENT 4" (100) OR LESS IS INCLUDED IN THE COST OF CURB OR CURB AND GUTTER REMOVAL AND REPLACEMENT.

REMOVAL AND REPLACEMENT IN EXCESS OF 4" (100) WILL BE PAID FOR IN ACCORDANCE WITH ARTICLE 109.04 OF THE STANDARD SPECIFICATIONS.

PROPOSED #6 (20) EPOXY COATED TIE BARS 24" (600) LONG AT 24" (600) CENTERS WILL NOT BE PAID FOR SEPARATELY. DELETE EPOXY COATED TIE BARS IF EXISTING TIE BARS ARE USABLE AS DETERMINED BY THE ENGINEER. (SEE NOTE ③).

BASIS OF PAYMENT: THIS WORK WILL BE PAID FOR AT THE CONTRACT UNIT PRICE PER FOOT (METER) FOR "CURB REMOVAL AND REPLACEMENT" OR "COMBINATION CONCRETE CURB AND GUTTER REMOVAL AND REPLACEMENT".

CURB OR CURB AND GUTTER REMOVAL AND REPLACEMENT

NOT TO SCALE

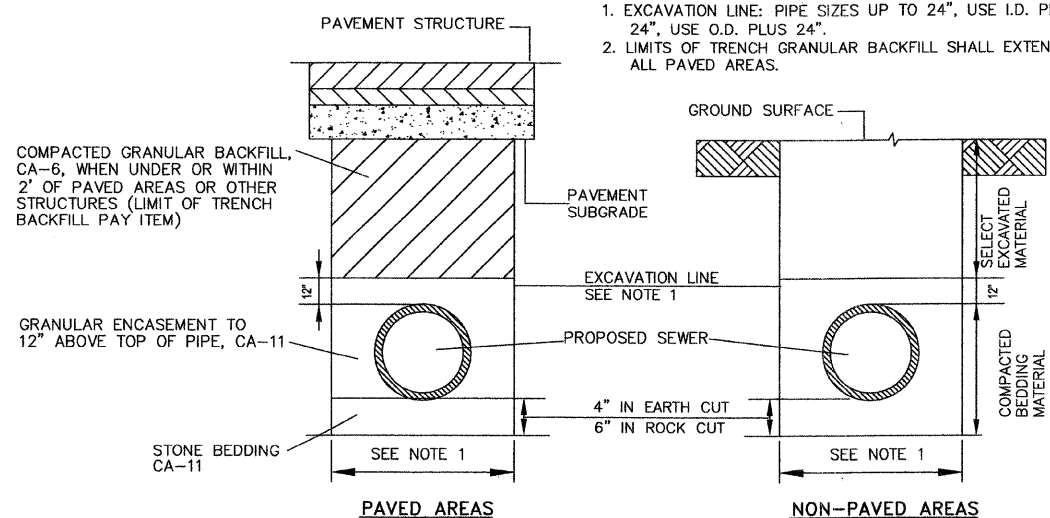

TRENCH BACKFILL SECTIONS

NOT TO SCALE

- NOTES:
 1. EXCAVATION LINE: PIPE SIZES UP TO 24", USE I.D. PLUS 20". OVER 24", USE O.D. PLUS 24".
 2. LIMITS OF TRENCH GRANULAR BACKFILL SHALL EXTEND 2' OUTSIDE ALL PAVED AREAS.

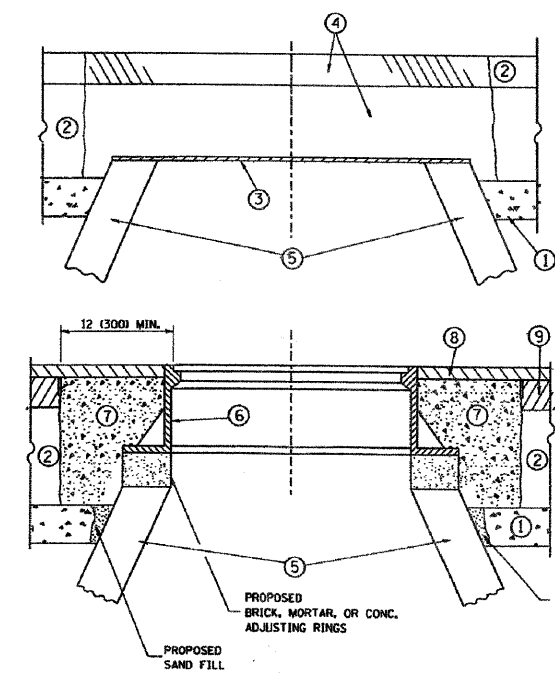

NOTES:

EXISTING BROKEN FRAMES AND LIDS SHALL BE REMOVED AND DISPOSED OF BY THE CONTRACTOR AND SHALL BE REPLACED AS DIRECTED BY THE ENGINEER. REPLACEMENT FRAMES AND LIDS WILL BE PAID FOR IN ACCORDANCE WITH ARTICLE 109.04 OF THE STANDARD SPECIFICATIONS UNLESS A SEPARATE PAY ITEM HAS BEEN PROVIDED.

IF THE EXISTING LIDS ARE OPEN, THE FRAME WILL BE ADJUSTED TO THE ELEVATION OF THE MILLED PAVEMENT SURFACE PRIOR TO THE MILLING OPERATION. THE FRAME WILL NOT BE REMOVED AND COVERED BY THE METAL PLATE.

CITY OF CHICAGO CASTINGS ARE THE PROPERTY OF THE CITY AND THE CONTRACTOR SHALL NOTIFY THE CITY FOR REMOVAL AND DISPOSITION OF THE CASTINGS.

THE METAL PLATE USED TO COVER THE STRUCTURE SHALL REMAIN THE PROPERTY OF THE CONTRACTOR.

WHEN STRUCTURES ARE TO BE ADJUSTED OR RECONSTRUCTED, THE LOWERING AND RAISING OF THE FRAMES AND LIDS WILL NOT BE PAID FOR SEPARATELY BUT WILL BE INCLUDED IN THE COST OF THE CORRESPONDING PAY ITEM.

DETAILS FOR FRAMES AND LIDS ADJUSTMENT WITH MILLING

NOT TO SCALE

CONSTRUCTION PROCEDURES

- STAGE 1 (BEFORE PAVEMENT MILLING)
 A) REMOVE A MINIMUM OF 12 (300) OF THE PAVEMENT FROM AROUND THE STRUCTURE.
 B) REMOVE THE EXISTING FRAME AND LID FROM THE STRUCTURE.
 C) COVER THE STRUCTURE OPENING WITH A 36 (900) DIAMETER METAL PLATE.
 D) BACKFILL WITH CRUSHED STONE AND A MINIMUM 1/2 (40) THICK HMA SURFACE MIX APPROVED BY THE ENGINEER.

- STAGE 2 (AFTER PAVEMENT MILLING)
 A) REMOVE THE HMA SURFACE MIX AND CRUSHED STONE.
 B) INSTALL THE FRAME AND LID; ADJUST THE FRAME TO ITS FINAL SURFACE ELEVATION.
 C) THE SURROUNDING SPACE SHALL BE FILLED WITH CLASS S1 CONCRETE, OR HMA SURFACE COURSE OR HMA BINDER COURSE TO THE ELEVATION OF THE SURFACE OF THE EXISTING BASE COURSE OR THE BINDER COURSE.

THE PROCEDURE EXPLAINED ABOVE SHALL CONFORM TO THE APPLICABLE PORTIONS OF SECTIONS 353, 406, 602, AND 603 OF THE STANDARD SPECIFICATIONS.

LEGEND

- | | |
|--|--|
| ① SUB-BASE GRANULAR MATERIAL | ⑥ FRAME AND LID (SEE NOTES) |
| ② EXISTING PAVEMENT | ⑦ CLASS S1 CONCRETE, HMA SURFACE COURSE OR HMA BINDER COURSE |
| ③ 36 (900) DIAMETER METAL PLATE | ⑧ PROPOSED HMA SURFACE COURSE |
| ④ PROPOSED CRUSHED STONE AND HMA SURFACE MIX | ⑨ PROPOSED HMA BINDER COURSE |
| ⑤ EXISTING STRUCTURE | |

LOCATION OF STRUCTURES:

THE CONTRACTOR WILL BE REQUIRED TO KEEP A RECORD OF THE LOCATIONS OF THE BURIED STRUCTURES ACCORDING TO THE STATION AND DISTANCE LEFT OR RIGHT OF THE CENTERLINE OF PAVEMENT. UPON COMPLETION OF THE WORK, THE CONTRACTOR WILL DELIVER THE RECORD TO THE ENGINEER.

BASIS OF PAYMENT: THIS WORK WILL BE PAID FOR AT THE CONTRACT UNIT PRICE PER EACH FOR "FRAMES AND LIDS TO BE ADJUSTED, SPECIAL" NEW FRAMES AND LIDS, WHEN SPECIFIED, WILL BE PAID FOR SEPARATELY.

REVISIONS					
DATE	BY	DESCRIPTION	DATE	BY	DESCRIPTION

DESIGNED: GC
DRAFTED: GC
CHECKED: GWK
APPROVED: GWK DATE: 11/17/08

VILLAGE OF RIVER FOREST
 LATHROP AVENUE
 RESURFACING IMPROVEMENTS
 STANDARDS AND DETAILS
 SECTION NO: 08-00088-00-RS

TITLE:	LATHROP AVENUE RESURFACING IMPROVEMENTS STANDARDS AND DETAILS SECTION NO: 08-00088-00-RS
--------	---



SCALE:	NONE
DATE:	11/17/2008
PROJ. NO.:	4065
SHEET:	15 OF 17

CONTRACT NO. 63179

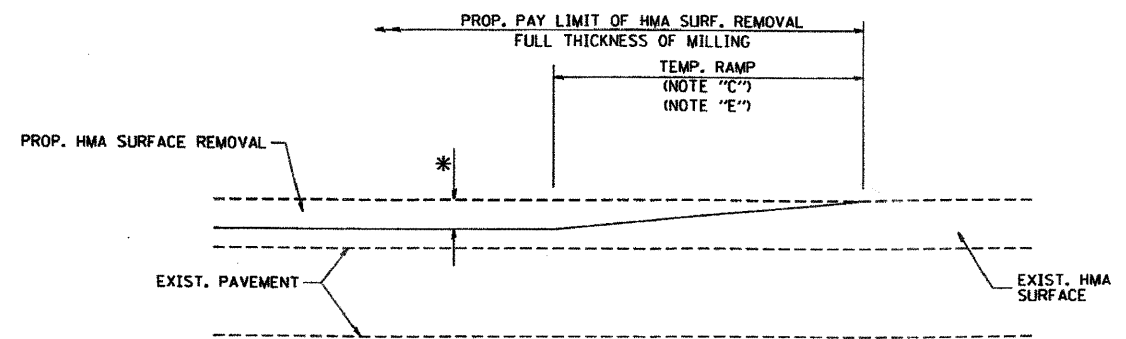

MILLED TEMPORARY RAMP
(FOR BUTT JOINT AND HMA TAPER SEE DETAIL BELOW)

OPTION 1

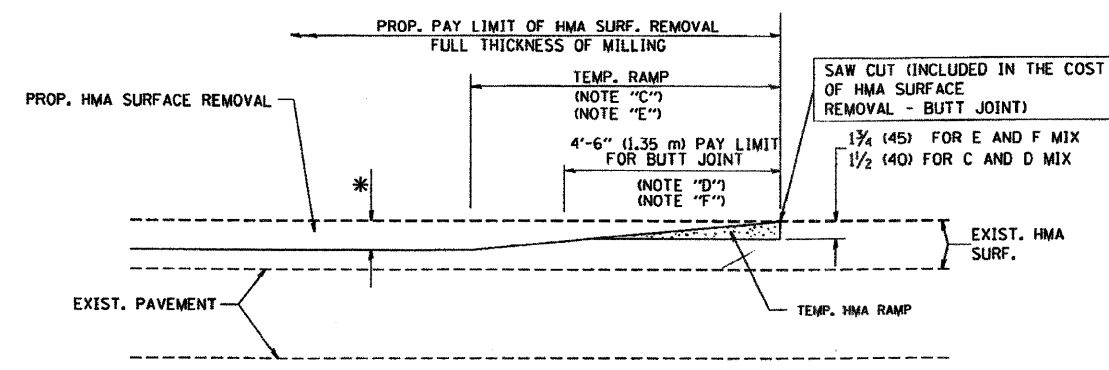

HMA CONSTRUCTED TEMPORARY RAMP
(FOR BUTT JOINT AND HMA TAPER SEE DETAIL BELOW)

OPTION 2

TYPICAL TEMPORARY RAMP

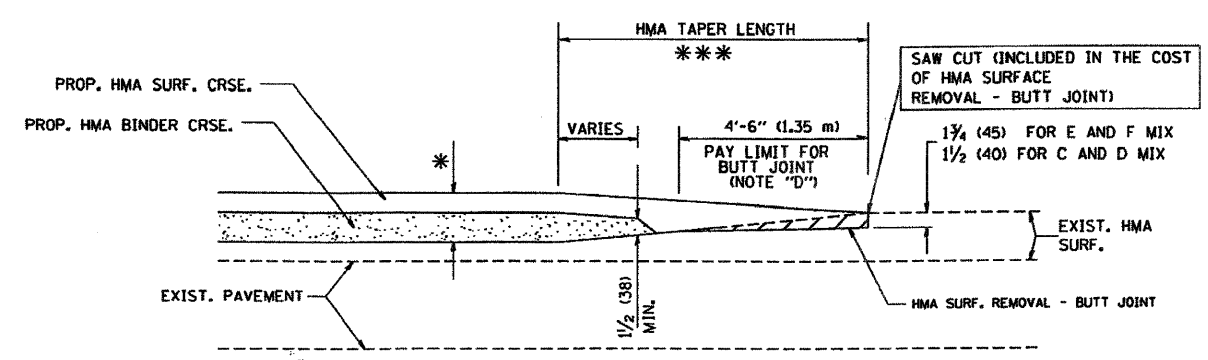

BUTT JOINT AND HMA TAPER

TYPICAL BUTT JOINT AND HMA TAPER FOR MILLING AND RESURFACING

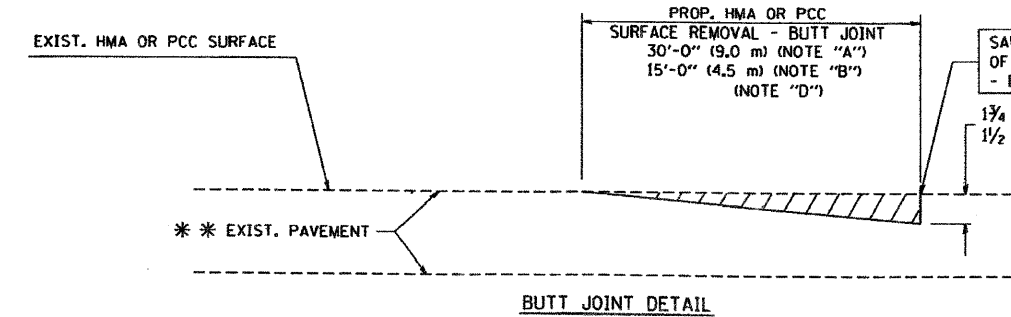

BUTT JOINT DETAIL

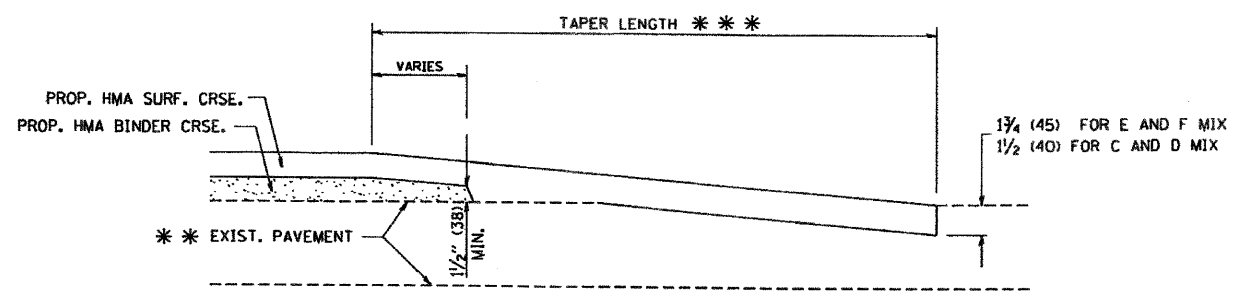

HMA TAPER DETAIL

TYPICAL BUTT JOINT AND HMA TAPER FOR RESURFACING ONLY

*** PC CONCRETE, HMA OR HMA RESURFACED PAVEMENT.

NOTES

- A: MAINLINE ROADWAYS AND MAJOR SIDE ROADS.
 - B: MINOR SIDE ROADS.
 - C: THE TEMP. RAMP SHALL BE CONSTRUCTED IMMEDIATELY UPON REMOVAL OF THE EXISTING HMA SURFACE.
 - D: THE BUTT JOINT SHALL BE CONSTRUCTED IMMEDIATELY PRIOR TO PLACING THE PROPOSED HMA COURSES.
 - E: TAPER THE TEMP. RAMP AT A RATE OF 3'-0" (900 mm) PER 1 INCH (25 mm) OF MILLING THICKNESS.
 - F: INSTALLATION AND REMOVAL OF THE 4'-6" (1.35 m) TEMP. RAMP IS INCLUDED IN COST OF HMA SURFACE REMOVAL - BUTT JOINT
 - G: SEE ARTICLE 406.08 AND 406.14 OF THE STANDARD SPECIFICATIONS FOR "HMA AND/OR PCC SURFACE REMOVAL, BUTT JOINT".
- * SEE TYPICAL SECTIONS FOR MILLING THICKNESS.
- *** 20'-0" (6.1 m) PER 1 (25) RESURFACING (NOTE "A")
10'-0" (3.0 m) PER 1 (25) RESURFACING (NOTE "B")

BASIS OF PAYMENT:

THE BUTT JOINT WILL BE PAID FOR AT THE CONTRACT UNIT PRICE PER SQUARE YARD (SQUARE METER) FOR "HOT-MIX ASPHALT SURFACE REMOVAL - BUTT JOINT" OR FOR "PORTLAND CEMENT CONCRETE SURFACE REMOVAL - BUTT JOINT".

ALL DIMENSIONS ARE IN INCHES (MILLIMETERS) UNLESS OTHERWISE SHOWN.

REVISIONS					
DATE	BY	DESCRIPTION	DATE	BY	DESCRIPTION

DESIGNED: GC
DRAFTED: GC
CHECKED: GWK
APPROVED: GWK DATE: 11/17/08

VILLAGE OF RIVER FOREST
ENGINEERING DEPARTMENT
400 PARK AVE.
RIVER FOREST, IL 60305
(708) 366-8500

TITLE:
LATHROP AVENUE
RESURFACING IMPROVEMENTS
STANDARDS AND DETAILS
SECTION NO: 08-00088-00-RS



SCALE: NONE
DATE: 11/17/2008
PROJ. NO: 4065
SHEET: 16 OF 17

F.A.P. RTE.	SECTION	COUNTY	TOTAL SHEETS	SHEET NO.
2765	08-00089-00-RS	COOK	17	17
FED. ROAD DIST. NO. 1		ILLINOIS		

CONTRACT NO. 63179

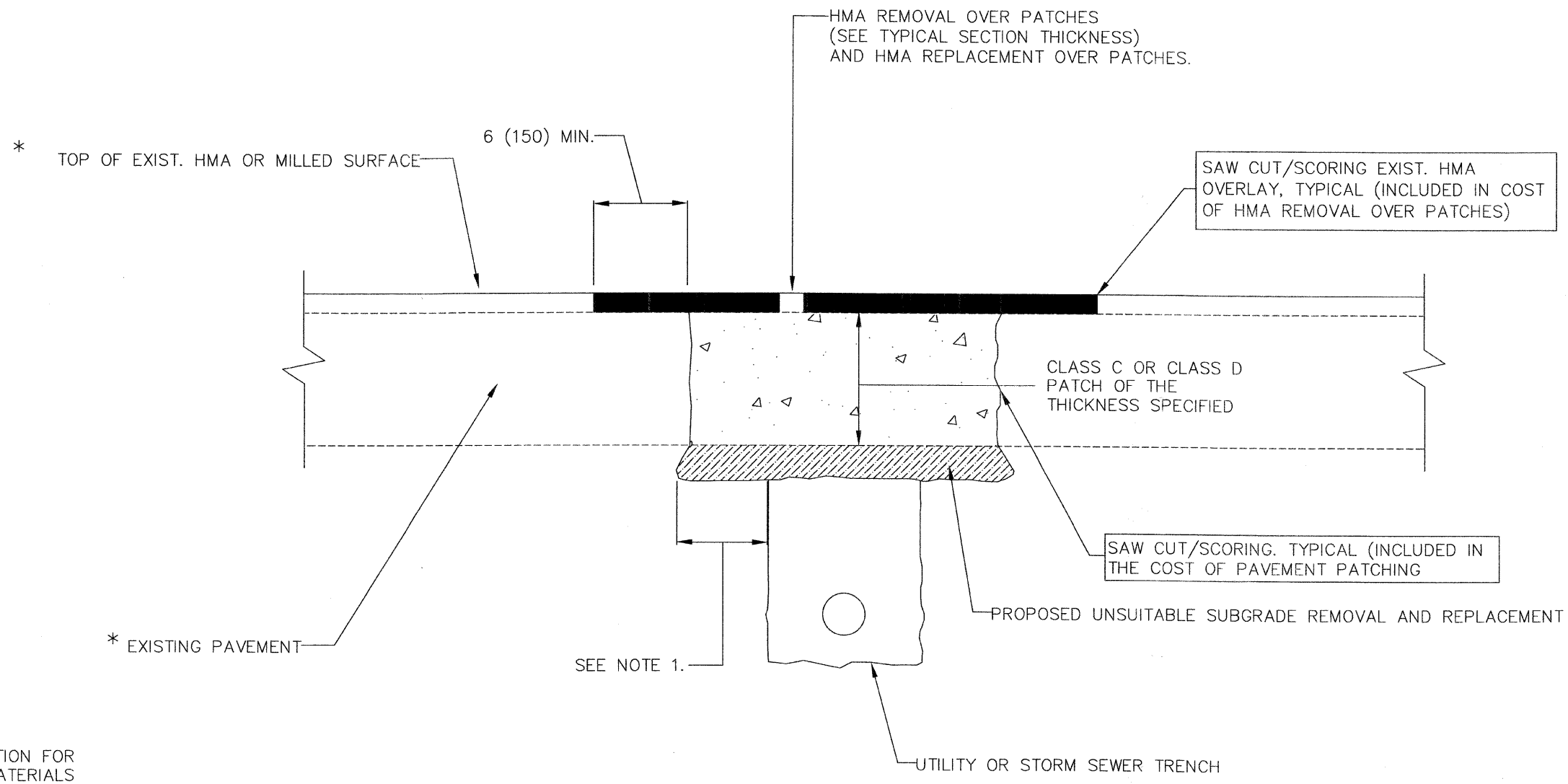

* SEE TYPICAL SECTION FOR THICKNESS AND MATERIALS

NOTES:

1. THE WIDTH OF THE FULL DEPTH PATCH OVER A TRENCH SHALL BE 12 (300) WIDER ON EACH SIDE OF THE TRENCH.
2. FOR METHOD OF MEASUREMENT AND BASIS OF PAVEMENT. SEE RECURRING SPECIAL PROVISIONS "PATCHING WITH HOT-MIX ASPHALT OVERLAY REMOVAL".

SCHEDULE OF CONSTRUCTION

1. REMOVE THE EXISTING HMA MATERIAL OVER THE AREA TO BE PATCHED.
2. REMOVE AND REPLACE FULL PATCHES
3. REPLACE HMA MATERIAL OVER THE AREA TO BE PATCHED.

ILLINOIS DEPARTMENT OF TRANSPORTATION

PAVEMENT PATCHING FOR HMA SURFACED PAVEMENT

SCALE: VERT. NONE
HORIZ. NONE
PLOT DATE: 2/21/2007

DRAWN BY:
CHECKED BY: