

ROUTE NO.	SECTION	COUNTY	TOTAL SHEETS	SHEET NO.
137-1B	Henry	54	19	3 SHEETS

PRESTRESSED PRECAST UNITS
 Fc = 5000 psi
 Ft = 2000 psi
 Fb = 250,000 psi (Strands)
 Fst = 160,000 psi (Struct)
 Fc = 14000 psi (Struct)

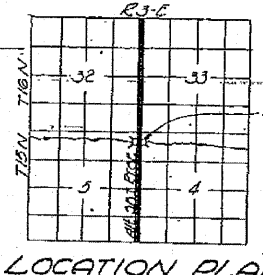

STATION 434+833
 BUILT 196 BY
 STATE OF ILLINOIS
 307. RT 82 SEC. 137-1B
 LOADING H15-312

NAME PLATE
 (See Standard 8113)

DESIGN STRESSES
 Fc = 1400 psi Super
 Fb = 200,000 psi Reinf.
 Fst = 140,000 psi Struct.
 n = 10
 Loading H15-312-44

WATERWAY INFORMATION
 Drainage Area 2215 Acres
 Character Rolling Cultiv.
 Required Opening (25 yr. fl.) 160 Sq. Ft.
 Present Opening 155 Sq. Ft.
 Proposed Opening 160 Sq. Ft.
 Ordinary water Elev. 692.4

GENERAL NOTES
 For item "Precast Concrete Bridge Deck" see Special Provisions.
 For timber structures see Sec. 57 of the Standard Specifications.
 Class K Concrete shall be used in Abutment caps.
 All Hardware except cast iron O.G. Washers and malleable iron washers shall be hot dipped galvanized and shall be galvanized after fabrication.
 The Contractor shall drive one test pile, before ordering remainder of piles, near South Abutment.
 Expansion bolts shall consist of self drilling expansion shells & 3/4" x 12" hook bolts.

V.C. DATA
 Top of base course
 400' V.C.
 Cr. Rdwy.
 P.I. Sta. 433+150 El. 702.93

TOTAL BILL OF MATERIAL

ITEM	Super	Sub	Total
Expansion Bolts 3/4" Ea	32	02	34
Precast Precast Conc Bridge DE 3918-257			257
Class X Concrete CUVs	13.8	13.8	
Treated Timber F.B.M.	2450	2450	
Hardware Lb.	740	740	
Reinforcement Bars Lb.	1460	1460	
Crested Piles 20" to 38" Lin.Ft.	600	600	
Test Pile Timber Ea	1	1	
Name Plates Ea	1	1	
Metal Plate Bridge Rail Lin.Ft.	70	70	
Reinforcing Existing Superstruc. Ea	1	1	

GENERAL PLANS-ELEVATION
 MARY TAYLOR'S BRIDGE
 BRANCH OF SPRING CREEK
 ALT. 307. RT. 82 SEC. 137-1B
 HENRY COUNTY
 STA. 434+833

DESIGNED: A.B. Henderson
 CHECKED: J. J. Howard
 DRAWN: A.P.H.
 EXAMINED: W.C. Baumann
 PASSED: [Signature]
 APPROVED: [Signature]
 DATE: SEPT. 9 1960