

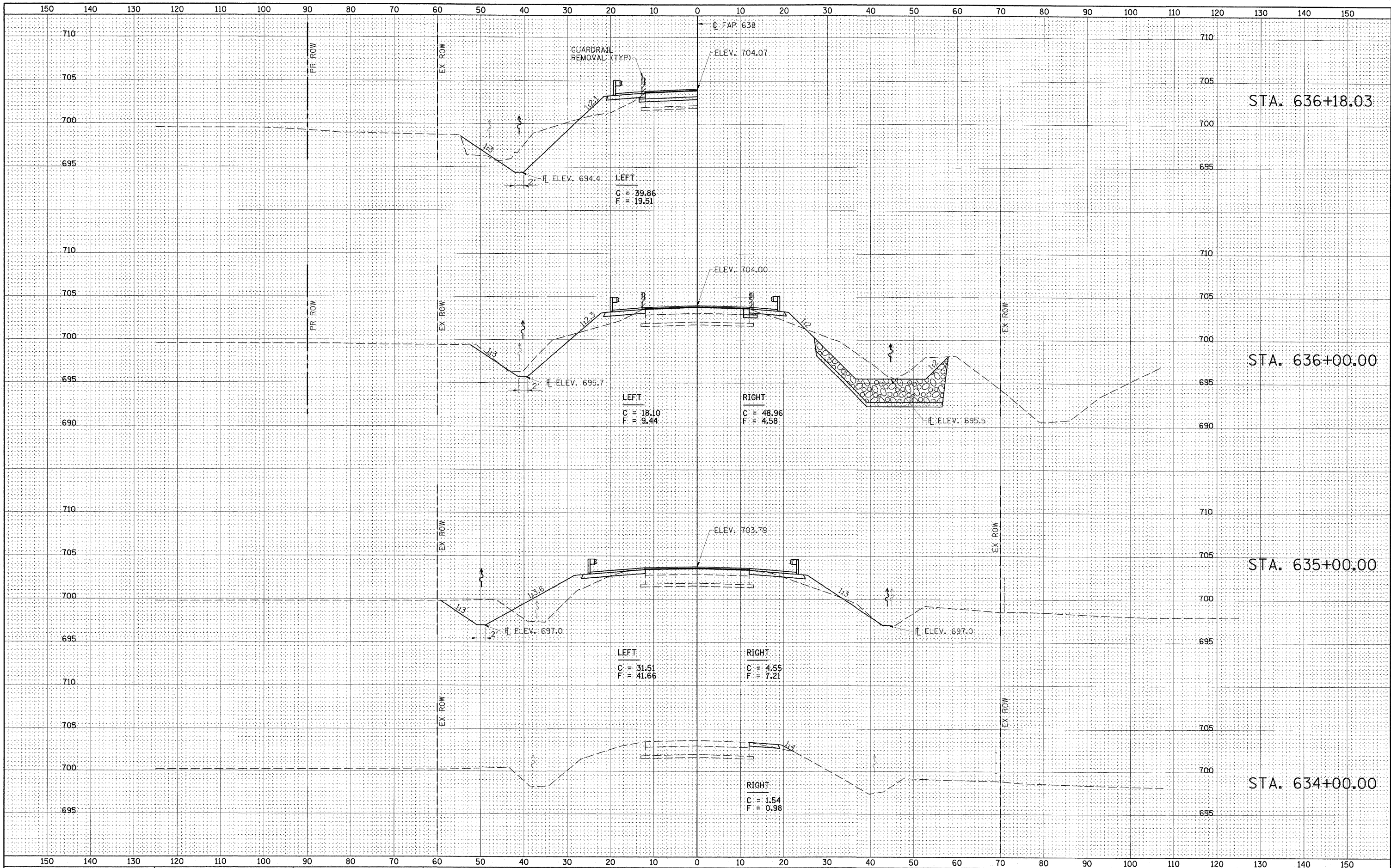

FINAL SURVEY	NO. _____
DESIGNED	BY _____
PLOTTED	DATE _____
TEMPLATE	
AREAS CHECKED	

ORIGINAL SURVEY	NO. _____
DESIGNED	BY _____
PLOTTED	DATE _____
TEMPLATE	
AREAS CHECKED	



FILE NAME = D264428-sh1-xssht02.dgn	USER NAME = HAS	DESIGNED - JMS	REVISED -	STATE OF ILLINOIS DEPARTMENT OF TRANSPORTATION	IL ROUTE 82 CROSS SECTIONS	F.A.P. RTE. 638	SECTION 137-1BR	COUNTY HENRY	TOTAL SHEETS 67	SHEET NO. 23	
SCALE: (HORIZ) 1"=10'-0" (VERT) 1"=5'	PLOT SCALE = 10.0733' / IN.	DRAWN - JPC	REVISED -			SCALE: 1"=10'-0"	SHEET NO. 2 OF 5 SHEETS	STA. 634+00 TO STA. 636+18.03	FED. ROAD DIST. NO.	ILLINOIS FED. AID PROJECT	CONTRACT NO. 64428
	PLOT DATE = 3/23/2009 9:58:00 AM	CHECKED - ELH	REVISED -								
		DATE - 03/13/09	REVISED -								