

# HORIZONTAL & VERTICAL CONTROL

Chain CENTERLINE contains:  
200 212 213 222 223 230

Beginning chain CENTERLINE description  
Feature: 405

Point 200 N 1,994,654.6830 E 2,442,655.4840 Sta 1105+33.7600

Course from 200 to 212 358° 31' 53.5192" Dist 10,150.5003'

Point 212 N 2,004,801.8497 E 2,442,395.3594 Sta 1206+84.2600

Course from 212 to 213 358° 20' 46.4430" Dist 999.9982'

Point 213 N 2,005,801.4314 E 2,442,366.4998 Sta 1216+84.2583

Course from 213 to 222 358° 09' 39.3717" Dist 8,336.2965'

Point 222 N 2,014,133.4340 E 2,442,098.9697 Sta 1300+20.5548

Course from 222 to 223 358° 15' 40.8526" Dist 999.9985'

Point 223 N 2,015,132.9721 E 2,442,068.6292 Sta 1310+20.5533

Course from 223 to 230 358° 21' 42.4034" Dist 926.6396'

Point 230 N 2,016,059.2330 E 2,442,042.1380 Sta 1319+47.1955

Ending chain CENTERLINE description

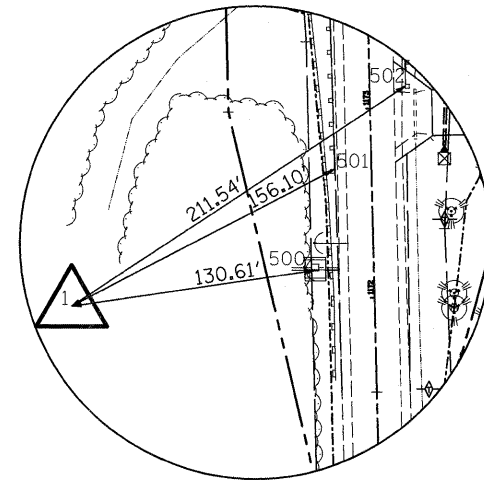

HORIZONTAL CONTROL POINT NO. 1

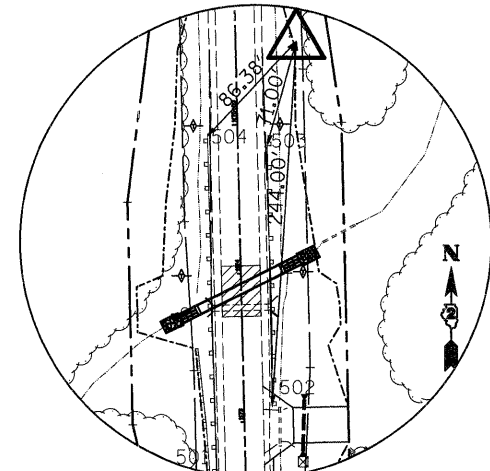

HORIZONTAL CONTROL POINT NO. 2

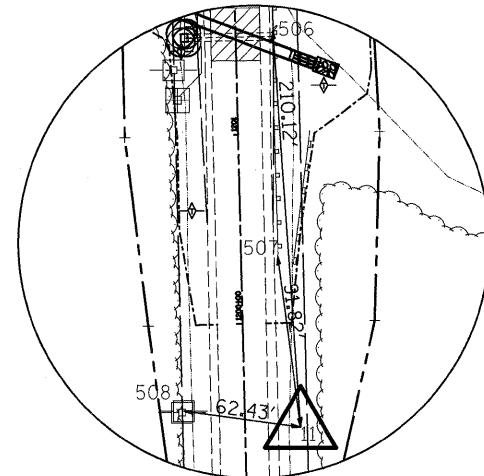

HORIZONTAL CONTROL POINT NO. 11

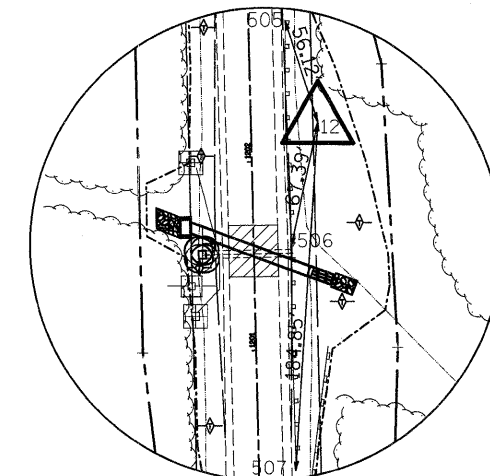

HORIZONTAL CONTROL POINT NO. 12

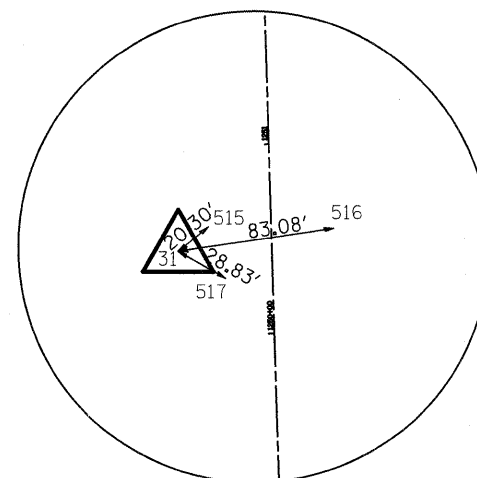

HORIZONTAL CONTROL POINT NO. 31

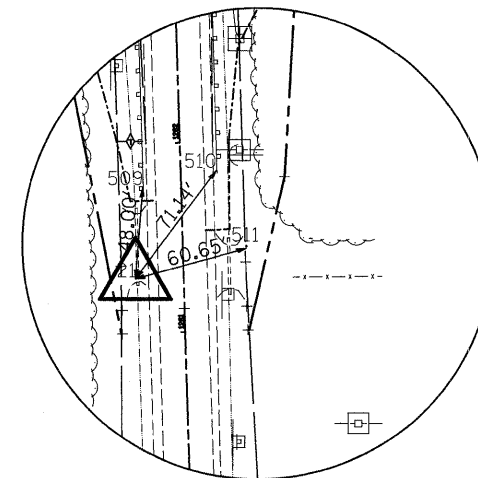

HORIZONTAL CONTROL POINT NO. 21

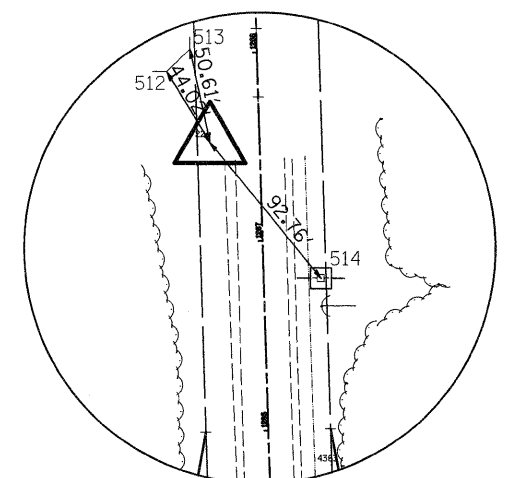

HORIZONTAL CONTROL POINT NO. 22

## REFERENCE TIES

POINT	CHAIN	STATION	OFFSET	DESCRIPTION
500	CENTERLINE	1172+15.1774	30.91' LT	POWER POLE, CHISELED "X"
501	CENTERLINE	1172+67.9911	20.308' LT	GUARDRAIL END SECTION, CHISELED "X"
502	CENTERLINE	1173+11.2785	19.0182' RT	GUARDRAIL END SECTION, CHISELED "X"
503	CENTERLINE	1174+86.4572	19.9468' RT	GUARDRAIL END SECTION, CHISELED "X"
504	CENTERLINE	1174+93.1501	20.1139' LT	GUARDRAIL END SECTION, CHISELED "X"
505	CENTERLINE	1202+73.8008	19.4712' RT	GUARDRAIL END SECTION, CHISELED "X"
506	CENTERLINE	1201+54.4843	19.7596' RT	HEADWALL, CHISELED "X"
507	CENTERLINE	1200+35.8684	19.4028' RT	GUARDRAIL END SECTION, CHISELED "X"
508	CENTERLINE	1199+54.4843	32.2458' LT	POWER POLE, CHISELED "X"
509	CENTERLINE	1281+76.6425	20.1973' LT	GUARDRAIL END SECTION, CHISELED "X"
510	CENTERLINE	1281+84.4231	18.9525' RT	GUARDRAIL END SECTION, CHISELED "X"
511	CENTERLINE	1281+42.8533	33.4539' RT	FENCE POST, CONCRETE
512	CENTERLINE	1287+91.2086	48.0089' LT	GATE POST, CONCRETE
513	CENTERLINE	1288+02.7046	35.4224' LT	GATE POST, CONCRETE
514	CENTERLINE	1286+79.4556	30.3391' RT	POWER POLE, CONCRETE
515	CENTERLINE	1250+57.0127	33.2868' LT	FENCE POST, CONCRETE
516	CENTERLINE	1250+54.2942	32.961' RT	FENCE POST, CONCRETE
517	CENTERLINE	1250+29.9553	24.9529' LT	PIPE CULVERT, CMP

FILE NAME =	USER NAME = goffjl	DESIGNED -	REVISED -
c:\pw_work\PW1DOT\G0FFJL\dms34801\d00363hvc.dgn		DRAWN -	REVISED -
PLOT SCALE = 50.0000' / IN.		CHECKED -	REVISED -
PLOT DATE = Wed Mar 11 10:30:50 2009		DATE -	REVISED -

STATE OF ILLINOIS  
DEPARTMENT OF TRANSPORTATION

HORIZONTAL AND VERTICAL CONTROL

SCALE: SHEET NO. OF SHEETS STA. TO STA.

F.A.P. RTE.	SECTION	COUNTY	TOTAL SHEETS	SHEET NO.
316	2T	OGLE	48	11
CONTRACT NO. 64851				
FED. ROAD DIST. NO. ILLINOIS FED. AID PROJECT				