

HORIZONTAL & VERTICAL CONTROL

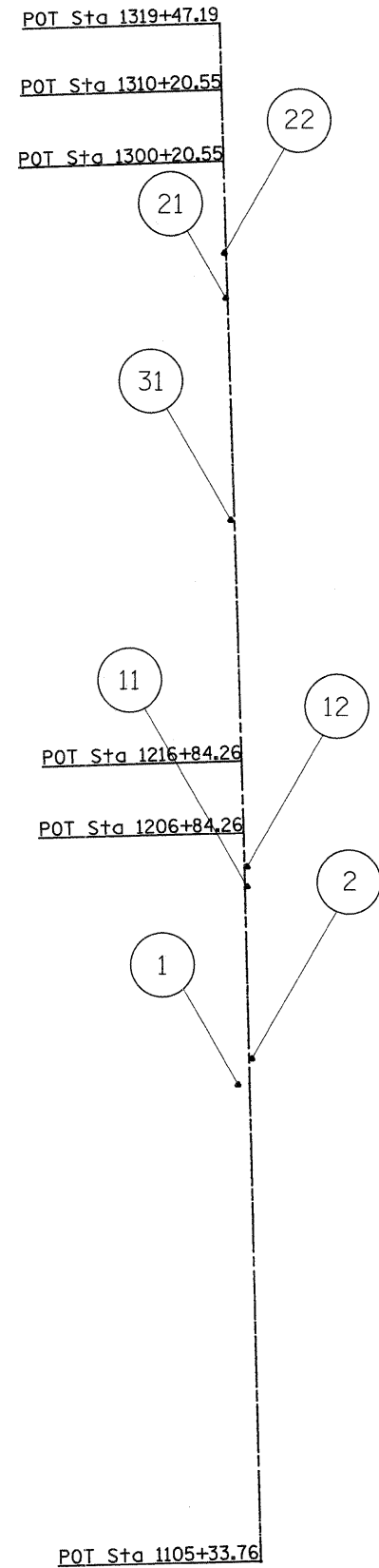

HORIZONTAL CONTROL POINTS							
POINT	NORTH	EAST	ELEVATION	CHAIN	STATION	OFFSET	DESCRIPTION
1	2001314.1080	2442324.1440	928.2630	CENTERLINE	1171+99.4891	160.5716' LT	TRAVERSE STATION, PIPE
2	2001673.9630	2442516.4550	935.7533	CENTERLINE	1175+54.2976	40.8982' RT	TRAVERSE STATION, PIPE
11	2004063.1750	2442443.6970	953.7049	CENTERLINE	1199+44.5895	29.3919' RT	TRAVERSE STATION, PIPE
12	2004338.6680	2442442.7310	953.8924	CENTERLINE	1202+20.0168	35.4862' RT	TRAVERSE STATION, PIPE
21	2012241.9810	2442134.1100	935.0719	CENTERLINE	1281+28.9486	25.5787' LT	TRAVERSE STATION, PIPE
22	2012865.6160	2442113.3820	934.2689	CENTERLINE	1287+52.9276	26.2822' LT	TRAVERSE STATION, PIPE
31	2009158.7770	2442209.0810	979.7904	CENTERLINE	1250+44.9267	49.5931' LT	TRAVERSE STATION, PIPE

BENCH MARKS							
POINT	NORTH	EAST	ELEVATION	CHAIN	STATION	OFFSET	DESCRIPTION
400	2001495.5200	2442460.0550	934.3740	CENTERLINE	1173+77.3585	20.0562' LT	HEADWALL, CHISELED "X"
401	2004270.7050	2442383.5530	951.4994	CENTERLINE	1201+53.5926	25.414' LT	HEADWALL, CHISELED "X"
402	2012467.0840	2442124.9350	926.2079	CENTERLINE	1283+54.2301	27.5249' LT	HEADWALL, CHISELED "X"