

CURVE POINT NUMBERS					
CHAIN	CURVE	PI	CC	PC	PT
PRUS30	G200	G200	G201	G202	G203
PRUS30	71220	71220	71221	71222	71223
PRUS30	71230	71230	71231	71232	71233
PRUS30	G230	G230	G231	G232	G233
PRUS30	70380	70380	70381	70382	70383

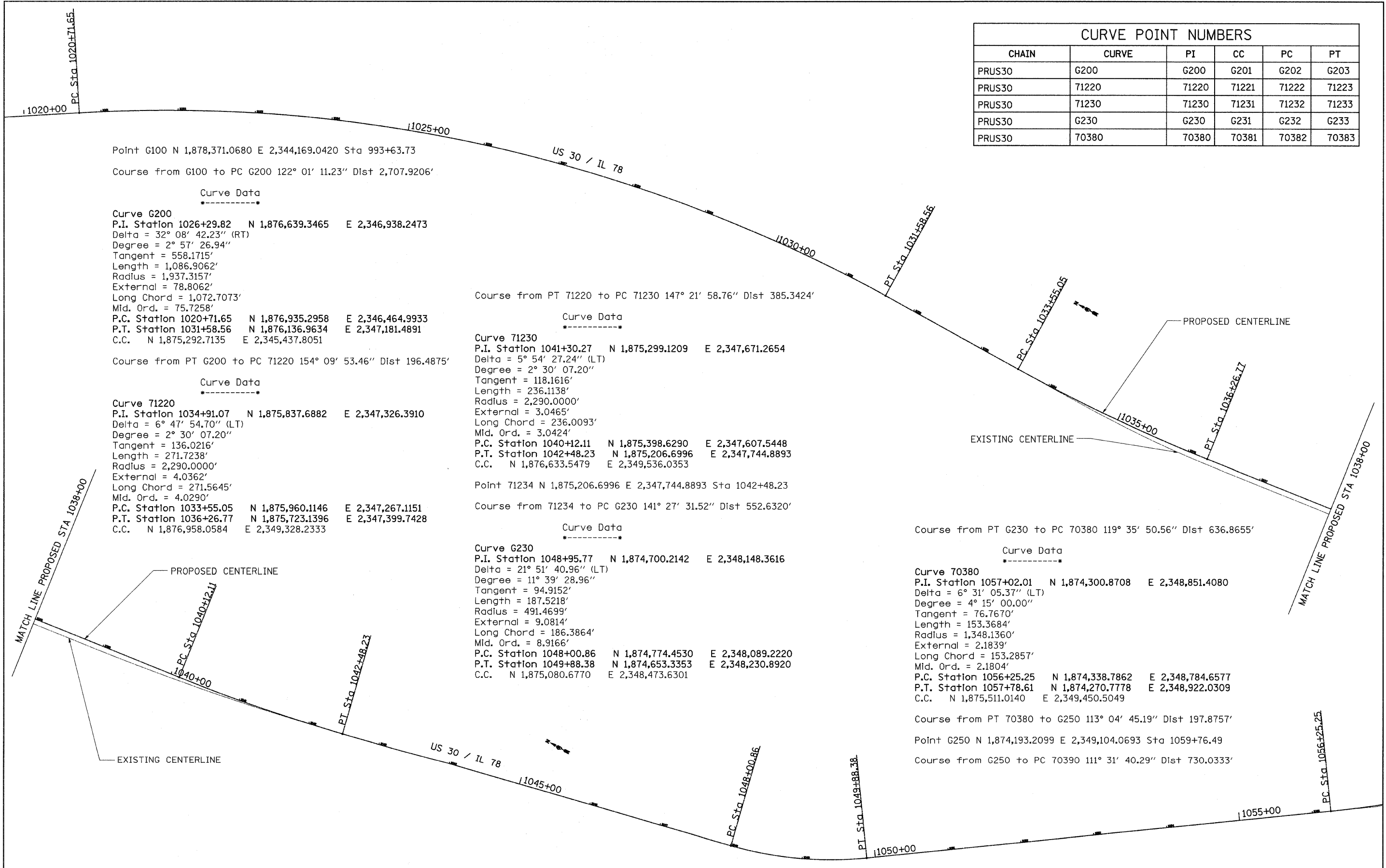

Point G100 N 1,878,371.0680 E 2,344,169.0420 Sta 993+63.73
 Course from G100 to PC G200 122° 01' 11.23" Dist 2,707.9206'

Curve Data

 Curve G200
 P.I. Station 1026+29.82 N 1,876,639.3465 E 2,346,938.2473
 Delta = 32° 08' 42.23" (RT)
 Degree = 2° 57' 26.94"
 Tangent = 558.1715'
 Length = 1,086.9062'
 Radius = 1,937.3157'
 External = 78.8062'
 Long Chord = 1,072.7073'
 Mid. Ord. = 75.7258'
 P.C. Station 1020+71.65 N 1,876,935.2958 E 2,346,464.9933
 P.T. Station 1031+58.56 N 1,876,136.9634 E 2,347,181.4891
 C.C. N 1,875,292.7135 E 2,345,437.8051

Course from PT G200 to PC 71220 154° 09' 53.46" Dist 196.4875'

Curve Data

 Curve 71220
 P.I. Station 1034+91.07 N 1,875,837.6882 E 2,347,326.3910
 Delta = 6° 47' 54.70" (LT)
 Degree = 2° 30' 07.20"
 Tangent = 136.0216'
 Length = 271.7238'
 Radius = 2,290.0000'
 External = 4.0362'
 Long Chord = 271.5645'
 Mid. Ord. = 4.0290'
 P.C. Station 1033+55.05 N 1,875,960.1146 E 2,347,267.1151
 P.T. Station 1036+26.77 N 1,875,723.1396 E 2,347,399.7428
 C.C. N 1,876,958.0584 E 2,349,328.2333

Course from PT 71220 to PC 71230 147° 21' 58.76" Dist 385.3424'

Curve Data

 Curve 71230
 P.I. Station 1041+30.27 N 1,875,299.1209 E 2,347,671.2654
 Delta = 5° 54' 27.24" (LT)
 Degree = 2° 30' 07.20"
 Tangent = 118.1616'
 Length = 236.1138'
 Radius = 2,290.0000'
 External = 3.0465'
 Long Chord = 236.0093'
 Mid. Ord. = 3.0424'
 P.C. Station 1040+12.11 N 1,875,398.6290 E 2,347,607.5448
 P.T. Station 1042+48.23 N 1,875,206.6996 E 2,347,744.8893
 C.C. N 1,876,633.5479 E 2,349,536.0353

Point 71234 N 1,875,206.6996 E 2,347,744.8893 Sta 1042+48.23

Course from 71234 to PC G230 141° 27' 31.52" Dist 552.6320'

Curve Data

 Curve G230
 P.I. Station 1048+95.77 N 1,874,700.2142 E 2,348,148.3616
 Delta = 21° 51' 40.96" (LT)
 Degree = 11° 39' 28.96"
 Tangent = 94.9152'
 Length = 187.5218'
 Radius = 491.4699'
 External = 9.0814'
 Long Chord = 186.3864'
 Mid. Ord. = 8.9166'
 P.C. Station 1048+00.86 N 1,874,774.4530 E 2,348,089.2220
 P.T. Station 1049+88.38 N 1,874,653.3353 E 2,348,230.8920
 C.C. N 1,875,080.6770 E 2,348,473.6301

Course from PT G230 to PC 70380 119° 35' 50.56" Dist 636.8655'

Curve Data

 Curve 70380
 P.I. Station 1057+02.01 N 1,874,300.8708 E 2,348,851.4080
 Delta = 6° 31' 05.37" (LT)
 Degree = 4° 15' 00.00"
 Tangent = 76.7670'
 Length = 153.3684'
 Radius = 1,348.1360'
 External = 2.1839'
 Long Chord = 153.2857'
 Mid. Ord. = 2.1804'
 P.C. Station 1056+25.25 N 1,874,338.7862 E 2,348,784.6577
 P.T. Station 1057+78.61 N 1,874,270.7778 E 2,348,922.0309
 C.C. N 1,875,511.0140 E 2,349,450.5049

Course from PT 70380 to G250 113° 04' 45.19" Dist 197.8757'

Point G250 N 1,874,193.2099 E 2,349,104.0693 Sta 1059+76.49

Course from G250 to PC 70390 111° 31' 40.29" Dist 730.0333'

FILE NAME =	USER NAME = ditzlerse	DESIGNED -	REVISED -	STATE OF ILLINOIS DEPARTMENT OF TRANSPORTATION	PROPOSED HORIZONTAL CONTROL	F.A.P. RTE.	SECTION	COUNTY	TOTAL SHEETS	SHEET NO.
cd:\pwork\pwork\ditzlerse\dms34552\sl3805hvo.dgn	DRAWN -	REVISED -	309			(17)B	WHITESIDE	376	15	
PLOT SCALE = 50.0000' / IN.	CHECKED -	REVISED -	CONTRACT NO. 64B74							
PLOT DATE = Fri Mar 13 08:49:21 2009	DATE -	REVISED -	ILLINOIS FED. AID PROJECT							
					SCALE:	SHEET NO. OF SHEETS STA. TO STA.				