

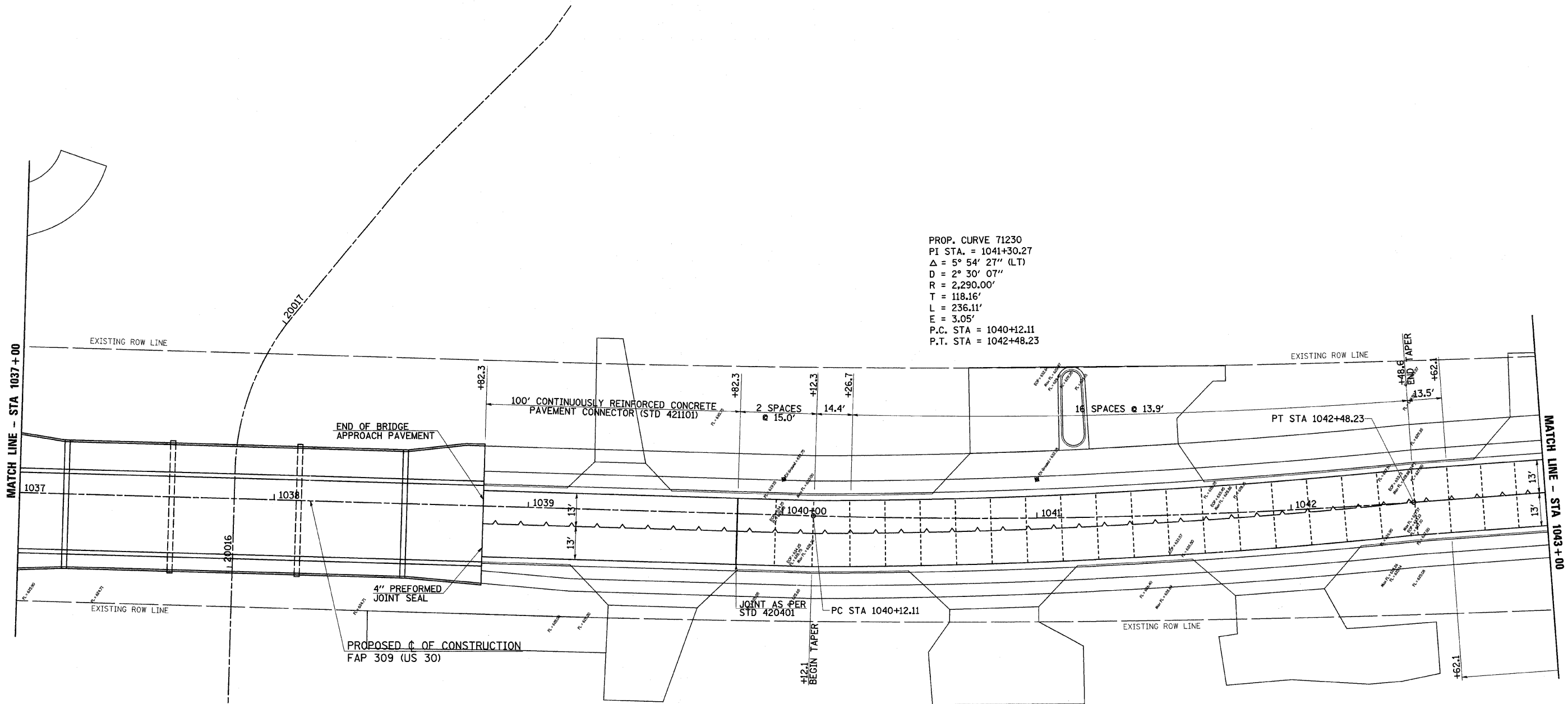



PROP. CURVE 71230
 PI STA. = 1041+30.27
 $\Delta = 5^\circ 54' 27''$ (LT)
 $D = 2^\circ 30' 07''$
 $R = 2,290.00'$
 $T = 118.16'$
 $L = 236.11'$
 $E = 3.05'$
 P.C. STA = 1040+12.11
 P.T. STA = 1042+48.23



NOTE: SAWED CONTRACTION JOINT SPACING IS MEASURED ALONG THE CROWN LINE OF THE PROPOSED PAVEMENT.

LEGEND:

-  LONGITUDINAL CONSTRUCTION JOINT, STD 420001
-  LONGITUDINAL SAWED OR CONSTRUCTION JOINT, STD 420001
-  SAWED CONTRACTION JOINT WITH 1 1/2" DOWELS, STD 420001

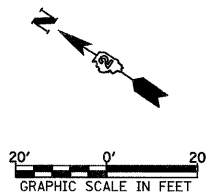

FILE NAME =	USER NAME = dtzlerse	DESIGNED - AWM	REVISED -
ct:\pwwork\pwi\dot\dtzlerse\dms34552\2247002.dgn		DRAWN - TJD	REVISED -
PLOT SCALE = 20,0000' / IN.		CHECKED - AWM	REVISED -
PLOT DATE = Fri Mar 13 08:46:35 2009		DATE - 1/16/09	REVISED -

STATE OF ILLINOIS
 DEPARTMENT OF TRANSPORTATION

PCC PAVEMENT JOINTING PLAN

SCALE: 1"=20' SHEET NO. 2 OF 3 SHEETS STA. 1037+00 TO STA. 1043+00

F.A.P. RTE.	SECTION	COUNTY	TOTAL SHEETS	SHEET NO.
309	(17)B	WHITESIDE	376	34
CONTRACT NO. 64B74				

FED. ROAD DIST. NO. ILLINOIS FED. AID PROJECT