

STATE OF ILLINOIS
DEPARTMENT OF TRANSPORTATION

Sheet S22 of S25

F.A.P. RTE.	SECTION	COUNTY	TOTAL SHEETS	SHEET NO.
309	(17)B	WHITESIDE	376	72
FED. ROAD DIST. NO. 2		ILLINOIS FED. AID PROJECT		

Contract #64B74

When cantilever forming brackets are used, the work shall be done according to Article 503.06(b) of the Standard Specifications, except as modified below and in the details shown on this sheet.

The finishing machine rails shall be placed on the top flange of the exterior beams.

The beams or girders, supporting cantilever forming brackets, shall be tied together at 4 foot intervals.

For Standard construction, or Stage Construction the Hardwood bracing materials shall be placed as shown between webs of beams in each bay.

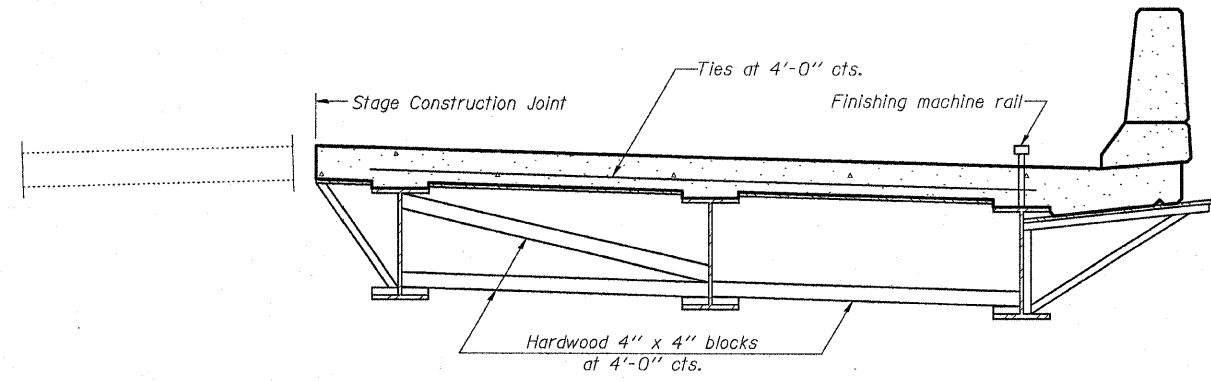

**FORM BRACES FOR
STAGE CONSTRUCTION**

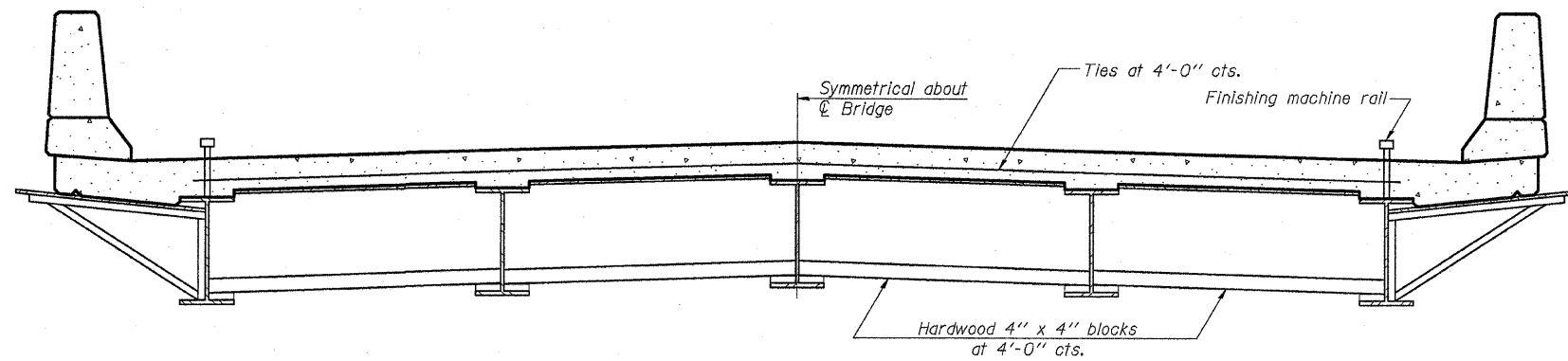

**FORM BRACES FOR
STANDARD CONSTRUCTION**

n:\file\dot\20608_05\work_order#\us_30_over_rock_creek\drawings\struct\22-Cantilever Brackets.dgn
 02/17/2008 2:28:33 PM

PATRICK
ENGINEERING INC.
LISLE, ILLINOIS

SB-1

10-1-08

CANTILEVER FORMING BRACKETS
U.S. RTE. 30/IL RTE. 78 OVER ROCK CREEK
F.A.P. ROUTE 309, SECTION (17)B
WHITESIDE COUNTY
STATION 1037+84.35
STRUCTURE NO. 098-0113

DATE: December 18, 2008
DRAWN BY: D. Schettler
CHECKED BY: A. Yargicoglu