

# EROSION CONTROL

IMPROVEMENT ENDS  
STA. 794+41

SECTION ENDS  
STA. 789+92.7

STA 789+50 RT  
PROPOSED  
50' PIPE CULVERT CLASS D, T1, 15"  
2 EACH END SECTIONS 15"  
INLET ELEV=772.02  
OUTLET ELEV=771.80

STA 1786+22.15 (IL ROUTE 72) =  
STA 787+24.80 (IL ROUTE 251)

EXIST. CURVE 200  
PI STA. = 1791+53.98  
 $\Delta = 36^\circ 31' 34''$  (RT)  
D = 4° 58' 53"  
R = 1,150.17'  
T = 379.56'  
L = 733.23'  
E = 61.01'  
e = ----  
T.R. = ----  
S.E. RUN = ----  
P.C. STA. = 1787+74.42  
P.T. STA. = 1795+07.66

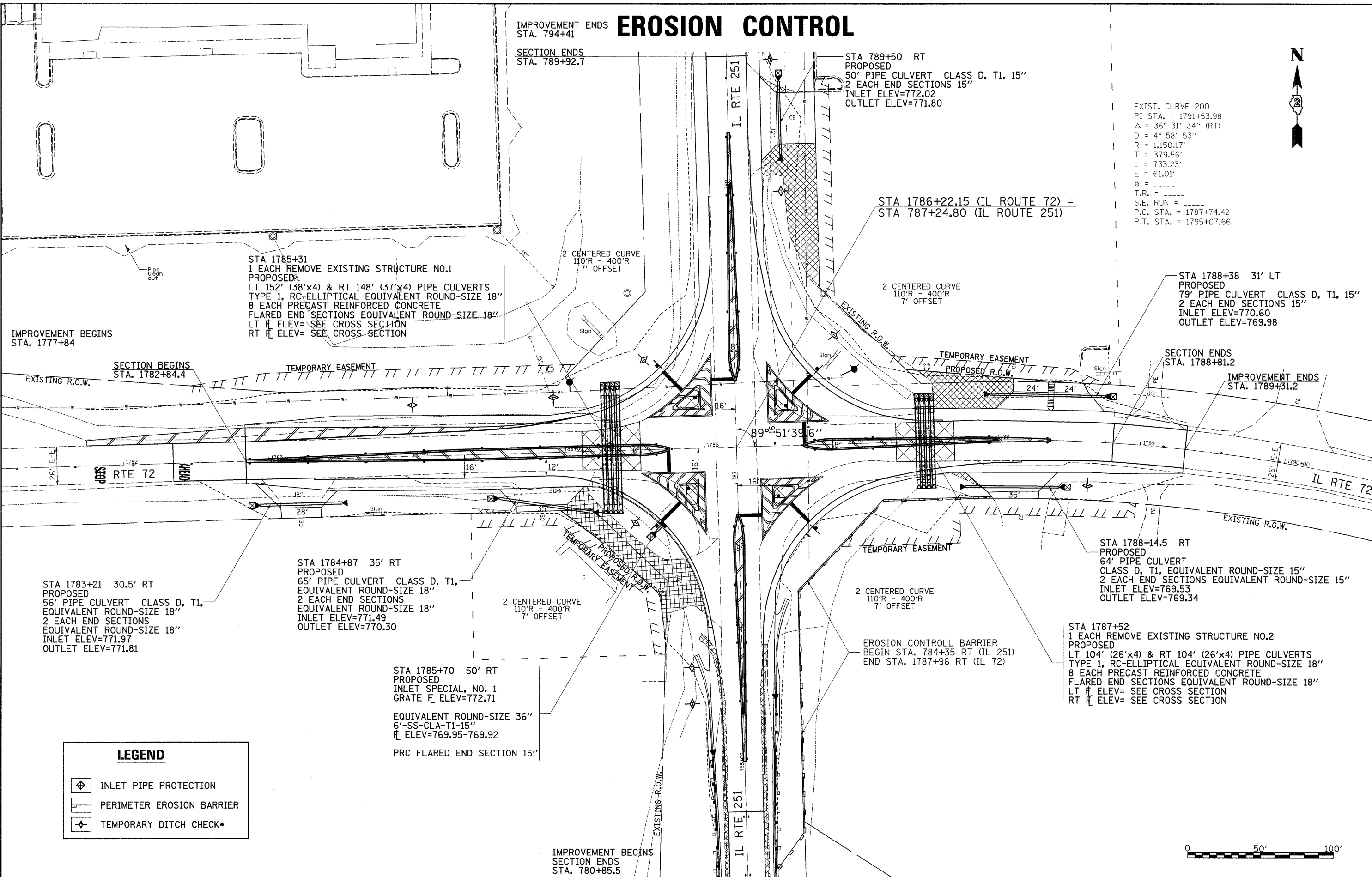

IMPROVEMENT BEGINS  
STA. 1777+84

SECTION BEGINS  
STA. 1782+84.4

SECTION ENDS  
STA. 1788+81.2

IMPROVEMENT ENDS  
STA. 1789+31.2

STA 1783+21 30.5' RT  
PROPOSED  
56' PIPE CULVERT CLASS D, T1,  
EQUIVALENT ROUND-SIZE 18"  
2 EACH END SECTIONS  
EQUIVALENT ROUND-SIZE 18"  
INLET ELEV=771.97  
OUTLET ELEV=771.81

STA 1785+31  
1 EACH REMOVE EXISTING STRUCTURE NO.1  
PROPOSED:  
LT 152' (38'x4) & RT 148' (37'x4) PIPE CULVERTS  
TYPE 1, RC-ELLIPTICAL EQUIVALENT ROUND-SIZE 18"  
8 EACH PRECAST REINFORCED CONCRETE  
FLARED END SECTIONS EQUIVALENT ROUND-SIZE 18"  
LT # ELEV= SEE CROSS SECTION  
RT # ELEV= SEE CROSS SECTION

STA 1784+87 35' RT  
PROPOSED  
65' PIPE CULVERT CLASS D, T1,  
EQUIVALENT ROUND-SIZE 18"  
2 EACH END SECTIONS  
EQUIVALENT ROUND-SIZE 18"  
INLET ELEV=771.49  
OUTLET ELEV=770.30

STA 1785+70 50' RT  
PROPOSED  
INLET SPECIAL, NO. 1  
GRATE # ELEV=772.71  
  
EQUIVALENT ROUND-SIZE 36"  
6'-SS-CLA-T1-15"  
# ELEV=769.95-769.92  
PRC FLARED END SECTION 15"

STA 1788+14.5 RT  
PROPOSED  
64' PIPE CULVERT  
CLASS D, T1, EQUIVALENT ROUND-SIZE 15"  
2 EACH END SECTIONS EQUIVALENT ROUND-SIZE 15"  
INLET ELEV=769.53  
OUTLET ELEV=769.34

STA 1787+52  
1 EACH REMOVE EXISTING STRUCTURE NO.2  
PROPOSED  
LT 104' (26'x4) & RT 104' (26'x4) PIPE CULVERTS  
TYPE 1, RC-ELLIPTICAL EQUIVALENT ROUND-SIZE 18"  
8 EACH PRECAST REINFORCED CONCRETE  
FLARED END SECTIONS EQUIVALENT ROUND-SIZE 18"  
LT # ELEV= SEE CROSS SECTION  
RT # ELEV= SEE CROSS SECTION

**LEGEND**

- INLET PIPE PROTECTION
- PERIMETER EROSION BARRIER
- TEMPORARY DITCH CHECK\*

IMPROVEMENT BEGINS  
SECTION ENDS  
STA. 780+85.5

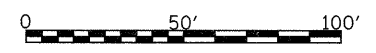

FILE NAME =	USER NAME = dossdd	DESIGNED -	REVISED -	<b>STATE OF ILLINOIS DEPARTMENT OF TRANSPORTATION</b>	<b>IL 251 &amp; IL 72 EROSION CONTROL SHEET</b>			F.A.P. RTE.	SECTION	COUNTY	TOTAL SHEETS	SHEET NO.			
02\pwwork\pwwid01\DOSSDD\dms41852\d0780	beros.dgn	DRAWN -	REVISED -		SCALE: 1" = 30'	SHEET NO.	OF	SHEETS	STA.	TO STA.	553	120M	OGLE	71	34
		PLOT SCALE = 30.0000" / IN.	CHECKED -		CONTRACT NO. 64E55										
		PLOT DATE = Tue Jan 13 15:45:58 2009	DATE -		ILLINOIS FED. AID PROJECT										