

| | | | | |
|-------|---------|---------|--------------|-----------|
| ROUTE | SECTION | COUNTY | TOTAL SHEETS | SHEET NO. |
| 39 | VARIOUS | LASALLE | 14 | 12 |

MATERIALS REQUIRED FOR (1) ONE WIDE FLANGE BEAM TERMINAL JOINT COMPLETE (SPL)

| Bar | No. | Size | Length | Splice |
|-----|-----|------|--------|--------|
| a | 44 | #4 | 19'-0" | |
| b | 29 | #5 | 43'-4" | |
| c | 77 | #6 | 8'-0" | |

RCC Pavt. or Class X Conc., CY 11.9
 Reinforcement Bars, Lbs. 2617
 Structural Steel, Lbs. 3248*

* Weight includes beam, end plates, stiffener plates and studs

Pavement, Sq. Yds. 130.7
 Pavt. Reinf., Sq. Yds. 130.7
 4" Stab. Sub-base, Sq. Yds. 117.8

NE OR SW QUANTITIES

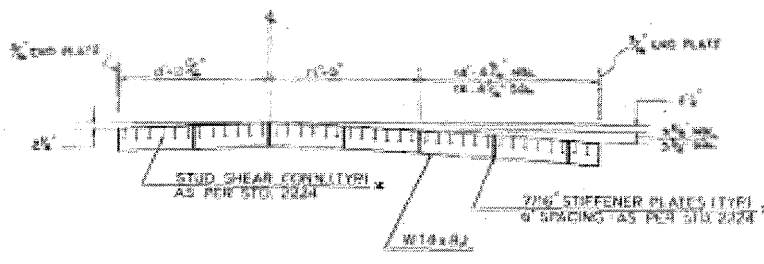

NE APPROACH STA. 1031+15.60 NBL (LOOKING NORTH)
 SW APPROACH STA. 1025+89.48 SBL (LOOKING SOUTH)

MATERIALS REQUIRED FOR (1) ONE WIDE FLANGE BEAM TERMINAL JOINT COMPLETE (SPL)

| Bar | No. | Size | Length | Splice |
|-----|-----|------|--------|--------|
| a | 44 | #4 | 19'-0" | |
| b | 29 | #5 | 43'-4" | |
| c | 87 | #6 | 8'-0" | |

RCC Pavt. or Class X Conc., CY 13.5
 Reinforcement Bars, Lbs. 2980
 Structural Steel, Lbs. 3692*

* Weight includes beam, end plates, stiffener plates and studs

Pavement, Sq. Yds. 147.4
 Pavt. Reinf., Sq. Yds. 147.4
 4" Stab. Sub-base, Sq. Yds. 131.7

NW OR SE QUANTITIES

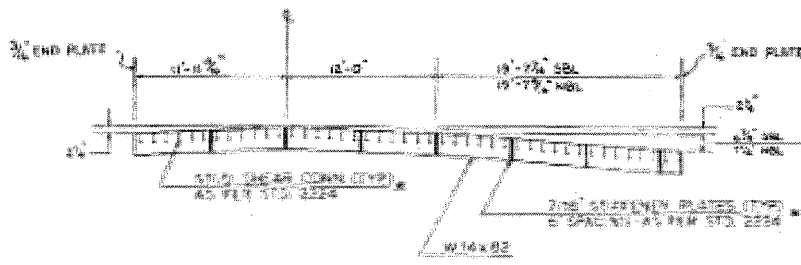

NW APPROACH STA. 1031+04.48 SBL (LOOKING SOUTH)
 SE APPROACH STA. 1025+00.00 NBL (LOOKING NORTH)

* NOTE STUDS & STIFFENER PLATES TO BE WELDED TO BRIDGE SIDE OF BEAM

50-5HB WIDE FLANGE BEAM DETAILS

FOR INFORMATION ONLY