

F.A.I. RTE.	SECTION	COUNTY	TOTAL SHEETS	SHEET NO.
55	VARIOUS	LIVINGSTON	13	1
ILLINOIS		CONTRACT NO. 66940		

STATE OF ILLINOIS
DEPARTMENT OF TRANSPORTATION
DIVISION OF HIGHWAYS

**PROPOSED
HIGHWAY PLANS**

FAI ROUTE 55 (I-55)
SECTION VARIOUS / (53-1) I-4

**PAVEMENT PATCHING/RECONSTRUCTION
LIVINGSTON AND GRUNDY COUNTIES**
C-93-076-09

INDEX OF SHEETS

1. COVER SHEET
2. GENERAL NOTES
3. SUMMARY OF QUANTITIES
- 4-5. TYPICAL SECTIONS
- 6-8. SCHEDULES
- 9-10. CLASS A PATCHING DETAILS
11. PAVEMENT RECONSTRUCTION DETAILS
12. TYPICAL PAVEMENT MARKING
13. RAMP CLOSURE SIGNING

STANDARDS

- | | |
|-----------|--|
| 000001-05 | STANDARD SYMBOLS, ABBREVIATIONS AND PATTERNS |
| 001001-02 | AREAS OF REINFORCEMENT BARS |
| 001006 | DECIMAL OF AN INCH AND OF A FOOT |
| 420001-07 | PAVEMENT JOINTS |
| 420701-02 | PAVEMENT FABRIC |
| 421001-02 | BAR REINFORCEMENT FOR CRC PAVEMENT |
| 442001-04 | CLASS A PATCHES |
| 483001-04 | PCC SHOULDER |
| 701101-02 | OFF-ROAD OPERATIONS MULTILANE, 15' (4.5 m) TO 24" (600 mm) FROM PAVEMENT EDGE |
| 701106-02 | OFF-ROAD OPERATIONS, MULTILANE, MORE THAN 15' (4.5 m) AWAY |
| 701400-03 | APPROACH TO LANE CLOSURE, FREEWAY/EXPRESSWAY |
| 701401-05 | LANE CLOSURE, FREEWAY/EXPRESSWAY |
| 701411-05 | LANE CLOSURE, MULTILANE, AT ENTRANCE OR EXIT RAMP FOR SPEEDS ≥ 45 MPH |
| 701422-02 | LANE CLOSURE, MULTILANE, FOR SPEEDS ≥ 45 MPH TO 55 MPH |
| 701426-03 | LANE CLOSURE, MULTILANE, INTERMITTENT OR MOVING OPERATIONS FOR SPEEDS ≥ 45 MPH |
| 701451 | RAMP CLOSURE FREEWAY/EXPRESSWAY |
| 701901-01 | TRAFFIC CONTROL DEVICES |

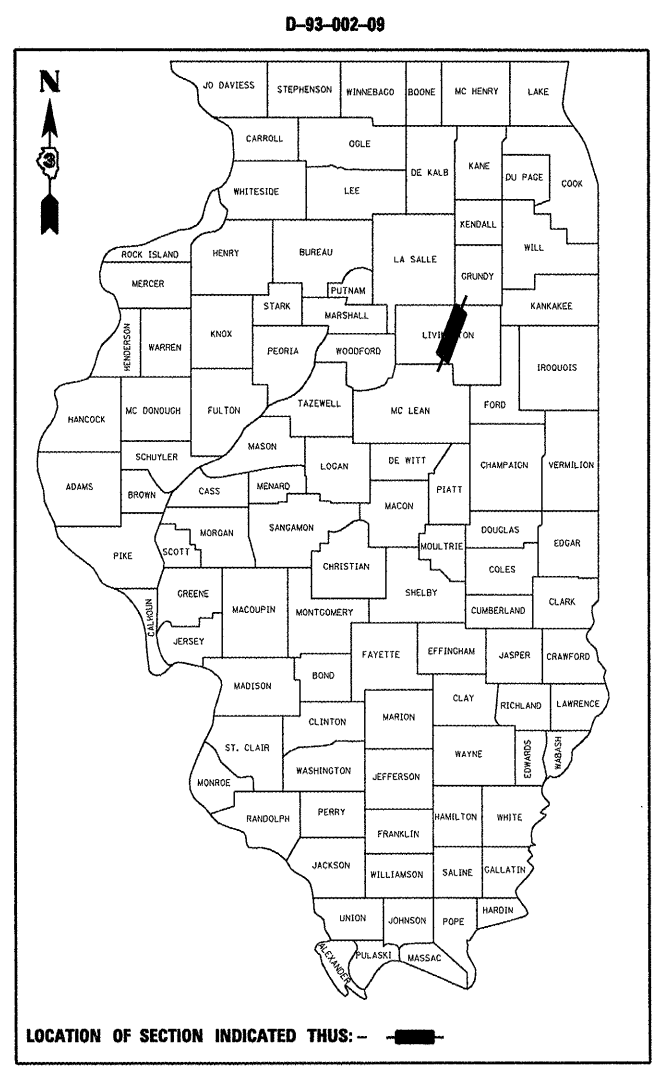

FUNCTIONAL CLASSIFICATION
RURAL - INTERSTATE
FAI ROUTE 55 (I-55)
2007 ADT = 20400
P.V. = 69.1% M.U. = 26.5% S.U. = 4.4%

PAVEMENT RECONSTRUCTION

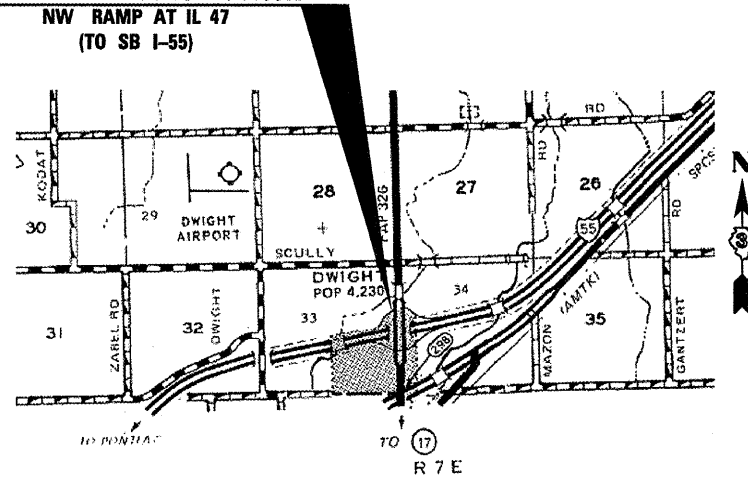

J.U.L.I.E.
JOINT UTILITY LOCATION INFORMATION FOR EXCAVATION
1-800-892-0123
OR 811

PROJECT ENGINEER: JOE KANNEL
UNIT CHIEF: RON WOODSHANK
TOWNSHIPS: VARIOUS
CONTRACT NO. 66940

END PAVEMENT PATCHING
GRUNDY COUNTY LINE
(M.M. 218.07)

BEGIN PAVEMENT PATCHING
McCLEAN COUNTY LINE
(M.M. 187.70)

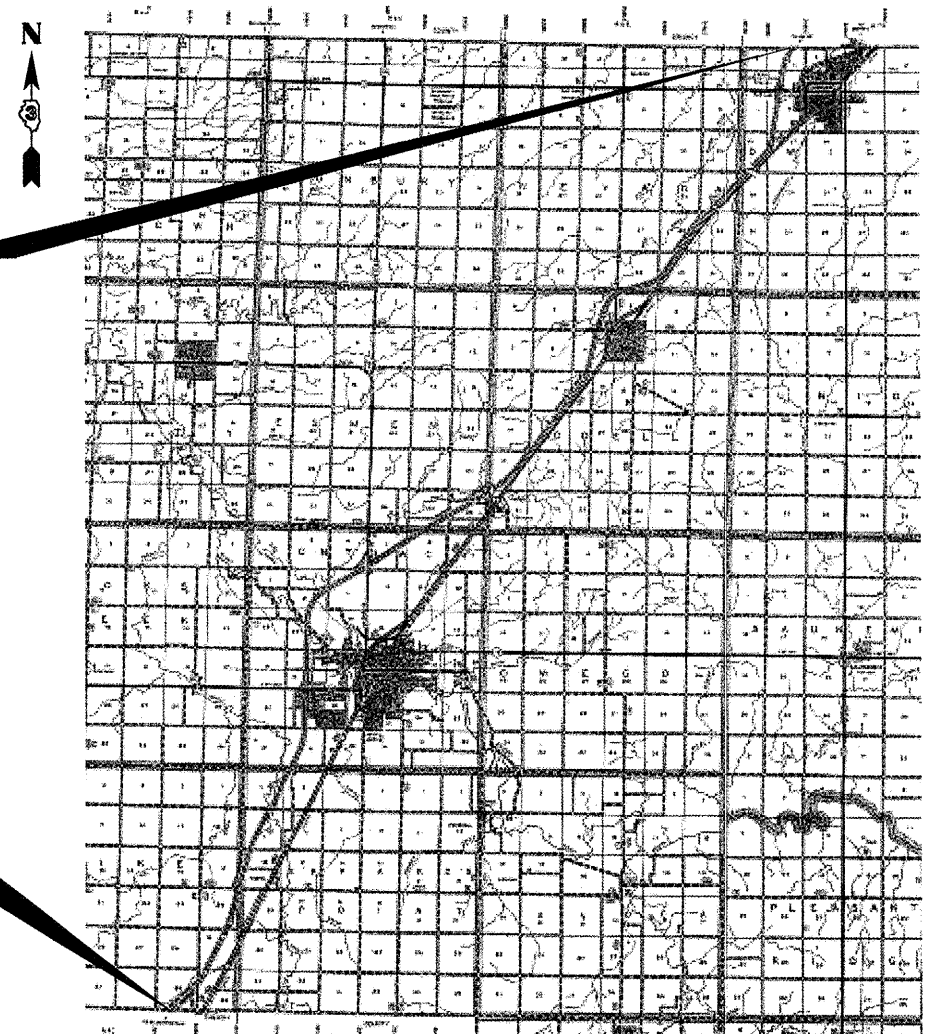

STATE OF ILLINOIS
DEPARTMENT OF TRANSPORTATION
DIVISION OF HIGHWAYS

SUBMITTED 7/2 2009
George Ryan
DEPUTY DIRECTOR OF HIGHWAYS, REGION ENGINEER

May 8, 2009
Charles G. Ingensoll
ENGINEER OF DESIGN AND ENVIRONMENT

May 8, 2009
Christine M. Reed
DIRECTOR OF HIGHWAYS, CHIEF ENGINEER

**PRINTED BY THE AUTHORITY
OF THE STATE OF ILLINOIS**