

INDEX OF SHEETS

- 1. COVER SHEET
- 2-3. COMMITMENTS AND GENERAL NOTES
- 4-5. SUMMARY OF QUANTITIES
- 6-8. TYPICAL SECTIONS
- 9-13. SCHEDULES OF QUANTITIES
- 14. LINE DIAGRAM
- 15. PAVEMENT MARKING DETAIL
- 16-23. CADD STANDARDS
HIGHWAY STANDARDS

HIGHWAY STANDARDS

000001-05	701001-02	701336-05
442201-03	701006-03	701901-01
630001-08	701301-03	780001-02
635006-03	701306-02	781001-03
635011-02	701311-03	

DISTRICT CADD STANDARDS

406101-D4	630101-D4
440001-D4	780001-D4

ADT: 6,000 (2007)
2.08% MU & 3.75% SU

PROJECT DESCRIPTION

RESURFACING ON IL 91
FROM WEST OF ALTA RD./IL 91
INTERSECTION TO LEGION HALL RD.

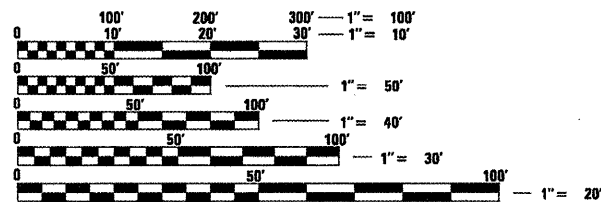

FULL SIZE PLANS HAVE BEEN PREPARED USING STANDARD ENGINEERING SCALES. REDUCED SIZED PLANS WILL NOT CONFORM TO STANDARD SCALES. IN MAKING MEASUREMENTS ON REDUCED PLANS, THE ABOVE SCALES MAY BE USED.

PROJECT ENGINEER: CHRISTOPHER MAUSHARD 309.671.3453
PROJECT MANAGER: MIKE MOHAMED 309.671.3462

CONTRACT NO. 68612
CATALOG NO. 033303-00D

STATE OF ILLINOIS
DEPARTMENT OF TRANSPORTATION
DIVISION OF HIGHWAYS
PROPOSED
HIGHWAY PLANS

F.A.S. ROUTE 1380 (IL 91)
SECTION 2RS-4, 3RS-3, 7RS-4
RESURFACING PROJECT
PEORIA COUNTY
PROJECT ESP-1380(106)
C-94-102-06

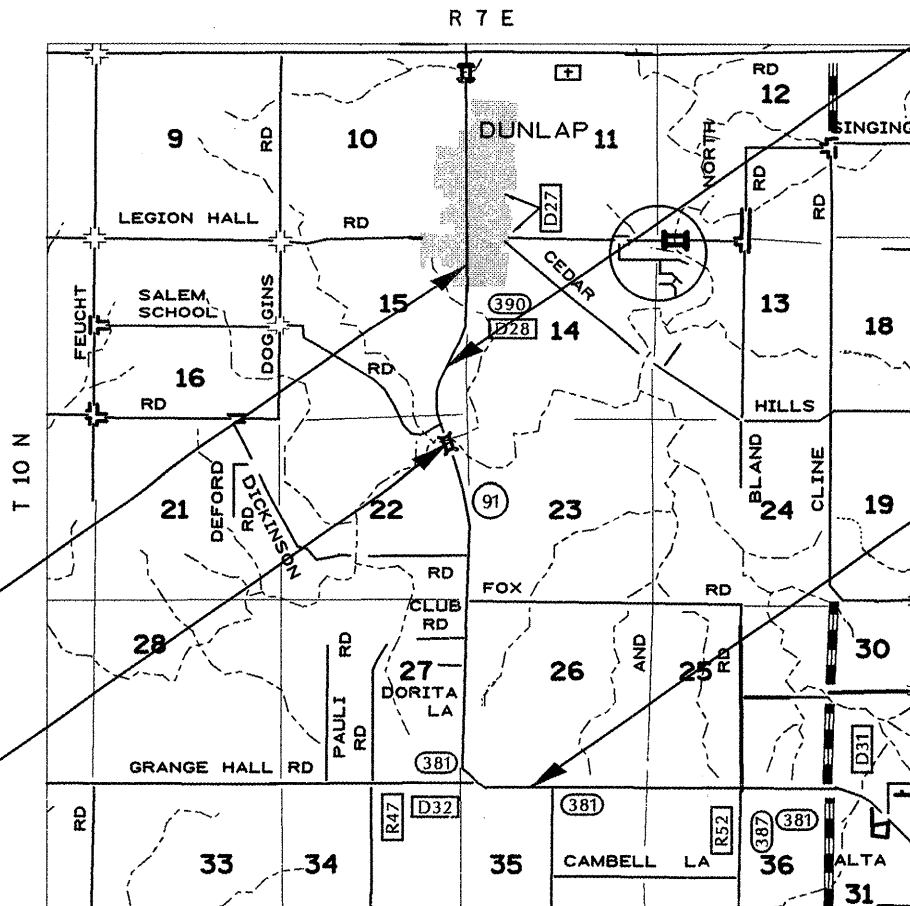

PROJECT ENDS
STA. 111 + 53.30

OMISSION
S.N. 072-0155
STA. 46 + 97.00
TO STA. 47 + 89.00

OMISSION
STA. 66 + 90.00
TO STA. 82 + 25.00

PROJECT BEGINS
STA. 143 + 19.60

FOR STATION EQUATIONS SEE LINE DIAGRAM

GROSS LENGTH = 17,974.33 FT. = 3.404 MILE
NET LENGTH = 16,347.33 FT. = 3.096 MILE

F.A.S. RTE.	SECTION	COUNTY	TOTAL SHEETS	SHEET NO.
1380	2RS-4, 3RS-3, 7RS-4	PEORIA	23	1
		ILLINOIS	CONTRACT NO. 68612	

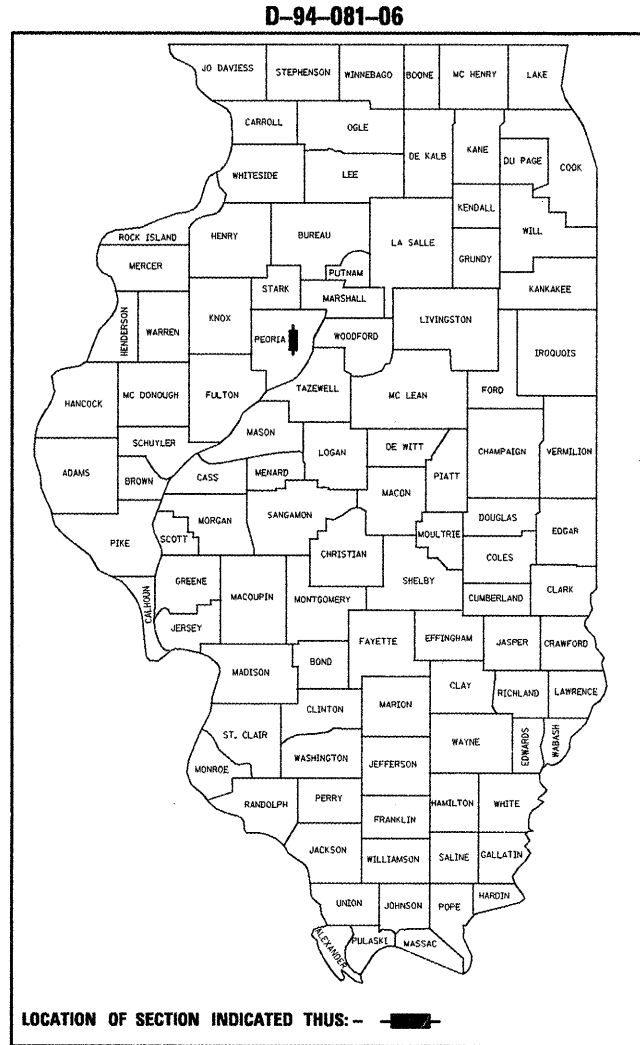

J.U.L.I.E.
JOINT UTILITY LOCATION INFORMATION FOR EXCAVATION
1-800-992-0123
OR 811

STATE OF ILLINOIS
DEPARTMENT OF TRANSPORTATION
DIVISION OF HIGHWAYS

SUBMITTED *March 26, 2009*

[Signature]
DEPUTY DIRECTOR OF HIGHWAYS, REGION ENGINEER

May 8, 2009
Charles J. Orgero
ENGINEER OF DESIGN AND ENVIRONMENT

May 8, 2009
Christine M. Reed
DIRECTOR OF HIGHWAYS, CHIEF ENGINEER

**PRINTED BY THE AUTHORITY
OF THE STATE OF ILLINOIS**