

F.A.P. RTE.	SECTION	COUNTY	TOTAL SHEETS	SHEET NO.
614		CASS, MASON	351	1

• 144(B-1, B-2)

STATE OF ILLINOIS  
DEPARTMENT OF TRANSPORTATION  
DIVISION OF HIGHWAYS  
**PROPOSED  
HIGHWAY PLANS**

FAP ROUTE 614 (IL 78)  
SECTION 144(B-1, B-2)  
PROJECT: ACF-BRF-0614(031)  
CASS AND MASON COUNTIES  
C-96-514-08

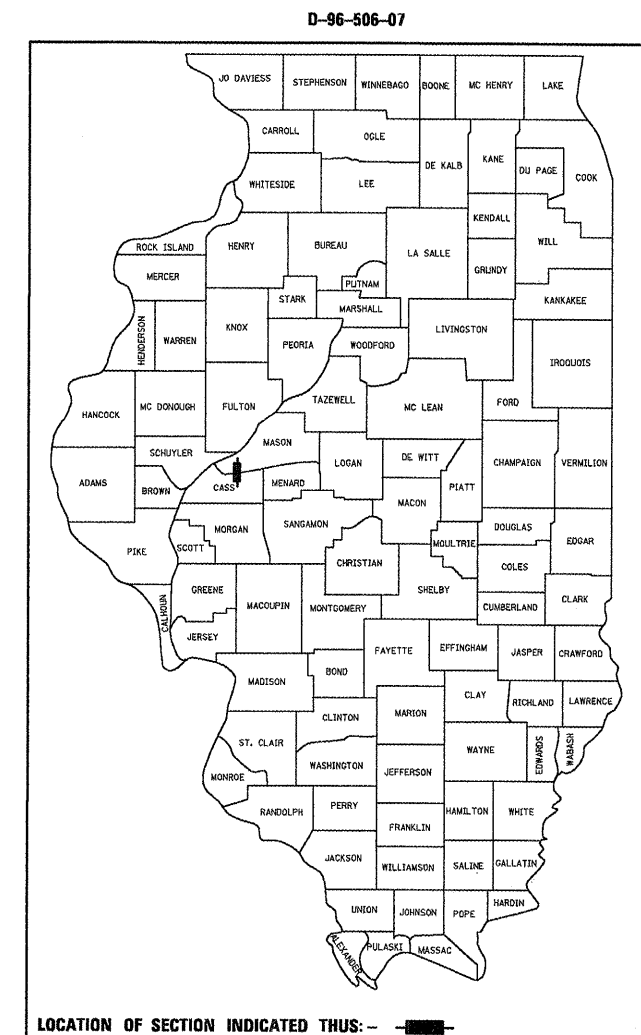

LOCATION OF SECTION INDICATED THIS: -

**CB** Coombe-Bloxdorf P.C.  
-CIVIL ENGINEERS-  
-STRUCTURAL ENGINEERS-  
-LAND SURVEYORS-  
Design Firm License No. 184-002703

STATE OF ILLINOIS  
DEPARTMENT OF TRANSPORTATION  
DIVISION OF HIGHWAYS

SUBMITTED March 27 2009  
Raymond D. Smith  
DEPUTY DIRECTOR OF HIGHWAYS, REGION ENGINEER

May 8, 2009  
Charles J. Ingersoll  
ENGINEER OF DESIGN AND ENVIRONMENT

May 8, 2009  
Christine M. Reed  
DIRECTOR OF HIGHWAYS, CHIEF ENGINEER

**PRINTED BY THE AUTHORITY  
OF THE STATE OF ILLINOIS**

INDEX OF SHEETS

SHT. NO.	DESCRIPTION
1	COVER SHEET
2	GENERAL NOTES AND COMMITMENTS
3-7	SUMMARY OF QUANTITIES
8-12	SCHEDULE OF QUANTITIES
13-23	TYPICAL CROSS SECTIONS
24-28	SURVEY LAYOUT INFORMATION
29-50	TRAFFIC CONTROL & PROTECTION AND STAGING DETAILS
51	PPP LINE DIAGRAM
52-67	PLAN & PROFILE SHEETS
68-69	RELOCATION PAVEMENT CONNECTER DETAILS
70-72	BOAT RAMP & PARKING AREA LAYOUT & ELEVATION DETAILS
73-75	BOAT RAMP AND PARKING AREA TYPICAL SECTIONS AND DETAILS
76-77	BOAT RAMP PROFILES
78-79	ACCESS GATE DETAILS
80-83	ENTRANCE DETAILS
84	BRIDGE APPROACH PIPE DRAIN OUTLET AND RIPRAP SWALE DETAILS
85	BUTT JOINT AND FILLSLOPE STEPPING DETAILS
86	FIELD TILE REPLACEMENT DETAILS
87	PERMANENT EROSION PROTECTION DETAILS
88-99	STORM WATER POLLUTION AND PREVENTION PLAN
100-103	BRIDGE APPROACH PAVEMENT DETAILS
104	BIG LAKE FILL DETAILS
105	TEMPORARY BRIDGE TRAFFIC SIGNAL DETAILS
106-107	BRIDGE REPAIR DETAIL SN 009-0006
108-136	BRIDGE DETAILS (SN 063-0500) -- WOLF LAKE
137-222	BRIDGE DETAILS (SN 009-0510) -- SANGAMON RIVER
223-226	BOX CULVERT DETAILS (SN 009-2509)
227-328	CROSS SECTIONS - FAP 614 (IL 78)
329-342	CROSS SECTIONS - SANGAMON RIVER, NORTH BANK
343-351	CROSS SECTIONS - SANGAMON RIVER, SOUTH BANK

LIST OF STANDARDS

000001-05	606006-02	701301-03
001001-02	609001-04	701306-02
001006	609006-04	701311-03
280001-04	630001-08	701321-10
<del>420401-07</del>	630301-05	701326-03
420701-02	631031-07	701331-03
442201-04	635006-03	701901-01
515001-03	635011-02	704001-05
542301-02	666001-01	720001-01
542401-01	701001-02	720006-02
601101-01	701006-03	728001-01
602301-02	701011-02	780001-02
604036-02	701201-03	781001-03

STA 913+26.00  
EX SN 009-0005 TO BE  
REMOVED AND REPLACED  
W/SN 009-0510  
(12 SPAN, 54" & 66" WEB PLATE  
GIRDER, 1820'-0" BK TO BK  
ABUTMENTS, 39'-2" O TO O  
CONCRETE DECK, SKEWED  
25° RT FWD)

**TRAFFIC DATA**

ADT (2007) = 1,450
PV (88%) = 1,276
SU (6%) = 87
MU (6%) = 87
ADT (2029) = 1,950

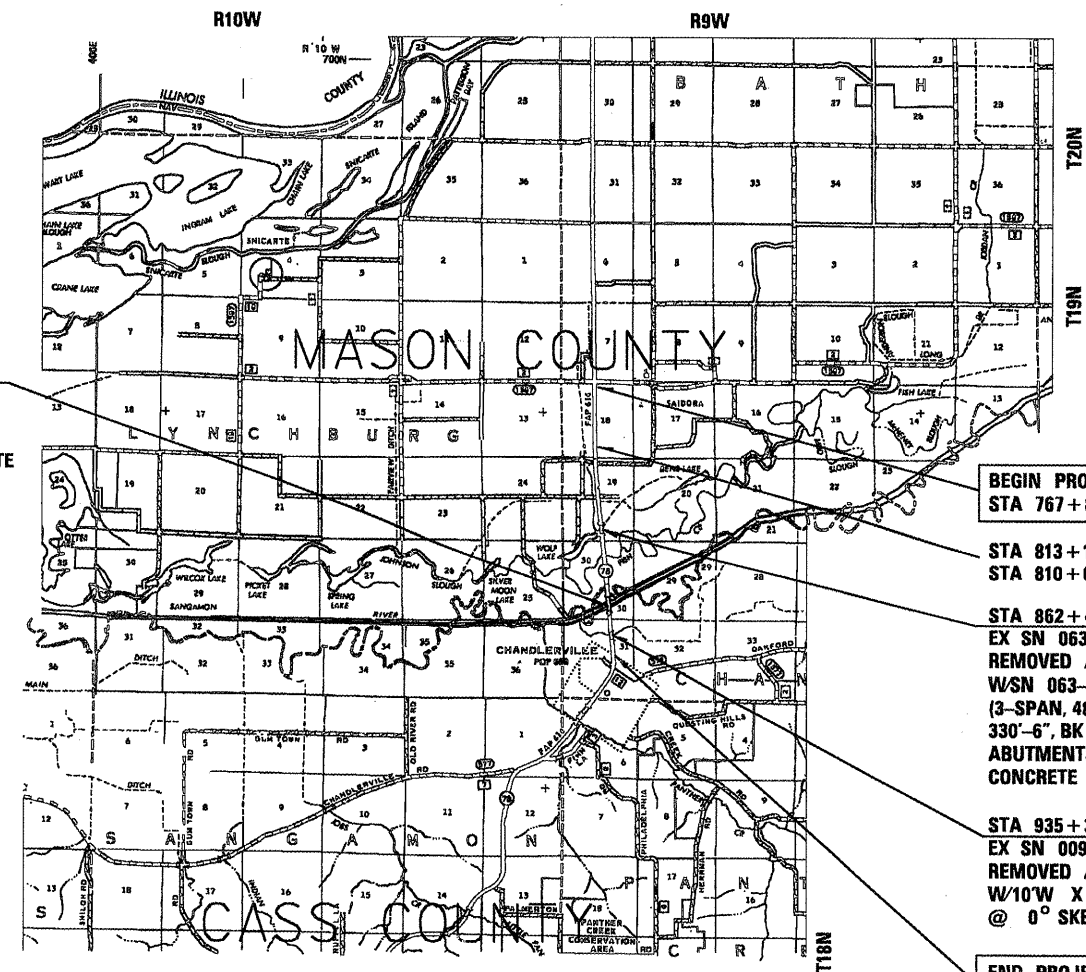

BEGIN PROJECT  
STA 767+80.00

STA 813+19.00 BK =  
STA 810+00.00 AH

STA 862+41.25  
EX SN 063-0007 TO BE  
REMOVED AND REPLACED  
W/SN 063-0500  
(3-SPAN, 48" WEB PLATE GIRDERS,  
330'-6", BK TO BK  
ABUTMENTS, 39'-2" O TO O  
CONCRETE DECK @0° SKEW)

STA 935+35.00  
EX SN 009-0006 TO BE  
REMOVED AND REPLACED  
W/10'W X 10'H R.C. BOX CULVERT  
@ 0° SKEW (SN 009-2509)

END PROJECT  
STA 953+00.00

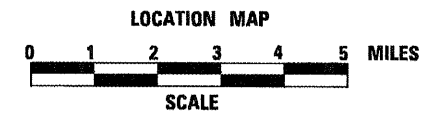

NET PROJECT LENGTH = 18,839.00 FEET = 3.568 MILES  
TOTAL PROJECT LENGTH = 18,839.00 FEET = 3.568 MILES



*Mary Coombe Bloxdorf*  
3/27/09  
Exp. 11/30/09

PROJECT ENGINEER: JOHN MEGANGARD; (217) 782-6990  
SQUAD LEADER: VINCE MADONIA; (217) 785-9046

J.U.L.I.E.  
JOINT UTILITY LOCATION INFORMATION FOR EXCAVATION  
1-800-892-0123

CONTRACT NO. 72A76