

DATE	
BY	
FINAL SURVEY	SURVEYED
NOTE BOOK	PLOTTED
NO.	TEMPLATE
	AREAS CHECKED

DATE	
BY	
ORIGINAL SURVEY	SURVEYED
NOTE BOOK	PLOTTED
NO.	TEMPLATE
	AREAS CHECKED

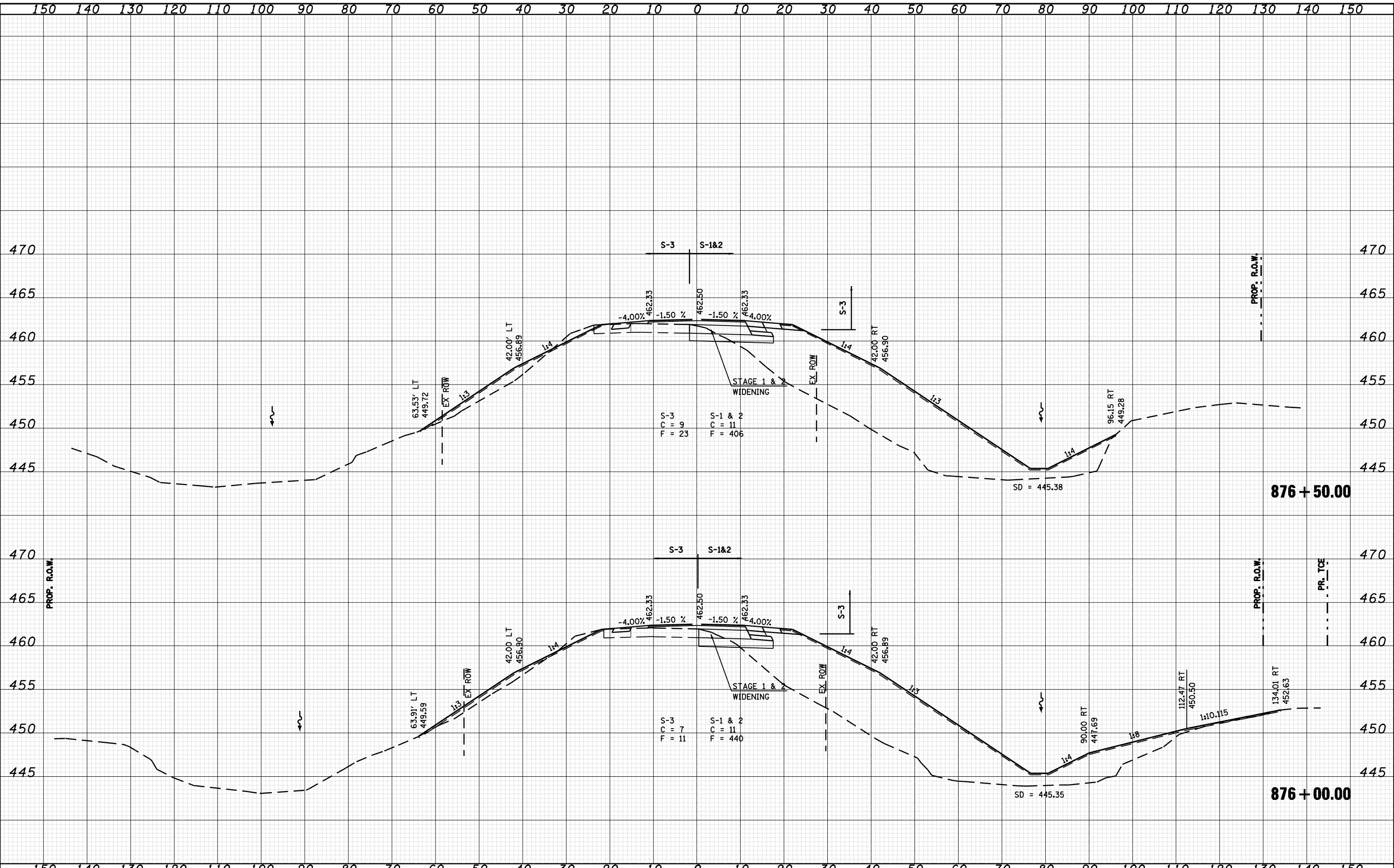

FILE NAME = c:\pwork\PIWIDOT\LAUGHLIN\LD0134498\xsprp001\td\tdm\j-sheets\A.dgn

USER NAME = laughlinr1	DESIGNED -	REVISED -
PLLOT SCALE = 20.0000' / IN.	DRAWN -	REVISED -
PLLOT DATE = Mar-31-2009 08:08:22AM	CHECKED -	REVISED -
	DATE -	REVISED -

STATE OF ILLINOIS
DEPARTMENT OF TRANSPORTATION

IL 78 OVER SANGAMON RIVER

SCALE:	SHEET NO.	OF SHEETS	STA. 876+00.00 TO STA. 876+50.00
--------	-----------	-----------	----------------------------------

F.A.P. RTE. 614	SECTION 144(B-1)	COUNTY CASS, MASON	TOTAL SHEETS 351	SHEET NO. 250
FED. ROAD DIST. NO.	ILLINOIS FED. AID PROJECT	CONTRACT NO. 72A76		