

DATE	
BY	
FINAL SURVEY NO.	
SURVEYED	
PLOTTED	
TEMPLATE	
AREAS CHECKED	

DATE	
BY	
ORIGINAL SURVEY NO.	
SURVEYED	
PLOTTED	
TEMPLATE	
AREAS CHECKED	

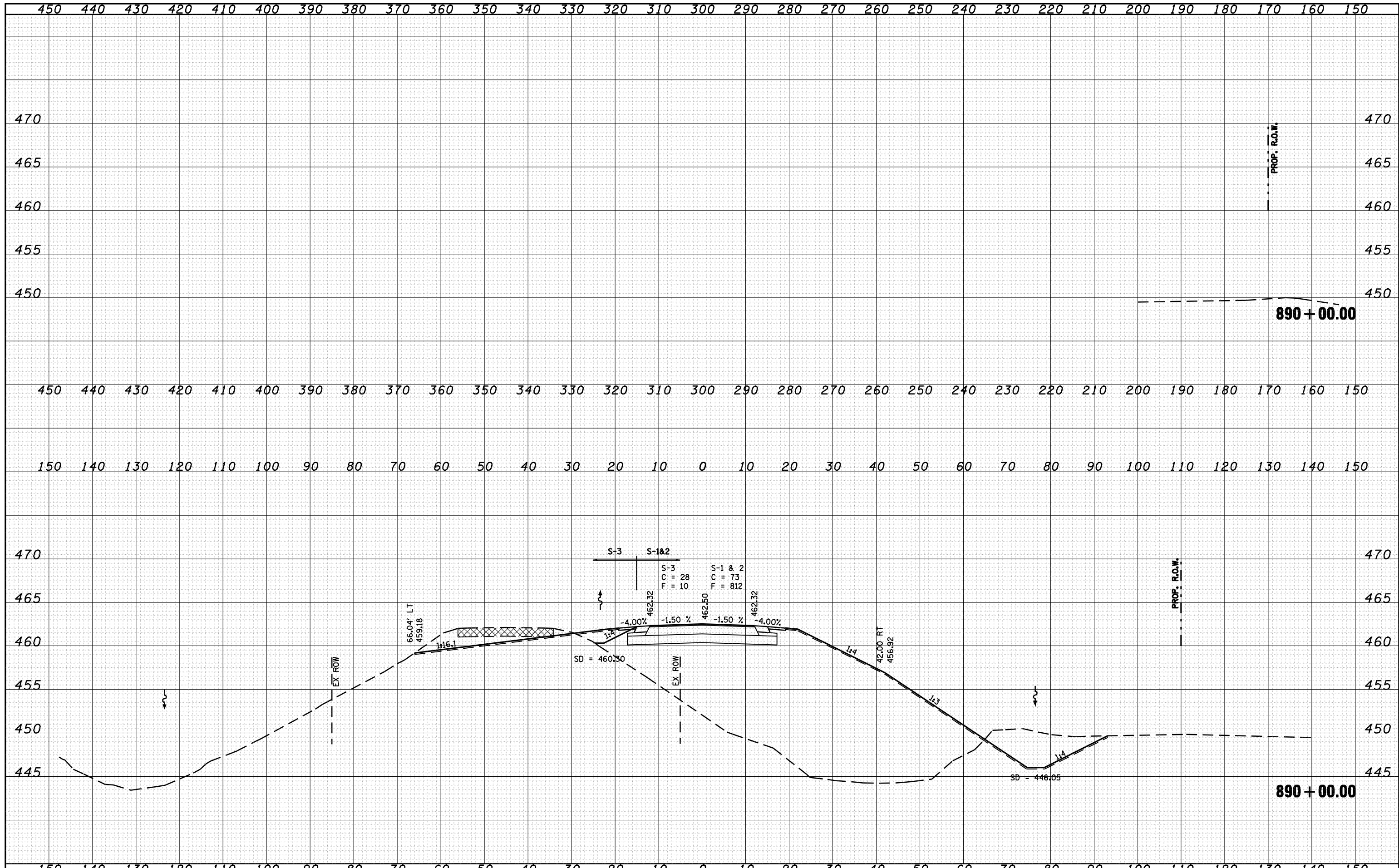

FILE NAME =	USER NAME = laughlinr1	DESIGNED -	REVISED -	STATE OF ILLINOIS DEPARTMENT OF TRANSPORTATION	IL 78 OVER SANGAMON RIVER			F.A.P. RTE.	SECTION	COUNTY	TOTAL SHEETS	SHEET NO.
c:\pwork\pwidot\LAUGHLINR\0134498\ksprp001\111111-j-sheetsA.dgn	DRAWN -	REVISED -	614					144(B-1)	CASS, MASON	351	267	
PLOT SCALE = 20.0000' / IN.	CHECKED -	REVISED -	CONTRACT NO. 72A76									
PLOT DATE = Mar-31-2009 08:08:58AM	DATE -	REVISED -	SCALE:		SHEET NO.	OF SHEETS	STA. 890+00.00 TO STA. 890+00.00	FED. ROAD DIST. NO.	ILLINOIS FED. AID PROJECT			