

STATE OF ILLINOIS  
DEPARTMENT OF TRANSPORTATION  
DIVISION OF HIGHWAYS  
**PROPOSED  
HIGHWAY PLANS**

F.A.I. RTE.	SECTION	COUNTY	TOTAL SHEETS	SHEET NO.
172	1, 1-2)D6PATCHING		6	1
FED. ROAD DIST. NO.	ILLINOIS	CONTRACT NO. 72C74		

FOR INDEX OF SHEETS, SEE SHEET NO. 2

FAI 172 ROUTE (I-172)  
SECTION (1, 1-2)D6PATCHING

CLASS A PATCHING  
ADAMS COUNTY

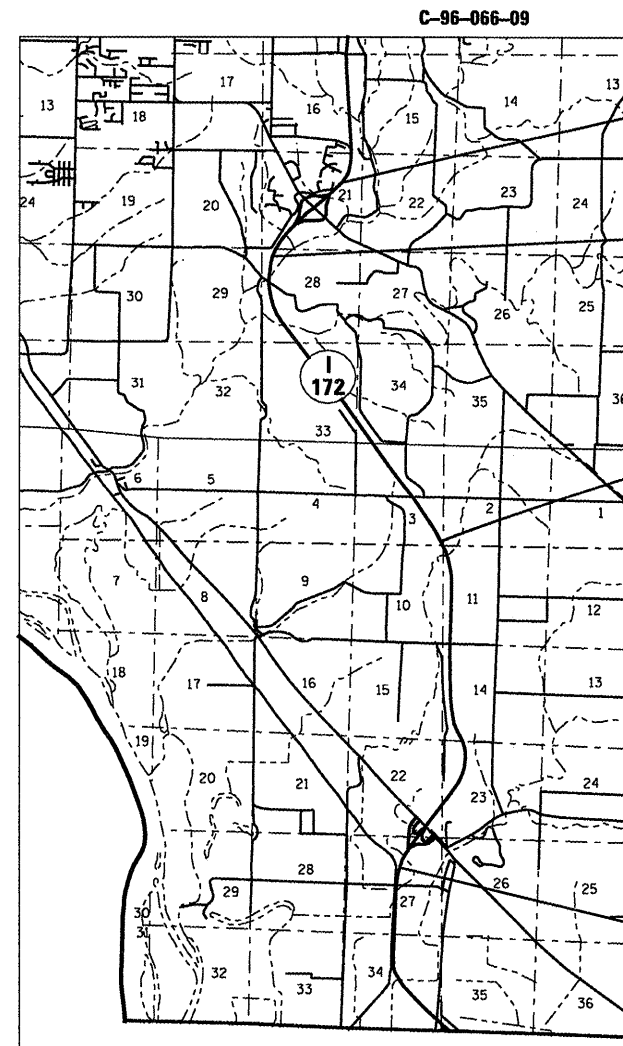
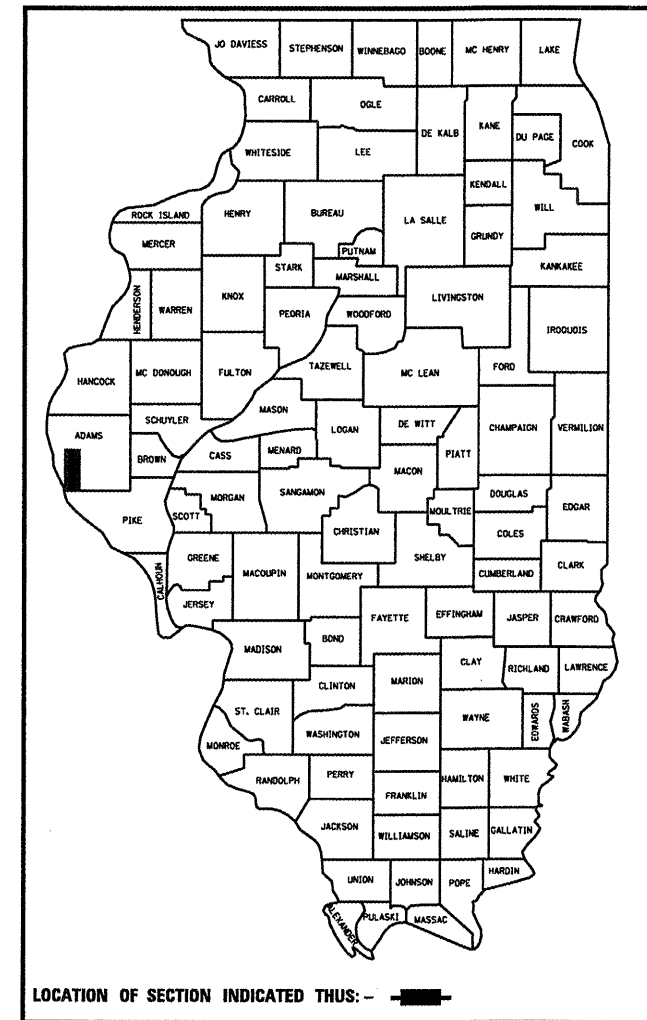

C-96-066-09

END PROJECT  
STA. 66 + 00

STATION EQUATION  
 $197 + 82bk = 30 + 87.58ah$

STATION EQUATION  
 $285 + 95.95bk = 0 + 00ah$

BEGIN PROJECT  
STA. 47 + 00

NET LENGTH = 47,190.37 FT. = 8.938 MILE

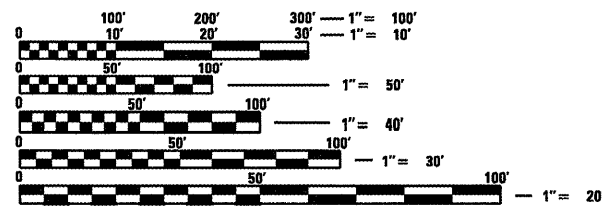

FULL SIZE PLANS HAVE BEEN PREPARED USING STANDARD ENGINEERING SCALES. REDUCED SIZED PLANS WILL NOT CONFORM TO STANDARD SCALES. IN MAKING MEASUREMENTS ON REDUCED PLANS, THE ABOVE SCALES MAY BE USED.

J.U.L.I.E.  
JOINT UTILITY LOCATION INFORMATION FOR EXCAVATION  
1-800-892-0123  
OR 811

PROJECT ENGINEER  
PROJECT MANAGER

CONTRACT NO. 72C74

STATE OF ILLINOIS  
DEPARTMENT OF TRANSPORTATION  
DIVISION OF HIGHWAYS

SUBMITTED February 6, 2009  
Regan Z. Dambin  
DEPUTY DIRECTOR OF HIGHWAYS, REGION ENGINEER

May 1, 2009  
Charles G. Ingensoll  
ENGINEER OF DESIGN AND ENVIRONMENT

May 1, 2009  
Christine M. Reed  
DIRECTOR OF HIGHWAYS, CHIEF ENGINEER

PRINTED BY THE AUTHORITY  
OF THE STATE OF ILLINOIS