

MATCH LINE STA. 1343+00
(SEE EXISTING PLAN AND REMOVALS -5)

MATCH LINE STA. 1350+25 (SEE EXISTING PLAN AND REMOVALS -2)

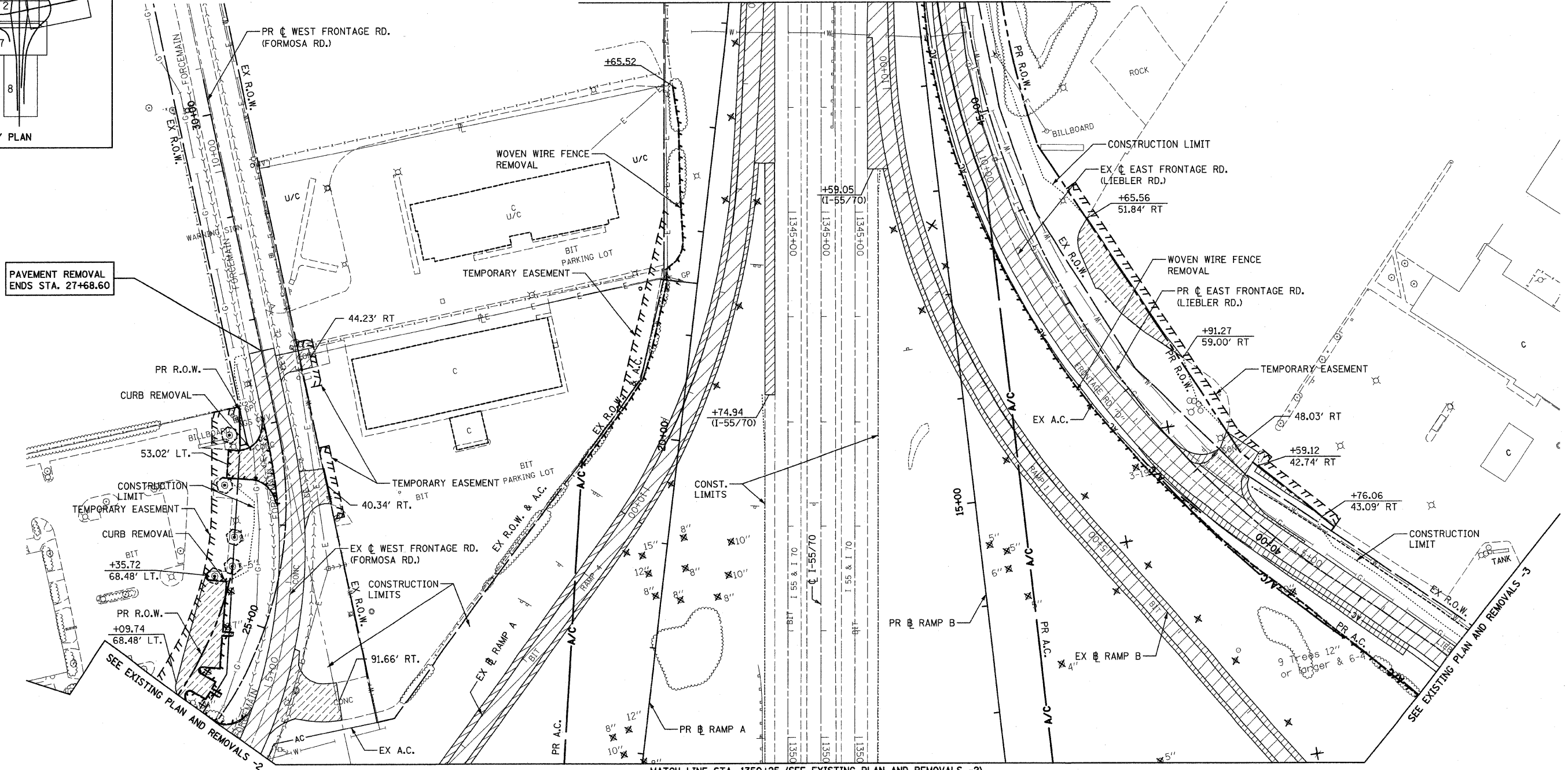
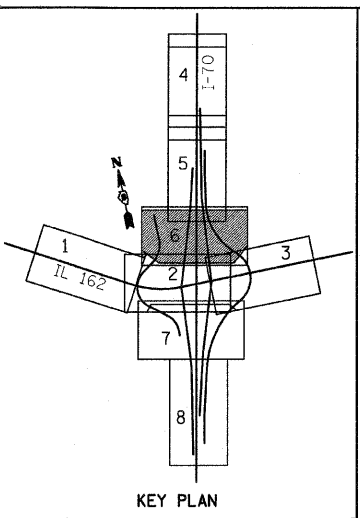

PAVEMENT REMOVAL
ENDS STA. 27+68.60

PLAN	DATE
BY	
DESIGNED	
CHECKED	
ALIGNED	
PLOTTED	
NOTE BOOK	
NO.	
CADD FILE NAME	

LEGEND

	PAVED SHOULDER REMOVAL		DRIVEWAY PAVEMENT REMOVAL
	MEDIAN REMOVAL		TREE REMOVAL
	PAVEMENT REMOVAL		TREE TRUNK PROTECTION
	HOT-MIX ASPHALT SURFACE REMOVAL		ITEM TO BE REMOVED
			DELINEATOR REMOVAL
			TRAFFIC SIGN REMOVAL

NOTES:

- SEE DRAINAGE PLAN SHEETS FOR EXISTING PIPE, CULVERTS AND STRUCTURE REMOVALS.
- DRIVEWAY STATION OFFSETS ARE MEASURED FROM THE PROPOSED CENTERLINE.

REVISIONS	
NAME	DATE

ILLINOIS DEPARTMENT OF TRANSPORTATION
EXISTING PLAN AND REMOVALS -6

FAI ROUTE 70
SECTION 60-10K-1, 60-10HB
MADISON COUNTY

DRAWN BY: GRH
PLOT DATE: *DATE-TIME*

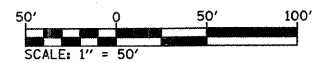

DGN-SPEC
 REF: 236cm01.dgn
 REF: 236cp01.dgn
 REF: 236cu01.dgn
 REF: 236cc01.dgn
 REF: 236cc02.dgn
 REF: 236cc03.dgn
 REF: 236cc04.dgn
 REF: 236cc05.dgn
 REF: 236cc06.dgn
 REF: 236cc07.dgn
 REF: 236cc08.dgn
 REF: 236cc09.dgn
 REF: 236cc10.dgn
 REF: 236cc11.dgn
 REF: 236cc12.dgn
 REF: 236cc13.dgn
 REF: 236cc14.dgn
 REF: 236cc15.dgn
 REF: 236cc16.dgn
 REF: 236cc17.dgn
 REF: 236cc18.dgn
 REF: 236cc19.dgn
 REF: 236cc20.dgn
 REF: 236cc21.dgn
 REF: 236cc22.dgn
 REF: 236cc23.dgn
 REF: 236cc24.dgn
 REF: 236cc25.dgn
 REF: 236cc26.dgn
 REF: 236cc27.dgn
 REF: 236cc28.dgn
 REF: 236cc29.dgn
 REF: 236cc30.dgn
 REF: 236cc31.dgn
 REF: 236cc32.dgn
 REF: 236cc33.dgn
 REF: 236cc34.dgn
 REF: 236cc35.dgn
 REF: 236cc36.dgn
 REF: 236cc37.dgn
 REF: 236cc38.dgn
 REF: 236cc39.dgn
 REF: 236cc40.dgn
 REF: 236cc41.dgn
 REF: 236cc42.dgn
 REF: 236cc43.dgn
 REF: 236cc44.dgn
 REF: 236cc45.dgn
 REF: 236cc46.dgn
 REF: 236cc47.dgn
 REF: 236cc48.dgn
 REF: 236cc49.dgn
 REF: 236cc50.dgn
 REF: 236cc51.dgn
 REF: 236cc52.dgn
 REF: 236cc53.dgn
 REF: 236cc54.dgn
 REF: 236cc55.dgn
 REF: 236cc56.dgn
 REF: 236cc57.dgn
 REF: 236cc58.dgn
 REF: 236cc59.dgn
 REF: 236cc60.dgn
 REF: 236cc61.dgn
 REF: 236cc62.dgn
 REF: 236cc63.dgn
 REF: 236cc64.dgn
 REF: 236cc65.dgn
 REF: 236cc66.dgn
 REF: 236cc67.dgn
 REF: 236cc68.dgn
 REF: 236cc69.dgn
 REF: 236cc70.dgn
 REF: 236cc71.dgn
 REF: 236cc72.dgn
 REF: 236cc73.dgn
 REF: 236cc74.dgn
 REF: 236cc75.dgn
 REF: 236cc76.dgn
 REF: 236cc77.dgn
 REF: 236cc78.dgn
 REF: 236cc79.dgn
 REF: 236cc80.dgn
 REF: 236cc81.dgn
 REF: 236cc82.dgn
 REF: 236cc83.dgn
 REF: 236cc84.dgn
 REF: 236cc85.dgn
 REF: 236cc86.dgn
 REF: 236cc87.dgn
 REF: 236cc88.dgn
 REF: 236cc89.dgn
 REF: 236cc90.dgn
 REF: 236cc91.dgn
 REF: 236cc92.dgn
 REF: 236cc93.dgn
 REF: 236cc94.dgn
 REF: 236cc95.dgn
 REF: 236cc96.dgn
 REF: 236cc97.dgn
 REF: 236cc98.dgn
 REF: 236cc99.dgn
 REF: 236cc100.dgn