

FAP ROUTE	SECTION	COUNTY	TOTAL SHEETS	SHEET NO
70	*	MADISON	420	80

STA.	TO STA.
CONTRACT NO.: 76709	
* 60-10K-1, 60-10HB	

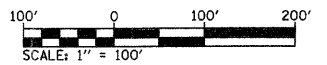

ILLINOIS DEPARTMENT OF TRANSPORTATION
MAINTENANCE OF TRAFFIC STAGE II & III TEMPORARY ALIGNMENT
 FAI ROUTE 70
 SECTION 60-10K-1, 60-10HB
 MADISON COUNTY
 DRAWN BY: HJB

REVISIONS	
NAME	DATE

PLOT DATE: *DATE-TIME*

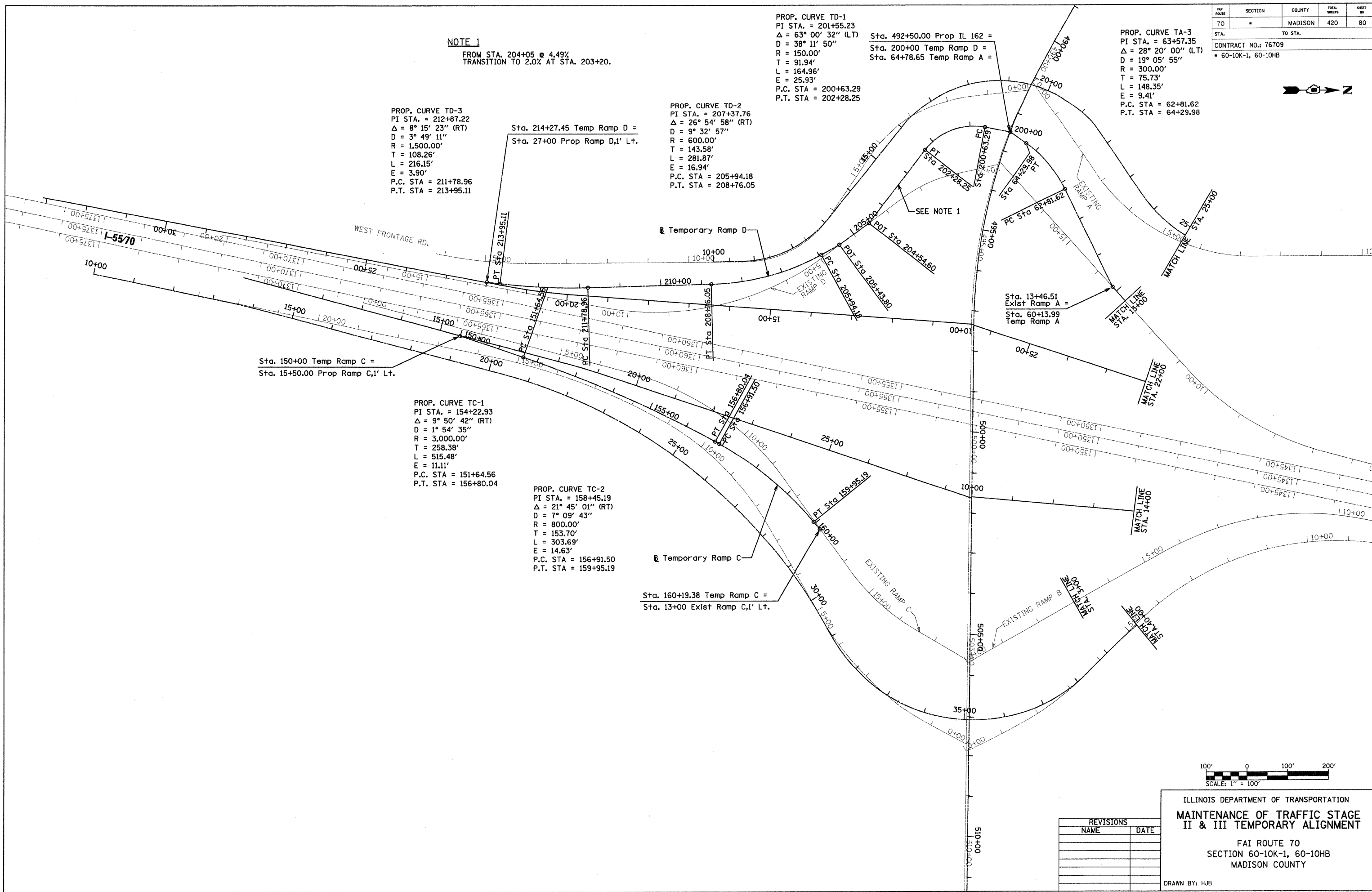

NOTE 1
 FROM STA. 204+05 @ 4.49%
 TRANSITION TO 2.0% AT STA. 203+20.

PROP. CURVE TD-3
 PI STA. = 212+87.22
 $\Delta = 8^\circ 15' 23''$ (RT)
 D = 3' 49' 11"
 R = 1,500.00'
 T = 108.26'
 L = 216.15'
 E = 3.90'
 P.C. STA = 211+78.96
 P.T. STA = 213+95.11

Sta. 214+27.45 Temp Ramp D =
 Sta. 27+00 Prop Ramp D, 1' Lt.

PROP. CURVE TD-2
 PI STA. = 207+37.76
 $\Delta = 26^\circ 54' 58''$ (RT)
 D = 9' 32' 57"
 R = 600.00'
 T = 143.58'
 L = 281.87'
 E = 16.94'
 P.C. STA = 205+94.18
 P.T. STA = 208+76.05

PROP. CURVE TD-1
 PI STA. = 201+55.23
 $\Delta = 63^\circ 00' 32''$ (LT)
 D = 38' 11' 50"
 R = 150.00'
 T = 91.94'
 L = 164.96'
 E = 25.93'
 P.C. STA = 200+63.29
 P.T. STA = 202+28.25

Sta. 492+50.00 Prop IL 162 =
 Sta. 200+00 Temp Ramp D =
 Sta. 64+78.65 Temp Ramp A =

PROP. CURVE TA-3
 PI STA. = 63+57.35
 $\Delta = 28^\circ 20' 00''$ (LT)
 D = 19' 05' 55"
 R = 300.00'
 T = 75.73'
 L = 148.35'
 E = 9.41'
 P.C. STA = 62+81.62
 P.T. STA = 64+29.98

PROP. CURVE TC-1
 PI STA. = 154+22.93
 $\Delta = 9^\circ 50' 42''$ (RT)
 D = 1' 54' 35"
 R = 3,000.00'
 T = 258.38'
 L = 515.48'
 E = 11.11'
 P.C. STA = 151+64.56
 P.T. STA = 156+80.04

Sta. 150+00 Temp Ramp C =
 Sta. 15+50.00 Prop Ramp C, 1' Lt.

PROP. CURVE TC-2
 PI STA. = 158+45.19
 $\Delta = 21^\circ 45' 01''$ (RT)
 D = 7' 09' 43"
 R = 800.00'
 T = 153.70'
 L = 303.69'
 E = 14.63'
 P.C. STA = 156+91.50
 P.T. STA = 159+95.19

Sta. 160+19.38 Temp Ramp C =
 Sta. 13+00 Exist Ramp C, 1' Lt.

PLAN	SUBMITTED	DATE
NOTE BOOK	BY	
NO.		

DATE-TIME*
 DATE-TIME*
 REF-SPEC*
 REF-