

FAI ROUTE	SECTION	COUNTY	TOTAL SHEETS	SHEET NO
70		MADISON	420	138
STA. 504+50		TO STA. 510+50		
CONTRACT NO.: 76709				
• 60-10K-1, 60-10HB				

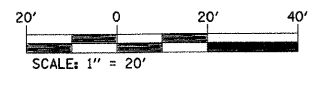

PLAN	SURVEYED	DATE
	PLOTTED	BY
	ALIGNED	
	ASSEMBLED	
	CAD FILE NAME	
	NO.	

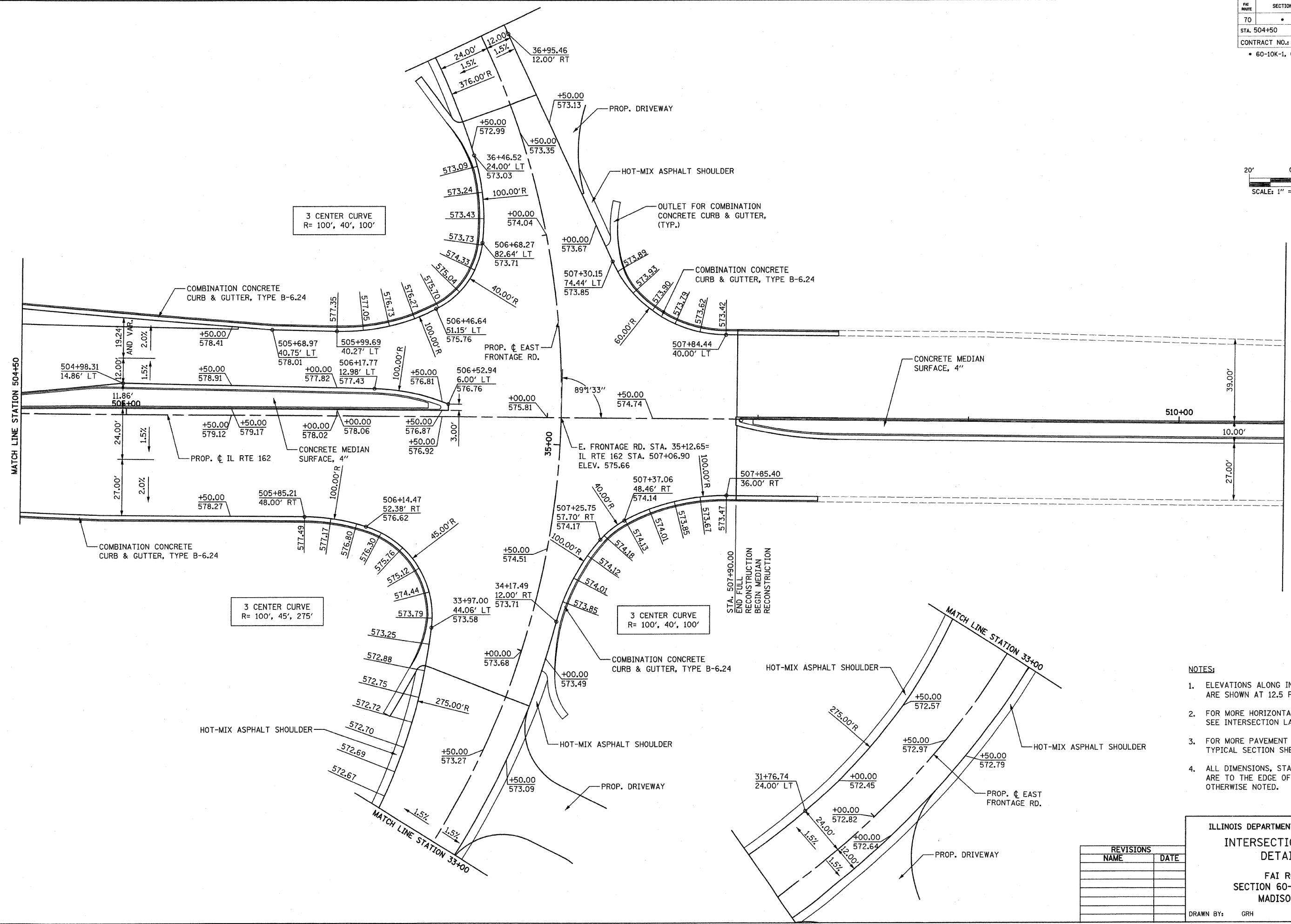

- NOTES:**
- ELEVATIONS ALONG INTERSECTION RADII ARE SHOWN AT 12.5 FT INTERVAL.
 - FOR MORE HORIZONTAL GEOMETRY INFO SEE INTERSECTION LAYOUT DETAILS.
 - FOR MORE PAVEMENT SLOPE INFO SEE TYPICAL SECTION SHEETS.
 - ALL DIMENSIONS, STATIONS AND OFFSETS ARE TO THE EDGE OF PAVEMENT UNLESS OTHERWISE NOTED.

REVISIONS	
NAME	DATE

ILLINOIS DEPARTMENT OF TRANSPORTATION
**INTERSECTION ELEVATION
 DETAILS - 6**
 FAI ROUTE 70
 SECTION 60-10K-1, 60-10HB
 MADISON COUNTY

DRAWN BY: GRH

PLOT DATE: *DATE-TIME*

DIN-SPEC
 REF- 236ch20.dgn
 REF- 236ch20.dgn