

SECTION	COUNTY	TOTAL SHEETS	SHEET NO.
60-10 (K-1,HB)	MADISON	420	180
STA. 478+00 TO STA. 493+50		CONTRACT NO.: 76709	

**NOTES:**

- ALL UNIT DUCT ON THIS SHEET SHALL BE 6" (2" 6 XLP, 1" 6 XLP G, 1.0 P) UNLESS NOTED OTHERWISE.

**LEGEND**

- TBR - TO BE REMOVED
- REMOVE POLE
- REMOVE AND SALVAGE LUMINAIRE
- REMOVE FOUNDATION

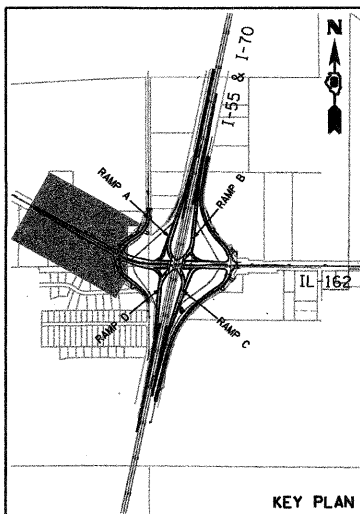

PLAN	DATE
BY: _____	DATE: _____
NO. _____	DATE: _____
NO. _____	DATE: _____
NO. _____	DATE: _____

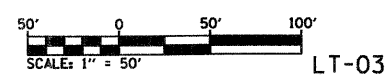
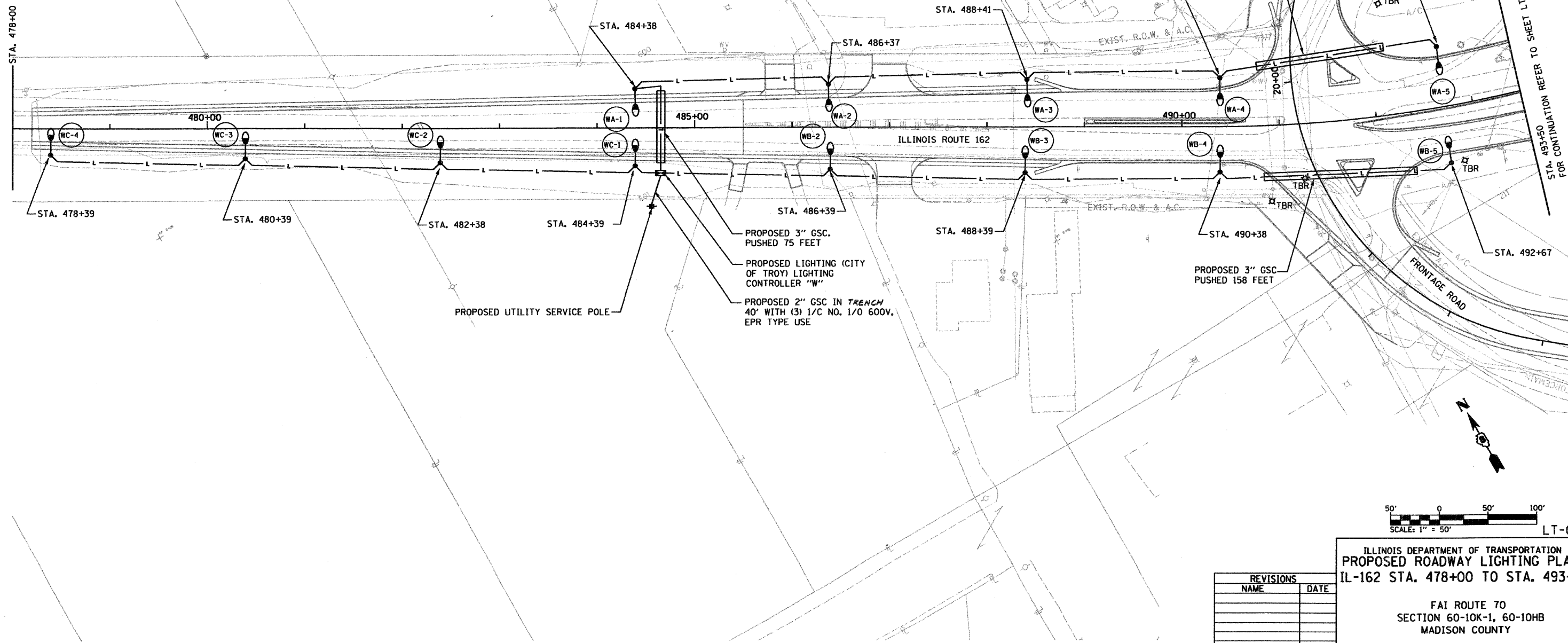

ILLINOIS DEPARTMENT OF TRANSPORTATION  
**PROPOSED ROADWAY LIGHTING PLAN**  
 IL-162 STA. 478+00 TO STA. 493+50

FAI ROUTE 70  
 SECTION 60-10K-1, 60-10HB  
 MADISON COUNTY

DRAWN BY: RPJ      CHECKED BY: A. OSHANA, P.E.

REVISIONS	
NAME	DATE

XXXXXXX - IDOT IL 162 over 1-55-70 revisions  
 236-LT-03.dgn  
 1/28/2009  
 10:24 PM  
 Robert Swanson