

F.A. RTE.	SECTION	COUNTY	TOTAL SHEETS	SHEET NO.
70		MADISON	420	208
STA.	TO STA.			
FED. ROAD DIST. NO.	ILLINOIS	FED. AID PROJECT		
• 60-10K-1, 60-10HB				

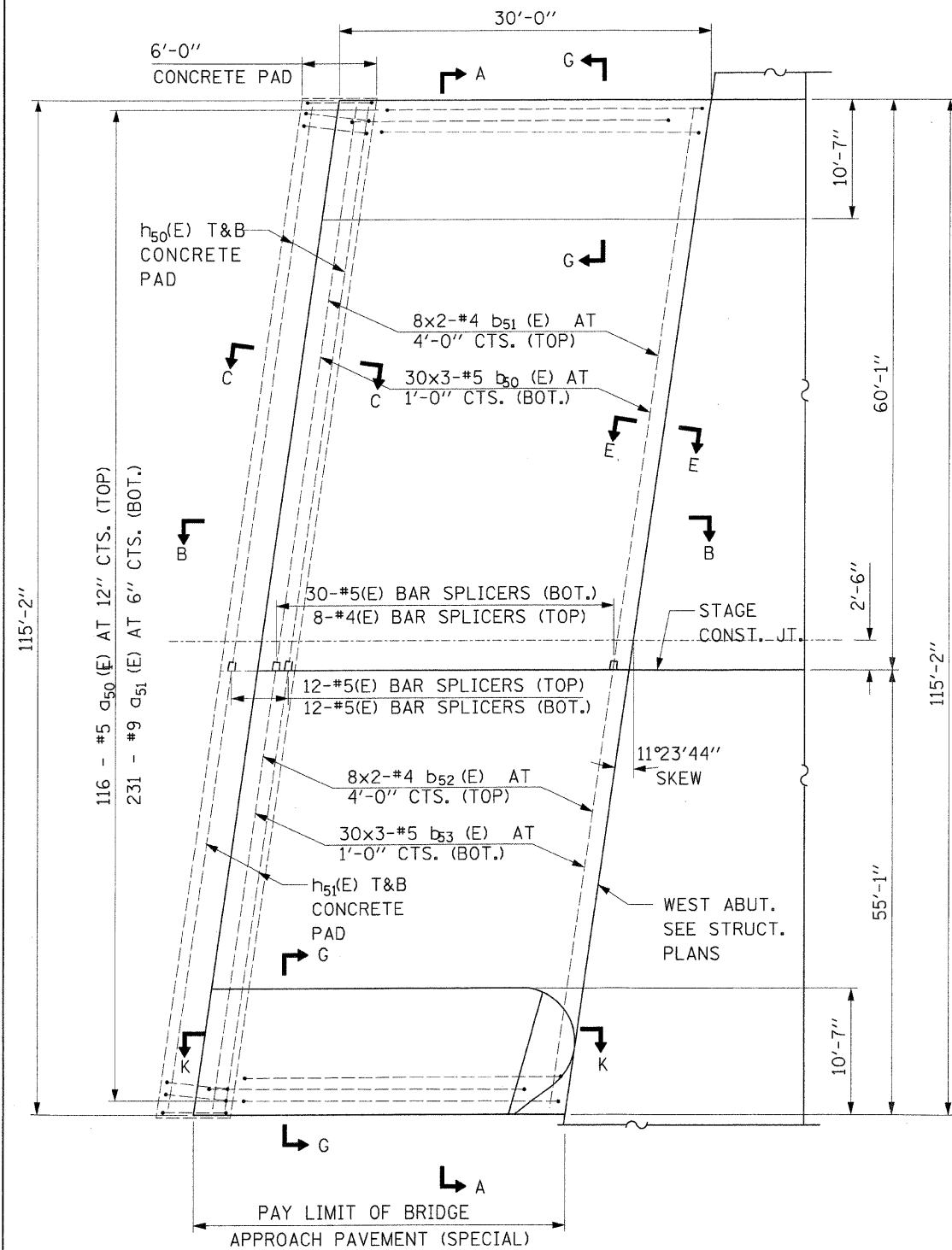

BRIDGE APPROACH PAVEMENT PLAN - WEST

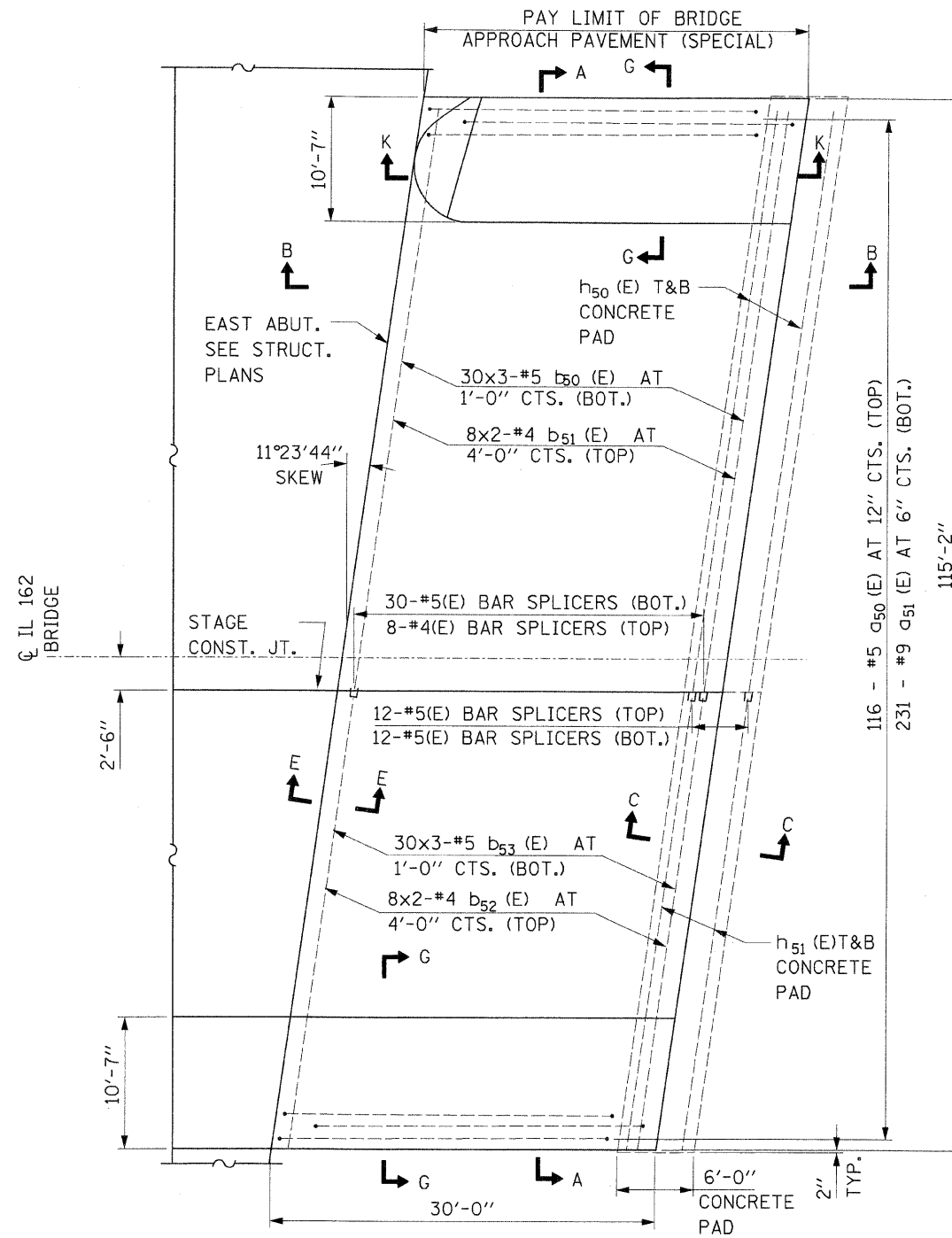

BRIDGE APPROACH PAVEMENT PLAN - EAST

MIN. LAP
 #4 = 1'-8"
 #5 = 2'-2"

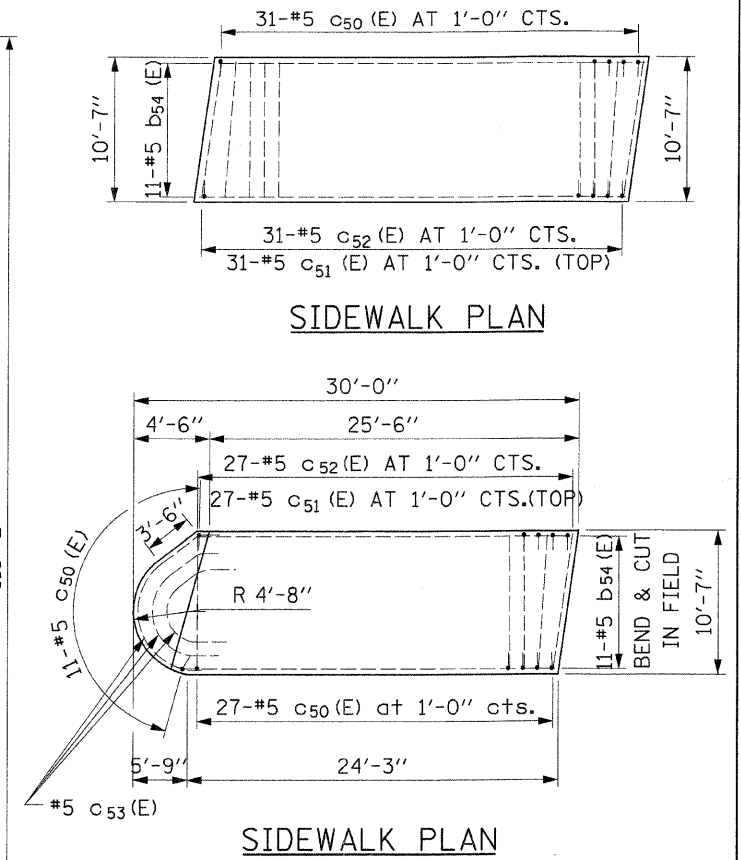

GENERAL NOTES

- SEE STANDARD 421001 FOR REINFORCEMENT DETAILS NOT SHOWN.
- SEE STANDARD 420001 FOR DETAILS OF JOINTS NOT SHOWN.
- REFER TO STRUCTURAL BRIDGE PLANS FOR ABUTMENT.
- BLOCK OUT CONCRETE SLEEPER SLAB FOR STEEL PLATE BEAM GUARD RAIL POSTS. COORDINATE WITH STANDARD 631031.

REVISIONS	
NAME	DATE

ILLINOIS DEPARTMENT OF TRANSPORTATION
 BRIDGE APPROACH PAVEMENT
 FAI ROUTE 70
 SECTION 60-10K, 60-10-4HB
 MADISON COUNTY

SCALE: NOT TO SCALE
 DATE: 4/06
 DRAWN BY: HJB
 CHECKED BY: JAW