

STATE OF ILLINOIS
DEPARTMENT OF TRANSPORTATION
DIVISION OF HIGHWAYS

**PROPOSED
HIGHWAY PLANS**

FAP ROUTE 42/841 (IL 13/127/154)
SECTION (8,103,108)I-1

PAVEMENT REMOVAL AND REPLACEMENT
PERRY COUNTY

C-99-038-09

F.A.P. RTE.	SECTION	COUNTY	TOTAL SHEETS	SHEET NO.
•	(8,103,108)I-1	PERRY	214	1
FED. ROAD DIST. NO.	ILLINOIS	CONTRACT NO. 78117		

•FAP 42/841

D-99-022-09

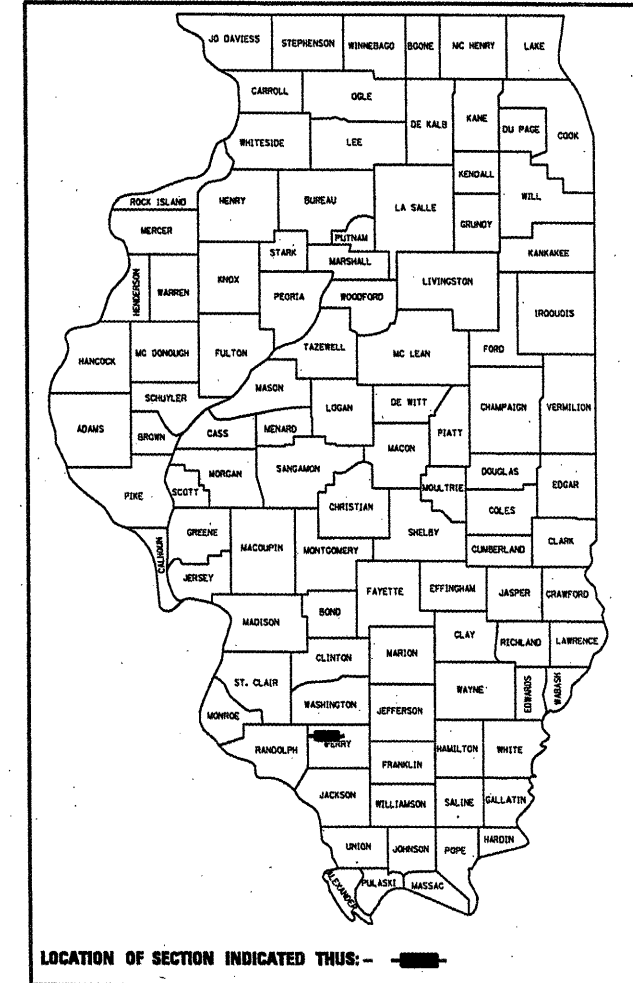

FOR INDEX OF SHEETS, SEE SHEET NO. 3

ADT (2007) 8000
PV = 7300
MU = 100
SU = 600

PROP. PROJECT LIMITS
FAP 42/841 (IL 13/127/154)
STA. 1262+51 TO STA. 1266+75

PRECINCT - PINCKNEYVILLE

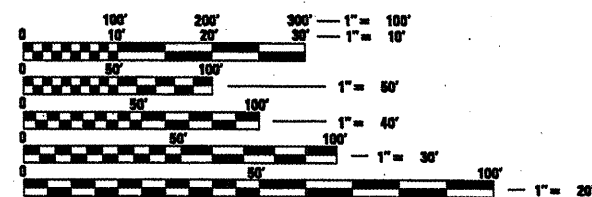

FULL SIZE PLANS HAVE BEEN PREPARED USING STANDARD ENGINEERING SCALES. REDUCED SIZED PLANS WILL NOT CONFORM TO STANDARD SCALES. IN MAKING MEASUREMENTS ON REDUCED PLANS, THE ABOVE SCALES MAY BE USED.

J.U.L.I.E.
JOINT UTILITY LOCATION INFORMATION FOR EXCAVATION
1-800-892-0123
OR 811

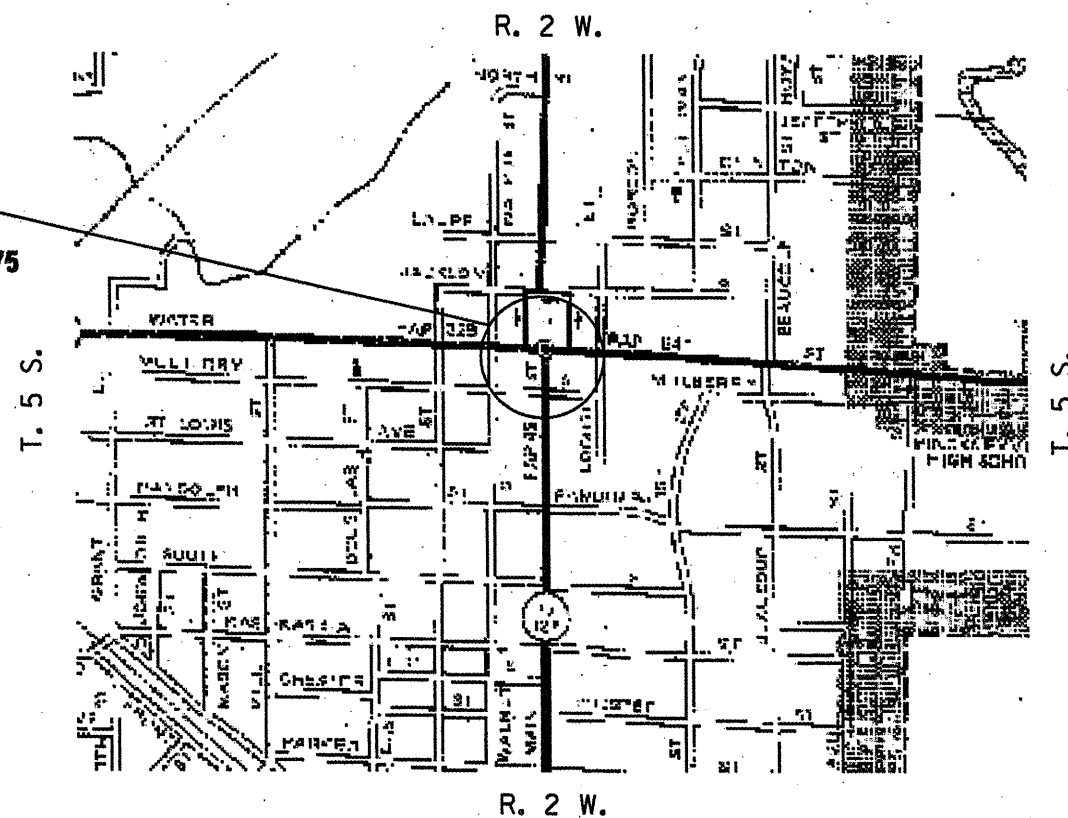

LENGTH OF PROJECT: 520 FT. = 0.098 MILES

PROJECT ENGINEER Charles Stein - (618) 351-5210
PROJECT MANAGER Kathi McCord - (618) 351-5216

CONTRACT NO. 78117

STATE OF ILLINOIS
DEPARTMENT OF TRANSPORTATION
DIVISION OF HIGHWAYS

SUBMITTED *March 20 09*
Mar C. Gami
DEPUTY DIRECTOR OF HIGHWAYS, REGION ENGINEER

May 8, 20 09
Charles J. Ingersoll
ENGINEER OF DESIGN AND ENVIRONMENT

May 8, 20 09
Christine M. Reed
DIRECTOR OF HIGHWAYS, CHIEF ENGINEER

**PRINTED BY THE AUTHORITY
OF THE STATE OF ILLINOIS**