

# INDEX OF SHEETS

SHEET NUMBER	DESCRIPTION
1	COVER SHEET -- LOCATION MAP
2	SUMMARY OF QUANTITIES
3	TYPICAL CROSS SECTIONS
4 & 5	TYPICAL INTERSECTIONS, PRIVATE ENTRANCES AND MAILBOX TURNOUTS
6	QUANTITY TABLES
7	EARTH EX WIDENING, HMA SHOULDERS LOCATIONS & RUMBLE STRIP DETAIL

## STANDARDS

000001-05	SYMBOLS AND ABBREVIATIONS, & PATTERNS
667101-01	PERMANENT SURVEY MARKERS
701301-03	LANE CLOSURE, 2L, 2W, SHORT TIME OPERATIONS
701306-02	LANE CLOSURE, 2L, 2W, SLOW MOVING OPERATIONS DAY ONLY, FOR SPEEDS > 45 MPH
701311-03	LANE CLOSURE, 2L, 2W, MOVING OPERATIONS-DAY ONLY
701901-01	TRAFFIC CONTROL DEVICES
780001-02	TYPICAL PAVEMENT MARKINGS
BLR 24-2	MAILBOX TURNOUTS FOR LOCAL ROADS

# STATE OF ILLINOIS DEPARTMENT OF TRANSPORTATION DIVISION OF HIGHWAYS

## PLANS FOR PROPOSED IMPROVEMENT OF FEDERAL AID SECONDARY HIGHWAY 329 & 331 BUILT IN ACCORDANCE WITH L. A. P. P. POLICY

### IROQUOIS COUNTY HIGHWAY PROJECT

ROUTE	FAS 329 & 331
SECTION	05-00298-00-RS
PROJECT	RS-0329(104)
JOB #	C-93-105-09

GROSS LENGTH OF IMPROVEMENT	
(COUNTY HIGHWAY 10)	25,212' = 4.78 MI.
(COUNTY HIGHWAY 45)	5,300' = 1.00 MI.

OMISSION LENGTH	
(COUNTY HIGHWAY 10)	OMISSION LENGTH = 1000 FT. = 0.2 MI.
(COUNTY HIGHWAY 45)	OMISSION LENGTH = 22 FT. = 0.004 MI.

NET LENGTH OF IMPROVEMENT	
	30,512 FT. - 1,022 FT = 29,490 FT.

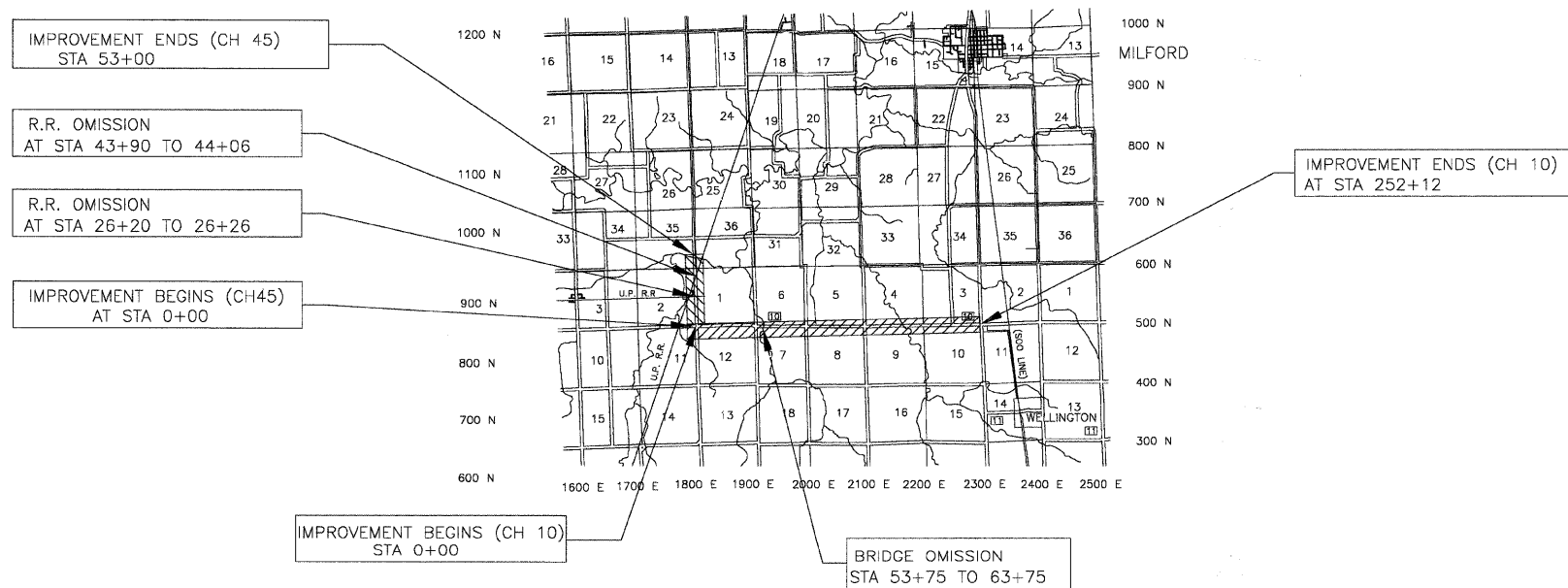

### NOTES:

JULIE # 1-800-892-0123  
KNOWN UTILITIES  
 AMEREN CIPS  
 EASTERN ILLINI ELECTRIC CO-OP  
 AVENUE BROADBAND  
 VERIZON

SCALES

MILE

ROUTE NO.	SECTION	COUNTY	TOTAL SHEETS	SHEET NO.
FAS 329 & 331	05-00298-00-RS	IROQUOIS	7	1
F. H. W. A. REG. 4 ILLINOIS			PROJECT RS-0329(104)	
CONTRACT 87396				

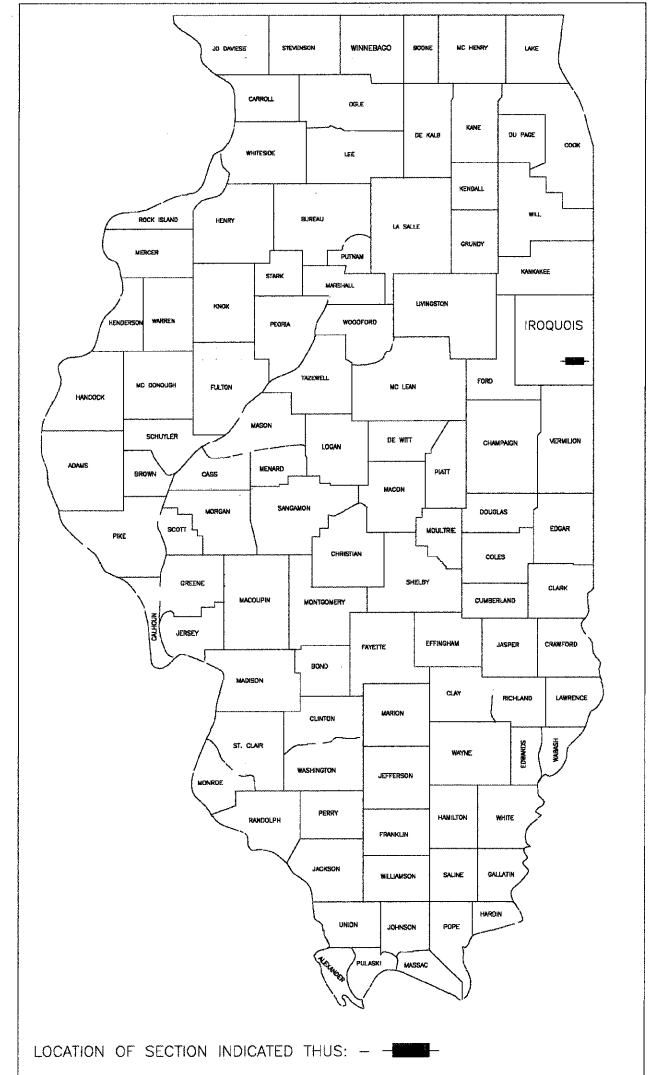

MAJOR COLLECTOR 2009 ADT = 600  
 PV = 88% SU = 7% MU = 5%

### CONTRACT 87396

\*THESE PLANS WERE PREPARED BY ME OR BY A FULL TIME MEMBER OF MY STAFF WORKING UNDER MY DIRECT SUPERVISION\*

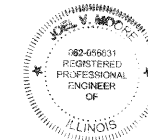

JOEL V. MOORE, COUNTY ENGINEER  
 ILL. REG. PROF. ENG. #62056831  
 DATE EXPIRES: 11/30/11

Approved: March 20, 2009  
*[Signature]*  
 County Engineer  
 Passed: March 30, 2009  
*[Signature]*  
 DISTRICT THREE ENGINEER OF LOCAL ROADS & STREETS  
 RELEASED FOR BID BASED ON LIMITED REVIEW: March 20, 2009  
*[Signature]*  
 DEPUTY DIRECTOR OF HIGHWAYS, REGION TWO ENGINEER  
 STATE OF ILLINOIS  
 DEPARTMENT OF TRANSPORTATION

ROUTE NO. FAS 329 & 331	SECTION 05-00298-00-RS F. H. W. A. REG. 4 ILLINOIS	COUNTY IROQUOIS	TOTAL SHEETS 7	SHEET NO. 2
PROJECT RS 329(104)			CONTACT 87396	

SUMMARY OF QUANTITIES			FUND CODE	I000
ITEM #	CODE #	ITEM	UNIT	QUANTITY
1	Z0048665	RAILROAD PROTECTIVE LIABILITY INSURANCE	L SUM	1.00
2	Z0055300	RUMBLE STRIPS	EACH	6.00
* 3	20200500	EARTH EXCAVATION WIDENING	CU YD	240.00
4	40600100	BITUMINOUS MATERIALS (PRIME COAT)	GAL	3,800.00
5	40600300	AGGREGATE (PRIME COAT)	TON	131.00
* 6	40600625	LEVEL BINDER (MACHINE METHOD), N50	TON	6250.00
* 7	40600982	HOT-MIX ASPHALT SURFACE REMOVAL - BUTT JOINT	SQ YD	1205.00
8	40600985	PCC SURFACE REMOVAL-BUTT JOINT	SQ YD	50.00
9	40600990	TEMPORARY RAMP	SQ YD	250.00
*10	40603310	HOT-MIX ASPHALT SURFACE COURSE "C" N50	TON	5900.00
*11	40800050	INCIDENTAL HOT-MIX ASPHALT SURFACING	TON	403.00
*12	48101200	AGGREGATE SHOULDERS, TYPE B	TON	7500.00
*13	48203100	HOT-MIX ASPHALT SHOULDERS	TON	600.00
*14	550B0010	STORM SEWER, CLASS B, TYPE 1, 4'	FOOT	30.00
*15	60234500	INLETS TYPE A, TYPE 1 FRAME, OPEN LID (24' DEP)	EACH	1.00
16	66700205	PERMANENT SURVEY MARKER, TYPE 1	EACH	5.00
17	67100100	MOBILIZATION	L SUM	1.00
*18	70101700	TRAFFIC CONTROL AND PROTECTION	L SUM	1.00
19	70300100	SHORT-TERM PAVEMENT MARKING	FOOT	5898.00
20	70300200	TEMPORARY PAVEMENT MARKING	FOOT	30102.00
21	70301000	WORK ZONE PAVEMENT MARKING REMOVAL	SQ FT	983.00
Δ 22	78000100	THERMOPLASTIC PAVEMENT MARKING - LETTERS AND SYMBOLS	SQ FT	245.00
Δ 23	78000200	THERMOPLASTIC PAVEMENT MARKING - LINE 4"	FOOT	2660.00
Δ 24	78000650	THERMOPLASTIC PAVEMENT MARKING - LINE 24"	FOOT	151.00
Δ 25	78001110	PAINT PAVEMENT MARKING - LINE 4"	FOOT	27442.00

\* SEE SPECIAL PROVISIONS  
Δ SPECIALTY ITEMS

### GENERAL NOTES

THE THICKNESS OF HOT-MIX ASPHALT MIXTURES SHOWN ON THE TYPICAL X-SECTION IS THE NOMINAL THICKNESS. DEVIATIONS FROM THE NOMINAL THICKNESS WILL BE PERMITTED WHEN SUCH DEVIATIONS OCCUR DUE TO IRREGULARITIES IN THE EXISTING SURFACE.

THE ENGINEER SHALL BE THE SOLE JUDGE CONCERNING CURING TIME FOR THE VARIOUS HOT-MIX ASPHALT LIFTS.

FOR ALL PAVEMENT MARKINGS ON FINAL SURFACES (I.E., MAINLINE PAVEMENT), ONLY TEMPORARY PAVEMENT MARKING TAPE SHALL BE USED.

ANY REFERENCE TO A STANDARD IN THESE PLANS SHALL BE INTERPRETED TO MEAN THE EDITION AS INDICATED BY THE SUB-NUMBER LISTED IN THE INDEX OF SHEETS OR THE COPY OF THE STANDARD INCLUDED IN THESE PLANS.

THE FOLLOWING RATES OF APPLICATION HAVE BEEN ASSUMED IN CALCULATING PLAN QUALITIES:

GRANULAR MATERIALS	2.05	TONS/CU YD
BITUMINOUS MATERIALS PRIME COAT	0.05	GAL/SQ YD
AGGREGATE PRIME COAT	0.002	TONS/SQ YD
HOT MIX ASPHALT SURFACE COURSE	112	LBS/SQ YD/INCH
LEVELING BINDER (MACHINE METHOD)	112	LBS/SQ YD/INCH
BINDER COURSE, IL 19.0, N50	112	LBS/SQ YD/INCH
SHORT TERM PAVEMENT MARKING	4	FT/40 FT OF APPLICATION
PAINT PAVEMENT MARKING - LINE 4"	10	FT/40 FT OF APPLICATION

### FUNCTIONAL OVERLAY

DESIGN DATA FOR INFORMATION ONLY.

FLEXIBLE PAVEMENT OVERLAY DESIGN FOR CLASS III ROAD USING EQUATION 54-5.3

DESIGN PERIOD D. P. = 20 YEARS

DESIGN YEAR = 2019 PV=88% SU=7% MU=5%

DESIGN ADT = 660 IBV = 2.88 TRAFFIC FACTOR = 0.159

SN<sub>F</sub> = 3.19 SN<sub>Fe</sub> = 2.07 D<sub>o</sub> = 2.80

### MIXTURE TABLE

	HMA LEVEL BINDER	HMA SURFACE	HMA SHOULDERS (BOTTOM 7 1/2)
PG GRADE	PG64-22	PG64-22	PG58-22
MAX % RAP ALLOWABLE**	15 %	15%	25%
DESIGN AIR VOIDS	4.0% @ N50	4.0% @ N50	2.0% @ N30
MIXTURE COMPOSITION	IL 9.5	IL 12.5 OR IL 9.5	IL 19.0
FRICTION AGGREGATE		MIXTURE C	
DENSITY TEST METHOD	SATISFACTION OF ENGINEER	CORRELATION	*

\* MATERIAL SHALL BE COMPACTED TO 93.0-97.4 PERCENT OF THE MAXIMUM THEORETICAL DENSITY, EXCEPT THAT WHEN PLACED AS FIRST LIFT ON AN UNIMPROVED SUBGRADE THE MINIMUM PERCENT COMPACTION SHALL BE 92.0 PERCENT. THE MAXIMUM THEORETICAL DENSITY SHALL BE DETERMINED FROM THE MOVING AVERAGE AS SPECIFIED IN THE QC/QA SPECIFICATION.

\*\* WHEN MORE THAN 20% RAP IS USED, A SOFTER ASPHALT BINDER (PG58-22) MAY BE REQUIRED AS DETERMINED BY THE ENGINEER.

### HOT-MIX ASPHALT SURFACE REMOVAL - BUTT JOINT

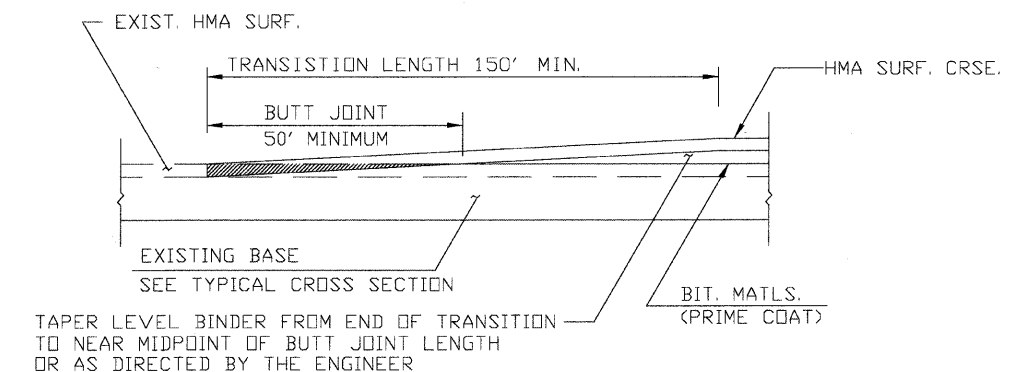

### SECTION NOTES

THE PROPOSED IMPROVEMENT CONSISTS OF A HOT MIX ASPHALT SURFACE COURSE INCLUDING LEVELING BINDER, SHOULDER STONE AND ALL WORK NECESSARY TO COMPLETE THE PROJECT ACCORDING TO THE PLANS AND SPECIFICATIONS.

COUNTY HIGHWAY 10 WAS CONSTRUCTED UNDER SECTIONS (200Q, 216 Q, 1-X) 15d, W & RS, 84-00255-00-RS. COUNTY HIGHWAY 45 WAS CONSTRUCTED UNDER SECTIONS (56-15d) W & RS and 82-00250-00-WR.

ROUTE NO. FAS 329 & FAS 331	SECTION 05-00298-00-RS F. H. W. A. REG. 4 ILLINOIS	COUNTY IROQUOIS	TOTAL SHEETS 7	SHEET NO. 3
--------------------------------------	--	--------------------	-------------------	----------------

PROJECT RS-0329(104)

CONTRACT 87396

# CH 10

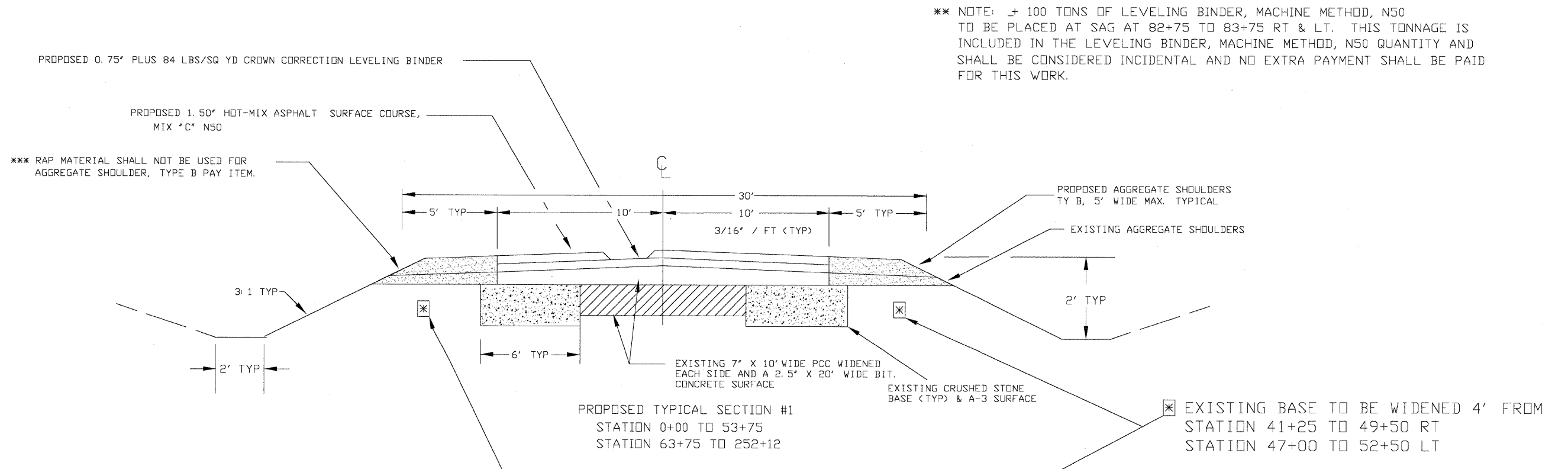

\*\*\* NOTE: ± 100 TONS OF LEVELING BINDER, MACHINE METHOD, N50 TO BE PLACED AT SAG AT 82+75 TO 83+75 RT & LT. THIS TONNAGE IS INCLUDED IN THE LEVELING BINDER, MACHINE METHOD, N50 QUANTITY AND SHALL BE CONSIDERED INCIDENTAL AND NO EXTRA PAYMENT SHALL BE PAID FOR THIS WORK.

# CH 45

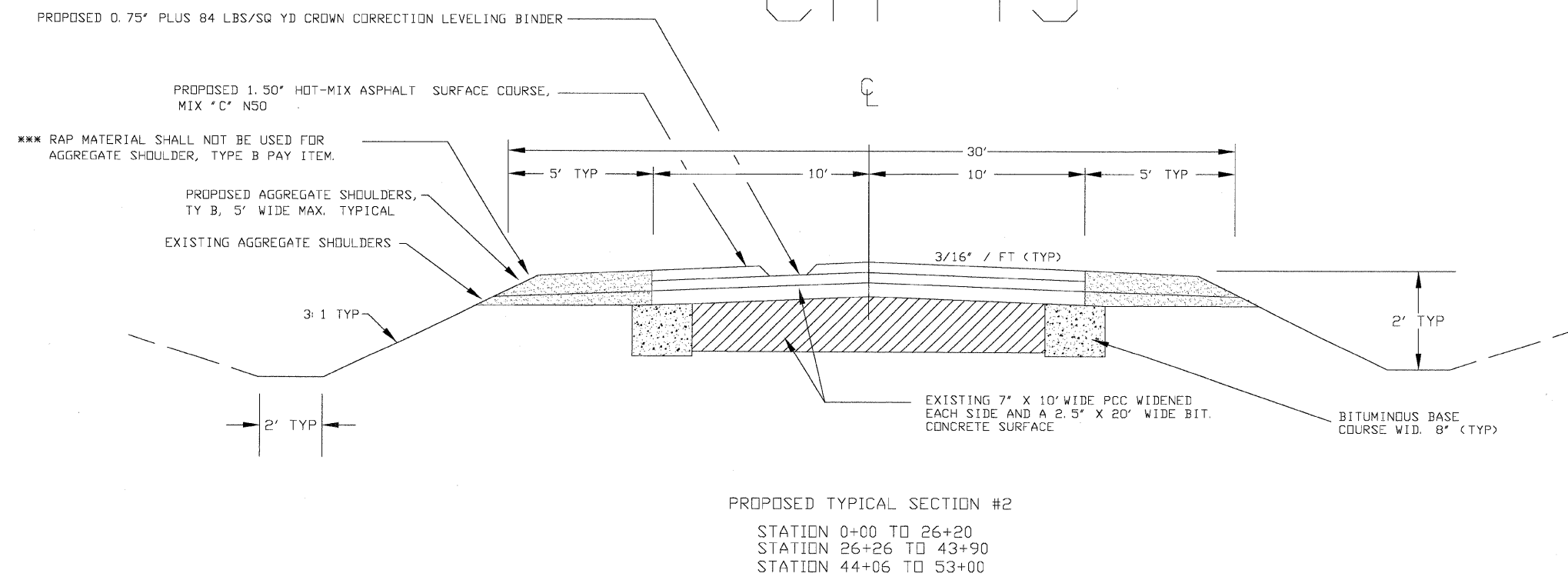

# COUNTY HIGHWAY 10

ROUTE NO. FAS 329 & 331	SECTION 05-00298-00-RS F. H. W. A. REG. 4 ILLINDIS	COUNTY IROQUOIS	TOTAL SHEETS 7	SHEET NO. 4
PROJECT RS-0329(104)			CONTRACT 87396	

NOTE: ALL PRIVATE ENTRANCES, MAIL BOX TURNOUTS AND SIDE ROAD INTERSECTIONS SHALL BE PAID FOR AS INCIDENTAL HOT-MIX ASPHALT SURFACING TOTAL 227 TON FOR CH 10.

NOTE: AGGREGATE AROUND ALL PRIVATE ENTRANCES, MAIL BOX TURNOUTS AND SIDE ROAD INTERSECTIONS SHALL BE CONSIDERED INCIDENTAL TO AGGREGATE SHOULDERS, TYPE B AND PLACED AS DIRECTED BY THE ENGINEER.

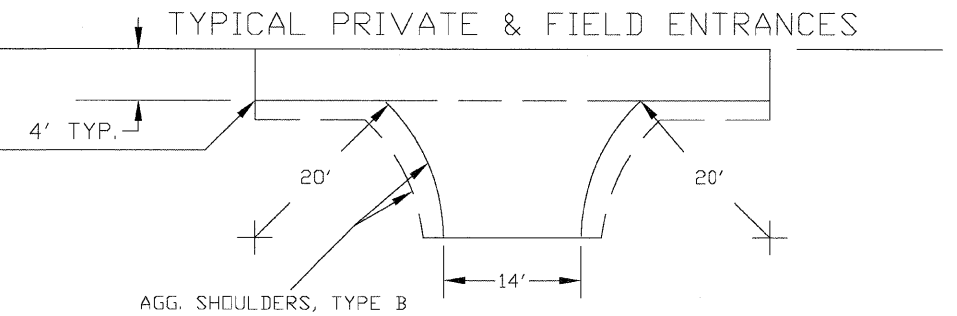
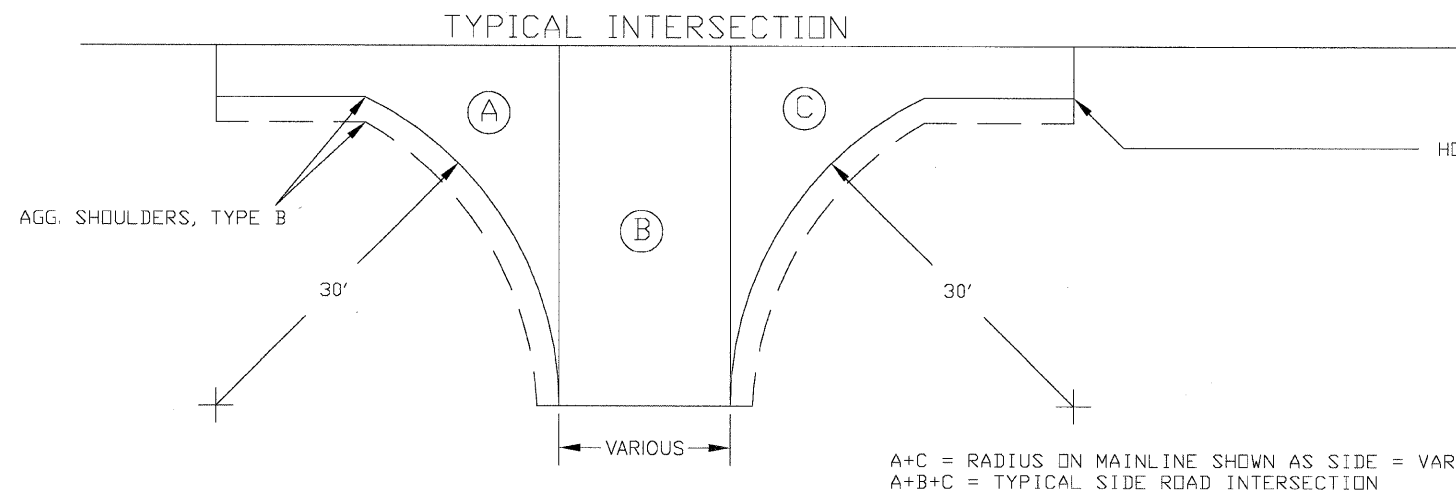
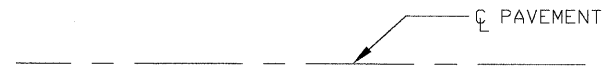
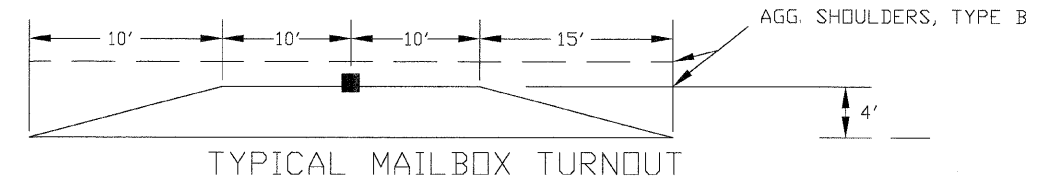

TYPICAL MAILBOX TURNOUT

STATION	SIDE	SQ. YD	TON
156+00	RT	15	4
161+95	RT	15	4
181+10	RT	15	4
191+26	RT	15	4
246+29	RT	15	4
TOTAL = 20 TONS			

TYPICAL FIELD ENTRANCES

STATION	RT/LT	TYPE	PROPOSED	SQ. YD.	TON	STATION	RT/LT	TYPE	PROPOSED	SQ. YD.	TON
9+22	LT.	FE	AGG	—	5	175+11	RT.	FE.	AGG	—	5
9+95	RT.	FE	AGG	—	5	180+45	LT.	FE.	AGG	—	5
19+79	RT.	FE	AGG	—	5	186+42	LT.	FE.	AGG	—	5
20+10	RT.	FE	AGG	—	5	187+12	RT.	FE	AGG	—	5
26+75	LT.	FE	AGG	—	5	191+54	LT.	FE.	AGG	—	5
28+11	RT.	FE	AGG	—	5	200+77	RT.	FE.	AGG	—	5
35+99	RT.	FE	AGG	—	5	200+87	LT.	FE	AGG	—	5
71+47	LT.	FE	AGG	—	5	214+28	RT.	FE	AGG	—	5
71+88	LT.	FE	AGG	—	5	226+15	RT.	FE	AGG	—	5
79+05	LT.	FE	AGG	—	5	226+89	RT.	FE	AGG	—	5
89+14	LT.	FE	AGG	—	5	237+14	LT.	FE	AGG	—	5
92+51	LT.	FE	AGG	—	5						
99+33	RT.	FE	AGG	—	5						
123+05	RT.	FE	AGG	—	5						
123+19	LT.	FE	AGG	—	5						
123+58	RT.	FE	AGG	—	5						
155+54	LT.	FE.	AGG	—	5						

TOTAL AGGREGATE FOR CH 10 FIELD ENTRANCES = 140 TON. THIS QUANTITY IS INCLUDED IN AGGREGATE SHOULDERS, TYPE B TOTAL QUANTITY.

TYPICAL PRIVATE ENTRANCES

STATION	RT/LT	TYPE	PROPOSED	SQ. YD.	TON
*156+78	RT.	PE.	HMA	20	5
*161+87	LT.	PE.	HMA	20	5
*181+36	RT.	PE.	HMA	20	5
*191+50	RT.	PE.	HMA	20	5
*246+86	LT.	PE.	HMA	20	5
*248+14	LT.	PE.	HMA	20	5
TOTAL = 30 TONS					

\* THESE ENTRANCES SHALL RECEIVE ONLY A FOUR FOOT PAVED APRON.

TYPICAL INTERSECTION - SIDE ROADS

STATION	SIDE	WIDTH	SQ. YD.	TON
0+65	500N 1800E RT	22'	80	10
52+70	500N 1900E LT	18'	138	15
52+70	500N 1900E RT	22'	184	38
97+44	500N 2000E RT	16'	120	12
97+44	500N 2000E LT	18'	138	15
149+11	500N 2100E RT	18'	138	15
149+11	500N 2100E LT	24'	200	40
226+89	500N 2250E LT	20'	167	32
TOTALS = 177 TONS				

# COUNTY HIGHWAY 45

ROUTE NO. FAS 329 & 331	SECTION 05-00298-00-RS F. H. W. A. REG. 4 ILLINOIS	COUNTY IROQUOIS	TOTAL SHEETS 7	SHEET NO. 5
PROJECT RS-0329(104)			CONTRACT 87396	

NOTE: ALL PRIVATE ENTRANCES, MAIL BOX TURNOUTS AND SIDE ROAD INTERSECTIONS SHALL BE PAID FOR AS INCIDENTAL HOT-MIX ASPHALT SURFACING. TOTAL 176 TONS FOR CH 45

NOTE: AGGREGATE AROUND ALL PRIVATE ENTRANCES, MAIL BOX TURNOUTS AND SIDE ROAD INTERSECTIONS SHALL BE CONSIDERED INCIDENTAL TO AGGREGATE SHOULDERS, TYPE B AND PLACED AS DIRECTED BY THE ENGINEER.

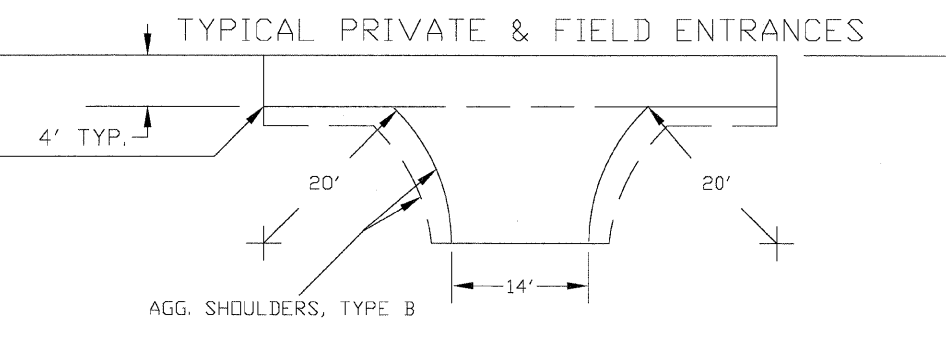
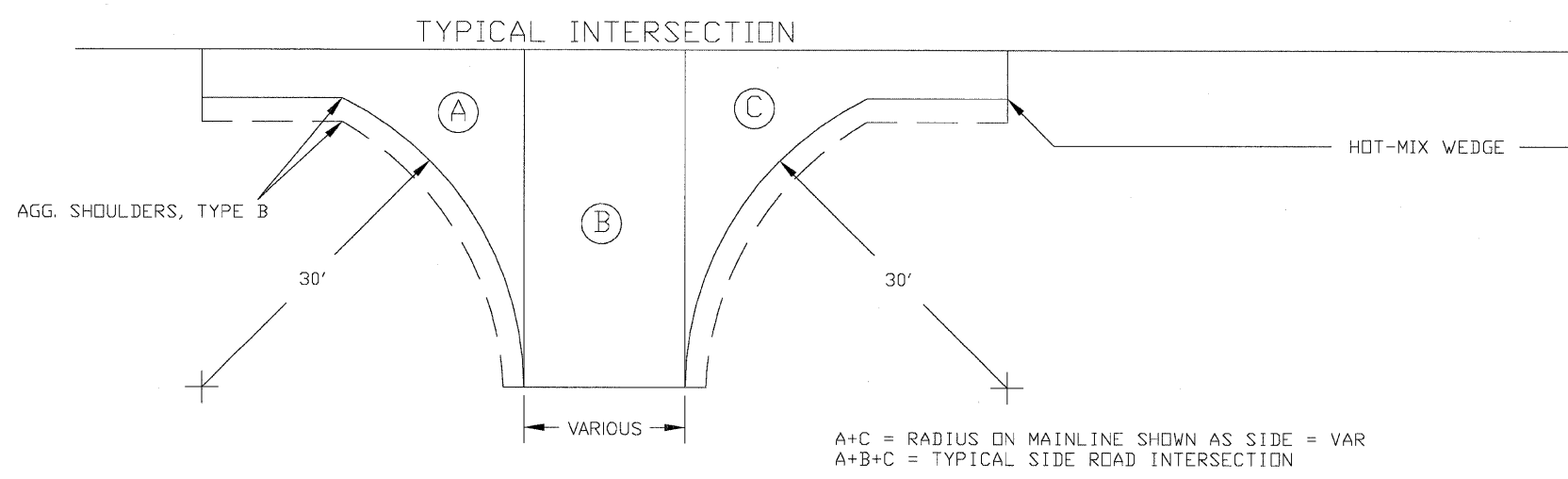
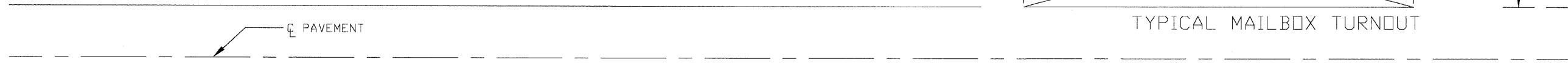
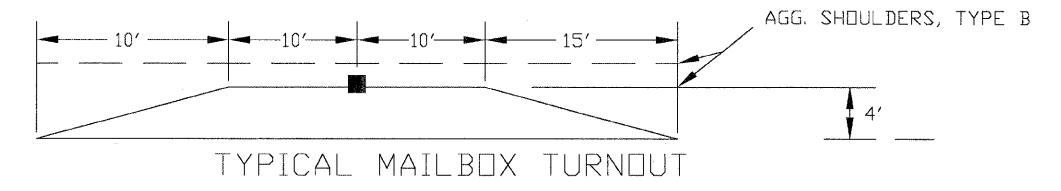

TYPICAL FIELD ENTRANCES

STATION	RT/LT	TYPE	PROPOSED	SQ. YD.	TON
38+04	RT.	FE	AGG	—	5
50+00	RT.	FE	AGG	—	5
51+90	LT.	FE	AGG	—	5

TOTAL AGG. FOR CH 45 FIELD ENTRANCES = 15 TON  
THIS QUANTITY INCLUDED IN AGGREGATE SHOULDERS TYPE B TOTAL QUANTITY.

TYPICAL PRIVATE ENTRANCES

STATION	RT/LT	TYPE	EXT./PROP.	SQ. YD.	TON	STATION	RT/LT	TYPE	EXT./PROP.	SQ. YD.	TON
* 8+38	RT.	PE	HMA	20	5	* 28+35	RT.	PE	HMA	20	5
* 9+38	RT.	PE	HMA	20	5	* 29+07	LT.	PE	HMA	20	5
* 11+40	RT.	PE	HMA	20	5	* 29+78	RT.	PE	HMA	20	5
* 18+43	RT.	PE	HMA	20	5	* 30+97	RT.	PE	HMA	20	5
* 18+70	RT.	PE	HMA	20	5	* 31+69	RT.	PE	HMA	20	5
* 18+82	RT.	PE	HMA	20	5	* 31+69	LT.	PE	HMA	20	5
* 21+07	RT.	PE	HMA	20	5	* 32+24	LT.	PE	HMA	20	5
* 21+93	RT.	PE	HMA	20	5	* 34+10	LT.	PE	HMA	20	5
* 22+14	LT.	PE	HMA	20	5	37+25	LT.	PE	HMA	72	14
* 22+45	RT.	PE	HMA	20	5	38+90	LT.	PE	HMA	34	8
* 23+32	LT.	PE	HMA	20	5	* 51+88	RT.	PE	HMA	20	5
* 24+05	RT.	PE	HMA	20	5	* 52+24	RT.	PE	HMA	20	5
* 25+27	RT.	PE	HMA	20	5						

TOTAL = 137 TONS

TYPICAL MAILBOX TURNOUT

STATION	SIDE	SQ. YD.	TON
8+00	LT	15	4
19+00	LT	15	4
24+87	LT	15	4
31+10	LT	15	4
39+08	LT	15	4
51+66	LT	15	4
TOTAL = 24 TON			

TYPICAL INTERSECTION - SIDE ROADS

STATION	SIDE	WIDTH	SQ. YD.	TON
30+77	560N 1800E LT	18'	138	15
TOTAL = 15 TON				

TYPICAL INTERSECTION - MAINLINE

STATION	SIDE	WIDTH	SQ. YD.	TON
0+00	500N 1800E VAR.	20'	85	12
TOTAL = 12 TON				

\* THESE ENTRANCES SHALL RECEIVE ONLY A FOUR FOOT PAVED APRON.

# STRIPING QUANTITIES

## COUNTY HIGHWAY 10 PAINT PAVEMENT MARKINGS ☉ & NO PASSING ZONES

STATION TO STATION	FEET	LINE 4"
CENTERLINE		
0+00 TO 44+45	4,445	1,111
64+50 TO 252+12	18,762	4,691
NO PASSING ZONE		
31+90 TO 64+50 RT	3,260	3,260
44+45 TO 75+70 LT	3,125	3,125
143+10 TO 149+70 RT	660	660
156+20 TO 163+85 LT	765	765
180+85 TO 189+82 RT	897	897
195+80 TO 201+20 LT	540	540
217+00 TO 228+50 RT	1,150	1,150
231+00 TO 238+45 LT	745	745
TOTAL =		16,944

## COUNTY HIGHWAY 45 PAINT PAVEMENT MARKINGS ☉ & NO PASSING ZONES

STATION TO STATION	FEET	LINE 4"
CENTERLINE		
0+00 TO 22+30	2,230	558
30+58 TO 43+84	1,326	332
44+12 TO 53+00	888	222
NO PASSING ZONE		
39+12 TO 44+12 RT	500	500
43+84 TO 48+84 LT	500	500
EDGE LINE		
0+00 TO 22+30	4,460	4,460
30+58 TO 53+00	4,484	4,484
TOTAL =		10,498

## COUNTY HIGHWAY 45 THERMOPLASTIC PAVEMENT MARKINGS ☉ & NO PASSING ZONES

STATION TO STATION	FEET	LINE 4"
CENTERLINE		
22+30 TO 26+16	386	97
26+30 TO 30+58	428	107
NO PASSING ZONE		
22+30 TO 26+30 RT	400	400
26+16 TO 30+16 LT	400	400
EDGE LINE		
22+30 TO 30+58	1,656	1,656
TOTAL =		2,660

TOTAL PAINT PAVT MARKING LINE 4" = 27,442

TOTAL THERMOPLASTIC LINE 4" = 2,660

## EARTH EX WIDENING & HMA SHOULDERS

STATION TO STATION	EARTH EX WIDENING	HMA SHOULDERS
	CU. YDS.	TONS
CH 45		
STA 26+26.00 TO 26+95.00 LT	24.2	51.0
STA 26+95.00 TO 27+58.00 LT	38.5	80.0
STA 27+58.00 TO 28+46.00 LT	39.1	80.0
STA 28+46.00 TO 29+16.00 LT	19.5	40.0
STA 25+75.00 TO 26+20.00 RT	8.2	17.0
STA 26+26.00 TO 26+73.00 RT	8.6	18.0
CH 10		
STA 41+25.00 TO 49+50.00 RT	61.1	188.0
STA 47+00.00 TO 52+50.00 LT	40.8	126.0
TOTAL =	240.0	600.0

## RUMBLE STRIPS

### COUNTY HIGHWAY 10 RUMBLE STRIPS

STATION TO STATION	EACH
245+82 TO 245+57 RT	1
241+32 TO 241+07 RT	1
236+32 TO 236+07 RT	1
TOTAL =	3

### COUNTY HIGHWAY 45 RUMBLE STRIPS

STATION TO STATION	EACH
5+00 TO 5+25 LT	1
7+25 TO 7+50 LT	1
10+00 TO 10+25 LT	1
TOTAL =	3

TOTAL RUMBLE STRIPS = 6

ROUTE NO. FAS 329 & 331	SECTION 05-00298-00-RS F. H. W. A. REG. 4 ILLINOIS	COUNTY IROQUOIS	TOTAL SHEETS 7	SHEET NO. 6
PROJECT RS-0329(104)			CONTRACT 87396	

## HMA SURFACE REMOVAL BUTT JOINT

STATION TO STATION	SQ. YDS.
CH 10	
STA 0+00.00 TO 0+50.00	111.1
STA 0+65.00 INT. RT	111.1
STA 53+25.00 TO 53+75.00	111.1
STA 63+75.00 TO 64+25.00	111.1
STA 251+62.00 TO 252+12.00	111.1
CH 45	
STA 25+86.00 TO 26+36.00	111.1
STA 26+44.00 TO 26+94.00	111.1
STA 43+34.00 TO 43+84.00	116.7
STA 44+14.00 TO 44+64.00	116.7
STA 52+50.00 TO 53+00.00	111.1
STA 26+73.00 TO 26+89.00 RT	7.2
STA 26+89.00 TO 27+46.00 RT	44.4
STA 28+01.00 TO 28+41.00 RT	31.2
TOTAL =	1205.0

## PERMANENT SURVEY MARKERS

STATION	EACH
CH 45	
STA 25+79 < 5' LT OF ☉	1
CH 10	
STA 0+65 < 1800E / 500N	1
STA 52+75 < 1900E / 500N	1
STA 97+69 < 2000E / 500N	1
STA 149+11 < 2100E / 500N	1
TOTAL =	5

## PCC SURFACE REMOVAL BUTT JOINT

STATION TO STATION	SQ. YDS.
CH 45	
STA 27+46.00 TO 28+01.00 RT	50.0
TOTAL =	50.0

ROUTE NO.	SECTION	COUNTY	TOTAL SHEETS	SHEET
FAS 329 & 331	05-00298-00-RS F. H. W. A. REG. 4 ILLINOIS	IRROQUOIS	7	7
			PROJECT RS-0329(104) CONTRACT 87396	

# CH 45 - IN GOODWINE

