

ROUTE NO. T.R. 50	SECTION 05-08145 -00-BR	COUNTY WOODFORD	TOTAL SHEETS 47	SHEET NO. 1
FED. ROAD DIST. NO.		ILLINOIS CONTRACT NO. 89448		

STATE OF ILLINOIS
DEPARTMENT OF TRANSPORTATION
DIVISION OF HIGHWAYS

**PLANS FOR PROPOSED
HIGHWAY BRIDGE PROGRAM**

PROJECT BROS-203(23)
SECTION 05-08145-00-BR
METAMORA ROAD DISTRICT
WOODFORD COUNTY
T.R. 50 / COAL BANK ROAD
PROPOSED STRUCTURE NO. 102-3039
C-94-147-06

INDEX OF SHEETS

SHEET NO.	DESCRIPTION
1.	COVER SHEET
2.	GENERAL NOTES AND HIGHWAY STANDARDS
3.	SUMMARY OF QUANTITIES
4.	SCHEDULE OF QUANTITIES
5.	TYPICAL SECTIONS AND MISC. DETAILS
6.	PLAN SHEET
7.	PROFILE SHEET
8.-9.	EROSION CONTROL SHEETS
10.-28.	STATION CROSS SECTIONS
29.-42.	BRIDGE SHEETS
43.-44.	BORINGS
45.-47.	DISTRICT 4 CADD STANDARDS

UTILITIES

ELECTRIC OVERHEAD:
AMEREN/CILCO
747 HICKORY DRIVE
LACON, IL 61540

BURIED CABLE:

MTCO
220 N. MENARD ST.
METAMORA, IL 61548-0800
PH. 1-309-367-4197

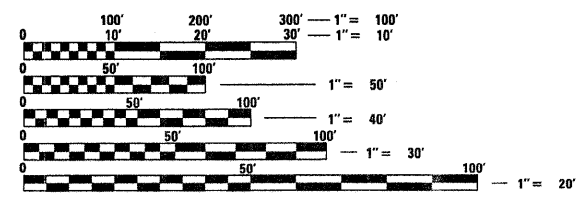

FULL SIZE PLANS HAVE BEEN PREPARED USING STANDARD ENGINEERING SCALES. REDUCED SIZED PLANS WILL NOT CONFORM TO STANDARD SCALES. IN MAKING MEASUREMENTS ON REDUCED PLANS, THE ABOVE SCALES MAY BE USED.

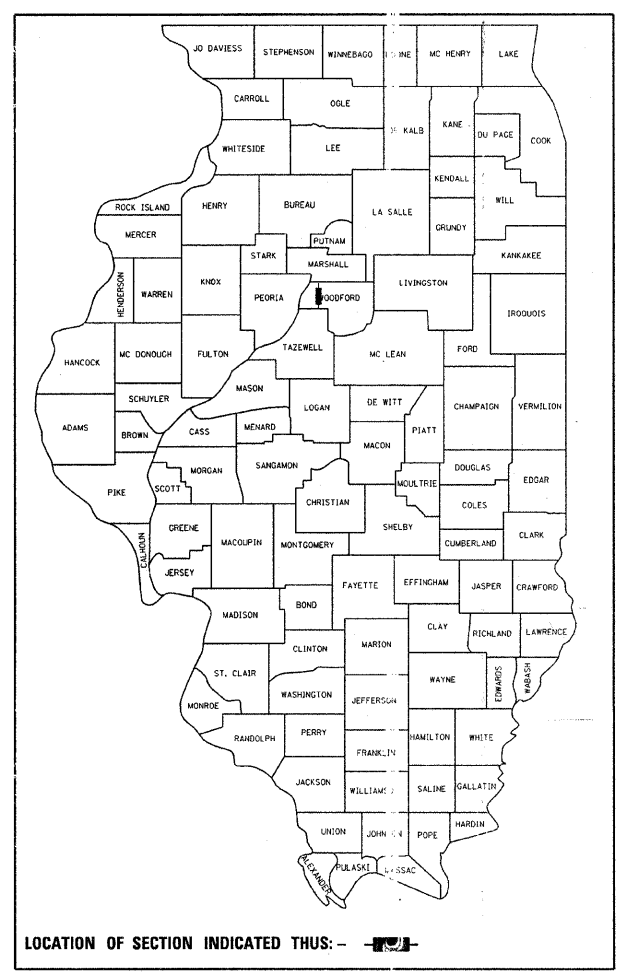

DESIGN DESIGNATION

FUNCTIONAL CLASSIFICATION: LOCAL ROAD (250-400 ADT)
DESIGN SPEED: 40 MPH
DESIGN TRAFFIC: 375 ADT (2005)

WOODFORD COUNTY HIGHWAY DEPT.	
APPROVED	<u>2-3-2009</u> <i>James L. Schuler</i> TOWNSHIP COMMISSIONER
APPROVED	<u>2/03</u> 20 09 <i>Dennis Rabin</i> COUNTY ENGINEER
PASSED	<u>02/25</u> 20 09 <i>Dorothy C. Parsh</i> DISTRICT FOUR ENGINEER OF LOCAL ROADS & STREETS
Releasing For Bid Based on Limited Review	<u>Feb 27</u> 20 09 <i>[Signature]</i> DEPUTY DIRECTOR OF HIGHWAYS REGION THREE ENGINEER STATE OF ILLINOIS DEPARTMENT OF TRANSPORTATION

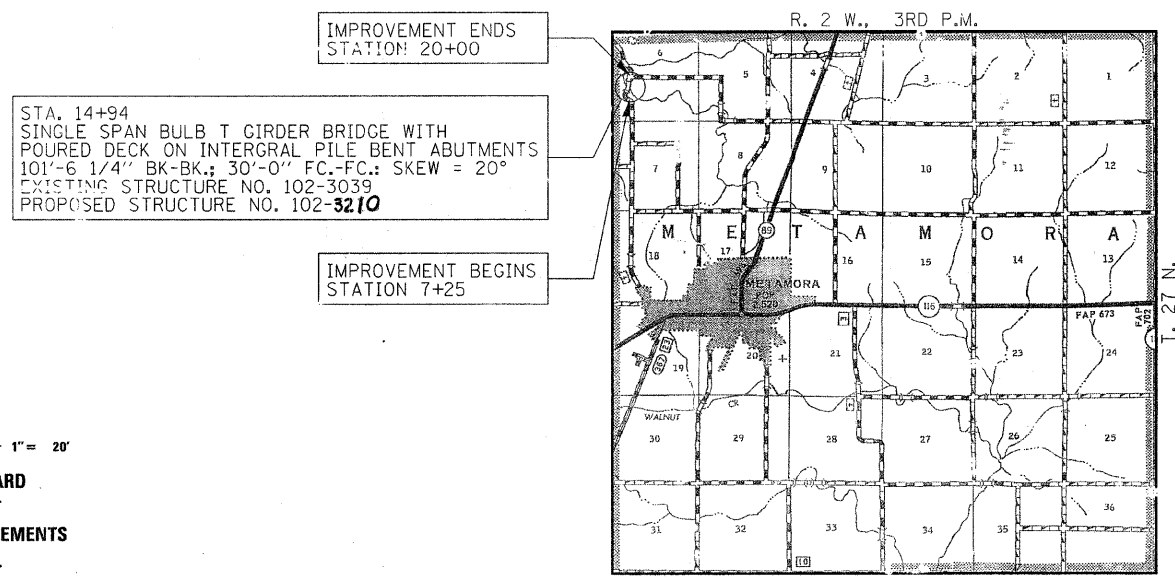
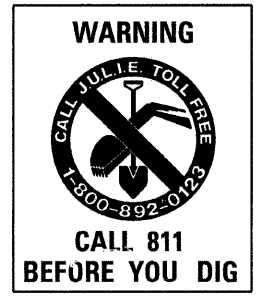

LOCATION MAP

APPROXIMATE SCALE: 1 MILE
NET LENGTH OF SECTION = 1,275 FEET = 0.241 MILES

CONTRACT NO. 89448
CATALOG NO. 033338-000

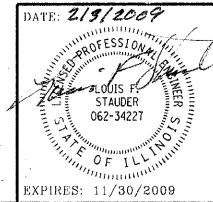

HAMPTON, LENZINI & RENWICK, INC.
CIVIL & STRUCTURAL ENGINEERS
LAND SURVEYORS
3385 STEVENSON DRIVE, SUITE 201
SPRINGFIELD, ILLINOIS 62703
(217) 546-3400
ELGIN • SPRINGFIELD
PROJECT NUMBER: 07-0373-130 DATE: 02/02/09