

DATE	
BY	
SURVEYED	
PLOTTED	
TEMPLATE	
NOTE BOOK	
AREAS CHECKED	
NO.	

DATE	
BY	
SURVEYED	
PLOTTED	
TEMPLATE	
NOTE BOOK	
AREAS CHECKED	
NO.	

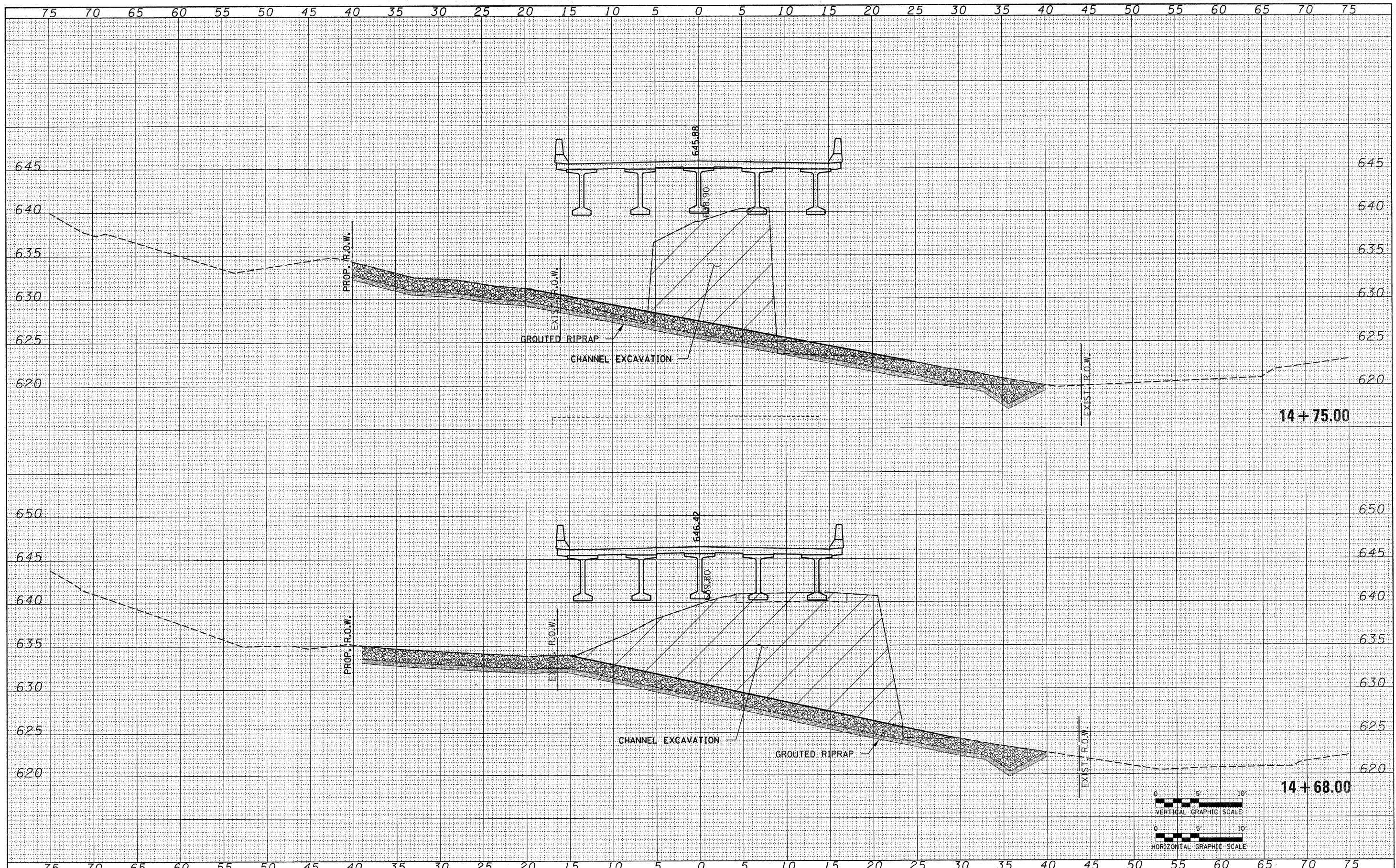

FILE NAME = 070373-sht-sss-At1B.dgn

USER NAME =
 DESIGNED - L.F.S.
 DRAWN - TWK
 CHECKED - S.W.M.
 DATE - 10/31/08

REVISIONS:
 REVISED -
 REVISED -
 REVISED - 02/02/09
 REVISED -

STATE OF ILLINOIS
 WOODFORD COUNTY HIGHWAY DEPARTMENT

HLR HAMPTON, LENZINI & RENWICK, INC.
 CIVIL & STRUCTURAL ENGINEERS
 LAND SURVEYORS

CROSS SECTIONS
 COAL BANK ROAD

SCALE: SHEET NO. OF SHEETS STA. 14+68.00 TO STA. 14+75.00

T.R.	SECTION	COUNTY	TOTAL SHEETS	SHEET NO.
50	05-08145-00-BR	WOODFORD	47	21
METAMORA R.D.		CONTRACT NO. 89448		
FED. ROAD DIST. NO.		ILLINOIS FED. AID PROJECT		