

F.A.U. RTE.	SECTION	COUNTY	TOTAL SHEETS	SHEET NO.
	05-00333-00-BT	McLEAN	56	36
STA.		TO STA.		
FED. ROAD DIST. NO.		ILLINOIS FED. AID PROJECT		

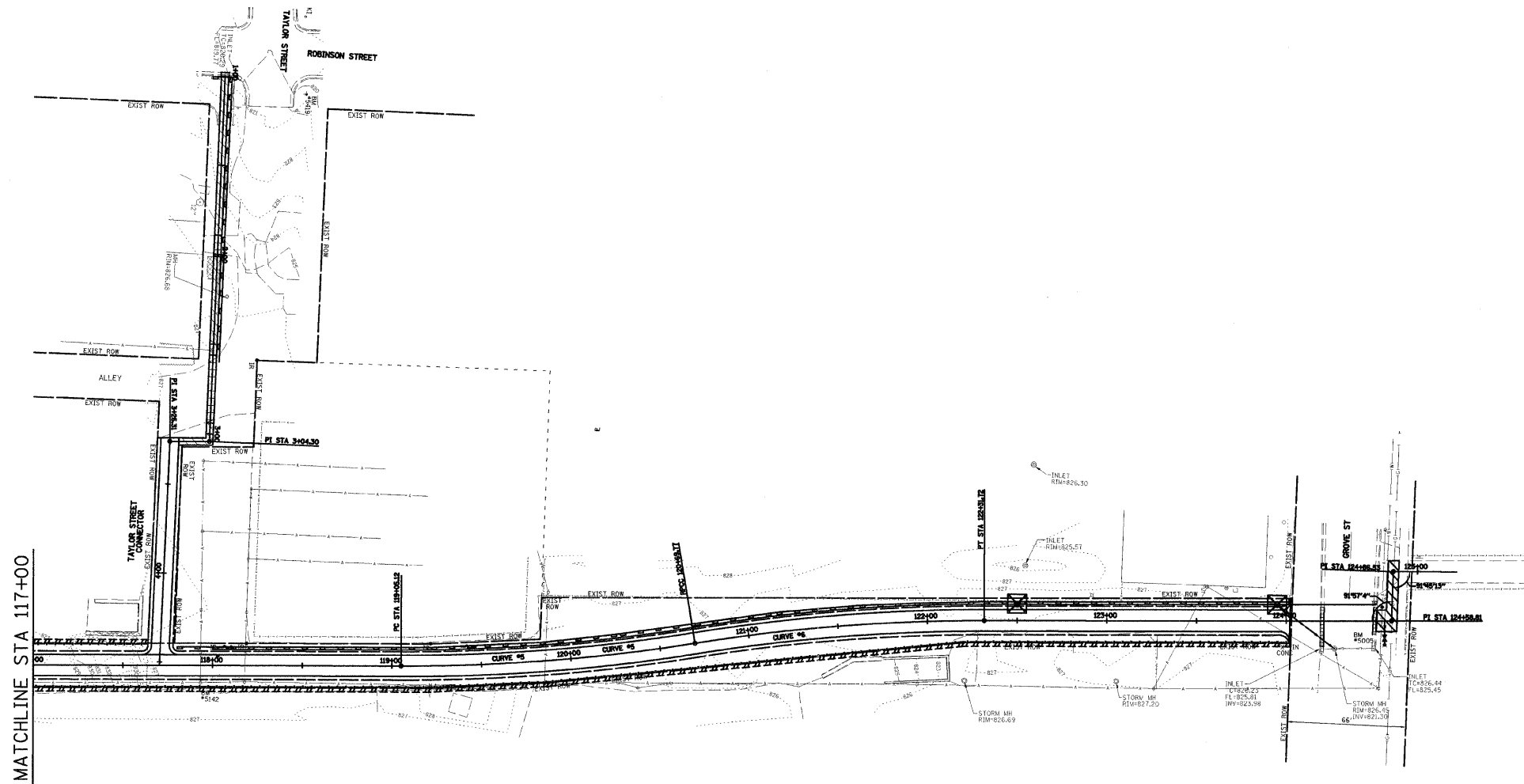

MATCHLINE STA 117+00

EROSION CONTROL LEGEND	
	INLET FILTERS OR INLET & PIPE PROTECTION
	PERIMETER EROSION CONTROL BARRIER
	TEMPORARY DITCH CHECKS

INTENDED SEQUENCE

1. PLACE PERIMETER EROSION CONTROL BARRIER PRIOR TO THE COMMENCEMENT OF ANY WORK. SEE STANDARD 280001.
2. PLACE INLET AND PIPE PROTECTION ON ALL INLETS OR PIPE CULVERTS REMAINING ON THE PROJECT.
3. INSTALL TEMPORARY DITCH CHECKS IN EXISTING DITCHES.
4. INSTALL WATERMAIN, SANITARY SEWER AND STORM SEWER.
5. PLACE INLET AND PIPE PROTECTION ON ALL NEW INLETS OR PIPE CULVERTS.
6. PERFORM EARTH EXCAVATION AND EMBANKMENT.
7. PLACE TEMPORARY EROSION CONTROL SEEDING ON ALL BARE EARTH AREAS.
8. PLACE PERMANENT EROSION CONTROL SEEDING AS SOON AS CONSTRUCTION PERMITS.

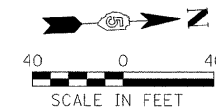

CITY OF BLOOMINGTON, ILLINOIS  
MFT SECTION 05-00333-00-BT

EROSION CONTROL PLAN  
"SWPPP"

DRAWN BY DRR	 2709 McGraw Drive Bloomington, Illinois 61704 309/863-8488 309/863-1971 fax	FILE NO. 24-8173
DATE 01/30/09		BOOK NO. 2752
CHECKED BY PJM		SHEET NO. 36 OF 56