

EROSION CONTROL PLAN & STORMWATER POLLUTION PREVENTION PLAN

THIS PROJECT DISTURBS 2.99 ACRES OF TOTAL LAND AREA. COMPLIANCE WITH THE NATIONAL POLLUTION DISCHARGE ELIMINATION SYSTEM (NPDES) STORMWATER PERMIT IS NECESSARY IF A PROJECT DISTURBS 1 OR MORE ACRES OF TOTAL LAND AREA; AN NPDES STORMWATER PERMIT WILL BE REQUIRED FOR THIS PROJECT. SEE SWPPP IN SPECIAL PROVISIONS.

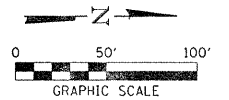

PI STA. 4+52.74
 $\Delta = 18^\circ 24' 45''$ (RT)
 $D = 5^\circ 27' 24''$
 $T = 170.18'$
 $R = 1,050.00'$
 $L = 337.43'$
 $E = 13.70'$
 PC STA. 2+82.56
 PT STA. 6+19.99
 $S.E. = 3.5\%$
 S.E. TRANSITION
 STA. 2+07.20 TO STA. 3+07.68
 STA. 5+94.87 TO STA. 6+95.35

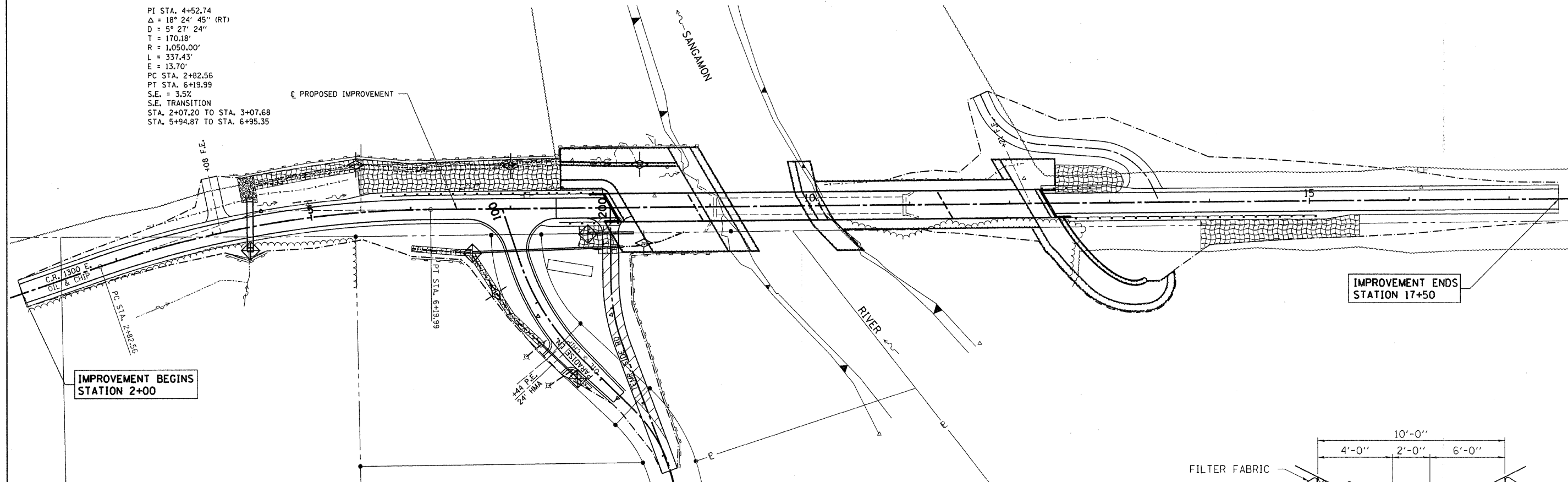

**IMPROVEMENT BEGINS
STATION 2+00**

**IMPROVEMENT ENDS
STATION 17+50**

GENERAL NOTES FOR SOIL EROSION CONTROL

1. SOIL EROSION AND SEDIMENT CONTROL FEATURES SHALL BE CONSTRUCTED PRIOR TO THE COMMENCEMENT OF UPLAND DISTURBANCE. SOIL DISTURBANCE SHALL BE CONDUCTED IN SUCH A MANNER TO MINIMIZE EROSION. SOIL STABILIZATION MEASURES SHALL CONSIDER THE TIME OF YEAR, SITE CONDITIONS AND THE USE OF TEMPORARY OR PERMANENT MEASURES.
2. PERIMETER EROSION BARRIER SHALL BE INSTALLED AT LOCATIONS SPECIFIED IN THE PLANS AT 4 FEET OUTSIDE THE TOE OF SLOPE OR INSIDE THE RIGHT-OF-WAY WHICHEVER IS CLOSER TO THE CENTERLINE, OR AS DIRECTED BY THE ENGINEER PRIOR TO THE START OF ANY EARTHWORK, CULVERT, OR STORM SEWER CONSTRUCTION. STAKES SHALL BE PLACED AT A MINIMUM OF 4 FOOT INTERVALS. SEE CODE 920 OF THE ILLINOIS URBAN MANUAL AND CONTRACT SPECIAL PROVISIONS.
3. THE PERIMETER EROSION BARRIER SHALL BE REMOVED WITHIN 30 DAYS AFTER ALL DISTURBED AREAS HAVE BEEN STABILIZED WITH VEGETATION. AFTER THE PERIMETER EROSION BARRIER IS REMOVED, ALL AREAS DAMAGED BY THE FENCE INSTALLATION SHALL BE RESTORED.
4. THE FENCE INSTALLATION, MAINTENANCE, REMOVAL AND THE RESTORATION OF THE AREA DISTURBED BY THE FENCE INSTALLATION IS INCLUDED IN COST OF THE PAY ITEM PERIMETER EROSION BARRIER.
5. TEMPORARY DITCH CHECKS SHALL BE CONSTRUCTED AS PER CONTRACT SPECIAL PROVISIONS OR AS SHOWN HEREON OR AS DIRECTED BY THE ENGINEER. THE DITCH CHECKS SHALL BE INSTALLED IMMEDIATELY AS GRADING PROGRESSES THROUGH THE PROJECT. THE PAY ITEM FOR TEMPORARY DITCH CHECK SHALL INCLUDE THE COST OF INSTALLATION, AND REMOVAL.
6. THE CLEARING OR REMOVAL OF TRAPPED SEDIMENT FROM TEMPORARY DITCH CHECK, PERIMETER EROSION BARRIER OR SILT TRAPS WILL NOT BE PAID FOR SEPARATELY BUT WILL BE INCLUDED IN THE COST OF TEMPORARY DITCH CHECKS, PERIMETER EROSION BARRIER OR SILT TRAPS. SEDIMENT SHALL BE REMOVED WHEN SILTATION REACHES 50% CAPACITY OF STRUCTURE. SEE APPLICABLE STANDARDS, SPECIFICATIONS, AND CONTRACT SPECIAL PROVISIONS FOR: EROSION AND SEDIMENT CONTROL, ILLINOIS URBAN MANUAL.
7. THE CONTRACTOR SHALL CLEAN UP AND GRADE THE WORK AREA AS THE PROJECT PROGRESSES TO ELIMINATE THE CONCENTRATION OF RUNOFF. THE PAVEMENT SHALL BE CLEANED DAILY TO REMOVE EARTH MATERIAL TO THE SATISFACTION OF THE ENGINEER.
8. ALL DISTURBED AREAS SHALL BE SEEDED AS DIRECTED BY THE ENGINEER. FINAL SEEDING SHALL CONFORM TO SEEDING CLASS 2 SPECIAL AS PER IDOT STANDARD SPECIFICATIONS AND CONTRACT SPECIAL PROVISIONS.
9. THE CONTRACTOR SHALL MAINTAIN AND PRESERVE ANY EXISTING SUB SURFACE DRAINAGE SYSTEMS (i.e. FIELD TILES) ACCORDING TO SECTION 611 OF THE IDOT STANDARD SPECIFICATIONS.

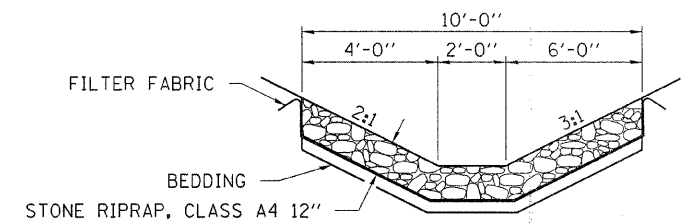

STONE RIPRAP DITCH

LEGEND

- EROSION CONTROL BLANKET
- PERIMETER EROSION BARRIER
- INLET AND PIPE PROTECTION
- TEMPORARY DITCH CHECK
- STONE RIPRAP CLASS A4

| | | | | | | | | | | | |
|--------------------------------------|-------------|-------------------|-----------|---|---|--|---|--------------------------|--------------------|--------------------|-----------------|
| FILE NAME = 75001-sht-erosion.dgn | USER NAME = | DESIGNED - L.F.S. | REVISED - | STATE OF ILLINOIS DEPARTMENT OF TRANSPORTATION | HAMPTON, LENZINI & RENWICK, INC. CIVIL & STRUCTURAL ENGINEERS LAND SURVEYORS | EROSION CONTROL SANGAMON ROAD DIST. | T.R. 154 | SECTION 03-6130-00-BR | COUNTY PIATT | TOTAL SHEETS 57 | SHEET NO. 12 |
| PLOT SCALE = | | CHECKED - S.W.M. | REVISED - | SCALE: SHEET NO. OF SHEETS | | STA. TO STA. | FED. ROAD DIST. NO. [ILLINOIS] FED. AID PROJECT | | CONTRACT NO. 91385 | | |
| PLOT DATE = 12/23/2008 | | DATE - 8/05/08 | REVISED - | | | | | | | | |