

EXISTING TL
CURVE #1
P.I. STA= 31+20.19
Δ= 16°46'46" LT
D= 03°30'00"
R= 1637.02 FT
T= 241.43 FT
L= 479.40 FT
E= 17.71 FT
S.E.= 0.057%
P.C. STA= 28+78.76
P.T. STA= 33+58.16
TRANSITION STA 27+78.76 TO STA 29+28.76
TRANSITION STA 34+58.16 TO STA 33+08.16
(MATCH EXISTING ALIGNMENT)

IMPROVEMENT BEGINS
STA 27+62.00

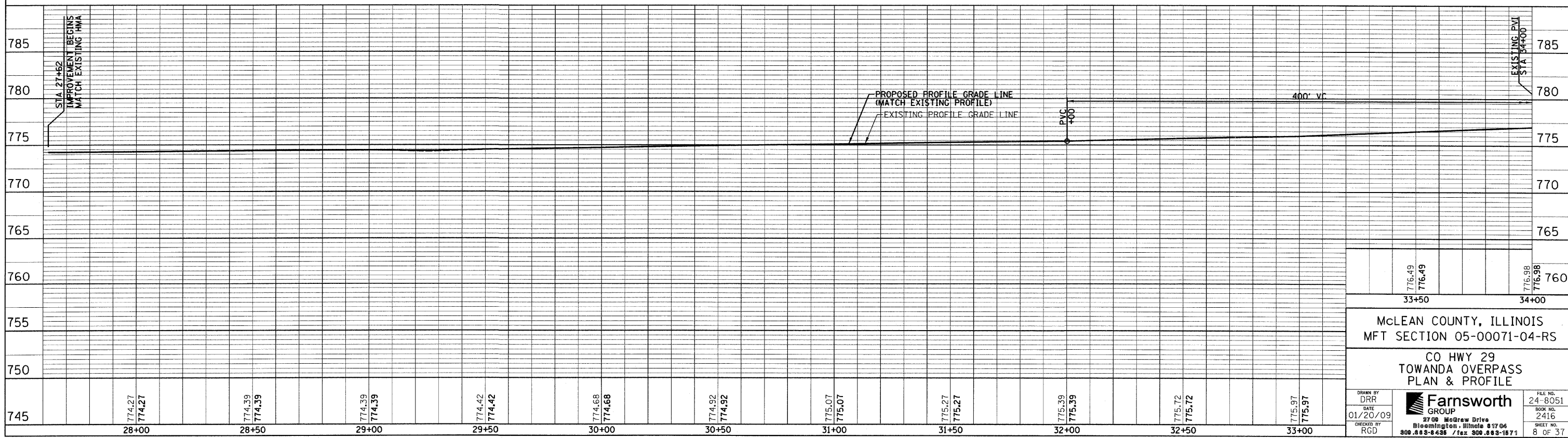
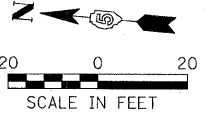
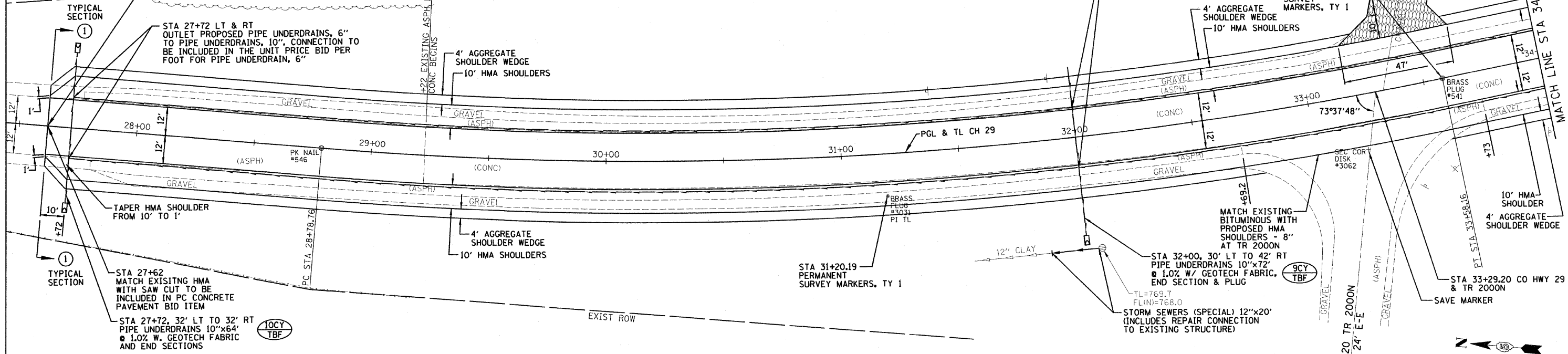

776.49 776.49				776.98 776.98			
33+50				34+00			
<p>McLEAN COUNTY, ILLINOIS MFT SECTION 05-00071-04-RS</p> <p>CO HWY 29 TOWANDA OVERPASS PLAN & PROFILE</p>							
DRAWN BY DRR	DATE 01/20/09	CHECKED BY RGD	Farnsworth GROUP 2700 McGraw Drive Bloomington, Illinois 61704 309.883-8435 / fax 309.883-1871		FILE NO. 24-8051	BOOK NO. 2416	SHEET NO. 8 OF 37

FILE:
DATE: