

MCLEAN COUNTY, ILLINOIS  
MFT SECTION 05-00071-04-RS  
STREET CROSS SECTIONS  
SCALE: H 1" = 10' V 1" = 5'

FINAL SURVEY	SURVEYED	BY	DATE
NOTE BOOK	PLOTTED		
NO.	TEMPLATE		
	AREAS CHECKED		

ORIGINAL SURVEY	SURVEYED	BY	DATE
NOTE BOOK	PLOTTED		
NO.	TEMPLATE		
	AREAS CHECKED		

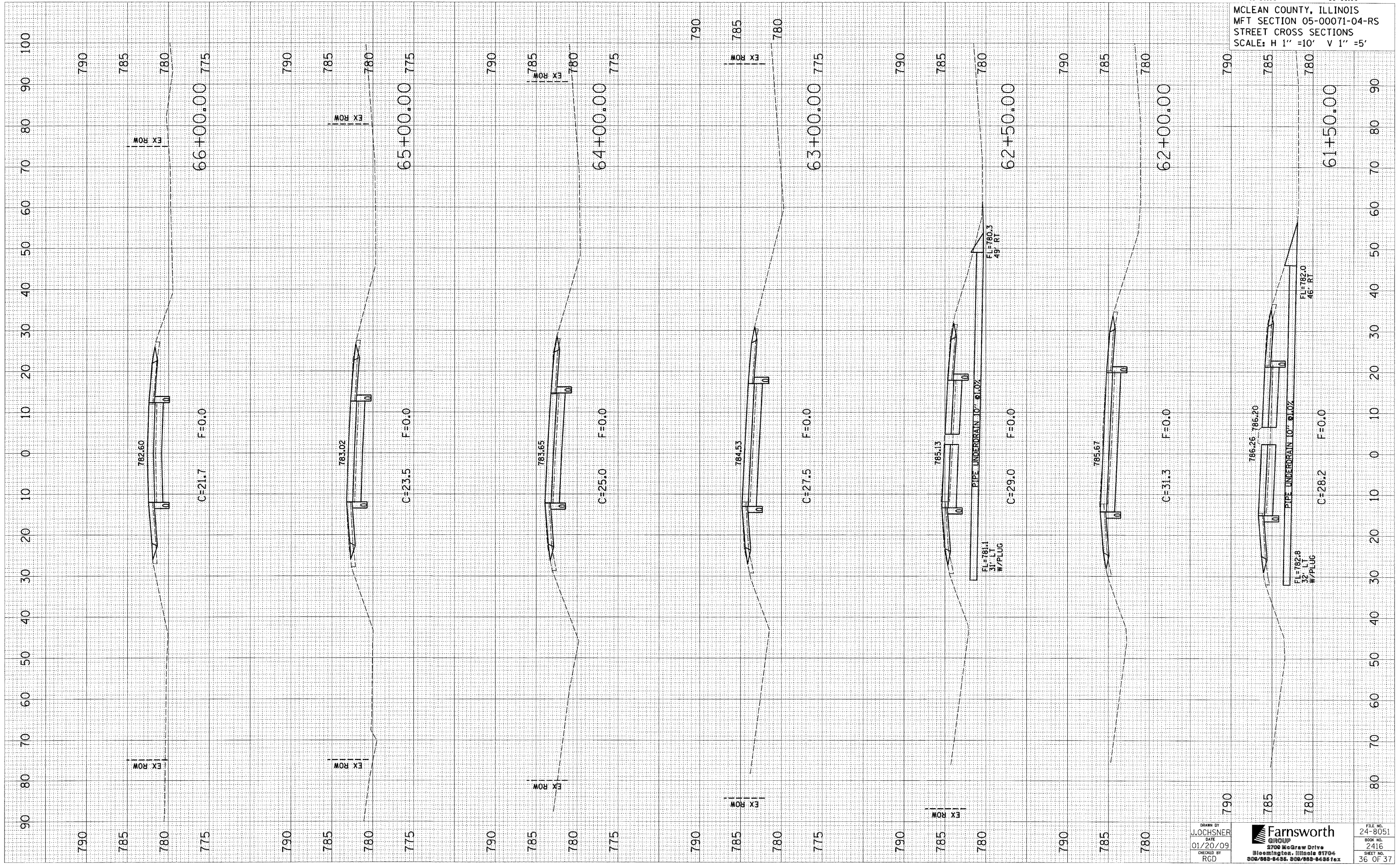

DRAWN BY  
J. JOCHNER  
DATE  
01/20/09  
CHECKED BY  
RGD

**Farnsworth**  
GROUP  
2700 McGraw Drive  
Bloomington, Illinois 61704  
309/882-8456 309/882-8435 fax

FILE NO.  
24-8051  
BOOK NO.  
2416  
SHEET NO.  
36 OF 37