

MCLEAN COUNTY, ILLINOIS  
MFT SECTION 05-00071-04-RS  
STREET CROSS SECTIONS  
SCALE: H 1" = 10' V 1" = 5'

FINAL SURVEY	SURVEYED	BY	DATE
NOTE BOOK NO.	PLOTTED		
	TEMPLATE		
	AREAS CHECKED		

ORIGINAL SURVEY	SURVEYED	BY	DATE
NOTE BOOK NO.	PLOTTED		
	TEMPLATE		
	AREAS CHECKED		

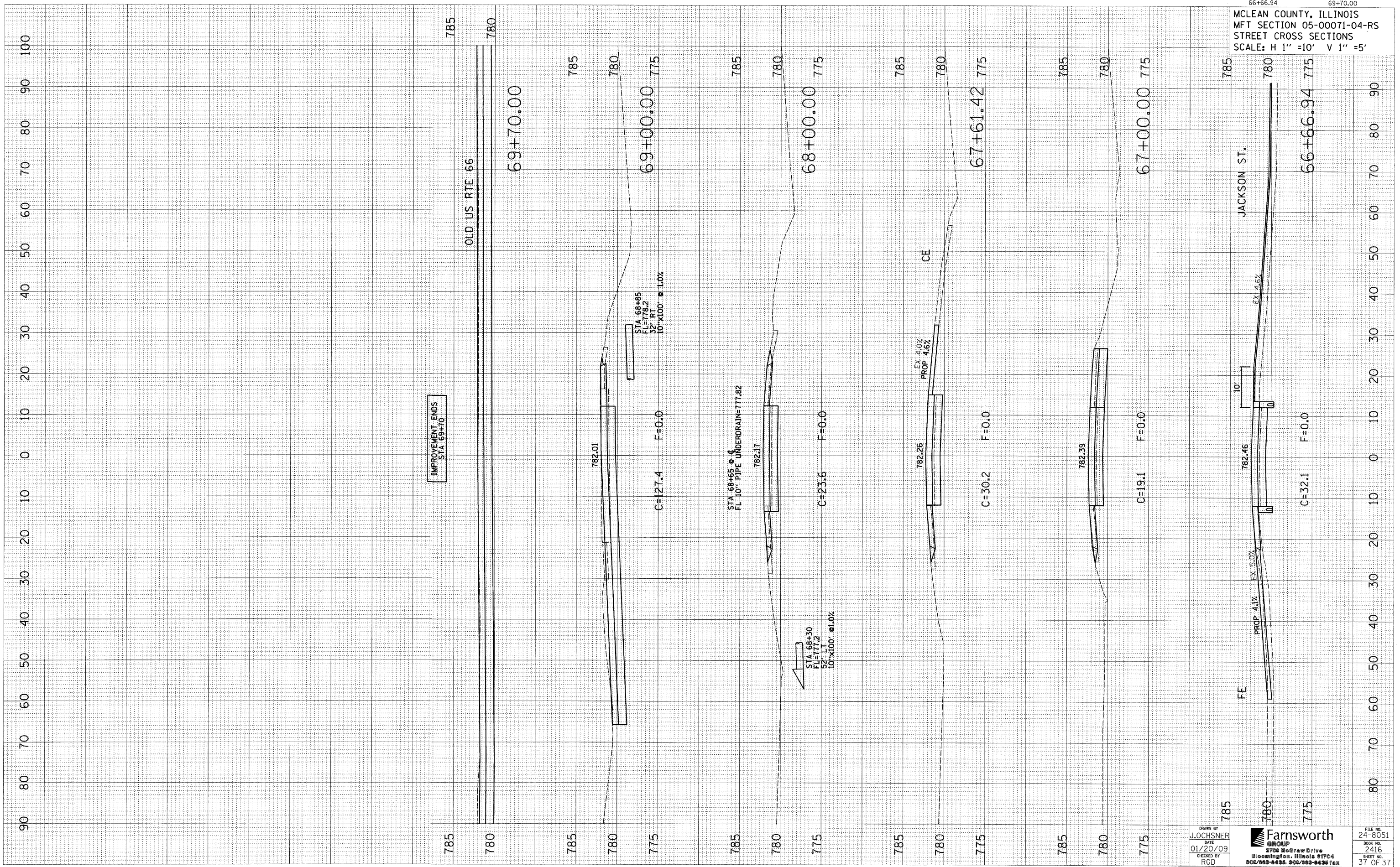

DRAWN BY  
J. OCHSNER  
DATE  
01/20/09  
CHECKED BY  
RGD

**Farnsworth GROUP**  
2700 McDrew Drive  
Bloomington, Illinois 61704  
304/652-8455, 304/652-8436 fax

FILE NO.  
24-8051  
BOOK NO.  
2416  
SHEET NO.  
37 OF 37