

F.A.S. RTE.	SECTION	COUNTY	TOTAL SHEETS	SHEET NO.
608	97-00043-01-FP	SCOTT	17	8
STA. 90+00		TO STA. 120+00		
FED. ROAD DIST. NO.		ILLINOIS PROJECT NO SR-0608(109)		

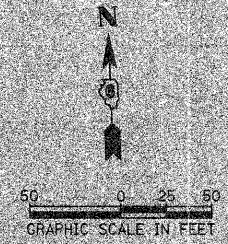

PROP. CURVE CH7-3  
 P.I. STA. = 107+31.11  
 $\Delta = 4^{\circ} 10' 00''$  (RT)  
 $D = 0^{\circ} 40' 00''$   
 $R = 8,594.33'$   
 $T = 312.64'$   
 $L = 625.00'$   
 $E = 5.68'$   
 $e = NC$   
 P.C. STA. = 104+18.48  
 P.T. STA. = 110+43.47

PROP. CURVE CH7-4  
 P.I. STA. = 119+51.89  
 $\Delta = 5^{\circ} 44' 12''$  (LT)  
 $D = 0^{\circ} 48' 00''$   
 $R = 7,161.98'$   
 $T = 358.84'$   
 $L = 717.08'$   
 $E = 8.98'$   
 $e = NC$   
 P.C. STA. = 115+93.05  
 P.T. STA. = 123+10.13

PROP. CURVE CH7-5  
 P.I. STA. = 107+31.11  
 $\Delta = 4^{\circ} 10' 00''$  (RT)  
 $D = 0^{\circ} 40' 00''$   
 $R = 8,594.33'$   
 $T = 312.64'$   
 $L = 625.00'$   
 $E = 5.68'$   
 $e = NC$   
 P.C. STA. = 104+18.48  
 P.T. STA. = 110+43.47

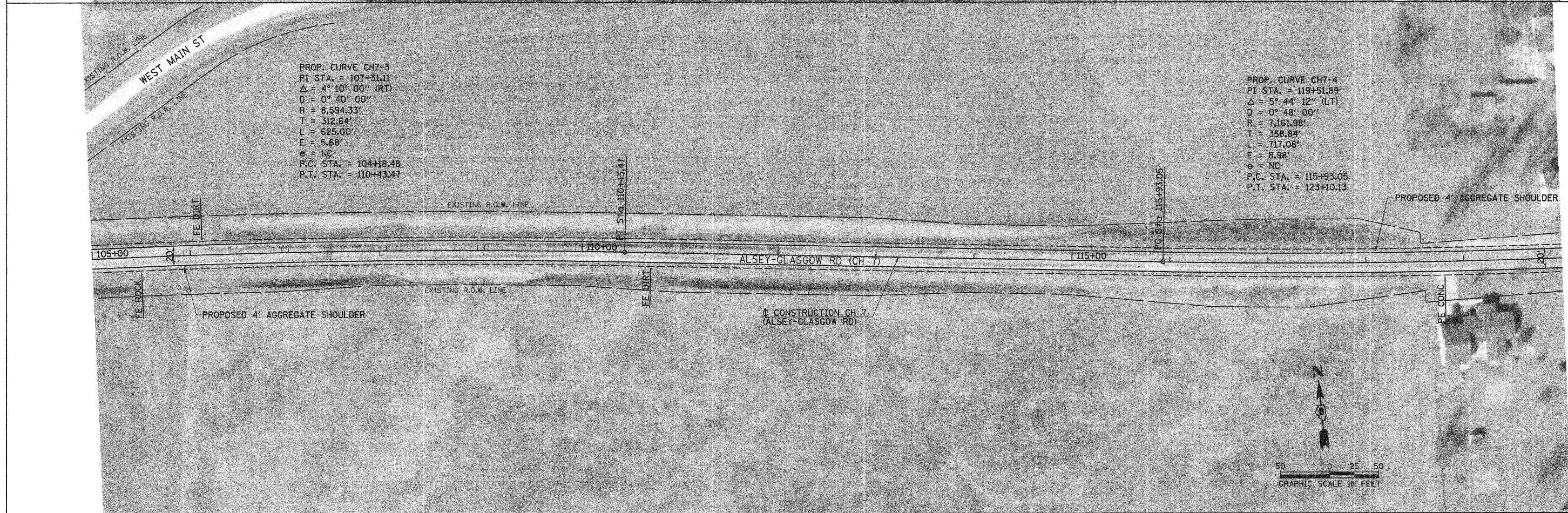
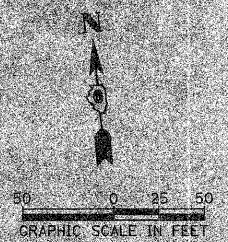

PLOT DATE = 3/2/2009  
 FILE NAME = V:\2438\COMBINED PLANS\2438p08.dgn  
 SCALE = 50.0000' / 1" = 5000.0000'  
 USER NAME = sborgman