

ROUTE NO.	SECTION	CITY	TOTAL SHEETS	SHEET NO.
STEVENS CREEK BIKEWAY	99-P4000-00-BP	DECATUR PARK DIST	145	43
FED. ROAD DIST. NO.		ILLINOIS	PROJECT TE-0007(27)	

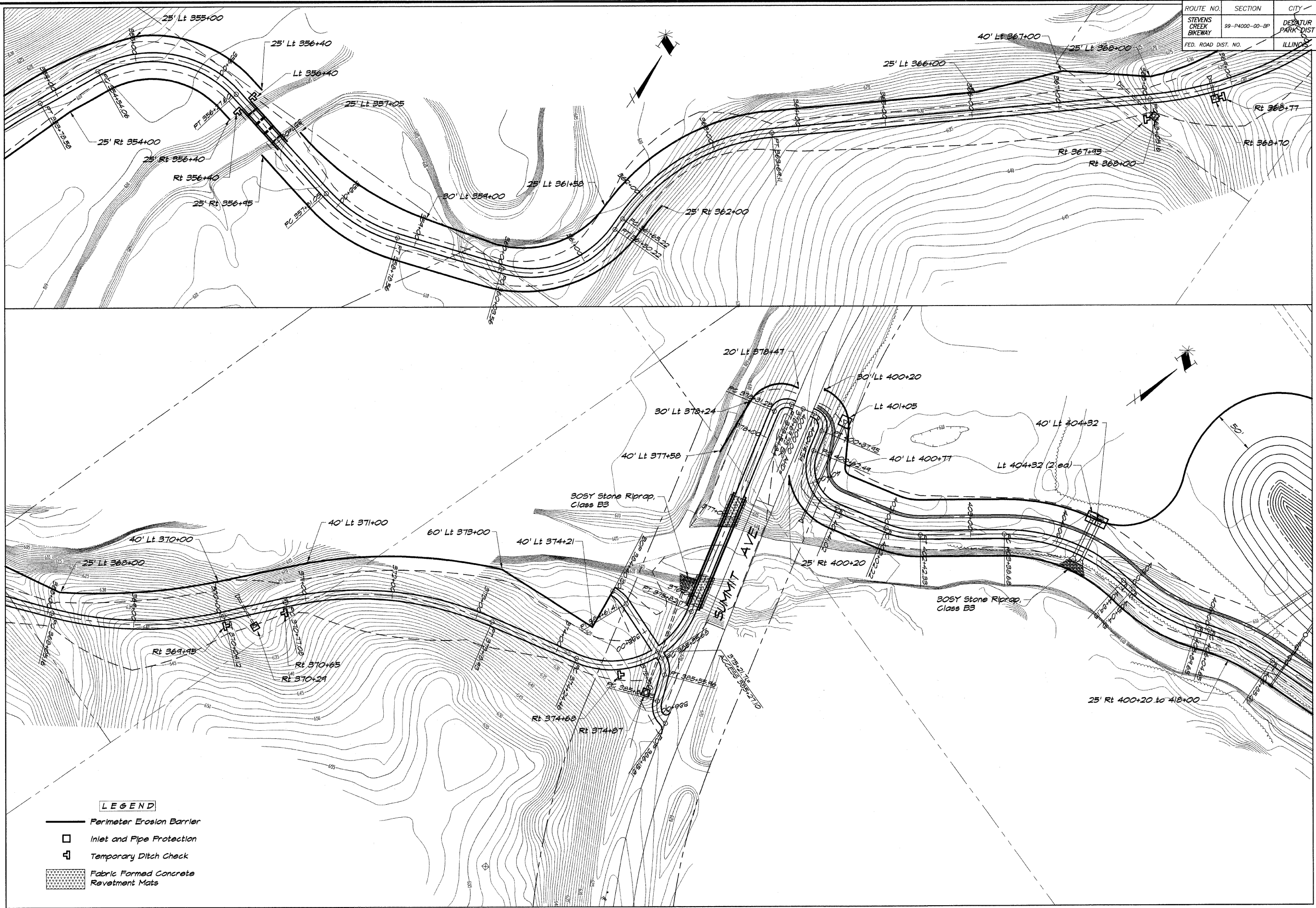

BAINBRIDGE & ASSOCIATES, INC.
GEBE
MULANSKI
 Consulting Engineers
 1000 W. JACKSON ST. SUITE 100
 DECATUR, ILLINOIS 62521
 Phone: 618-401-1265

REVISIONS

NO.	BY	DATE

DESIGNED NHP
DRAWN P m/s
SCALE 1" = 50'
DATE May 2002
FIELD BOOK XXX
JOB NO. 99008

DECATUR PARK DISTRICT
STEVENS CREEK BIKEWAY - PHASE I
EROSION CONTROL PLAN