

ROUTE NO.	SECTION	CITY	TOTAL SHEETS	SHEET NO.
STEVENS CREEK BIKEWAY	99-P4000-00-BP	DECATUR PARK DIST	145	47
FED. ROAD DIST. NO.		ILLINOIS	PROJECT TE-0007(27)	

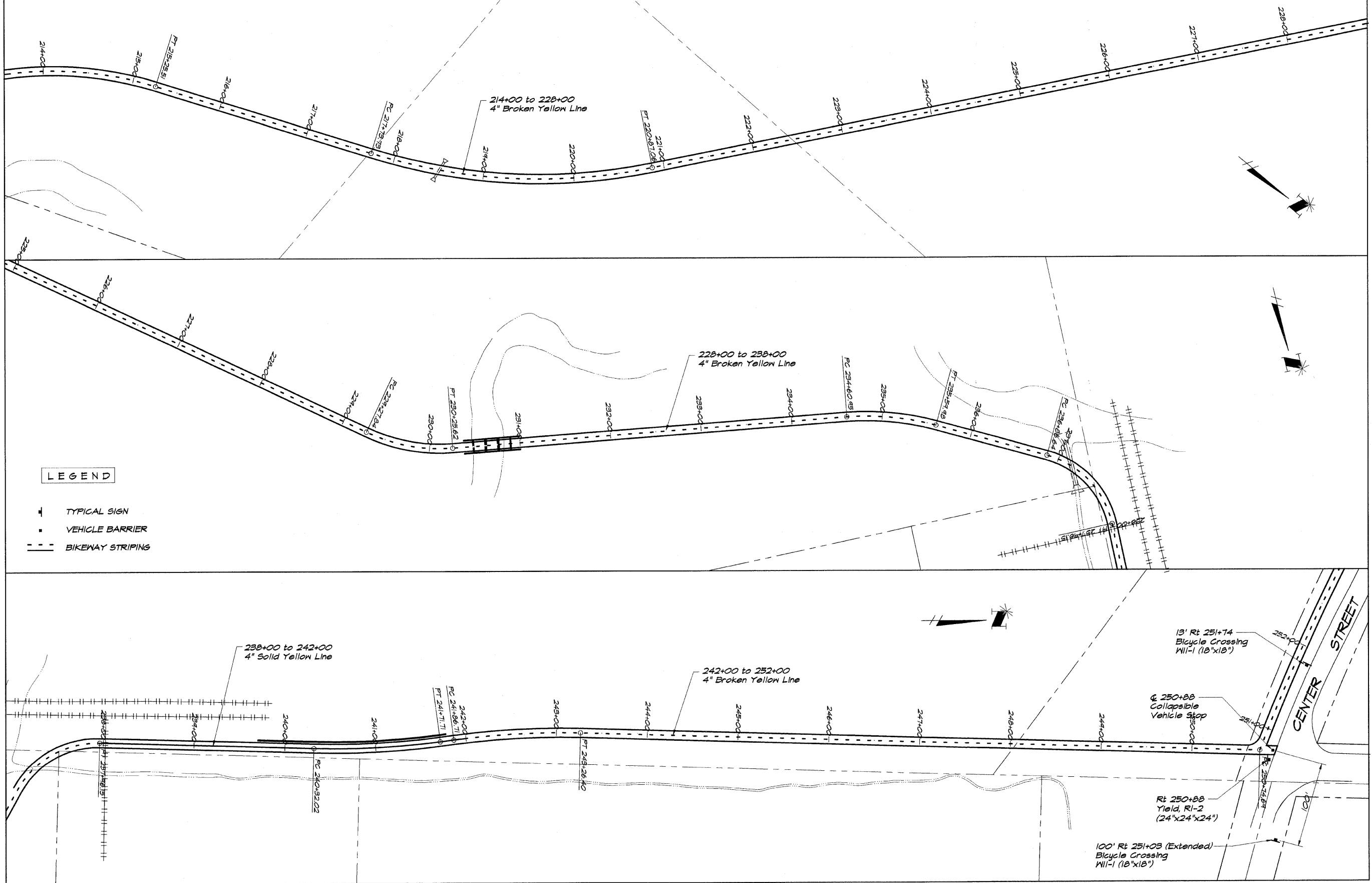

LEGEND

+	TYPICAL SIGN
■	VEHICLE BARRIER
---	BIKEWAY STRIPING

BATHURDGE & ASSOCIATES, INC.
GEB
MILLHART
 Consulting Engineers
 1000 W. TAYLORVILLE ROAD
 DECATUR, ILLINOIS
 Illinois License 184001285

REVISIONS

NO.	BY	DATE

SCALE: 1" = 50'
 DATE: May 2002
 DRAWN: P. Miller
 DESIGNED: MHP
 FIELD BOOK: XXX
 JOB NO.: 99C044

DECATUR PARK DISTRICT
STEVENS CREEK BIKEWAY - PHASE I
PAVEMENT MARKING AND SIGNING PLAN