

ROUTE NO.	SECTION	CITY	TOTAL SHEETS	SHEET NO.
STEVENS CREEK BIKEWAY	49-P4000-00-BP	DECATUR PARK DIST	145	60
ROAD DIST. NO.		ILLINOIS	PROJECT TE-00D7(27)	

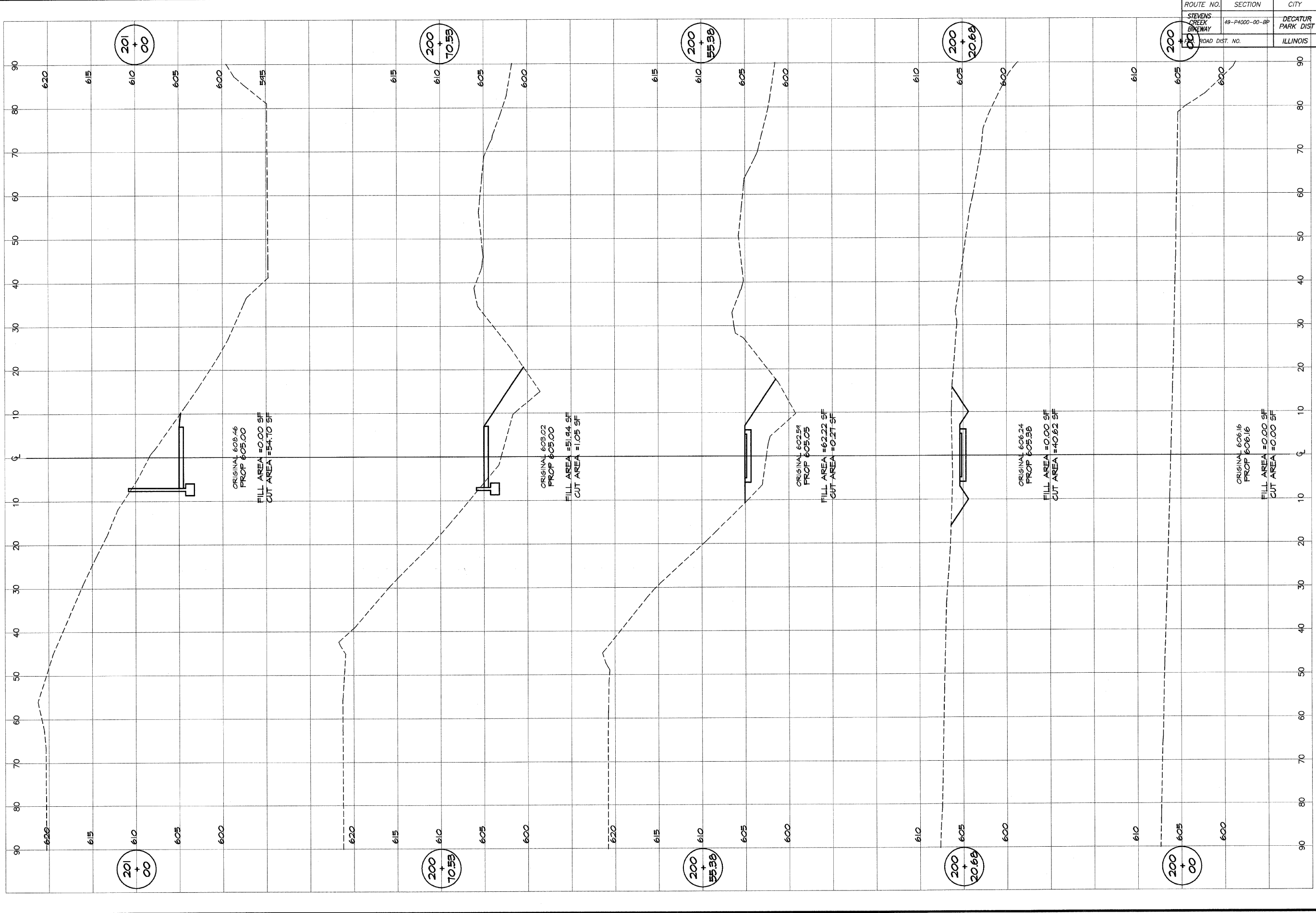

BAINBRIDGE
GEE
MILANSKI
 & ASSOCIATES, INC.
 Consulting Engineers
 1000 W. TAYLOR ST. #100
 DECATUR, ILLINOIS 62521
 Since License 18400282

DESIGNED	SCALE	REVISIONS
MHP	as noted	
DRWN	DATE	NO. BY DATE
P mls	Jan 2004	
FIELD BOOK	JOB NO.	
XXX	49049	

DECATUR PARK DISTRICT
 STEVENS CREEK BIKEWAY - PHASE I
 CROSS SECTIONS
 FAIRVIEW TO CENTER