

ROUTE NO.	SECTION	CITY	TOTAL SHEETS	SHEET NO.
STEVENS CREEK BIKEWAY	19-P4000-00-0P	DECATUR PARK DIST	145	61
FED. ROAD DIST. NO.		ILLINOIS	PROJECT TE-0007(27)	

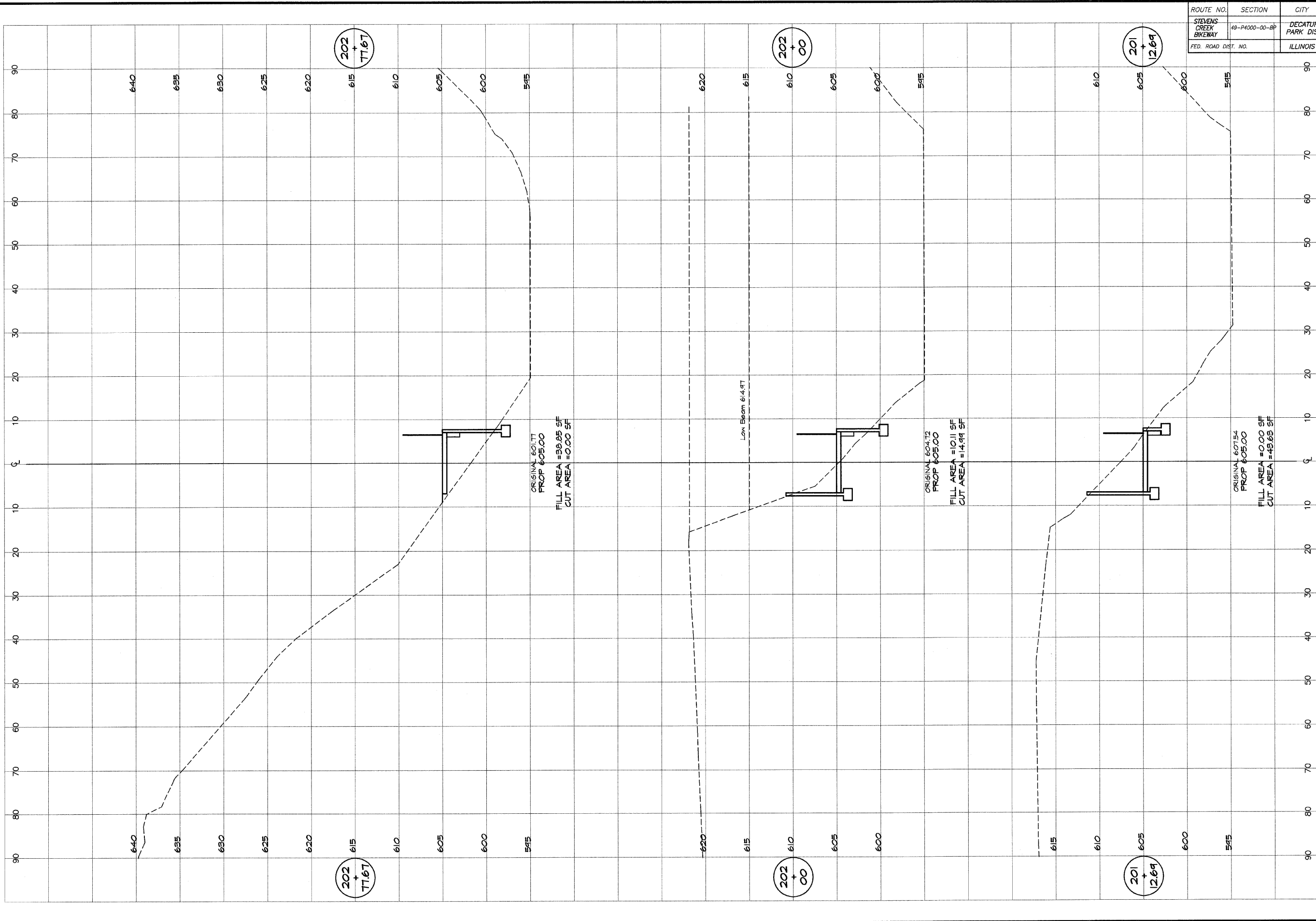

BAINBRIDGE & ASSOCIATES, INC.
 Consulting Engineers
 1111 W. TAYLOR ST.
 DECATUR, ILLINOIS 62521
 License No. 184-07188

DESIGNED	SCALE	REVISIONS
MHP	as noted	
DRWN	DATE	NO. BY DATE
P M/S	Jan. 2004	
FIELD BOOK	JOB NO.	
XXX	410214	

DECATUR PARK DISTRICT
 STEVENS CREEK BIKEWAY - PHASE I
 CROSS SECTIONS
 FAIRVIEW TO CENTER