

ROUTE NO. STEVENS CREEK BIKEWAY	SECTION 99-P4000-00-BP	CITY DECATUR PARK DIST	TOTAL SHEETS 145	SHEET NO. 95
ROAD DIST. NO. 348	ILLINOIS		PROJECT TE-0007(27)	

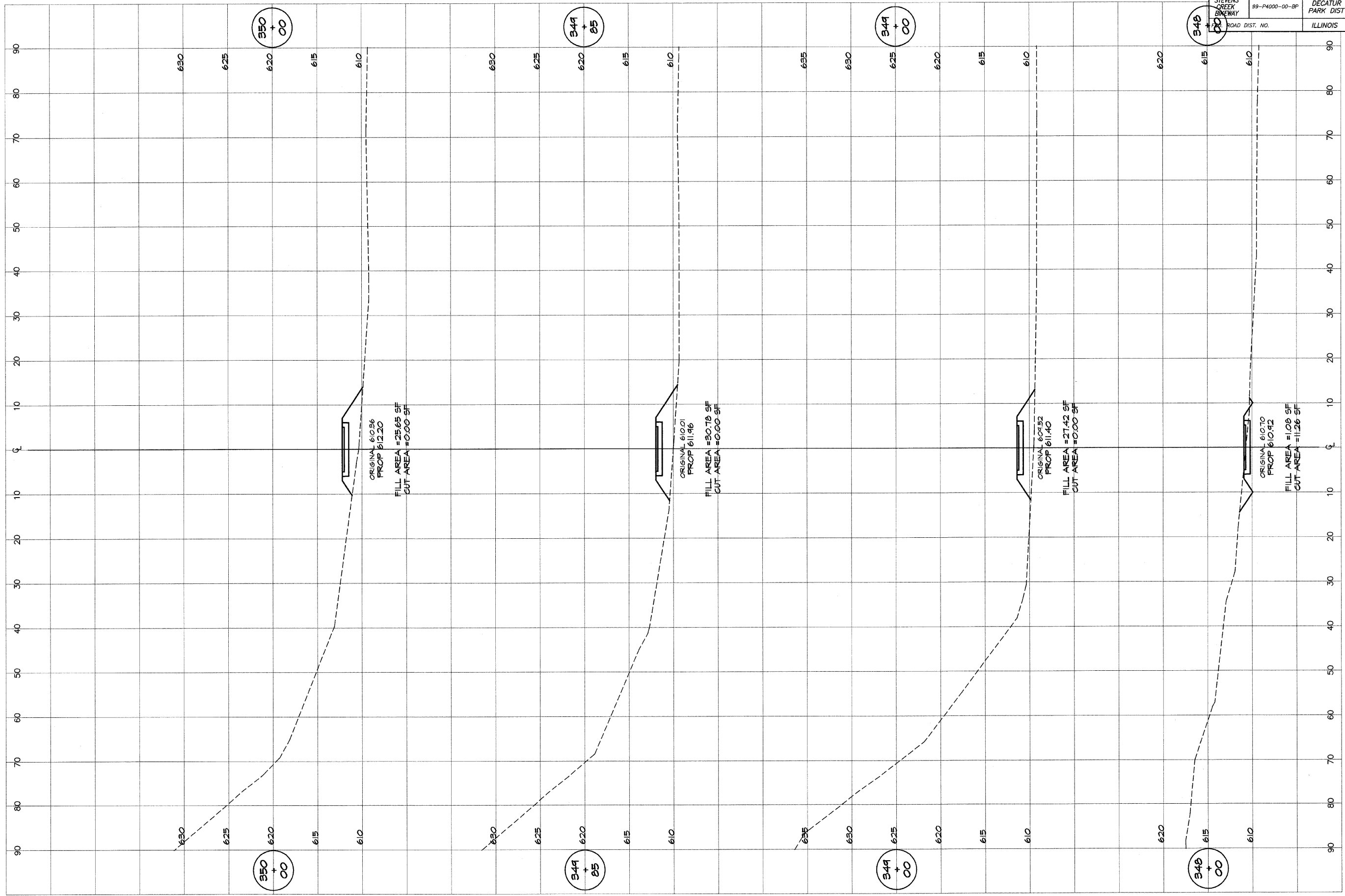

BAINBRIDGE & ASSOCIATES, INC.
Consulting Engineers
GEB MILANSKI
 100 S. FULTON ST., SUITE 1000
 DECATUR, ILLINOIS 62521
 PHONE: 312-401-1288

REVISIONS	NO.	BY	DATE
SCALE	as noted		
DATE	Jan 2004		
JOB NO.	99099		
FIELD BOOK	XXX		

DECATUR PARK DISTRICT
 STEVENS CREEK BIKEWAY - PHASE I
 CROSS SECTIONS
 CENTER TO SUMMIT