

ROUTE NO.	SECTION	CITY	TOTAL SHEETS	SHEET NO.
STEVENS CREEK BIKEWAY	99-P4000-00-BP	DECATUR PARK DIST	145	106
FED. ROAD DIST. NO.	ILLINOIS		PROJECT TE-0007(27)	

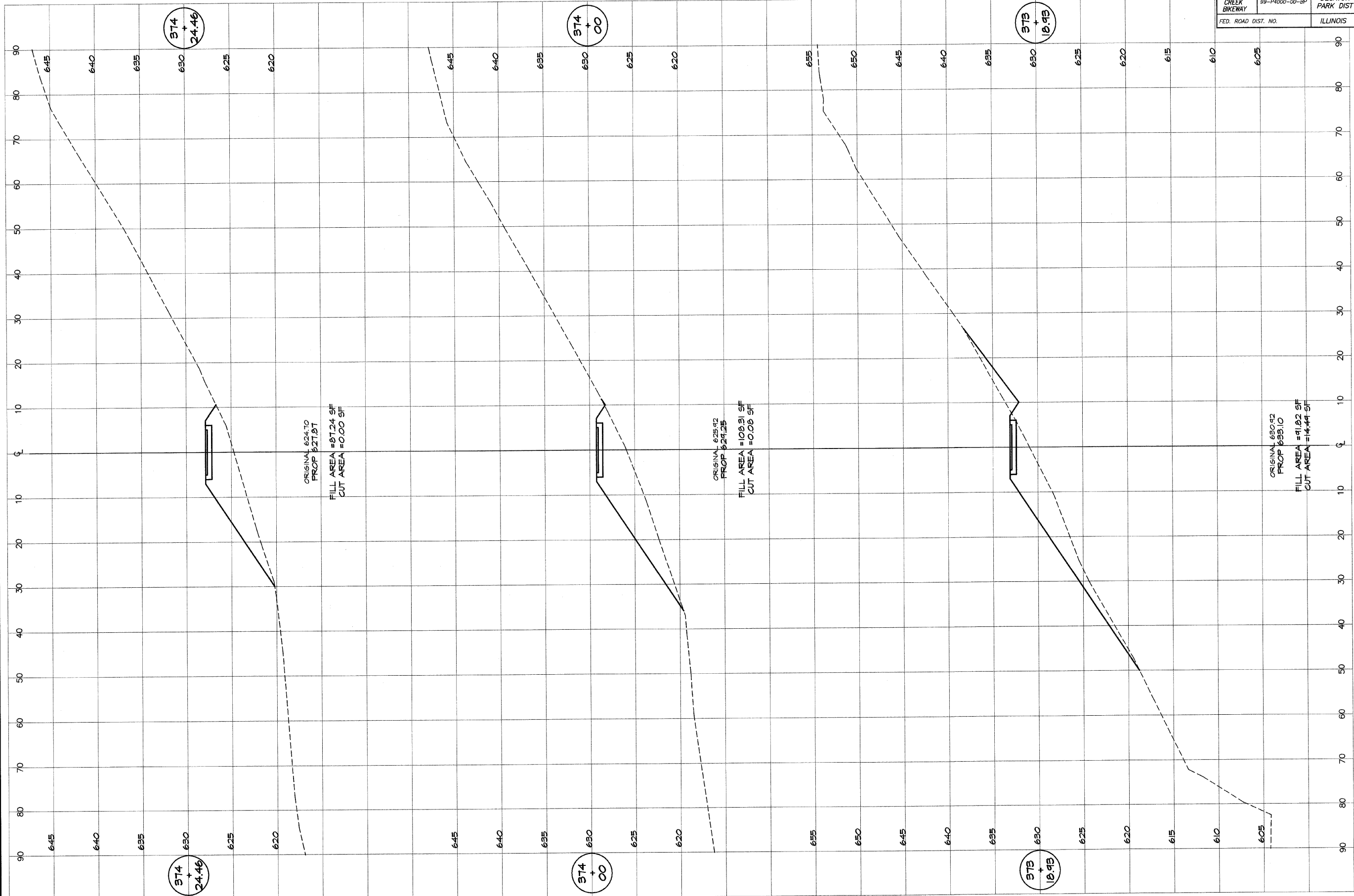

**BAINBRIDGE & ASSOCIATES, INC.**  
**GEB MILANSKI**  
 Consulting Engineers  
 807 SOUTH TAYLORVILLE ROAD  
 DECATUR, ILLINOIS  
 Phone License 184-07258

DESIGNED	SCALE	REVISIONS
MHP	as noted	NO. BY DATE
PNL	Jan 2004	
FIELD BOOK	JOB NO.	
XXX	99079	

**DECATUR PARK DISTRICT**  
 STEVENS CREEK BIKEWAY - PHASE I  
 CROSS SECTIONS  
 CENTER TO SUMMIT