

STATE OF ILLINOIS
DEPARTMENT OF TRANSPORTATION
DIVISION OF HIGHWAYS
PLANS FOR PROPOSED
SURFACE TRANSPORTATION RURAL PROJECT
AND TARP PROJECT
CRAWFORD COUNTY
SECTION 05-00089-00-RS
FAS 695 (CH 2)
PROJECT RS-695(105)
JOB NO. C-97-085-09

INDEX OF SHEETS

- 1 COVER SHEET
- 2 SUMMARY OF QUANTITIES & TYPICAL SECTIONS

STANDARDS:

442201-03	CLASS D PATCHES
701006-03	TRAFFIC CONTROL
701306-02	TRAFFIC CONTROL
701311-03	TRAFFIC CONTROL
701301-03	TRAFFIC CONTROL
701336-05	TRAFFIC CONTROL
701901-01	TRAFFIC CONTROL DEVICES
780001-02	PAVEMENT MARKINGS

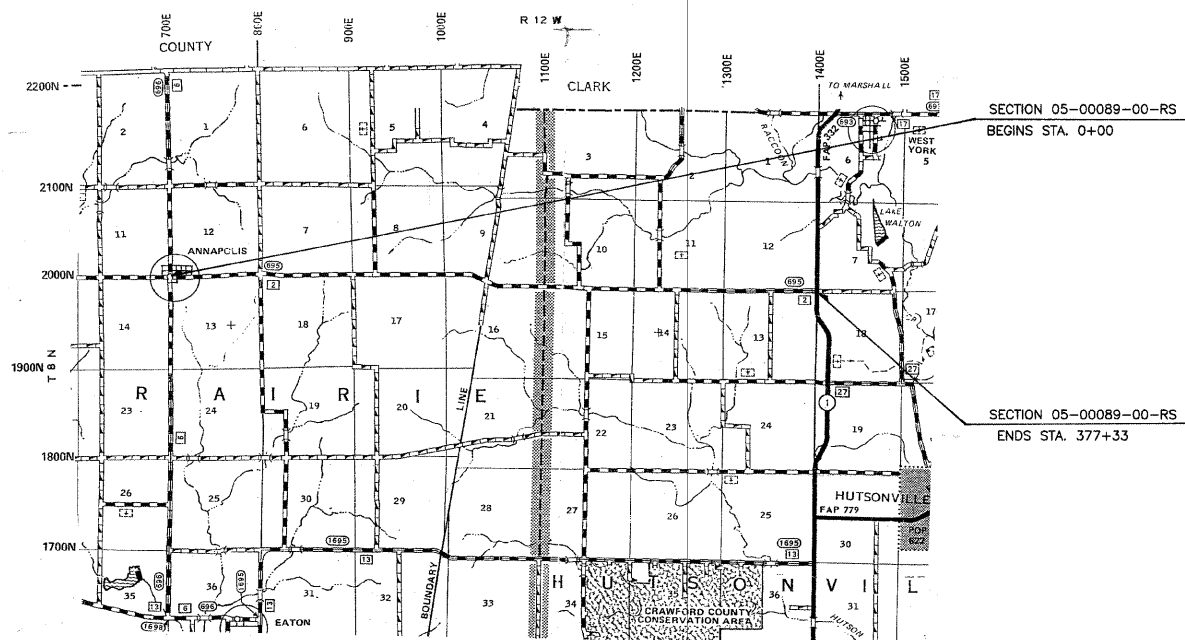

FUNCTIONAL CLASS - RURAL MAJOR COLLECTOR

ADT = 600
DESIGN SPEED = 50 MPH

LOCATION MAP
APPROXIMATE SCALE: 1 INCH = 1 MILE
NET LENGTH = 37,733 FEET = 7.146 MILES

TOLL FREE JOINT UTILITY LOCATING
INFORMATION FOR EXCAVATORS (J.U.L.I.E.)
TELEPHONE NO. 1-800-892-0123

CONNOR & CONNOR, INC.
PROFESSIONAL DESIGN FIRM #184-000832

John A. Stone
ILLINOIS REGISTERED PROFESSIONAL ENGINEER # 55012
LICENSE EXPIRES NOVEMBER 30, 2009
03/18/09

ILLINOIS DEPARTMENT OF TRANSPORTATION
APPROVED: <i>March 19</i> . . . 2009 <i>Robert R. Child</i> LOCAL AGENCY REPRESENTATIVE, COUNTY ENGINEER
PASSED: <i>4-2</i> 2009 <i>Murphy R. Ravel</i> DISTRICT SEVEN ENGINEER OF LOCAL ROADS & STREETS
RELEASING FOR BID BASED ON LIMITED REVIEW <i>4-2</i> . . . 2009 <i>Robert L. Dinahoff</i> DEPUTY DIRECTOR OF HIGHWAYS, REGION FOUR ENGINEER