

STATE OF ILLINOIS
 DEPARTMENT OF TRANSPORTATION
 DIVISION OF HIGHWAYS
 PLANS FOR PROPOSED
 SURFACE TRANSPORTATION RURAL PROJECT
 AND TARP PROJECT
 CRAWFORD COUNTY
 SECTION 05-00089-00-RS
 FAS 695 (CH 2)
 PROJECT RS-695(105)
 JOB NO. C-97-085-09

INDEX OF SHEETS

- 1 COVER SHEET
- 2 SUMMARY OF QUANTITIES & TYPICAL SECTIONS

STANDARDS:

442201-03	CLASS D PATCHES
701006-03	TRAFFIC CONTROL
701306-02	TRAFFIC CONTROL
701311-03	TRAFFIC CONTROL
701301-03	TRAFFIC CONTROL
701336-05	TRAFFIC CONTROL
701901-01	TRAFFIC CONTROL DEVICES
780001-02	PAVEMENT MARKINGS

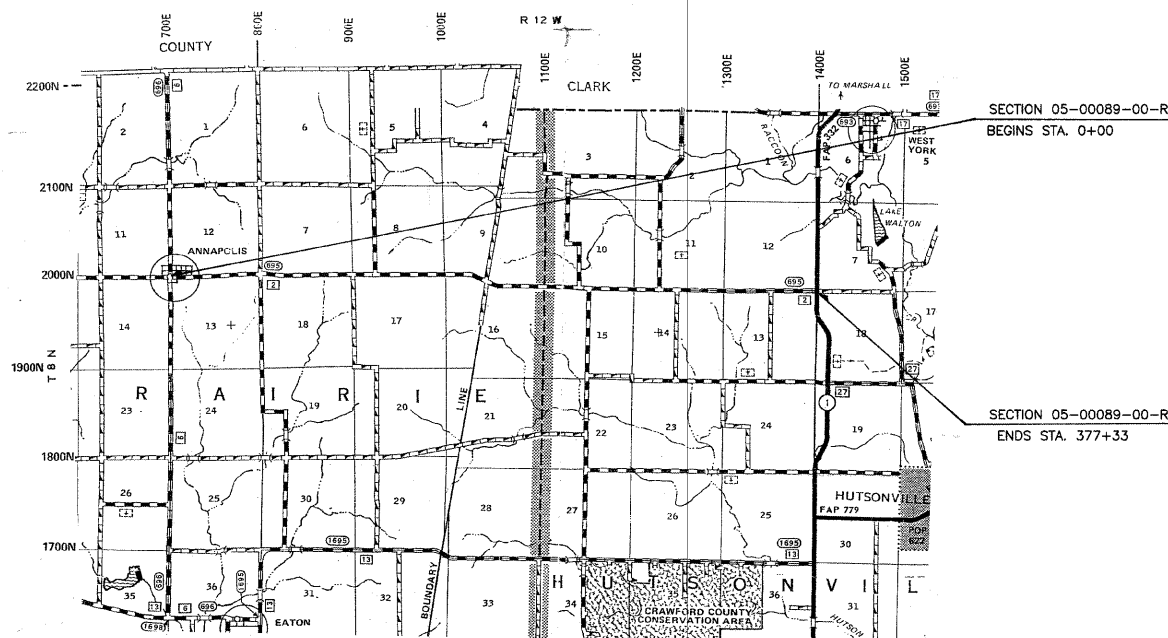

FUNCTIONAL CLASS - RURAL MAJOR COLLECTOR

ADT = 600
 DESIGN SPEED = 50 MPH

LOCATION MAP
 APPROXIMATE SCALE: 1 INCH = 1 MILE
 NET LENGTH = 37,733 FEET = 7.146 MILES

TOLL FREE JOINT UTILITY LOCATING
 INFORMATION FOR EXCAVATORS (J.U.L.I.E.)
 TELEPHONE NO. 1-800-892-0123

CONNOR & CONNOR, INC.
 PROFESSIONAL DESIGN FIRM #184-000832

John A. Stone
 ILLINOIS REGISTERED PROFESSIONAL ENGINEER # 55012
 LICENSE EXPIRES NOVEMBER 30, 2009
 03/18/09

ILLINOIS DEPARTMENT OF TRANSPORTATION
APPROVED: <i>March 19</i> 2009 <i>Robert R. Child</i> LOCAL AGENCY REPRESENTATIVE, COUNTY ENGINEER
PASSED: <i>4-2</i> 2009 <i>Murphy Ravel</i> DISTRICT SEVEN ENGINEER OF LOCAL ROADS & STREETS
RELEASING FOR BID BASED ON LIMITED REVIEW <i>4-2</i> 2009 <i>Robert L. Dinahoff</i> DEPUTY DIRECTOR OF HIGHWAYS, REGION FOUR ENGINEER

SECTION	05-00089-00-RS	TOTAL SHEETS	2
COUNTY	CRAWFORD	SHEET NO.	2
STA.	TO STA.		

CONTRACT NO. 95578

SUMMARY OF QUANTITIES

QTY.	UNIT	ITEM	CODE NO.
3,775	FOOT	SHORT-TERM PAVEMENT MARKING REMOVAL	XX003140
8,385	GALLON	BITUMINOUS MATERIALS (PRIME COAT)	40600100
168	TON	AGGREGATE (PRIME COAT)	40600300
10,379	TON	HOT MIX ASPHALT BINDER COURSE, IL-19.0, N70	40603085
7,350	TON	HOT MIX ASPHALT SURFACE COURSE, MIX "C", N70	40603315
25	SQ YD	CLASS D PATCHES, TYPE I, 11 INCH	44201773
25	SQ YD	CLASS D PATCHES, TYPE II, 11 INCH	44201777
25	SQ YD	CLASS D PATCHES, TYPE III, 11 INCH	44201781
4,147	TON	AGGREGATE SHOULDERS, TYPE B	48101200
3	CAL MO	ENGINEER'S FIELD OFFICE, TYPE B	67000500
1	L SUM	MOBILIZATION	67100100
1	L SUM	TRAFFIC CONTROL AND PROTECTION, STANDARD 701306	70100460
1	L SUM	TRAFFIC CONTROL AND PROTECTION, STANDARD 701336	70100600
1	L SUM	TRAFFIC CONTROL AND PROTECTION	70101700
6,712	FOOT	SHORT-TERM PAVEMENT MARKING	70300100
22.24	SQ FT	SIGN PANEL - TYPE I	72000100
112	FOOT	METAL POST - TYPE A	72900100
89,406	FOOT	PAINT PAVEMENT MARKING-LINE 4"	78001110

* SPECIALTY ITEMS

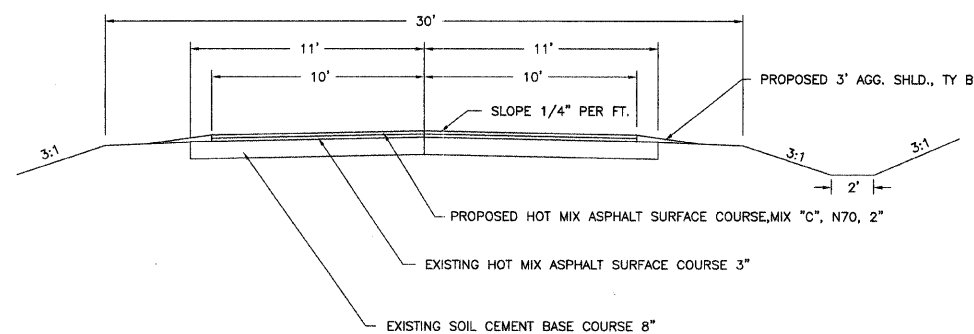

TYPICAL SECTION OF EXISTING AND PROPOSED ROAD

STA. 0+00 TO STA. 16+35

PAVEMENT DESIGN DATA

2028 ADT = 750, P = 605, SU = 55, MU = 15, CLASS III ROAD (80,000 LB. DESIGN) IFR = 3.0, SNF = 3.0
 PAVEMENT STRUCTURE MATERIALS: EXISTING SOIL-CEMENT BASE 8" = 0.17 x 8 = 1.36
 EXISTING CLASS I BIT. BINDER & SURFACE 3" = 0.30 x 3 = 0.9
 PROPOSED HMA SURFACE COURSE 2" = 0.40 x 2 = 0.8
 TOTAL = 3.06

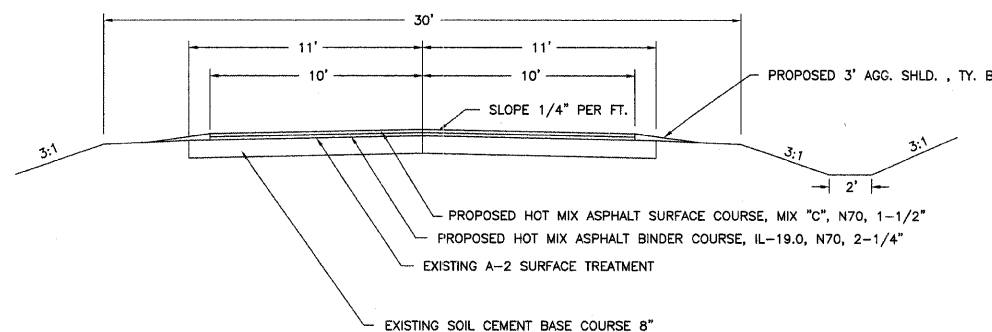

TYPICAL SECTION OF EXISTING AND PROPOSED ROAD

STA. 16+35 TO STA. 298+35

PAVEMENT DESIGN DATA

2028 ADT = 750, P = 605, SU = 55, MU = 15, CLASS III ROAD (80,000 LB. DESIGN) IFR = 3.0, SNF = 3.0
 PAVEMENT STRUCTURE MATERIALS: EXISTING SOIL-CEMENT BASE 8" = 0.17 x 8 = 1.36
 EXISTING SEAL COAT BUILD-UP = 0.20
 PROPOSED HMA SURFACE COURSE 1.50" & HMA BINDER COURSE 2.25" = 0.40 x 3.75 = 1.50
 TOTAL = 3.06

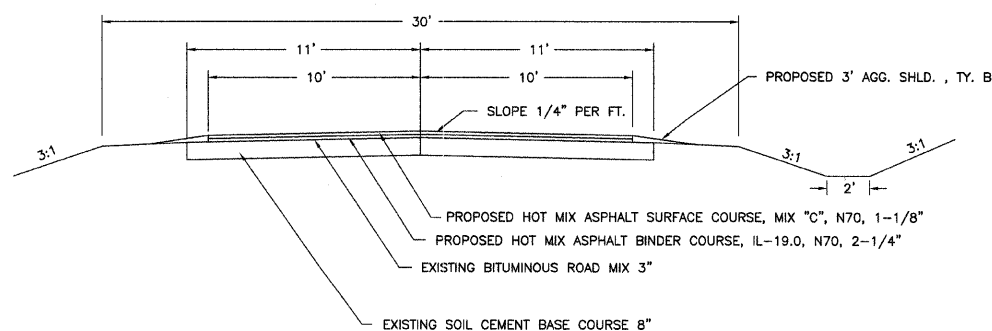

TYPICAL SECTION OF EXISTING AND PROPOSED ROAD

STA. 298+35 TO STA. 377+33

PAVEMENT DESIGN DATA

2028 ADT = 750, P = 605, SU = 55, MU = 15, CLASS III ROAD (80,000 LB. DESIGN) IFR = 3.0, SNF = 3.0
 PAVEMENT STRUCTURE MATERIALS: EXISTING SOIL-CEMENT BASE 8" = 0.17 x 8 = 1.36
 EXISTING BITUMINOUS ROAD MIX = 0.15 x 3 = 0.45
 PROPOSED HMA SURFACE COURSE 1.125" & HMA BINDER COURSE 2.25" = 0.40 x 3.375 = 1.35
 TOTAL = 3.16

NO PASSING ZONE SIGNS (W 14 - 3)

STA.	SIGN PANEL TY 1	METAL POSTS TY A
LT. 61+00	1 @ 5.56 SQ. FT.	2 EACH @ 14 FT. = 28 FT.
RT. 69+00	1 @ 5.56 SQ. FT.	2 EACH @ 14 FT. = 28 FT.
LT. 175+00	1 @ 5.56 SQ. FT.	2 EACH @ 14 FT. = 28 FT.
RT. 183+00	1 @ 5.56 SQ. FT.	2 EACH @ 14 FT. = 28 FT.
TOTALS =	22.24 SQ. FT.	112 FT.

PAINT PAVEMENT MARKING LINE 4" (TOTAL = 89,406 FT.)

CENTERLINE STRIPE

STA. 0+00 TO STA. 377+33 = 9,140 FT.

EDGE LINE

STA. 0+00 TO STA. 377+33 = 75,466 FT.

NO PASSING ZONE

LEFT SIDE (WEST BOUND)

STA. 65+00 TO STA. 69+00 = 400'
 STA. 163+00 TO STA. 183+00 = 2,000'

RIGHT SIDE (EAST BOUND)

STA. 57+00 TO STA. 61+00 = 400'
 STA. 155+00 TO STA. 175+00 = 2,000'

TOTAL = 4,800 FT.

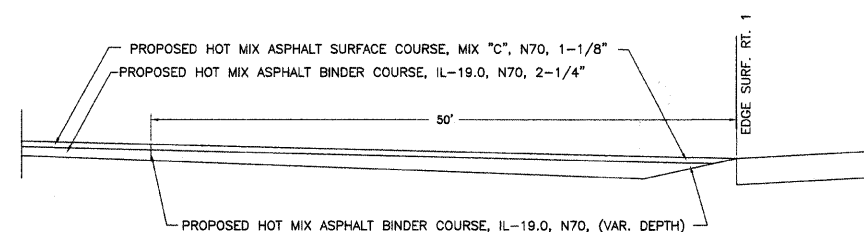

DETAIL OF RESURFACING AT IL RT 1

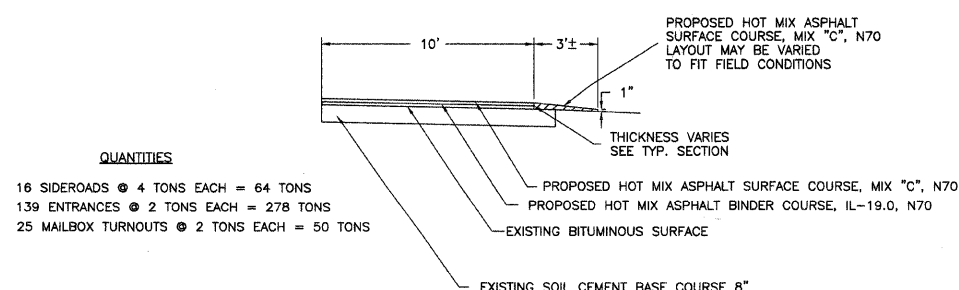

QUANTITIES

16 SIDEROADS @ 4 TONS EACH = 64 TONS
 139 ENTRANCES @ 2 TONS EACH = 278 TONS
 25 MAILBOX TURNOUTS @ 2 TONS EACH = 50 TONS

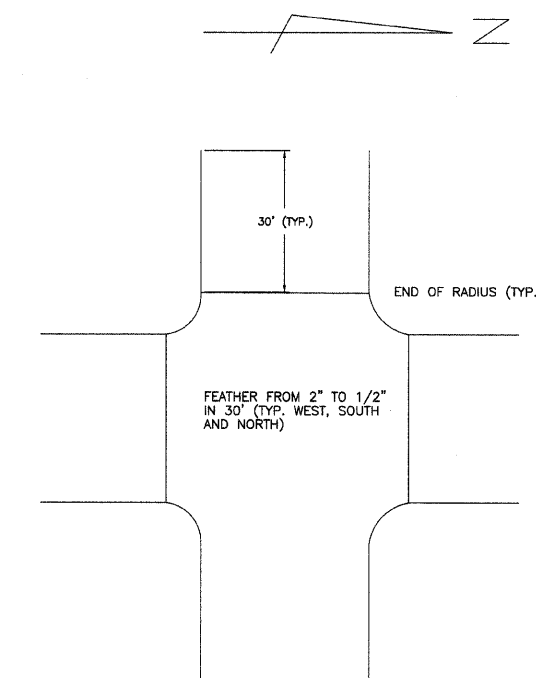

DETAIL OF RESURFACING AT STA. 0+00

DATE: 01/16/2008
 SCALE: AS SHOWN
 DRAWN BY: JLC
 PROJECT: P-1533



CONNOR & CONNOR, Inc.
CONSULTING ENGINEERS

209 North Cross Street
 ROBINSON, ILLINOIS 62454

Phone 618-544-9623
 Fax 618-544-3012

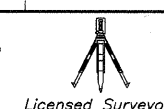

**TYPICAL SECTIONS
 & SUMMARY OF QUANTITIES
 SEC. 05-00089-00-RS
 CRAWFORD COUNTY**