

F. A. U. ROUTE	SECTION	COUNTY	TOTAL SHEETS	SHEET NUMBER
9732	00-00103-00-FP	JACKSON	37	8
CITY OF CARBONDALE		PROJECT NO. M-5008(19)		
CONTRACT NO. 99182		JOB NO. C99-504-03		
FEDERAL AID PROJECT				

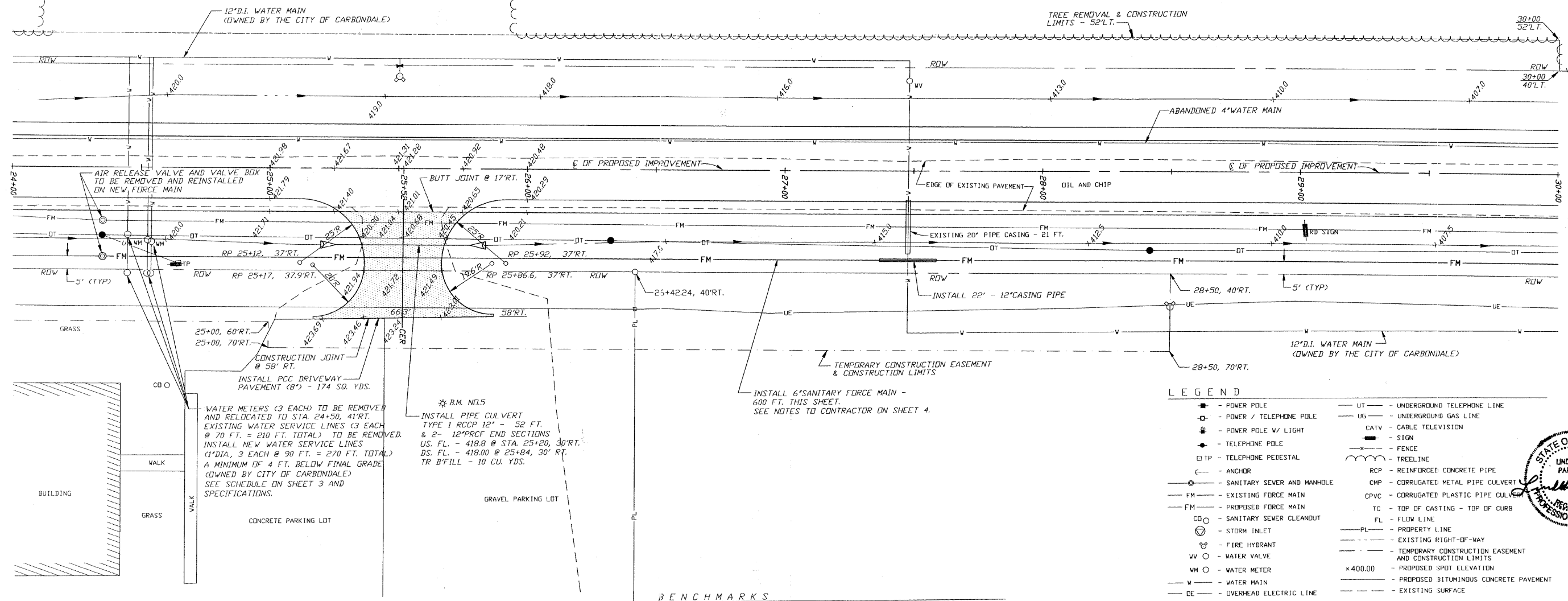
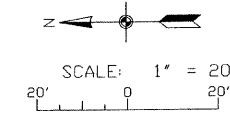

WATER METERS (3 EACH) TO BE REMOVED AND RELOCATED TO STA. 24+50, 41' RT. EXISTING WATER SERVICE LINES (3 EACH @ 70 FT. TOTAL) TO BE REMOVED. INSTALL NEW WATER SERVICE LINES (1" DIA., 3 EACH @ 90 FT. = 270 FT. TOTAL) A MINIMUM OF 4 FT. BELOW FINAL GRADE (OWNED BY CITY OF CARBONDALE) SEE SCHEDULE ON SHEET 3 AND SPECIFICATIONS.

* B.M. NO. 5
INSTALL PIPE CULVERT TYPE 1 RCP 12" - 52 FT. & 2" 12" RCP END SECTIONS US. FL. - 418.8 @ STA. 25+20, 30' RT. DS. FL. - 418.0 @ 25+84, 30' RT. TR B'FILL - 10 CU. YDS.

INSTALL 6" SANITARY FORCE MAIN - 600 FT. THIS SHEET. SEE NOTES TO CONTRACTOR ON SHEET 4.

LEGEND

- P — POWER POLE
- T — TELEPHONE POLE
- P/L — POWER POLE W/ LIGHT
- T/P — TELEPHONE POLE
- T/P — TELEPHONE PEDESTAL
- A — ANCHOR
- S — SANITARY SEWER AND MANHOLE
- FM — EXISTING FORCE MAIN
- FM — PROPOSED FORCE MAIN
- CO — SANITARY SEWER CLEAOUT
- S/I — STORM INLET
- F/H — FIRE HYDRANT
- W/V — WATER VALVE
- W/M — WATER METER
- W — WATER MAIN
- DE — OVERHEAD ELECTRIC LINE
- UE — UNDERGROUND ELECTRIC LINE
- DT — OVERHEAD TELEPHONE LINE
- UT — UNDERGROUND TELEPHONE LINE
- UG — UNDERGROUND GAS LINE
- CATV — CABLE TELEVISION
- S — SIGN
- F — FENCE
- T — TREE LINE
- RCP — REINFORCED CONCRETE PIPE
- CMP — CORRUGATED METAL PIPE CULVERT
- CPVC — CORRUGATED PLASTIC PIPE CULVERT
- TC — TOP OF CASTING - TOP OF CURB
- FL — FLOW LINE
- PL — PROPERTY LINE
- — — — — EXISTING RIGHT-OF-WAY
- — — — — TEMPORARY CONSTRUCTION EASEMENT AND CONSTRUCTION LIMITS
- x400.00 — PROPOSED SPOT ELEVATION
- — — — — PROPOSED BITUMINOUS CONCRETE PAVEMENT
- — — — — EXISTING SURFACE

BENCHMARKS
B.M. NO. 5 - "CUT ON EAST SIDE OF CONCRETE BASE TO LIGHT POLE AT STA. 25+70, 90' RT. (ELEV. = 426.15)

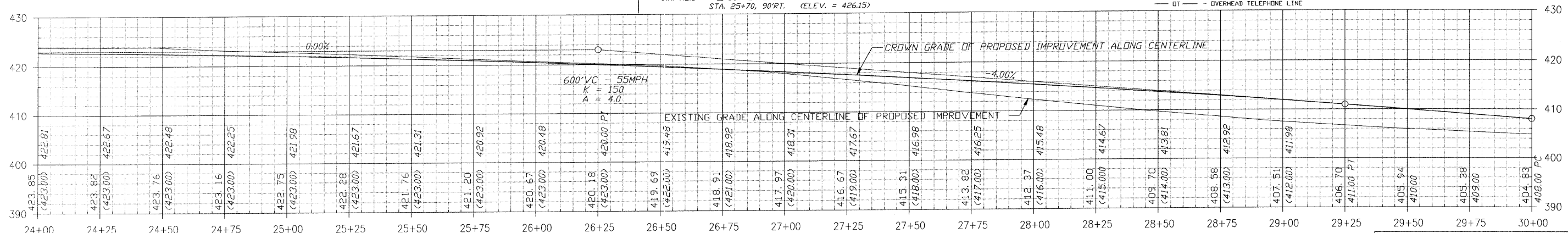

CIP NO. ST0102 - REED STATION ROAD
PLAN AND PROFILE
STA. 24+00 TO STA. 30+00