

**GENERAL NOTES:**

THIS SECTION SHALL BE CONSTRUCTED IN ACCORDANCE WITH THE PLANS, SPECIAL PROVISIONS AND "STANDARD SPECIFICATIONS FOR ROAD AND BRIDGE CONSTRUCTION", ADOPTED JANUARY 1, 2007.

THE WORK INVOLVED ON THIS SECTION CONSISTS OF THE REMOVAL OF THE EXISTING STRUCTURE, THE CONSTRUCTION OF A 55 FOOT LONG SINGLE SPAN PRECAST, PRESTRESSED CONCRETE DECK BEAM BRIDGE, EARTH APPROACHES, AGGREGATE SURFACE COURSE AND OTHER MISCELLANEOUS ITEMS NECESSARY TO COMPLETE THIS SECTION.

ALL ELEVATIONS ARE BASED ON U.S.G.S. MEAN SEA LEVEL DATUM.

IT SHALL BE THE CONTRACTOR'S RESPONSIBILITY TO CONTACT ALL THE UTILITIES, AFFECTING THE PROJECT, PRIOR TO CONSTRUCTION.

THE I-BEAMS SHALL BE REMOVED WITH MINIMUM DAMAGE AND STORED ALONG THE RIGHT-OF-WAY AS DIRECTED BY THE ENGINEER FOR THE COUNTY'S USE.

NOTE: CONSTRUCTION TRANSITIONS  
 STA. 2+50 TO STA 3+00  
 STA 7+00 TO STA 7+50  
 ALL QUANTITIES ARE INCLUDED IN THE PROPOSAL

CURVE #1  
 P.I. STA= 2+40  
 Δ= LT. 138'02"  
 D= 125.57'  
 R= 4000'  
 T= 57.04'  
 L= 114.08'  
 E= 0.41'  
 e= NONE  
 T.R.= NONE  
 S.E. RUN= NONE  
 P.C. STA= 1+82.96  
 P.T. STA= 2+97.03

CURVE #2  
 P.I. STA= 6+20  
 Δ= RT. 318'57"  
 D= 154'35'  
 R= 3000'  
 T= 86.83'  
 L= 173.62'  
 E= 1.26'  
 e= NONE  
 T.R.= NONE  
 S.E. RUN= NONE  
 P.C. STA= 5+33.16  
 P.T. STA= 7+06.78

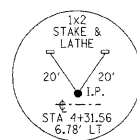
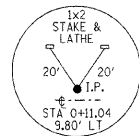

**TYPICAL CROSS SECTION PROPOSED**

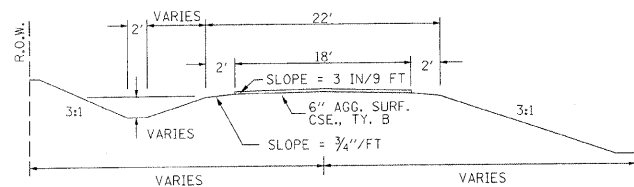

**TYPICAL CROSS SECTION EXISTING**

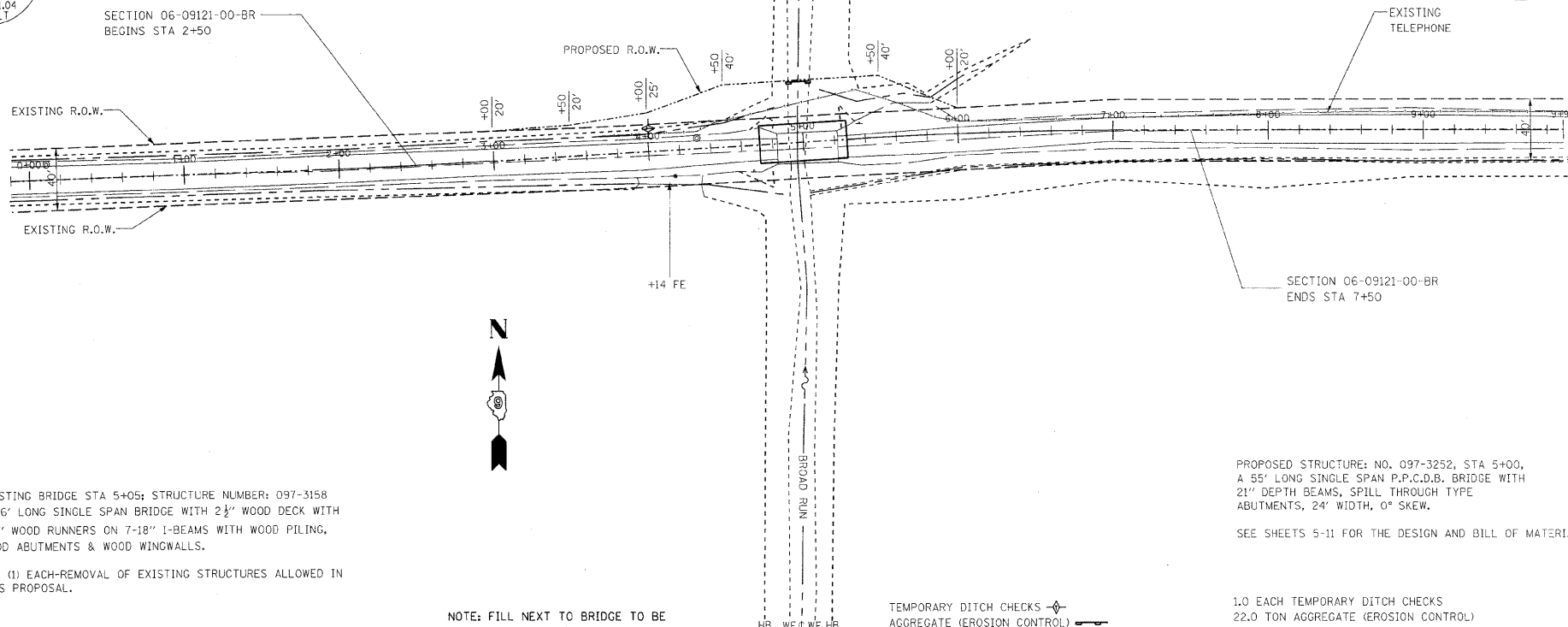
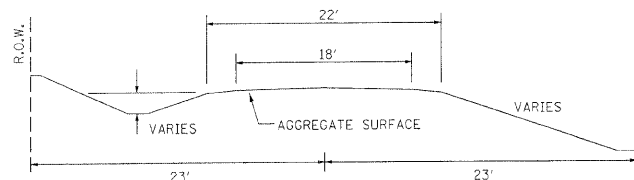

UTILITIES:  
 J.U.L.I.E. 1-800-892-0123

VERIZON  
 1-618-395-6191

EXISTING BRIDGE STA 5+05: STRUCTURE NUMBER: 097-3158  
 A 36' LONG SINGLE SPAN BRIDGE WITH 2 1/2" WOOD DECK WITH 2 1/2" WOOD RUNNERS ON 7-18" I-BEAMS WITH WOOD PILING, WOOD ABUTMENTS & WOOD WINGWALLS.

ONE (1) EACH-REMOVAL OF EXISTING STRUCTURES ALLOWED IN THIS PROPOSAL.

PROPOSED STRUCTURE: NO. 097-3252, STA 5+00, A 55' LONG SINGLE SPAN P.P.C.D.B. BRIDGE WITH 21" DEPTH BEAMS, SPILL THROUGH TYPE ABUTMENTS, 24" WIDTH, 0° SKEW.

SEE SHEETS 5-11 FOR THE DESIGN AND BILL OF MATERIALS.

**FIELD ENTRANCE DETAIL**

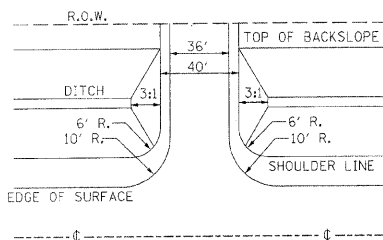

NOTE: CONSTRUCT SPECIAL DITCH

STA 2+50 TO STA 4+74.7 LT  
 STA 5+18.9 TO STA 5+50 LT

NOTE: CONSTRUCT STONE RIPRAP DITCH

STA 4+50 TO STA 4+74.7 LT (0.62 TON/LIN FT)  
 STA 5+18.9 TO STA 5+50 LT (0.62 TON/LIN FT)  
 35 TON STONE RIPRAP DITCH ALLOWED IN PROPOSAL.

SEE STONE RIPRAP DITCH DETAIL.

**STONE RIPRAP DITCH DESIGN**

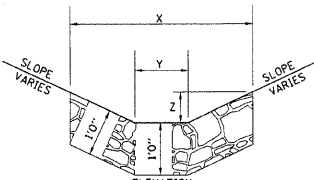
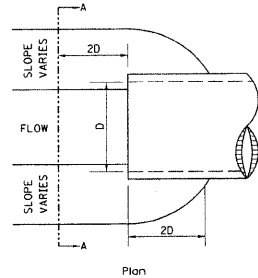

NOTE:

BOTTOM OF DITCH	SLOPE		
2 FT	1 1/2:1	2:1	3:1
X= 5 FT	6 FT	8 FT	
Y= 2 FT	2 FT	2 FT	
Z= 1 FT	1 FT	1 FT	
	0.40	0.48	0.62 TON/LIN. FT

NOTE: FOR PLACEMENT, QUALITY GRADATION AND OTHER MISCELLANEOUS REQUIREMENTS FOR STONE RIPRAP DITCH-SEE SPECIAL PROVISIONS.

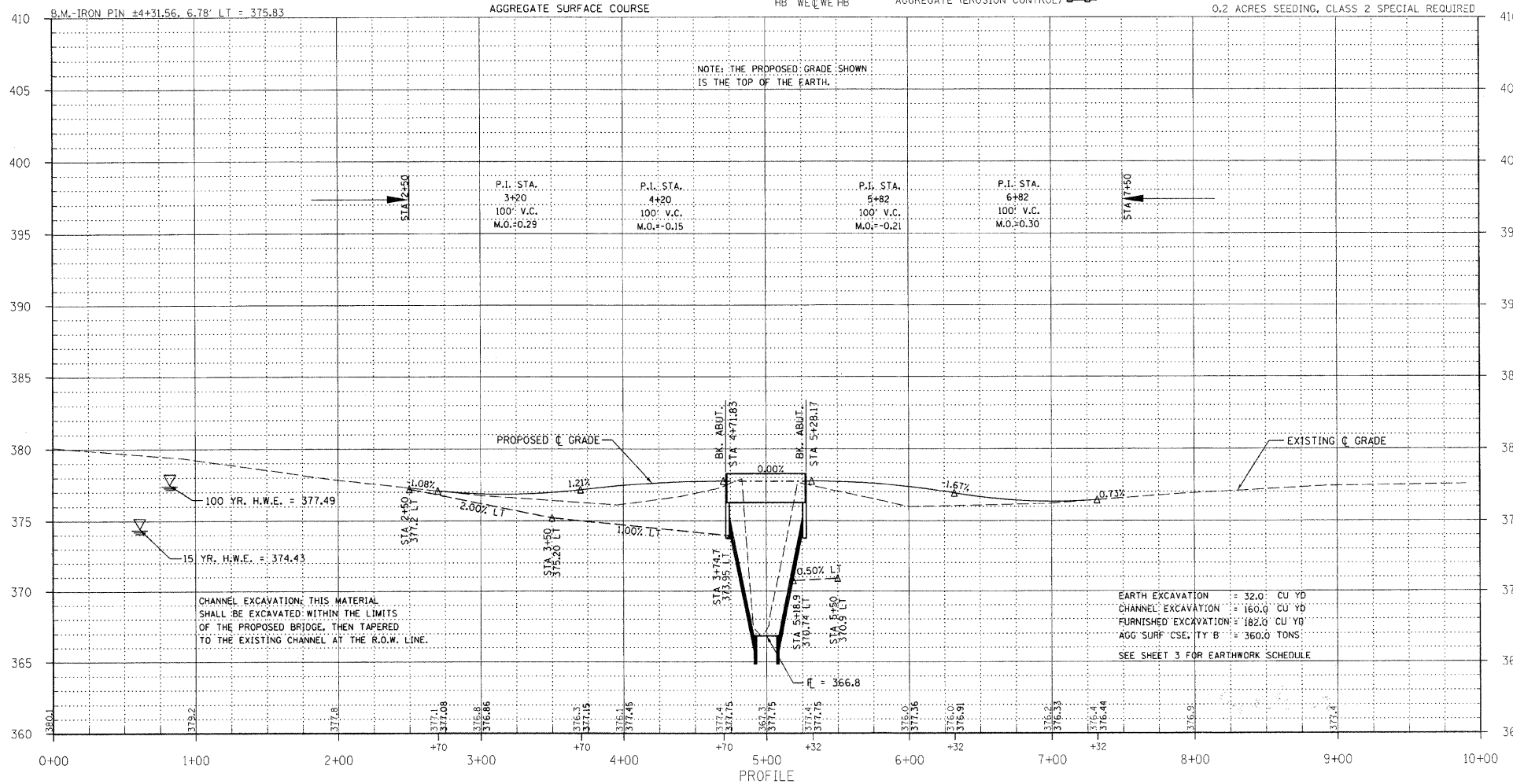

TR	SECTION	COUNTY	TOTAL SHEETS	SHEET NO.
125	06-09121-00-BR	WHITE	13	2

FED. ROAD DIST. NO. 9 ILLINOIS BROAD RUN  
 PROJECT # BROS-193271 CONTRACT # 99371  
 LEC JOB # H08R0102WH

323 W. 3RD ST.  
 P.O. BOX 160  
 MT. CARMEL, IL  
 62863  
 PHONE: (618)-262-8651  
 FAX: (618)-263-3327

405 W. STATE ST.  
 SUITE 100  
 PRINCETON, IN  
 47670  
 PHONE: (812)-386-7611  
 FAX: (812)-385-2812

**LAMAC ENGINEERING CO.**

PROFESSIONAL DESIGN FIRM  
 LAND SURVEY & PROFESSIONAL ENGINEERING CORPORATION  
 184-000887  
 (62-032435)(35-002769)

AARON M. MEFFORD  
 REGISTERED PROFESSIONAL ENGINEER OF ILLINOIS  
 5 2 8 4  
 3-10-09  
 DATE  
 11-30-09  
 EXPIRES

TOWNSHIP ROUTE 125  
 OVER BROAD RUN  
 WHITE COUNTY, ILLINOIS

SHEET TITLE:  
 PLAN & PROFILE

SCALE: VARIES  
 BY: AMM  
 DATE: 9/6/09  
 REV:

2 OF 13 SHEETS  
 SHEET NO. 2