

CONSTRUCTION PROCEDURE NOTES

1. ALL CONTRACTOR EMPLOYEES WILL PARK THEIR PERSONAL VEHICLES IN THE AREA DESIGNATED BY THE AIRPORT MANAGER FOR USE AS A VEHICLE PARKING AREA. THE CONTRACTOR WILL BE RESPONSIBLE FOR TRANSPORTING EMPLOYEES TO THE PROPOSED CONSTRUCTION SITE. ONLY AUTHORIZED CONTRACTOR VEHICLES WILL BE ALLOWED ON THE AIR OPERATIONS AREA OF THE AIRPORT AND ON THE CONSTRUCTION SITE.
2. FLAGS WILL BE REQUIRED ON ALL CONTRACTOR'S VEHICLES AND EQUIPMENT USED ON THE AIRPORT OPERATIONS AREA AND CONSTRUCTION SITE. THE FLAGS SHALL BE THREE (3) FOOT SQUARE CHECKERED FLAGS (INTERNATIONAL ORANGE AND WHITE) DISPLAYED IN FULL VIEW ABOVE THE VEHICLE.
3. THE CONTRACTOR SHALL REMOVE A SECTION OF FENCE TO GAIN ACCESS TO THE AIRPORT PROPERTY FOR THE HAUL ROAD THAT HE IS TO PROVIDE FOR HAULING MATERIAL TO THE WORK SITE. HE SHALL INSTALL A TEMPORARY GATE IN THE OPENING AND CLOSE SAID GATE AT THE END OF EACH WORKING DAY TO MAINTAIN AIRPORT SECURITY. UPON COMPLETION OF THE PROJECT, THE CONTRACTOR SHALL RESTORE THE FENCE TO ITS ORIGINAL STATE. THIS WORK SHALL BE CONSIDERED INCIDENTAL TO THE CONTRACT.
4. THE CONTRACTOR WILL USE THE DESIGNATED HAUL ROUTE AND EQUIPMENT STORAGE AREA SHOWN ON THIS SHEET. IT WILL BE THE CONTRACTOR'S RESPONSIBILITY TO MAINTAIN THE DESIGNATED HAUL ROUTE AND EQUIPMENT STORAGE AREA FOR THE DURATION OF THE PROJECT. ANY DAMAGE TO EXISTING PAVEMENTS USED TO HAUL MATERIAL TO THE CONSTRUCTION SITE WILL BE REPAIRED BY THE CONTRACTOR AT HIS OWN EXPENSE TO THE SATISFACTION OF THE AIRPORT MANAGER AND THE RESIDENT ENGINEER.
5. THE CONTRACTOR SHALL FURNISH, MAINTAIN, AND REMOVE ALL BARRICADES REQUIRED TO DELINEATE THE WORK AREA AND KEEP AIRCRAFT FROM ENCROACHING INTO SAID WORK AREA. THIS REQUIREMENT SHALL BE CONSIDERED INCIDENTAL TO THE CONTRACT AND NO ADDITIONAL COMPENSATION WILL BE ALLOWED.
6. AT SUCH TIME AS WORK IS BEING PERFORMED WITHIN THE AREA 200' FROM THE RUNWAY 13-31 CENTERLINE ON THE CONNECTING TAXIWAYS, RUNWAY 13-31 SHALL BE CLOSED.
7. CONSTRUCTION ACTIVITY CONTROL AND OPERATION AREA PROTECTION SHALL BE ACCOMPLISHED IN ACCORDANCE WITH FAA ADVISORY CIRCULAR NO. 150/5370-2E.
8. BARRICADE TAXIWAY C3 AT THE APRON TO CLOSE TAXIWAYS C AND C3 TO TRAFFIC AND PERFORM THE WORK. BARRICADES SHALL ALSO BE PLACED ON CLOSED TAXIWAYS C AND C3 AT EXISTING RUNWAY 13-31 TO PREVENT AIRCRAFT FROM EXITING RUNWAY 13-31 AT THESE TAXIWAYS. AIRCRAFT SHALL USE TAXIWAYS A, C, C1 AND C2 FOR ACCESS TO RUNWAY 13-31.
9. THE MAXIMUM CONSTRUCTION EQUIPMENT HEIGHT UTILIZED ON THE AIRPORT FOR THIS PROJECT SHALL BE 25'.
10. THIS PROJECT CONSISTS OF WORK TO REHABILITATE TAXIWAYS C AND C3.
11. THIS PROJECT WILL DISTURB LESS THAN 1 ACRE OF TURFED LAND.

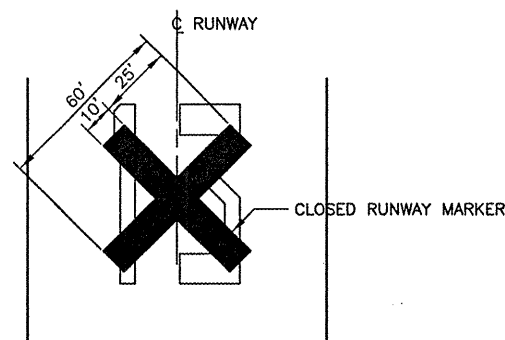

CLOSED RUNWAY MARKER DETAIL

1. CLOSED RUNWAY MARKER SHALL BE YELLOW IN COLOR.
2. CLOSED RUNWAY MARKER SHALL BE PAINTED PLYWOOD, PLASTIC SHEETING WEIGHTED DOWN WITH SANDBAGS, OR OTHER APPROVED MATERIALS ACCEPTABLE TO THE ENGINEER.
3. CONTRACTOR SHALL MAINTAIN MARKERS AS DIRECTED BY THE RESIDENT ENGINEER.
4. THE COST OF FURNISHING, PLACING, MAINTAINING, AND REMOVING CLOSED RUNWAY MARKERS SHALL BE PAID FOR UNDER ITEM AR150530 TRAFFIC MAINTENANCE.

LEGEND

- EXISTING BUILDING
- AIRPORT PROPERTY LINE
- REHABILITATE TAXIWAYS C AND C3
- LOCATION OF LIGHTED BARRICADES
- CP-1 CRITICAL POINT NO. 1

CRITICAL POINTS			
ALL POINTS ARE 200' FROM Q RUNWAY 13-31			
NO.	LATITUDE	LONGITUDE	ELEVATION
CP-1	39°46'16.35"	90°14'06.91"	622.1
CP-2	39°46'09.30"	90°13'57.83"	618.8

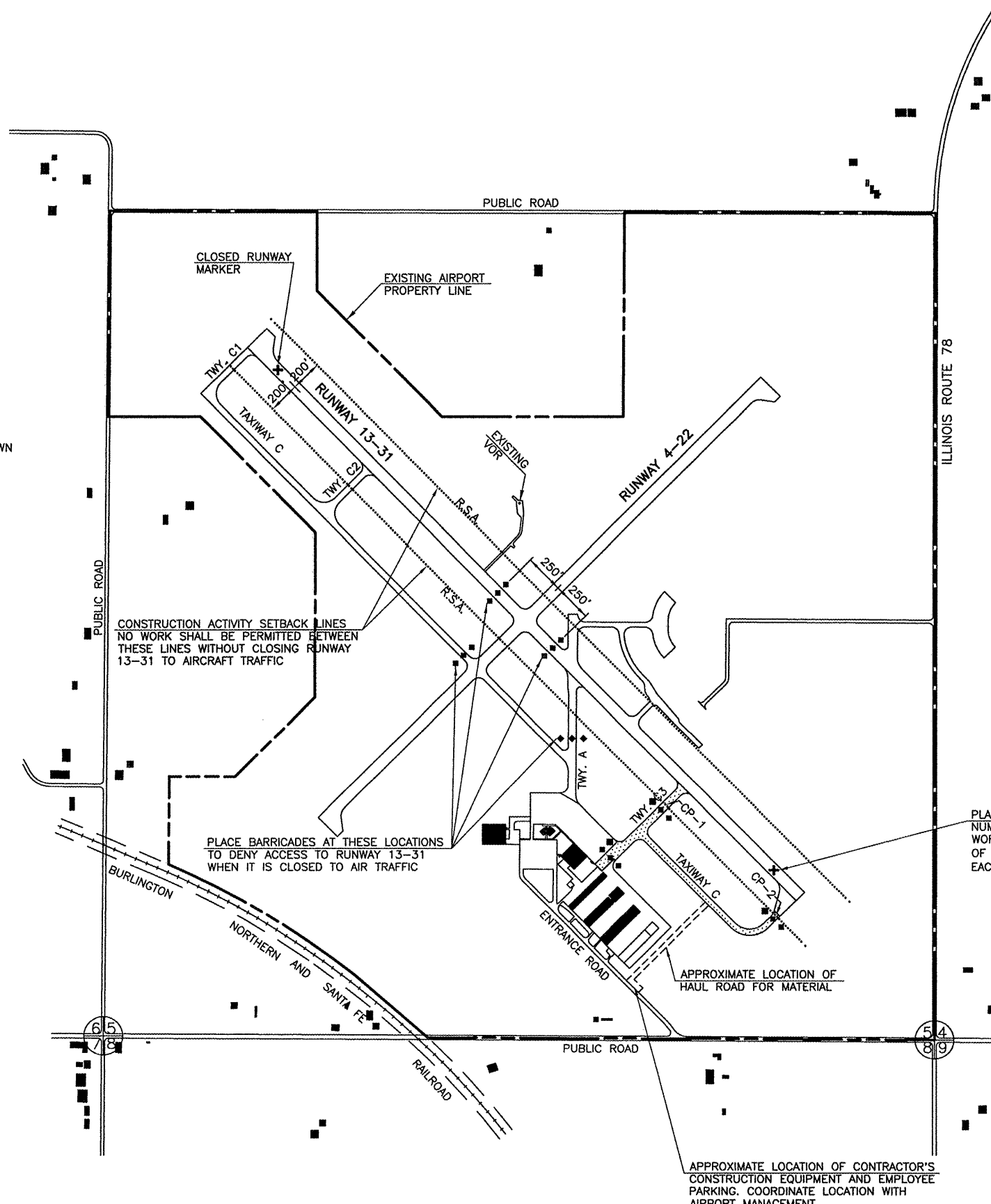

PLACE CLOSED RUNWAY MARKER OVER RUNWAY NUMERALS TO CLOSE RUNWAY 13-31 WHEN WORKING ON TAXIWAYS C AND C3 WITHIN 200' OF THE RUNWAY 13-31 CENTERLINE (TYPICAL EACH END OF RUNWAY)

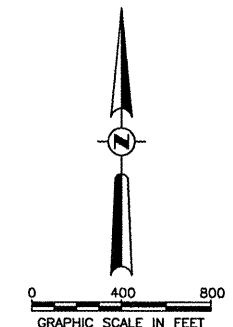

JACKSONVILLE MUNICIPAL AIRPORT JACKSONVILLE, ILLINOIS	
IMPROVEMENT AND SAFETY PLAN	
HUTCHISON ENGINEERING, INC. JACKSONVILLE, ILLINOIS	
DRAWN BY: R.L.R. DATE: APRIL, 2009	ILL. PROJ. NO. IJX-3903 AIP PROJ. NO. 3-17-0054-B15