

**LA038**  
 K:\Lansing\6\0529702\Draw\Sheets  
 FILE: 6-swppp.dwg  
 LAYOUT: Layout 1  
 UPDATE BY: Tony Marin  
 SURVEY BOOK #  
 DATE: Friday, February 27, 2009 2:53:25 PM  
 XREF DWG: Base-ty.dwg  
 tbcint.dwg  
 tb.dwg

REVISIONS		
NUMBER	BY	DATE

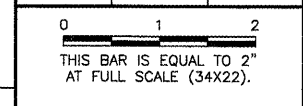

**LEGEND**

- NEW PAVEMENT
- NEW SEEDING (901) AND MULCHING (908)
- NEW EROSION CONTROL BLANKET (156) AND SEEDING (701)
- NEW SILT FENCE (156)
- NEW GRADING LIMITS
- NEW INLET PROTECTION (156)
- TEMPORARY DITCH CROSSING
- NEW DITCH CHECKS

SEED TABLE		
IDOT CLASS-TYPE	SEED MIXTURE	RATE (LB/ACRE)
1 (LAWN MIXTURE)	KENTUCKY BLUEGRASS PERENNIAL RYEGRASS CREEPING RED FESCUE	100 60 40
* 4A (LOW PROFILE NATIVE GRASS)	LITTLE BLUE STEM SIDE-OATS GRAMA WILD RYE PRAIRIE DROPSEED ANNUAL RYEGRASS OATS, SPRING PERENNIAL RYEGRASS	5 5 1 0.5 25 25 15

\* IDOT CLASS-4A SEED SHALL BE USED TO RESTORE ALL DISTURBED AREAS ALONG THE LANSING DRAINAGE DITCH BANKS. NO DIRECT PAYMENT SHALL BE MADE. COST SHALL BE INCIDENTAL TO RESPECTIVE PAY ITEM.

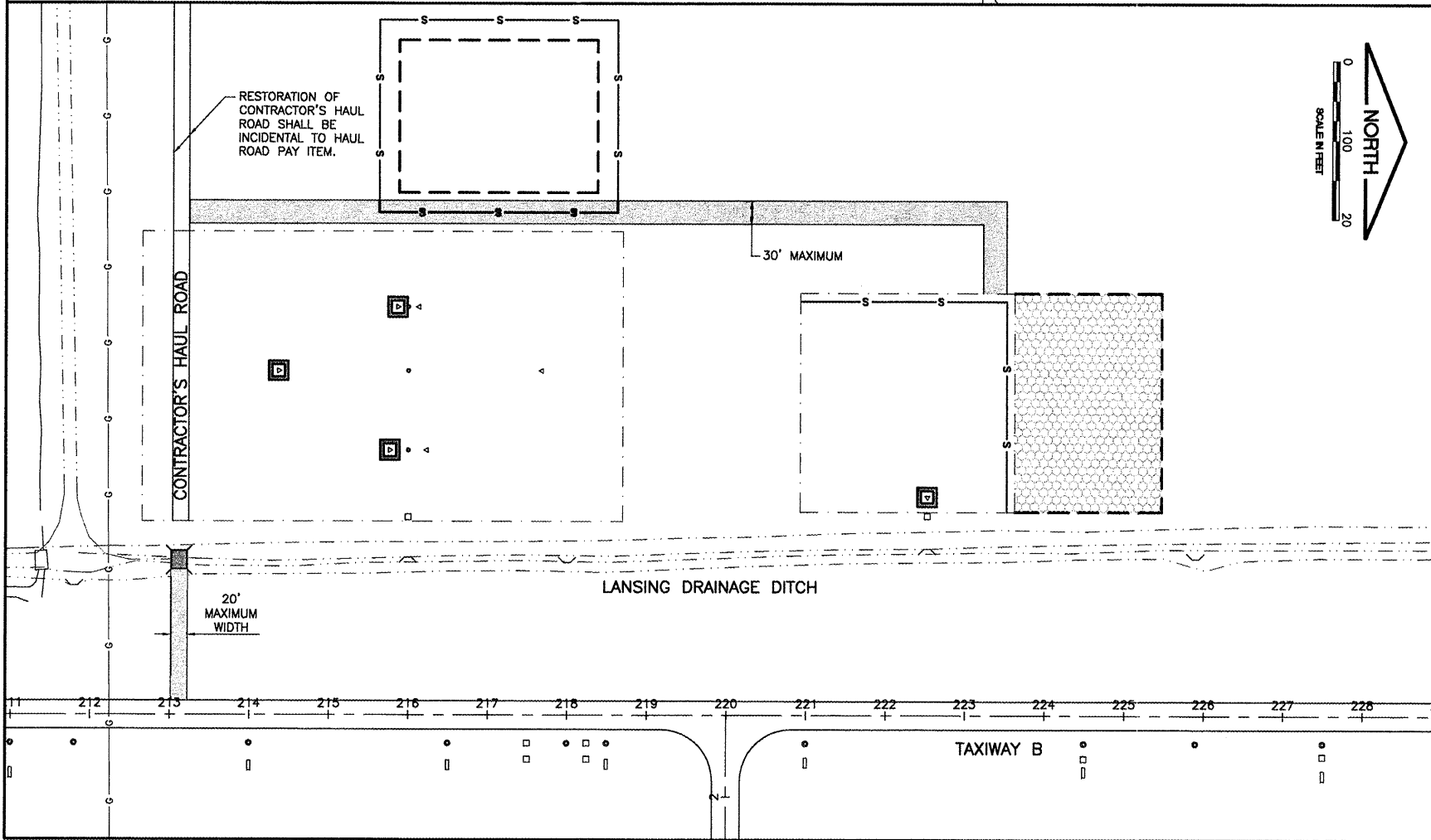

**NOTES**

- SILT FENCE SHALL BE PLACED AROUND ALL STORM SEWER INLETS AS DETAILED ON THE PLANS TO MINIMIZE SOIL INTRUSION INTO THE STORM SEWER SYSTEM (SEE DETAIL).
- THE CONTRACTOR SHALL BE REQUIRED TO COMPLY WITH THE REQUIREMENTS OF THE NATIONAL POLLUTANT DISCHARGE ELIMINATION SYSTEM (NPDES) STORM WATER PERMIT FOR CONSTRUCTION SITE ACTIVITIES.
- ALL PROJECT AREAS, INCLUDING STOCKPILES, ABANDONED HAUL ROADS AND STAGING AREAS, AS SHOWN ON THE PLANS, SHALL HAVE 4 INCHES OF TOPSOIL PLACED AND BE SEEDED AND MULCHED IN ACCORDANCE WITH THE SPECIFICATIONS. AREAS DISTURBED OUTSIDE THE PROJECT LIMITS WILL BE SEEDED AND MULCHED BY THE CONTRACTOR AT HIS COST AND RESTORED TO ORIGINAL CONDITIONS.
- FOR DETAILS, SEE STORMWATER POLLUTION PREVENTION NOTES AND DETAILS SHEET.
- FOR EXACT LOCATIONS OF INLETS, SEE DRAINAGE PLAN SHEETS.
- SEDIMENT AND EROSION CONTROL MEASURES SHALL BE INSPECTED ON A WEEKLY BASIS AND AFTER EACH 1/2" RAIN EVENT.
- THE CONTRACTOR SHALL HAVE A COPY OF THE APPROVED EROSION AND SEDIMENT CONTROL PLAN ON THE SITE AT ALL TIMES.
- ANY FIELD/DRAIN TILES THAT ARE DAMAGED IN ANY WAY SHALL BE IMMEDIATELY REPAIRED ACCORDING TO THE PLANS/SPECIFICATIONS AND SHALL BE PROTECTED FROM SEDIMENT-LADEN WATER.
- PRIOR TO COMMENCING LAND DISTURBING ACTIVITIES IN AREAS OTHER THAN INDICATED ON THESE PLANS (INCLUDING BUT NOT LIMITED TO, ADDITIONAL PHASES OF DEVELOPMENT AND OFF-SITE BORROW OR WASTE AREAS) A SUPPLEMENTARY EROSION CONTROL PLAN SHALL BE SUBMITTED TO THE OWNER FOR REVIEW.
- DURING DEWATERING OPERATION, WATER SHALL BE PUMPED INTO SEDIMENT BASINS OR SILT TRAPS. COSTS OF DEWATERING, SEDIMENT BASINS AND SILT TRAPS ARE INCIDENTAL TO THE CONTRACT. DEWATERING DIRECTLY INTO FIELD TILES OR STORMWATER STRUCTURES IS PROHIBITED.
- UNLESS OTHERWISE INDICATED, ALL VEGETATIVE AND STRUCTURAL EROSION AND SEDIMENT CONTROL PRACTICES SHALL BE CONSTRUCTED ACCORDING TO MINIMUM STANDARDS AND SPECIFICATIONS IN THE ILLINOIS URBAN MANUAL REVISED FEBRUARY 2002.
- WINTER SHUTDOWN SHALL BE ADDRESSED EARLY IN THE FALL GROWING SEASON SO THAT SLOPES AND OTHER BARE EARTH AREAS MAY BE STABILIZED WITH TEMPORARY AND OR PERMANENT VEGETATIVE COVER FOR PROPER EROSION AND SEDIMENT CONTROL.
- IN AREAS WHERE WORK IS COMPLETE, PERMANENT STABILIZATION SHALL OCCUR WITHIN 7 DAYS OF COMPLETION, AND IN AREAS WORK HAS TEMPORARILY CEASED, TEMPORARY STABILIZATION SHALL OCCUR BY THE 14TH DAY AFTER WORK HAS CEASED.

**LANSING MUNICIPAL AIRPORT  
 LANSING, ILLINOIS  
 PARTIAL PARALLEL TAXIWAY TO RUNWAY 18/36  
 STORM WATER POLLUTION PREVENTION PLAN**

© Copyright CMT, Inc.

**CMT**  
 CRAWFORD, MURPHY & TILLY, INC.  
 CONSULTING ENGINEERS  
 License No. 184-000613

Lansing Municipal Airport

DESIGN BY:	ARM
DRAWN BY:	JRO
CHECKED BY:	
APPROVED BY:	
DATE:	02/27/09
JOB No:	05297-02
IL PROJECT:	IGQ-3681
A.I.P. PROJECT:	3-17-0121-B26
SHEET	6 OF 30 SHEETS