

WHITESIDE COUNTY AIRPORT BOARD WHITESIDE COUNTY, ILLINOIS

Whiteside County AIRPORT
JOSEPH H. BITTORF FIELD

WHITESIDE COUNTY AIRPORT BOARD

APPROVED BY _____
JACK CASSENS, CHAIRMAN

DATE _____ APRIL 17, 2009

CONSTRUCTION PLANS FOR WHITESIDE COUNTY AIRPORT

REHABILITATE NORTH T-HANGAR PAVEMENTS / TAXIWAY REPAIRS

DESIGN INFORMATION

TOWNSHIP: 20 NORTH COUNTY: WHITESIDE
RANGE: 7 EAST MONTMORENCY TOWNSHIP
SECTION: 10

(MAXIMUM EQUIPMENT HEIGHT = 25')



CALL J.U.L.I.E BEFORE EXCAVATING
1-800-892-0123

Illinois Professional Engineering Practice Act of 1989



Springfield, Illinois
Aurora, Illinois
Rockford, Illinois
St. Louis, Mo.

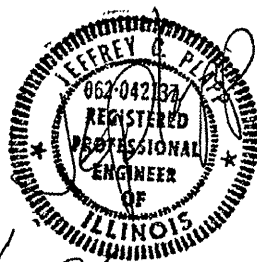

SUBMITTED BY _____
JEFFREY G. PLAPP, P.E.

DATE _____ APRIL 17, 2009
license expires 11-30-2009

FINAL SUBMITTAL

**ILLINOIS PROJECT: SQI-3872
A.I.P. PROJECT: 3-17-0098-B15**

APRIL 17, 2009
(JUNE 12, 2009 LETTING)



LOCATION MAP

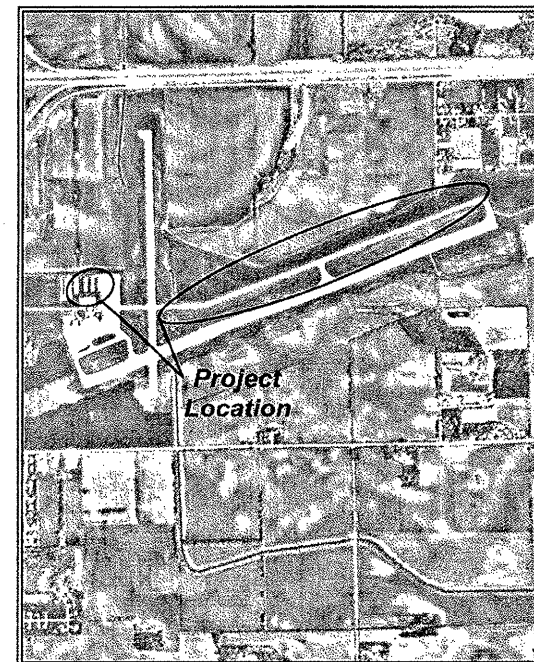

SITE PLAN

GENERAL

1. COVER SHEET (CVR1)
2. SUMMARY OF QUANTITIES (QTY1)
3. SITE PLAN (SPL1)
4. TYPICAL SECTIONS (TYP1)
5. CONSTRUCTION PHASING PLAN (CPP1)
6. CONSTRUCTION PHASING STAGE 1 (CPS1)
7. CONSTRUCTION PHASING STAGE 2 (CPS2)
8. EXISTING CONDITIONS / PROPOSED REMOVALS (REM1)
9. GRADING PLAN (GRD1)
10. MARKING / LANDSCAPING PLAN (MRK1)

SUMMARY OF QUANTITIES

SEQ NO	ITEM NO	DESCRIPTION	UNIT	BASE BID	
				REHAB. T-HANGAR TAXIWAY QUANTITY	RECORD QUANTITY
1	AR150510	ENGINEER'S FIELD OFFICE	LS	1.00	
2	AR152410	UNCLASSIFIED EXCAVATION	CY	340.00	
3	AR208515	POROUS GRANULAR EMBANKMENT	CY	200.00	
4	AR209608	CRUSHED AGG. BASE COURSE - 8"	SY	625.00	
5	AR401610	BITUMINOUS SURFACE COURSE	TONS	2,430.00	
6	AR401630	BITUMINOUS SURFACE TEST SECTION	EACH	1.00	
7	AR401900	REMOVE BITUMINOUS PAVEMENT	SY	10,360.00	
8	AR401910	REMOVE & REPLACE BIT. PAVEMENT	SY	890.00	
9	AR501604	4" PCC SIDEWALK	SF	92.00	
10	AR501690	PCC SIDEWALK REMOVAL	SF	92.00	
11	AR602510	BITUMINOUS PRIME COAT	GAL	3,120.00	
12	AR603510	BITUMINOUS TACK COAT	GAL	1,550.00	
13	AR610510	STRUCTURAL PC CONCRETE	CY	250.00	
14	AR620520	PAVEMENT MARKING - WATERBORNE	SF	7,490.00	
15	AR620525	PAVEMENT MARKING - BLACK BORDER	SF	7,490.00	
16	AR901510	SEEDING	ACRE	0.20	
17	AR905520	TOPSOILING (FROM OFF SITE)	CY	80.00	
18	AR908510	MULCHING	ACRE	0.20	
19					
20					
21					
22					
23					
24					
25					

WH008



Whiteside County **AIRPORT**
JOSEPH H. BITTORF FIELD

Whiteside County Airport

Sterling / Rock Falls, Illinois

Whiteside County Airport

AIP: 3-17-0098-B15
SQI-3872

REHABILITATE NORTH T-HANGAR PAVEMENTS / TAXIWAY REPAIRS

Revisions

No.	Date	Description

0 1
THIS BAR IS EQUAL TO 1" AT FULL SCALE (17 X 11).

DESIGN BY: CMT-RFD
DRAWN BY: CMT-RFD
CHECKED BY: CMT-RFD
APPROVED BY: JGP
DATE: 11.21.08
JOB No: 08292-05-00

SUMMARY OF QUANTITIES (QTY1)

SUMMARY OF QUANTITIES

02

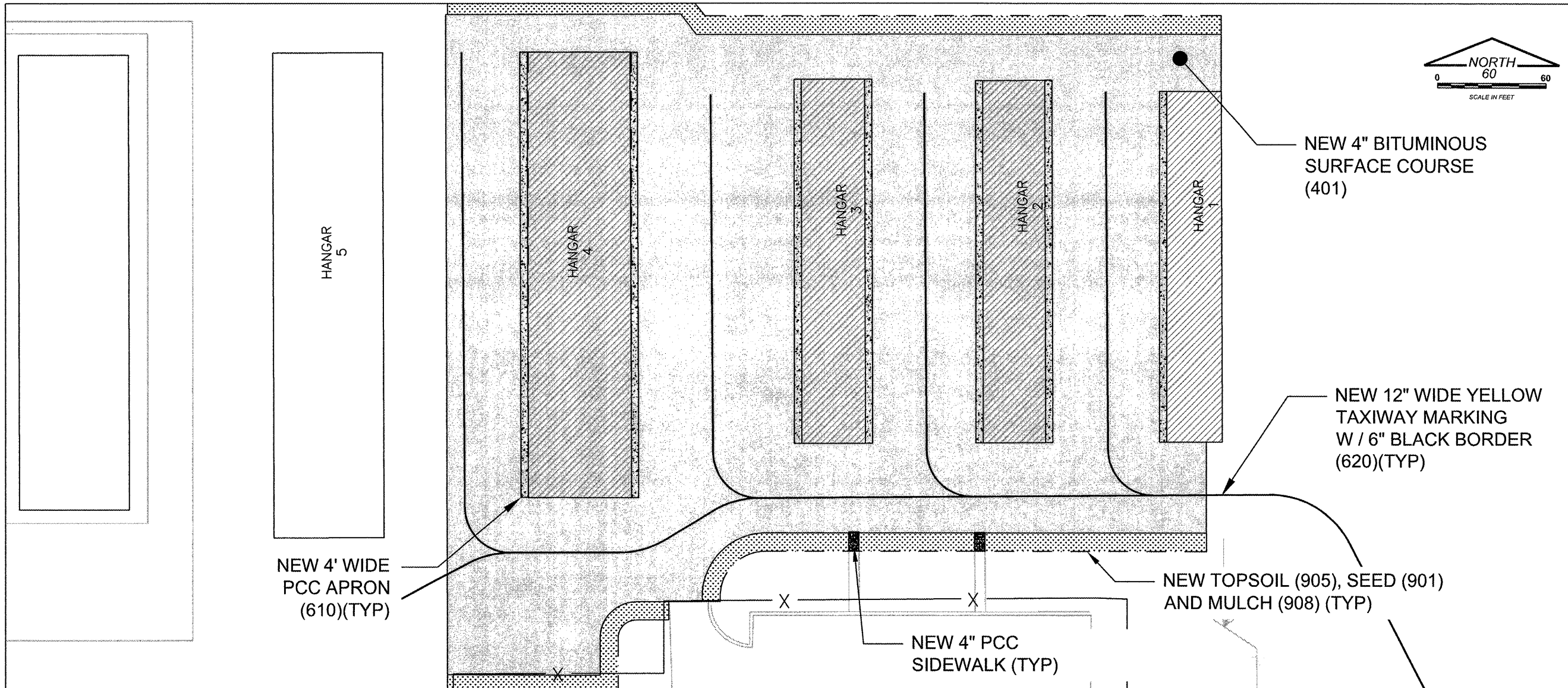

NEW 4" BITUMINOUS SURFACE COURSE (401)

NEW 12" WIDE YELLOW TAXIWAY MARKING W / 6" BLACK BORDER (620)(TYP)

NEW 4' WIDE PCC APRON (610)(TYP)

NEW TOPSOIL (905), SEED (901) AND MULCH (908) (TYP)

NEW 4" PCC SIDEWALK (TYP)

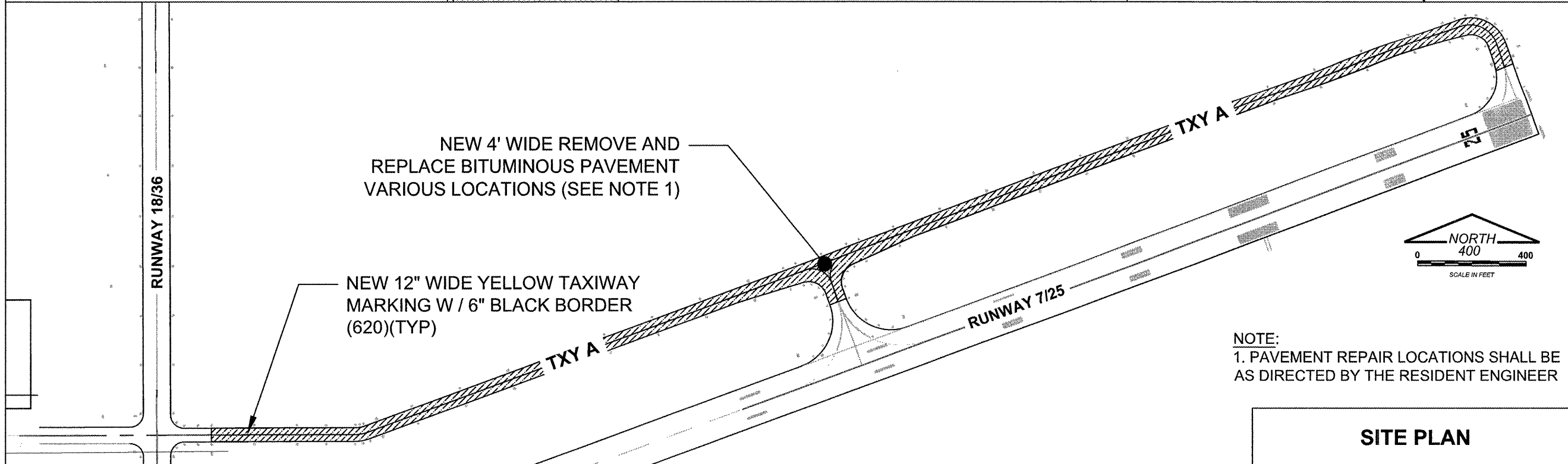

NOTE:
1. PAVEMENT REPAIR LOCATIONS SHALL BE AS DIRECTED BY THE RESIDENT ENGINEER

SITE PLAN

WH008



Whiteside County **AIRPORT**
JOSEPH H. BITTORF FIELD

Whiteside County Airport

Sterling / Rock Falls, Illinois

Whiteside County Airport

AIP: 3-17-0098-B15
SQI-3872

REHABILITATE NORTH T-HANGAR PAVEMENTS / TAXIWAY REPAIRS

Revisions

No.	Date	Description

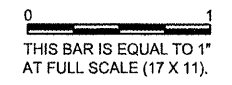

DESIGN BY: CMT- RFD
DRAWN BY: CMT- RFD
CHECKED BY: CMT- RFD
APPROVED BY: JGP
DATE: 11.21.08
JOB No: 08292-05-00

SITE PLAN (SPL1)

03

SHEET 03 OF 10 SHEETS

WH008



Whiteside County **AIRPORT**
JOSEPH H. BITTORF FIELD

Whiteside County
Airport

Sterling / Rock Falls,
Illinois

Whiteside County
Airport

AIP: 3-17-0098-B15
SQI-3872

REHABILITATE
NORTH T-HANGAR
PAVEMENTS /
TAXIWAY REPAIRS

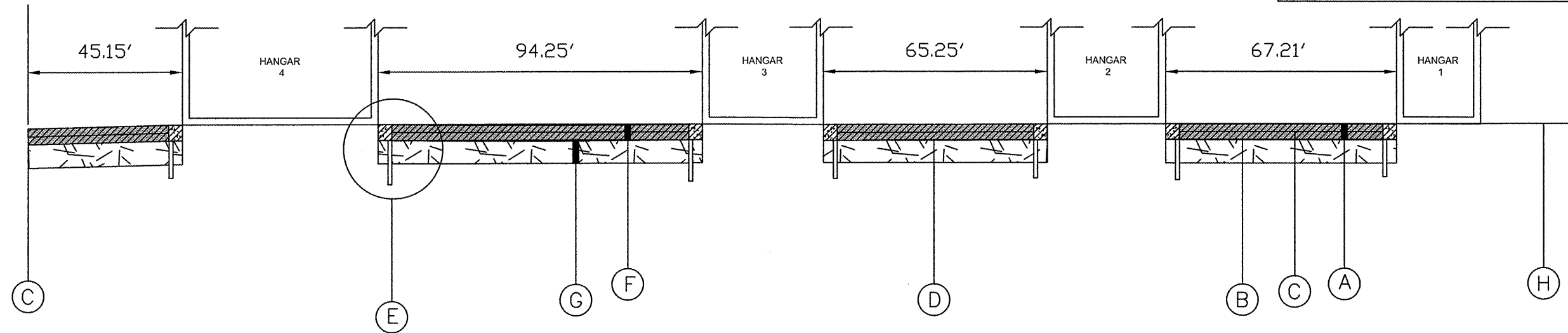
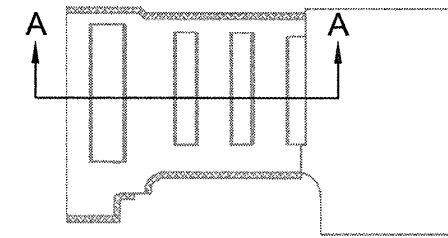

SECTION A-A
N.T.S.

LEGEND

- (A) NEW 4" SURFACE COURSE
2 LIFTS (401)
- (B) NEW BITUMINOUS PRIME COAT (602)
- (C) NEW BITUMINOUS TACK COAT (603)
- (D) NEW AGGR. BASE GRADING (401)
- (E) NEW 4" STRUCTURAL PCC (6100510)
SEE DETAIL THIS SHEET
- (F) EXISTING 4" BITUMINOUS PAVEMENT
TO BE REMOVED (AR401900)
- (G) EXISTING 8" AGGR. BASE
TO REMAIN
- (H) EXISTING GROUND LINE

Revisions

No.	Date	Description

0 1
THIS BAR IS EQUAL TO 1"
AT FULL SCALE (17 X 11).

DESIGN BY: CMT-RFD
DRAWN BY: CMT-RFD
CHECKED BY: CMT-RFD
APPROVED BY: JGP
DATE: 11.21.08
JOB No: 08292-05-00

**TYPICAL
SECTIONS
(TYP1)**

04

SHEET 04 OF 10 SHEETS

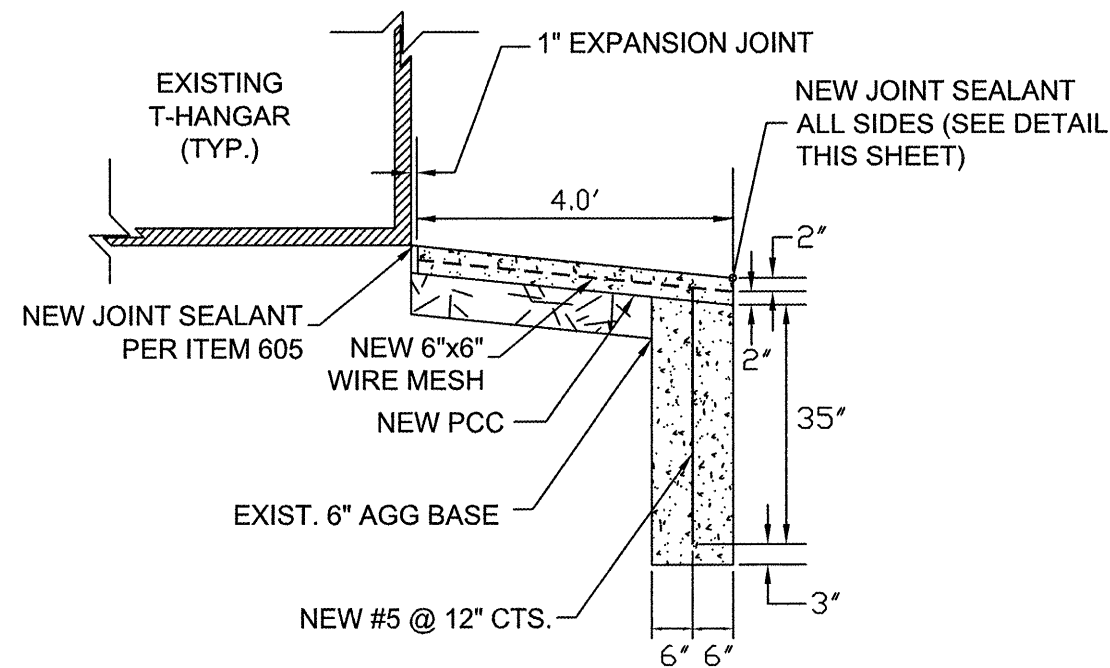

4" STRUCTURAL PCC DETAIL
NTS

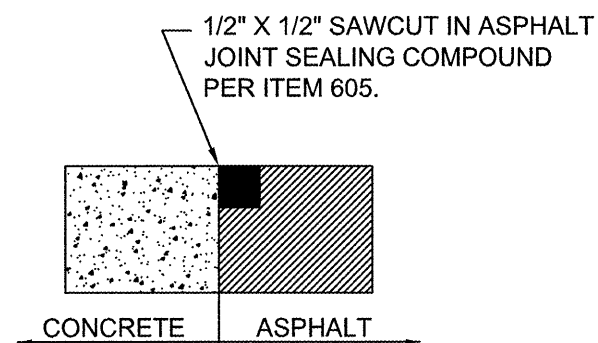

**JOINT SEALING AT CONCRETE
ASPHALT INTERFACE**
N.T.S.

NOTE: JOINT DIMENSIONS SHALL MEET MANUFACTURER'S RECOMMENDATION

TYPICAL SECTIONS 1

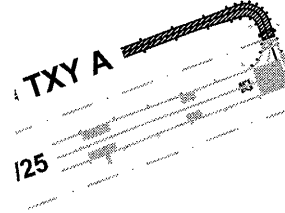
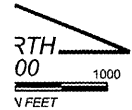

INSTRUCTION PAIRS

OF DAYLIGHT HOURS
LIGHTING TO ALLOW
ATIONS. LIGHT SHALL
ATIONS AND/OR
THE WORK AREA.
ITION TO OTHER
PROVED BY THE
AFFECT FLIGHT

TING UTILITIES SHALL
SEE SECTION 50-17
MENTS. THE
ON THE PLANS HAS
THE OWNER, THE
NSIBILITY
TENESS, OR
RANTEE, EITHER
ND TYPE OF
II DICATED ARE
RING
PONSIBILITY TO
ITIES, INCLUDING
PRIOR TO
UTILITY COMPANY
MAKE
SISTANCE IN
ILITY
ION, THE
' COMPANY, THE
NS AND/OR
IONS SHALL BE
SFACTION OF THE

7. AIRFIELD LIGHTING COORDINATION
THE CONTRACTOR SHALL BE REQUIRED TO ESTABLISH A COORDINATION PLAN WITH THE AIRPORT MANAGER OR HIS DESIGNATED REPRESENTATIVE, REGARDING DE-ENERGIZING AND ENERGIZING OF THE AIRFIELD LIGHTING CIRCUITS AT THE START AND END OF EACH CONSTRUCTION DAY.

8. TRAFFIC CONTROL PAYMENT
PAYMENT FOR TRAFFIC CONTROL INCLUDING, BUT NOT LIMITED TO, TEMPORARY CONSTRUCTION FENCING, BARRICADES, SIGNING, AIR OPERATIONS AREA (A.O.A.) LATH AND RIBBON, ETC. SHALL NOT BE PAID FOR SEPARATELY, BUT SHALL BE CONSIDERED INCIDENTAL TO THE CONTRACT. TYPE 2 BARRICADES WITH FLASHING LIGHTS SHALL BE PLACED ON 15' CENTERS. TYPE 2 BARRICADES SHALL BE PLACED AS SHOWN ON THIS PLAN AND AS DIRECTED BY THE RESIDENT ENGINEER FOR WORK ADJACENT TO THE EXPEDITED WORK AREA. WHEN NOT IN USE, THESE BARRICADES SHALL BE STORED AT THE CONTRACTOR'S STAGING AREA OR OFF SITE.

9. AIRFIELD FENCING / GATE SECURITY ALL EXISTING AND PROPOSED FENCE LINES, EXCEPT AS OTHERWISE NOTED, SHALL BE MAINTAINED AND SHALL SERVE AS CONSTRUCTION FENCING AROUND THE PERIMETER OF THE PROJECT. ALL EXISTING GATES SHALL BE MAINTAINED, CLOSED AND LOCKED AS DIRECTED BY THE AIRPORT OWNER'S REPRESENTATIVE. SHOULD THE CONTRACTOR CHOOSE TO KEEP A GATE OPEN FOR CONSTRUCTION OPERATIONS, A COMPETENT SECURITY GUARD SHALL MONITOR THE OPEN GATE. ANY COSTS SHALL NOT BE PAID FOR SEPARATELY, BUT THEY WILL BE CONSIDERED INCIDENTAL TO THE CONTRACT.

10. AIRPORT RADIO COMMUNICATION
THE CONTRACTOR SHALL SUPPLY AND HAVE IN THEIR POSSESSION AT ALL TIMES AT LEAST ONE AIRPORT RADIO. IN THE EVENT THAT THE AIRPORT MANAGER NEEDS TO CONTACT THE CONTRACTOR DIRECTLY, THE OPERATOR OF SAID RADIO SHALL BE FAMILIAR WITH AIRPORT RADIO PROCEDURES AND BE TUNED INTO THE GROUND CONTROL FREQUENCY.

11. DRIVERS TRAINING AND BADGING
SUPERVISORY PERSONNEL SHALL DEMONSTRATE IN THE PRESENCE OF THE AIRPORT MANAGER THAT THEY ARE FAMILIAR WITH AIRPORT RADIO AND AIRPORT DRIVING PROCEDURES IN ORDER TO PERFORM THE WORK. OTHER CONSTRUCTION PERSONNEL CAN BE WITHIN THE AIRFIELD LIMITS PROVIDED THAT THEY ARE UNDER ESCORT AND IN THE PRESENCE OF AN AUTHORIZED SUPERVISOR. KNOWLEDGE OF THE AIRPORT PROCEDURE'S BY THE SUPERVISORY PERSONNEL MUST BE DEMONSTRATED PRIOR TO THE START OF CONSTRUCTION.

12. DUST CONTROL REQUIREMENTS
THE CONTRACTOR SHALL BE REQUIRED TO PROVIDE DUST CONTROL AT ALL TIMES DURING THE PROJECT DURATION. A WATER TRUCK SHALL BE REQUIRED TO BE ON SITE DURING ALL CONSTRUCTION OPERATION WORKING HOURS. PAYMENT FOR DUST CONTROL SHALL BE INCIDENTAL TO THE CONTRACT.

13. OPERATIONAL SAFETY ON AIRPORT DURING CONSTRUCTION (AC 150/5370-2 LATEST EDITION)
ALL WORK SHALL CONFORM TO AC 150/5370-2E LATEST EDITION OPERATIONAL SAFETY ON AIRPORT DURING CONSTRUCTION. THIS AC IS AVAILABLE AT http://www.faa.gov/airports_airtraffic/airports/resources/advisory_circulars/media/150-5370-2E/150_5370_2e.pdf

**(ADD. PROJ. GEN. NOTES CONTD. SHT. CPS1)
(APPLY TO ALL STAGES):**

CONSTRUCTION PHASING PLAN

WH008



CMT
CRAWFORD, MURPHY & TILLY, INC.
CONSULTING ENGINEERS
© Copyright CMT, Inc.

Whiteside County AIRPORT
JOSEPH H. BITTORF FIELD

Whiteside County Airport

Sterling / Rock Falls, Illinois

Whiteside County Airport

**AIP: 3-17-0098-B15
SQI-3872**

**REHABILITATE
NORTH T-HANGAR
PAVEMENTS /
TAXIWAY REPAIRS**

Revisions

No.	Date	Description



THIS BAR IS EQUAL TO 1" AT FULL SCALE (17 X 11).

DESIGN BY: CMT- RFD

DRAWN BY: CMT- RFD

CHECKED BY: CMT- RFD

APPROVED BY: JGP

DATE: 11.21.08

JOB No: 08292-05-00

**CONSTRUCTION PHASING PLAN
(CPP1)**

05



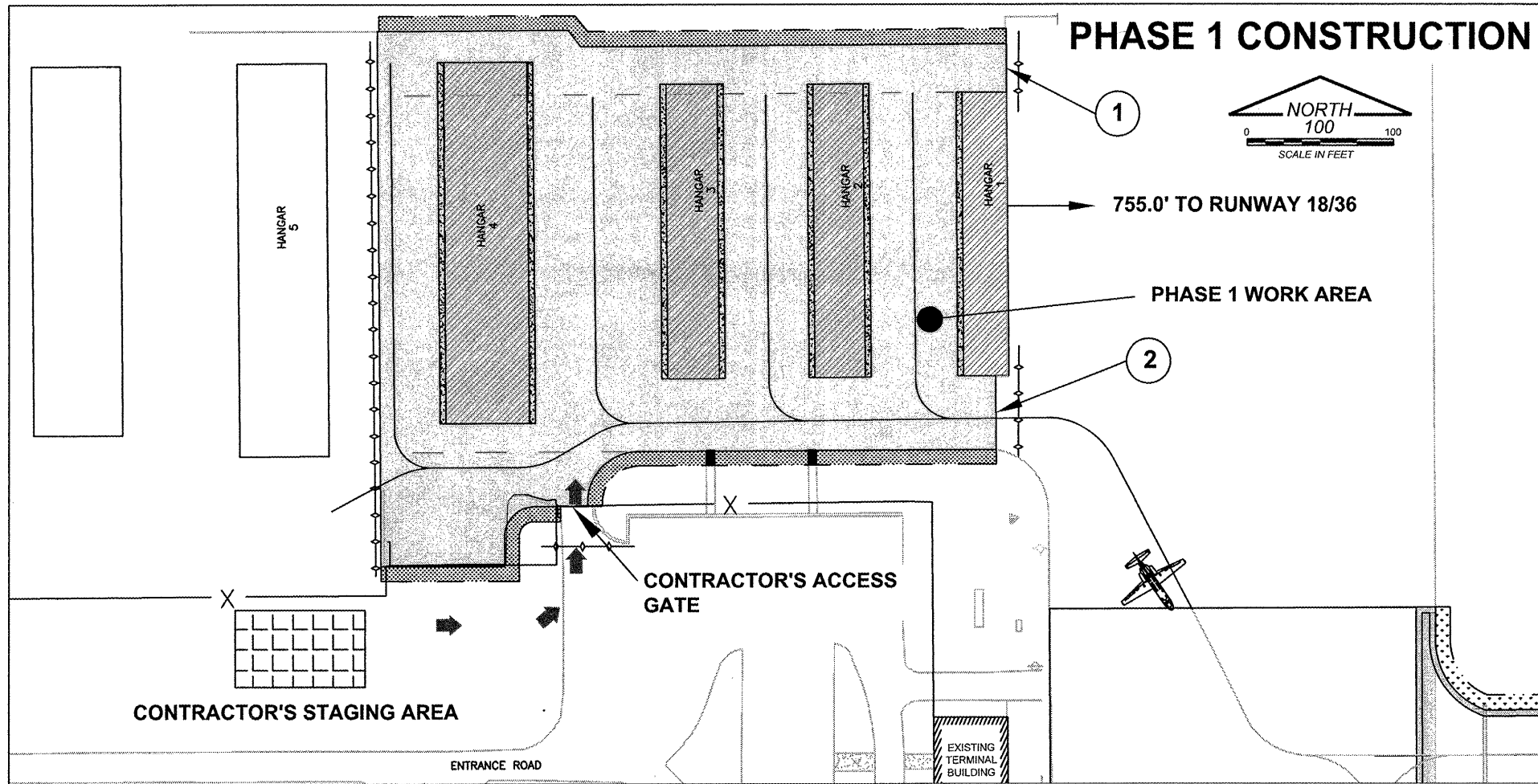

SHEET 05 OF 10 SHEETS



PHASE 1 CONSTRUCTION

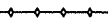

LEGEND

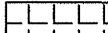
-  PHASE 1 CONSTRUCTION (EQUIPMENT HEIGHT 25')
-  CONTRACTOR'S ACCESS/HAUL ROAD
-  TYPE 2 BARRICADES WITH STEADY BURN RED LIGHTS AND CONSTRUCTION FENCING
-  AIRCRAFT MOVEMENT OPERATIONS
-  AOA AIR OPERATIONS AREA (A.O.A.)
-  CONSTRUCTION STAGING

WH008



Whiteside County **AIRPORT**
JOSEPH H. BITTORF FIELD

Whiteside County
Airport

Sterling / Rock Falls,
Illinois

Whiteside County
Airport

AIP: 3-17-0098-B15
SQI-3872
REHABILITATE
NORTH T-HANGAR
PAVEMENTS /
TAXIWAY REPAIRS

CONSTRUCTION PHASING STAGE 1 - NOTES:

1. CONTRACTOR SHALL PROVIDE RESIDENT ENGINEER WITH APPROVED PROGRESS SCHEDULE SHOWING START/ STOP DATES OF ALL PHASES. APPROVED PROGRESS SCHEDULE SHALL BE SUBMITTED 3 WORKING DAYS PRIOR TO START OF CONSTRUCTION.
2. PHASE 1 CONSTRUCTION ACTIVITIES SHALL TAKE PLACE BETWEEN THE HOURS OF OPERATION SUBMITTED BY THE CONTRACTOR AND APPROVED BY THE AIRPORT MANAGER AND RESIDENT ENGINEER.
3. PHASE 1 CONSTRUCTION SHALL BE COMPLETED PRIOR TO THE START OF PHASE 2.
4. PHASE 1 WORK AREA DESCRIPTION. AN APPROVED PHASE 1 WORK AREA SCHEDULE SHALL BE SUBMITTED TO THE AIRPORT MANAGER AND RESIDENT ENGINEER 72 HOURS PRIOR TO THE START OF SAID CONSTRUCTION. DURING PHASE 1 WORK THE CONTRACTOR SHALL PLACE TYPE 2 BARRICADES WITH STEADY BURN RED LIGHTS IN THE LOCATION OF THE WORK BEING PERFORMED. ACCESS TO THE ADJACENT HANGARS SHALL BE MADE AVAILABLE AT ALL TIMES TO AIRCRAFT AND AIRPORT PERSONNEL. SHOULD AN AIRCRAFT OR AIRPORT PERSONNEL NEED ACCESS TO A HANGAR OR AN AREA THAT THE CONTRACTOR IS WORKING, THE CONTRACTOR SHALL MAKE SAID AREA ACCESSIBLE AND SHALL DO SO AT NO ADDITIONAL COST TO THE CONTRACT. THE CONTRACTOR SHALL KEEP THE IMMEDIATE AND SURROUNDING AREA FREE OF DUST AND DEBRIS AT ALL TIMES DURING CONSTRUCTION.

**PROJECT GENERAL NOTES (CONTD. FROM SHT. CPP1)
(APPLY TO ALL STAGES):**

14. **STAGING AREA**
THE CONTRACTOR'S MATERIAL AND EQUIPMENT, WHEN NOT IN USE, SHALL BE STORED IN THE CONTRACTOR'S STAGING AREA. ALL DELIVERIES, EQUIPMENT RE-FUELING, EQUIPMENT MAINTENANCE AND EQUIPMENT TRANSFERS SHALL TAKE PLACE WITHIN THE CONTRACTOR'S STAGING AREA.
15. **UNATTENDED CONSTRUCTION ACCESS**
THE OWNER WILL ASSESS THE CONTRACTOR A \$1,000.00 FINE FOR CLOSING AND/OR LOCKING EACH UNATTENDED ACCESS DOOR, GATE OR FENCE WHICH HAS BEEN IDENTIFIED AS A CONTRACTOR RESPONSIBILITY. AN ACCESS DOOR, GATE OR FENCE IS DEFINED AS "UNATTENDED" ANY TIME IT IS OPEN, UNLOCKED OR OTHERWISE RENDERED INEFFECTIVE IN PROVIDING SECURITY AND CONTRACTOR PERSONNEL ARE NOT PHYSICALLY IN A POSITION TO DETECT AND PREVENT UNAUTHORIZED ENTRY THROUGH IT. IN THE EVENT AIRPORT PERSONNEL ARE UNABLE TO SECURE AN UNATTENDED ACCESS DOOR, GATE OR FENCE, AIRPORT SECURITY PERSONNEL WILL BE POSTED AND CONTRACTORS WILL BE NOTIFIED. CONTRACTORS WILL BE CHARGED THE COST OF PROVIDING SECURITY PERSONNEL UNTIL THE AREA IS AGAIN SECURE.
16. **UNAUTHORIZED ACCESS TO AIRFIELD**
THE CONTRACTOR SHALL RESTRICT ALL ACTIVITIES TO THE CONSTRUCTION AREA DETAILED IN THE PHASING PLAN. ANY UNAUTHORIZED MOVEMENTS, PEDESTRIAN OR VEHICULAR, BEYOND THE CONSTRUCTION LIMITS SHOWN SHALL BE CONSIDERED AN AIRFIELD INCURSION. AIRFIELD INCURSIONS, AT THE DISCRETION OF THE AIRPORT MANAGER, MAY BE FINED \$10,000.00 PER INCIDENT. INCURSION FINES WILL BE ASSESSED IMMEDIATELY AND TAKEN FROM MONIES DUE THE CONTRACTOR ON THE NEXT CONSTRUCTION PAYMENT.

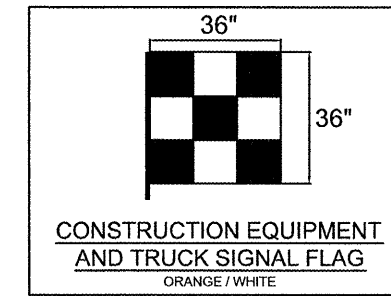

CRITICAL POINTS	
1	Lat. 41 44 36.25; Long. 89 41 01.26; Grd. El. 648.0; Equip. Ht. 25'; Top El. 673.0
2	Lat. 41 44 33.96; Long. 89 41 01.38; Grd. El. 648.0; Equip. Ht. 25'; Top El. 673.0

Revisions		
No.	Date	Description

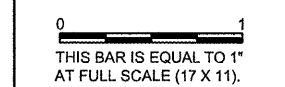

DESIGN BY: CMT- RFD
DRAWN BY: CMT- RFD
CHECKED BY: CMT- RFD
APPROVED BY: JGP
DATE: 11.21.08
JOB No: 08292-05-00

CONSTRUCTION PHASING STAGE 1 (CPS1)

CONSTR. PHASING STAGE 1

06
SHEET 06 OF 10 SHEETS

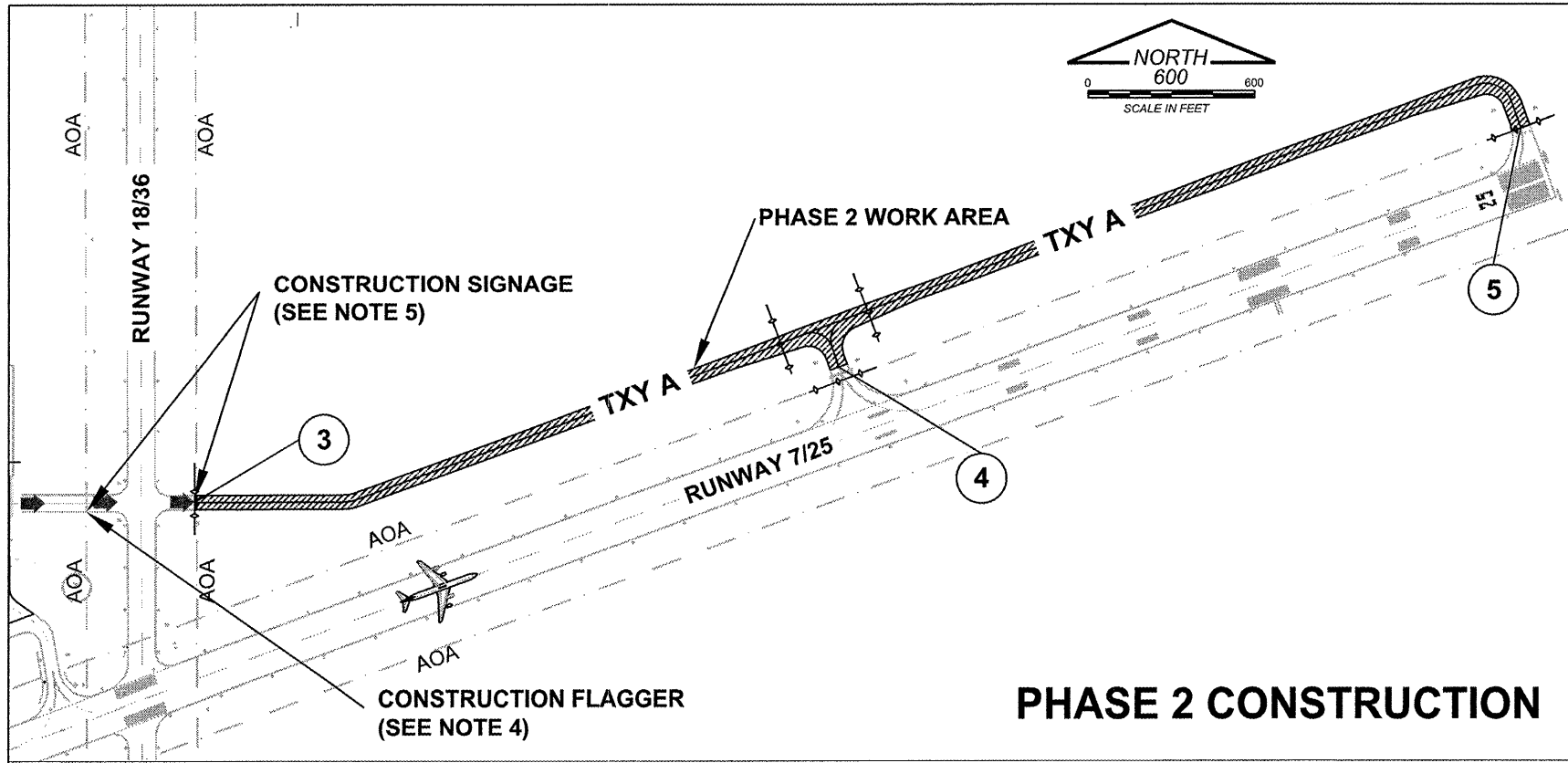

- LEGEND**
- PHASE 2 CONSTRUCTION AREA (EQUIPMENT HEIGHT 25')
 - CONTRACTOR'S ACCESS/HAUL ROAD
 - TYPE 2 BARRICADES WITH STEADY BURN RED LIGHTS AND CONSTRUCTION FENCING
 - AIRCRAFT MOVEMENT OPERATIONS
 - AIR OPERATIONS AREA (A.O.A.)
 - CONSTRUCTION LIMITS

PHASE 2 CONSTRUCTION

CONSTRUCTION PHASING STAGE 2 - NOTES:

1. PHASE 2 CONSTRUCTION ACTIVITIES SHALL TAKE PLACE BETWEEN THE HOURS OF OPERATION SUBMITTED BY THE CONTRACTOR AND APPROVED BY THE AIRPORT MANAGER AND RESIDENT ENGINEER.
2. PHASE 2 CONSTRUCTION SHALL NOT BEGIN UNTIL AFTER THE COMPLETION OF PHASE 1.
3. PHASE 2 WORK AREA DESCRIPTION. AN APPROVED PHASE 2 WORK AREA SCHEDULE SHALL BE SUBMITTED TO THE AIRPORT MANAGER AND RESIDENT ENGINEER 72 HOURS PRIOR TO THE START OF SAID CONSTRUCTION. DURING PHASE 2 WORK THE CONTRACTOR SHALL PLACE TYPE 2 BARRICADES WITH STEADY BURN RED LIGHTS IN THE LOCATION OF THE WORK BEING PERFORMED. ACCESS TO THE HANGARS, RUNWAYS AND TAXIWAYS SHALL BE MADE AVAILABLE AT ALL TIMES TO AIRCRAFT AND AIRPORT PERSONNEL. SHOULD AN AIRCRAFT OR AIRPORT PERSONNEL NEED ACCESS TO A HANGAR OR AN AREA THAT THE CONTRACTOR IS WORKING, THE CONTRACTOR SHALL MAKE SAID AREA ACCESSIBLE AND SHALL DO SO AT NO ADDITIONAL COST TO THE CONTRACT. THE CONTRACTOR SHALL KEEP THE IMMEDIATE AND SURROUNDING AREA FREE OF DUST AND DEBRIS AT ALL TIMES DURING CONSTRUCTION.
4. THE CONTRACTOR SHALL EMPLOY A FULL-TIME FLAGGER AT THE LOCATION SHOWN IN THE PLANS. THE FLAGGER SHALL BE IN RADIO CONTACT WITH THE AIRPORT FREQUENCY 123.0 AT ALL TIMES AND SHALL DIRECT CONSTRUCTION TRAFFIC ACROSS THE ACTIVE AIRFIELD PAVEMENTS. THE CONTRACTOR SHALL PROVIDE A RADIO FOR THE FLAGGER. BEFORE PHASE 2 CONSTRUCTION BEGINS THE AIRPORT MANAGER AND RESIDENT ENGINEER SHALL APPROVE THE CONTRACTOR'S PROPOSED FLAGGER. THE COST OF THE FLAGGER SHALL BE CONSIDERED INCIDENTAL TO THE CONTRACT.
5. THE CONTRACTOR SHALL PLACE STOP SIGNS AT THE RUNWAY 18/36 A.O.A. ON TAXIWAY A AS DIRECTED BY THE RESIDENT ENGINEER. CONSTRUCTION TRAFFIC SHALL NOT PROCEED PAST THESE SIGNS UNLESS DIRECTED TO BY THE AUTHORIZED FLAGGER. THE OWNER WILL ASSESS THE CONTRACTOR A \$1,000.00 FINE FOR EACH OCCURRENCE OF AN UNAUTHORIZED VEHICLE CROSSING. THE COST OF THE SIGNS SHALL BE CONSIDERED INCIDENTAL TO THE CONTRACT.

CRITICAL POINTS	
3	Lat. 41 44 31.62; Long. 89 40 48.67; Grd. El. 641.0; Equip. Ht. 25'; Top El. 666.0
4	Lat. 41 44 36.27; Long. 89 40 18.07; Grd. El. 646.0; Equip. Ht. 25'; Top El. 671.0
5	Lat. 41 44 44.99; Long. 89 39 45.81; Grd. El. 646.1; Equip. Ht. 25'; Top El. 671.1

WH008

CMT
CRAWFORD, MURPHY & TILLY, INC.
CONSULTING ENGINEERS
© Copyright CMT, Inc.

Whiteside County **AIRPORT**
JOSEPH H. BITTORF FIELD
Whiteside County Airport

Sterling / Rock Falls, Illinois
Whiteside County Airport

AIP: 3-17-0098-B15
SQI-3872
REHABILITATE NORTH T-HANGAR PAVEMENTS / TAXIWAY REPAIRS

Revisions		
No.	Date	Description

0 1
THIS BAR IS EQUAL TO 1" AT FULL SCALE (17 X 11).

DESIGN BY: CMT-RFD
DRAWN BY: CMT-RFD
CHECKED BY: CMT-RFD
APPROVED BY: JGP
DATE: 11.21.08
JOB No: 08292-05-00

CONSTRUCTION PHASING STAGE 2 (CPS2)

REMOVE EXISTING BITUMINOUS PAVEMENT REGRADE
EXISTING AGGREGATE BASE
(TYP)(401)

REMOVE EXISTING CONCRETE
APPROACH (TYP)
(SEE NOTE 1)

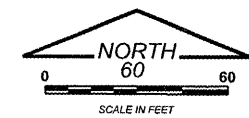

WH008
CMT
CRAWFORD, MURPHY & TILLY, INC.
CONSULTING ENGINEERS
© Copyright CMT, Inc.

Whiteside County **AIRPORT**
JOSEPH H. BITTORF FIELD
Whiteside County
Airport

Sterling / Rock Falls,
Illinois
Whiteside County
Airport
AIP: 3-17-0098-B15
SQI-3872

REHABILITATE
NORTH T-HANGAR
PAVEMENTS /
TAXIWAY REPAIRS

NOTES:
1. THE CONTRACTOR SHALL SAWCUT THE EXISTING CONCRETE APRON ALONG THE FACE OF THE EXISTING HANGAR. THE COST OF THE CONCRETE REMOVAL AND SAWING SHALL BE CONSIDERED INCIDENTAL ITEM AR401900 REMOVE BITUMINOUS PAVEMENT.
2. THE COST OF REMOVING AND REPLACING THE EXISTING EXIT LOOP SHALL BE CONSIDERED INCIDENTAL TO ITEM AR401900 REMOVE BITUMINOUS PAVEMENT.

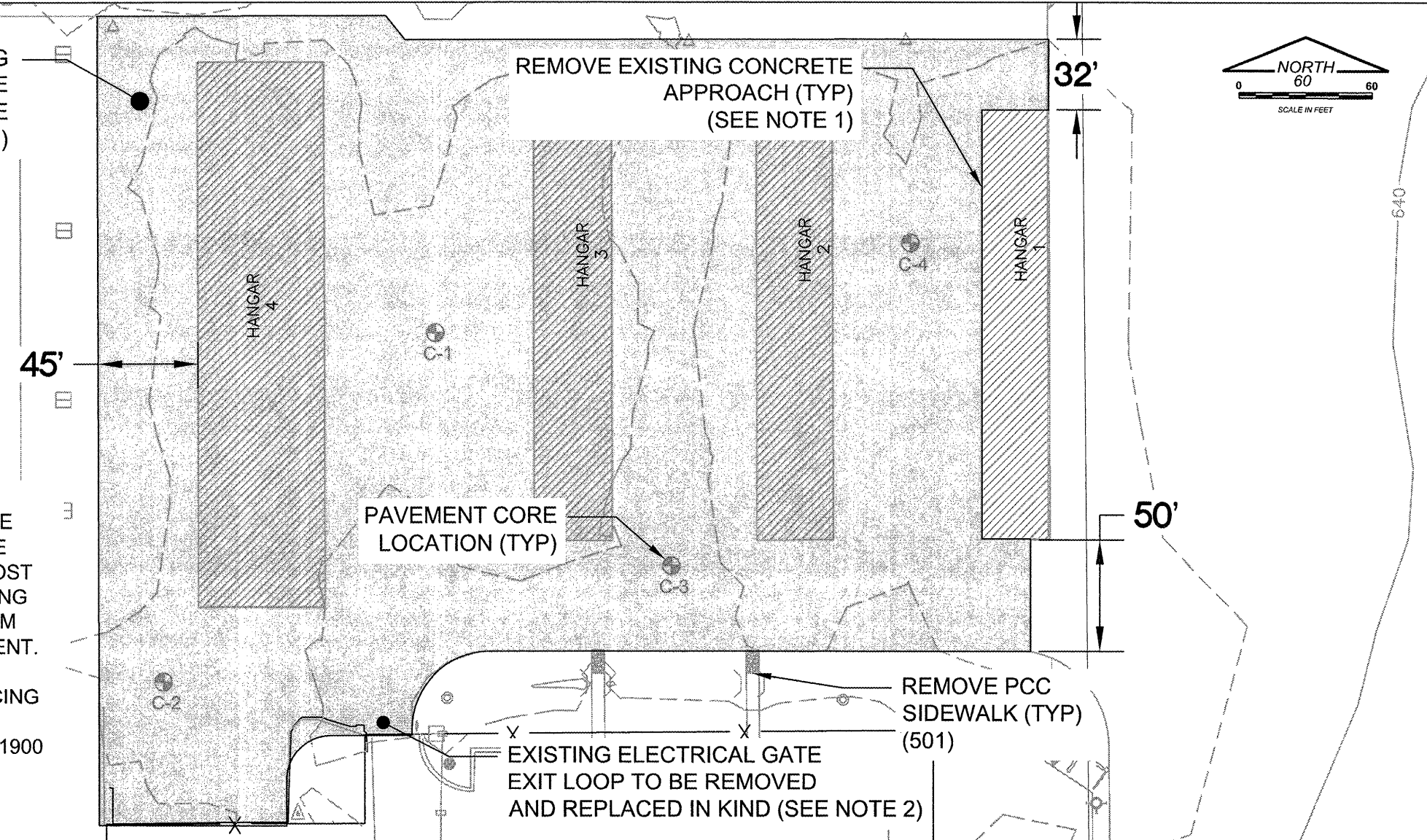

Revisions

No.	Date	Description

0 1
THIS BAR IS EQUAL TO 1"
AT FULL SCALE (17 X 11).
DESIGN BY: CMT- RFD
DRAWN BY: CMT- RFD
CHECKED BY: CMT- RFD
APPROVED BY: JGP
DATE: 11.21.08
JOB No: 08292-05-00

NEW 4' WIDE REMOVE AND
REPLACE BITUMINOUS PAVEMENT
VARIOUS LOCATIONS (SEE NOTE 1)



NOTE:
1. PAVEMENT REPAIR LOCATIONS SHALL BE AS DIRECTED BY THE RESIDENT ENGINEER

**EXISTING CONDITIONS /
PROPOSED REMOVALS**

**EXISTING
CONDITIONS /
PROPOSED
REMOVALS
(SPL1)**

08

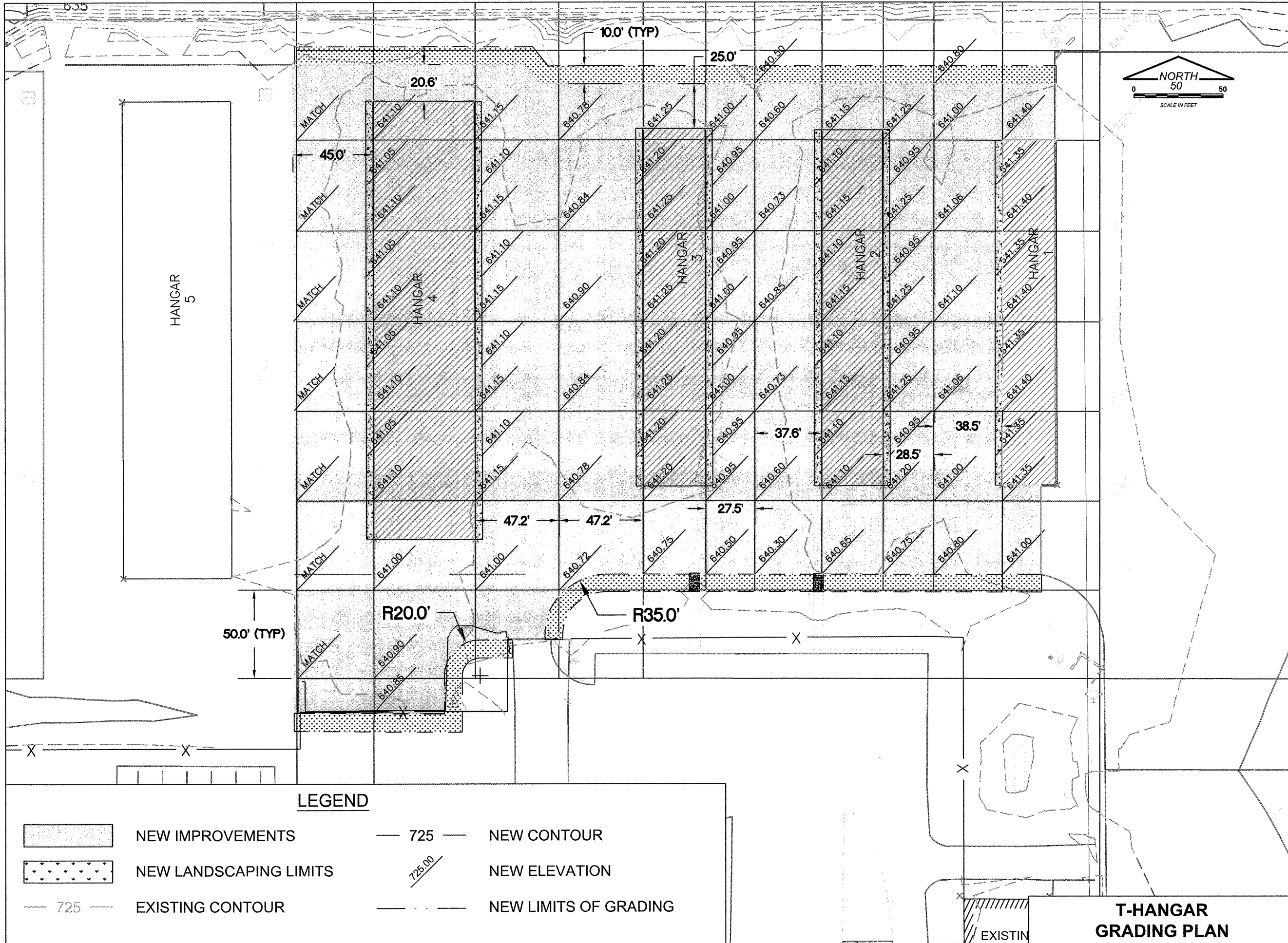

WH008



Whiteside County **AIRPORT**
JOSEPH H. BITTORF FIELD
Whiteside County Airport

Sterling / Rock Falls, Illinois
Whiteside County Airport
AIP: 3-17-0098-B15
SQI-3872

REHABILITATE NORTH T-HANGAR PAVEMENTS / TAXIWAY REPAIRS

Revisions

No.	Date	Description

0 1
THIS BAR IS EQUAL TO 1" AT FULL SCALE (17 X 11).

DESIGN BY: CMT-RFD
DRAWN BY: CMT-RFD
CHECKED BY: CMT-RFD
APPROVED BY: JGP
DATE: 11.21.08
JOB No: 08292-05-00

T-HANGAR GRADING PLAN (GRD1)

09

SHEET 09 OF 10 SHEETS

LEGEND

- NEW IMPROVEMENTS
- NEW LANDSCAPING LIMITS
- 725 EXISTING CONTOUR
- 725 NEW CONTOUR
- 725.00 NEW ELEVATION
- NEW LIMITS OF GRADING

T-HANGAR GRADING PLAN

EXISTIN

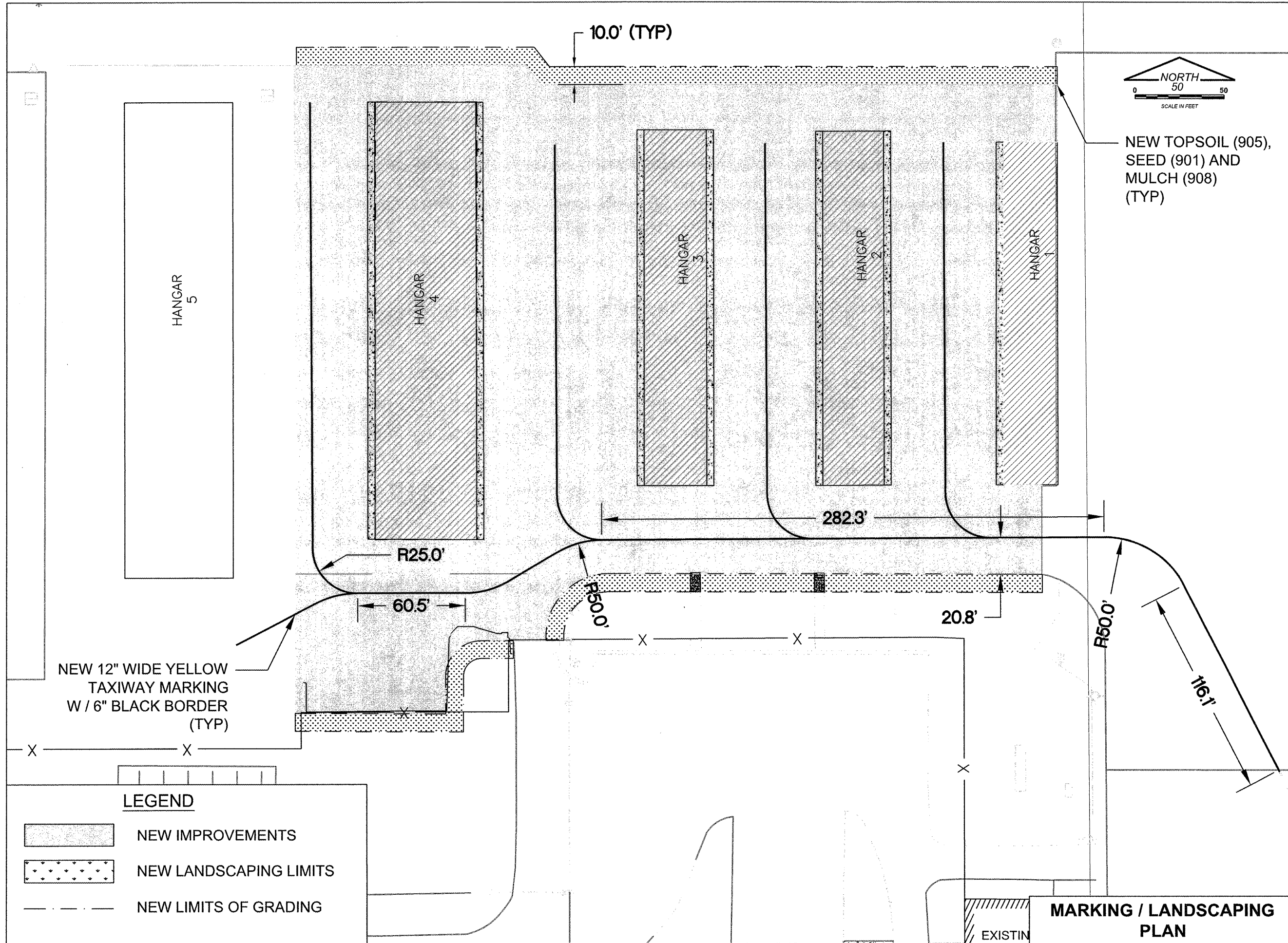

WH008



Whiteside County **AIRPORT**
JOSEPH H. BITTORF FIELD
Whiteside County
Airport

Sterling / Rock Falls,
Illinois
Whiteside County
Airport
AIP: 3-17-0098-B15
SQI-3872

REHABILITATE
NORTH T-HANGAR
PAVEMENTS /
TAXIWAY REPAIRS

Revisions

No.	Date	Description

0 1
THIS BAR IS EQUAL TO 1" AT FULL SCALE (17 X 11).

DESIGN BY: CMT-RFD
DRAWN BY: CMT-RFD
CHECKED BY: CMT-RFD
APPROVED BY: JGP
DATE: 11.21.08
JOB No: 08292-05-00

**MARKING /
LANDSCAPING
PLAN
(MRK1)**

10

**MARKING / LANDSCAPING
PLAN**

LEGEND

- NEW IMPROVEMENTS
- NEW LANDSCAPING LIMITS
- NEW LIMITS OF GRADING